

ELEVATION 1
1:20

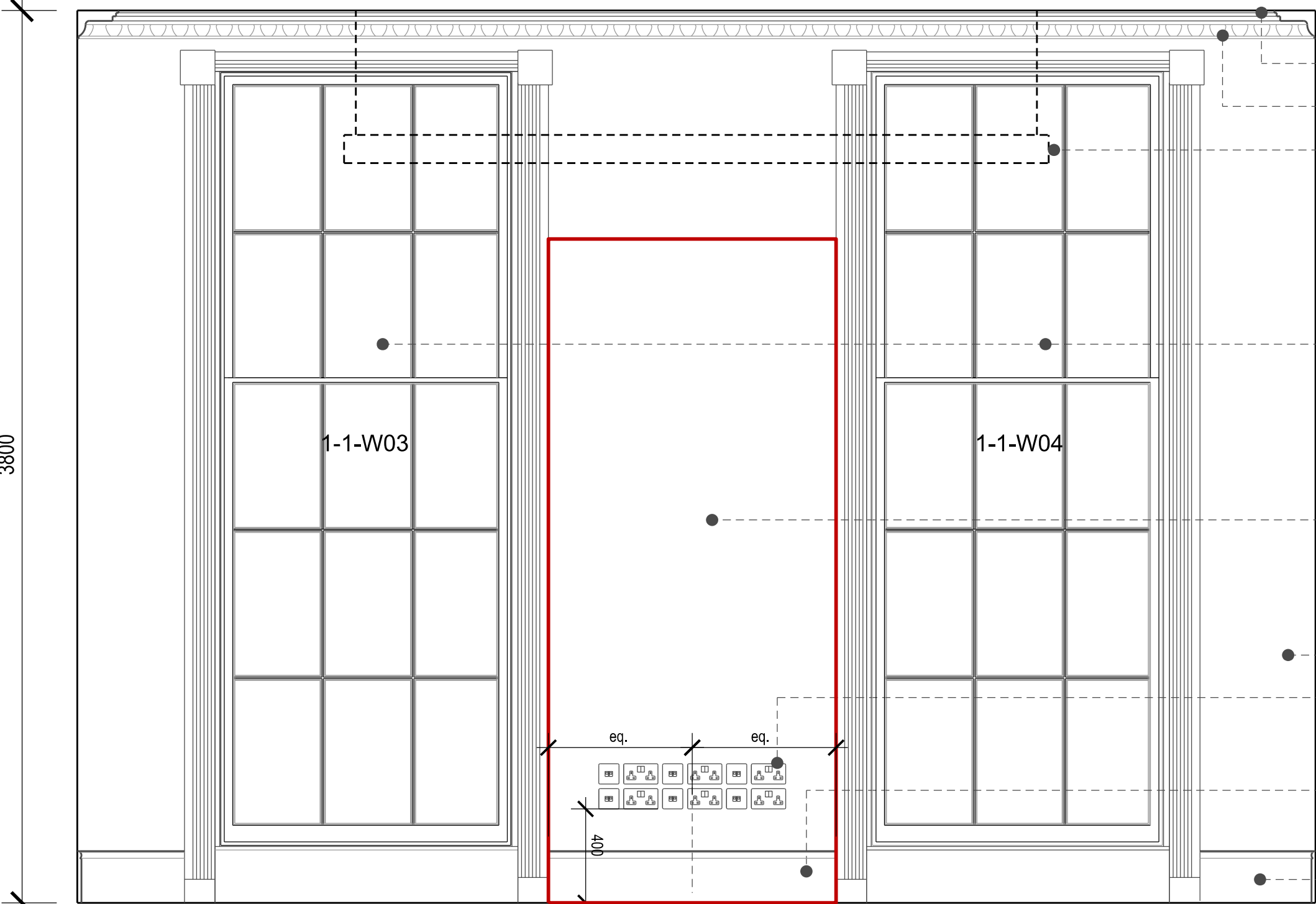

ELEVATION 2
1:20

METHOD STATEMENT SEE SPECIFIC NOTES FOR EACH WALL

INTERNAL WALLS

All metal elements associated with previous museum shelving to be carefully removed.

Carefully remove all modern plasterboard and plaster finishes from areas identified in the drawings.

Ensure existing laths are trimmed and fixed to end on a timber stud.

Fix new timber replacement laths spaced approximately 6-8mm apart to allow enough space for the haired plaster to be pushed up between them, and to form good nibs or keys. Laths to be fixed parallel to one another by nailing them to every stud that they cross. Replacement laths to be trimmed to length so that they end on a stud. A gap of 3mm to be allowed between butt ends of laths. Joints in laths to be staggered every 12th lath. Where laths pass over joists, beams, posts or studs wider than 75mm, counter lathing should be used to form a space behind the laths to accommodate plaster nibs. All new metal fixings to be non-ferrous or stainless steel.

A new 3 coat non-hydraulic lime plaster finish to be applied consisting of:
1) Pricking up coat- 1 part mature lime putty, 2.5 parts well-graded sand, 5kg hair per m3 of coarse stuff
2) Floating coat- 1 part mature lime putty, 2.5 parts well-graded sand, 3-5kg hair per m3 of coarse stuff
3) Setting coat plaster- 1 part mature lime putty, 1 part fine sand

New lime plaster finish to finish flush with existing adjacent plasterwork.

New matt emulsion paint decoration- Allow for 2no. coats based on colour selection to be agreed with architect and British Museum. Farrow and Ball colours to be matched with Dulux trade paint.

Repair all intrusive investigations in walls with lime plaster as above.

CEILINGS

New matt emulsion paint decoration. Colour to be agreed with architect and British Museum. Refer to (45) series reflected ceiling plans for additional information.

WINDOWS

Overhaul of existing sash windows to ensure full operation. To be fully redecorated. Refer to Window schedule for specific information.

DOORS

Doors to be redecorated in eggshell paint finish to match joinery. Refer to Door schedule for further information. Requirement for fire upgrade tbd.

JOINERY

Areas of missing skirting to be replaced with new hardwood boards to match the existing profile. Extent illustrated within red lines of drawing. Eggshell paint decoration in colour to be agreed.

DECORATIVE PLASTERWORK

Surfaces to be dusted down and any loose debris removed. New thin paint coating to be applied using water soluble soft distemper or water thinned alkyd resin paints to ensure decorative detail is not lost. Water thinned contract grade emulsion may be acceptable. Suggested trial area for inspection. Applies to full extent of cornices in principal spaces at ground and first floor levels.

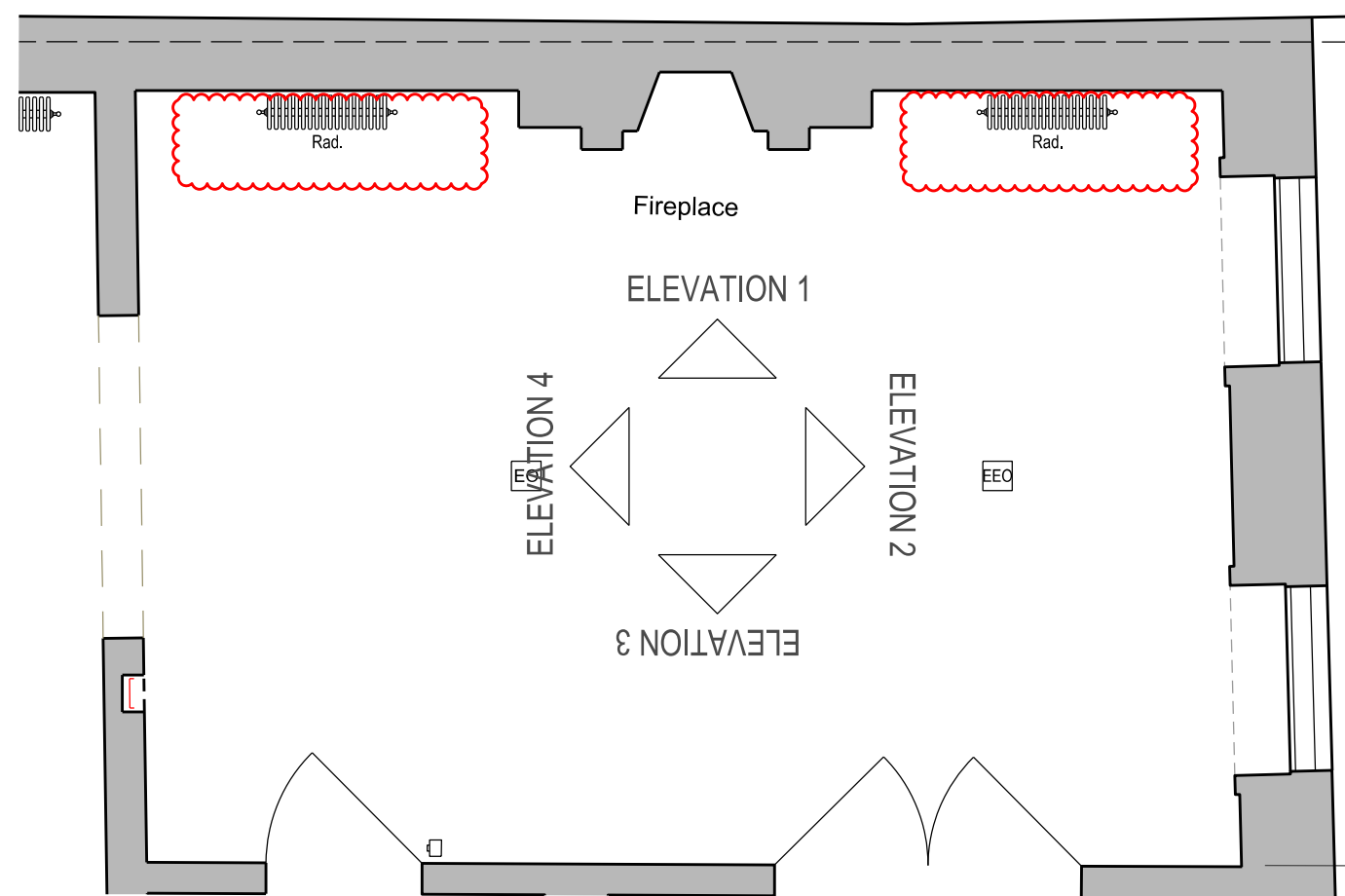

PLAN - 1MS/3/002 - 1.50



BUILDING DESIGN PARTNERSHIP LTD SHALL HAVE NO RESPONSIBILITY FOR ANY USE MADE OF THIS DOCUMENT OTHER THAN FOR THAT WHICH IT WAS PREPARED AND ISSUED.

ALL DIMENSIONS SHOULD BE CHECKED ON SITE.

DO NOT SCALE FROM THIS DRAWING.

ANY DRAWING ERRORS OR DIVERGENCES SHOULD BE BROUGHT TO THE ATTENTION OF BUILDING DESIGN PARTNERSHIP LTD AT THE ADDRESS SHOWN BELOW.

NOTES

EXISTING STRUCTURE

NEW CONSTRUCTION

EXTENT OF REPAIR WORK

REVISION CLOUD REFERS TO VRF REMOVED OR RADIATOR ADDED

REVISION DESCRIPTION DRAWN CHECKED DATE

C - For Planning and Listed Building Consent Application NA AC 24/04/18

B - For Planning and Listed Building Consent Application LBE MB 23/06/17

A - For Planning and Listed Building Consent Application RC MB 01/06/17

FIRST ISSUE RC MB 12/05/17

KEY PLAN



CLIENT LOGO



BDP.

16 Brewhouse Yard
Clerkenwell
London, EC1V 4LJ
United Kingdom

T +44 (0)20 7812 8000
F +44 (0)20 7812 8399
www.bdp.com

British Museum
Perimeter Properties Refurbishment

P2007246

DRAWING TITLE SCALE

1 Montague Street 1:20@A1

First Floor Level 1MS/3/002

Internal Elevations 1 - 2

Planning and LBC Application

DRAWING NO. REVISION

(70)AD015 C