

- GENERAL NOTES:**
- G1 For Site and Grid setting out refer to AXXXX/2000
 - G2 All dimensions to be checked on site
 - G3 Any discrepancies between drawings to be reported to the Architect immediately.
 - G4 All Levels are above Ordnance datum (AOD)
 - G5 New Levels are shown thus: ±20.325
 - G6 Existing Levels are shown thus: EX20.225
 - G7 Use Imperial dimensions only. Do not scale from drawings. IF IN DOUBT, ASK.
 - G8 Refer to Engineers drawings for all structural and services information.
 - G9 For tolerances see the Design Drawings and Specifications
 - G10 For details of work subject to Contractor's Design, this drawing is not to be used for construction purposes only. The Contractor is responsible for the detailed design and co-ordination of the installation within the parameters defined in the specification, design drawings, contract terms and contract documents.

G9 Room numbers are shown thus: 119

G10 Door (D) & Window (W) References

Door No. / Window No. / The Sillage

R402 / W100 / 100

Door Type / Window Type / Awning Type

Z120 / M15-01 / A1

G11 Chair height is shown thus

(finished floor to finished soffit)

G12 T Sheet Reference shown thus

G13 Finishes are shown thus:

G14 Settling Out Points shown thus: S20 / S30

G15 Refer to AXXXX/100 for T Sheet references, and to AXXXX/110 to 310 for Architectural Specifications.

NOTES:

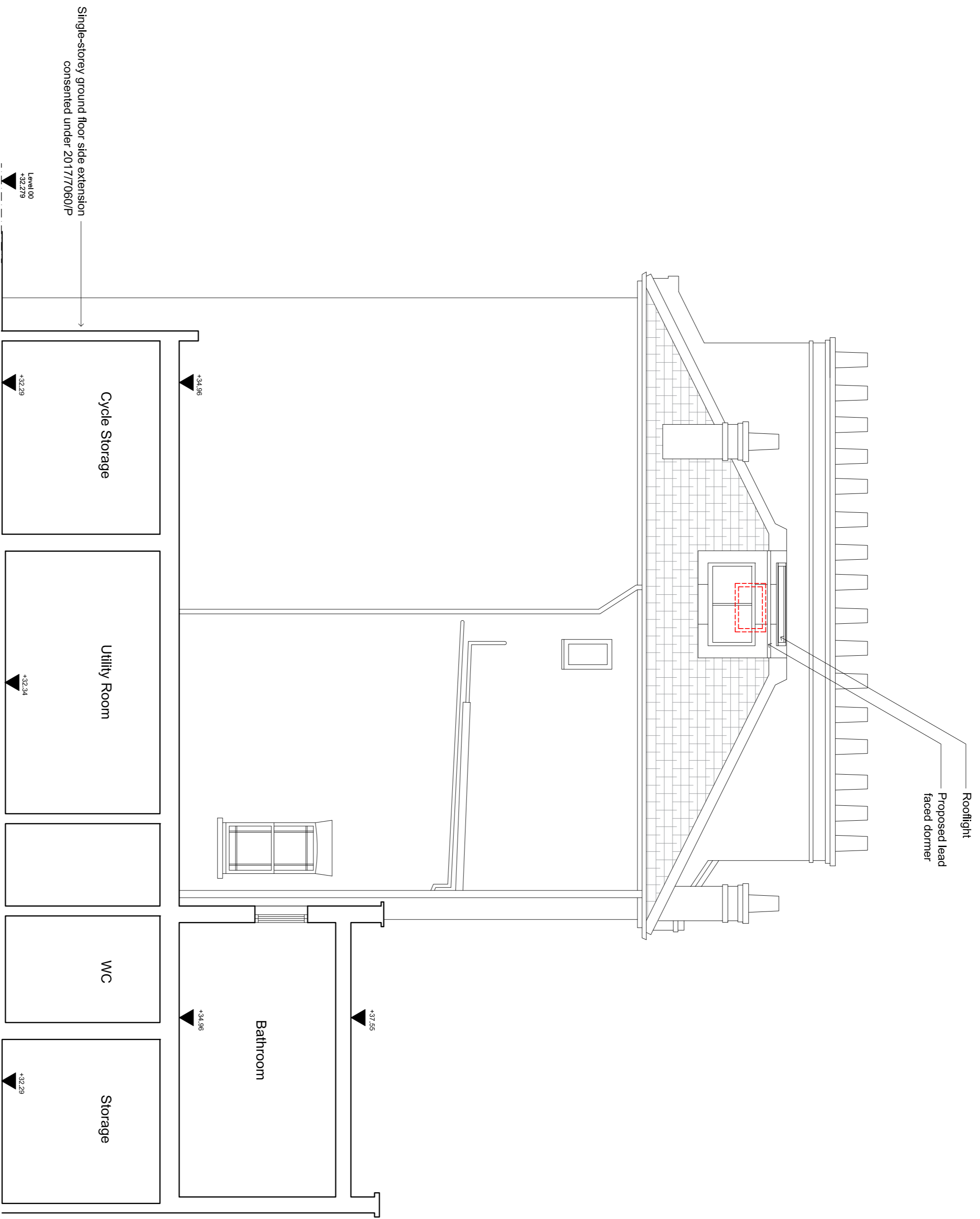

Drawn: 20/000

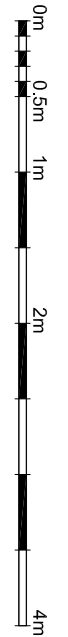

Date	Revision	Status
20/12/2017	1	Issue for Construction
20/12/2017	2	Issue for Construction
16/02/2018	3	Issue for Construction
20/02/2018	4	Issue for Construction
20/02/2018	5	Issue for Construction

EDWARD WILLIAMS ARCHITECTS
Newcombe House, 45 Notting Hill Gate, London W11 3LQ, UK
www.edwardwilliamsarchitects.com T: +44 (0)2079850540

Project: 21 Pashull Road
Subject: Side Elevation
Proposed

Scale: 1:50 @ A1 (1:100 @ A3)

Sort Code	Drawing No.	Revision
A21PR	4002	E