

KEY	
	Site Boundary
	Application of simple Georgian period skirting board (Atkey & Co detail 1720-30 sourced from Mill house, Pulborough) as shown on 1249/ SK 21
	Like for like replacement of architraves, detail shown on 1249 / SK 22 . Door linings retained.

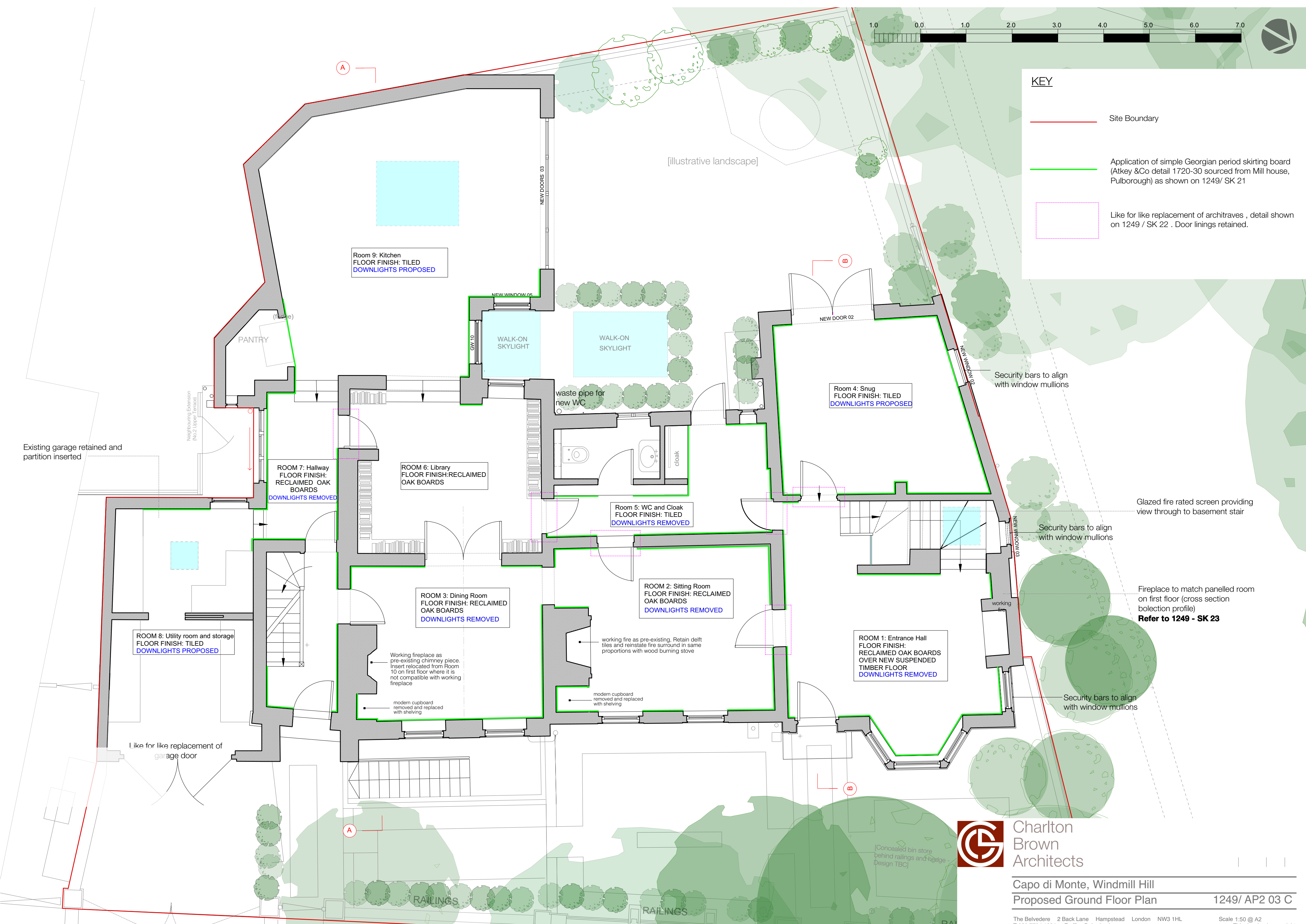

Room 9: Kitchen  
FLOOR FINISH: TILED  
DOWNLIGHTS PROPOSED

Room 4: Snug  
FLOOR FINISH: TILED  
DOWNLIGHTS PROPOSED

ROOM 7: Hallway  
FLOOR FINISH: RECLAIMED OAK BOARDS  
DOWNLIGHTS REMOVED

ROOM 6: Library  
FLOOR FINISH: RECLAIMED OAK BOARDS

Room 5: WC and Cloak  
FLOOR FINISH: TILED  
DOWNLIGHTS REMOVED

ROOM 3: Dining Room  
FLOOR FINISH: RECLAIMED OAK BOARDS  
DOWNLIGHTS REMOVED

ROOM 2: Sitting Room  
FLOOR FINISH: RECLAIMED OAK BOARDS  
DOWNLIGHTS REMOVED

ROOM 8: Utility room and storage  
FLOOR FINISH: TILED  
DOWNLIGHTS PROPOSED

ROOM 1: Entrance Hall  
FLOOR FINISH: RECLAIMED OAK BOARDS  
OVER NEW SUSPENDED  
TIMBER FLOOR  
DOWNLIGHTS REMOVED

Working fireplace as pre-existing chimney piece. Insert relocated from Room 10 on first floor where it is not compatible with working fireplace

modern cupboard removed and replaced with shelving

working fire as pre-existing. Retain delft tiles and reinstate fire surround in same proportions with wood burning stove

modern cupboard removed and replaced with shelving

Security bars to align with window mullions

Security bars to align with window mullions

Glazed fire rated screen providing view through to basement stair

Fireplace to match panelled room on first floor (cross section bolection profile)  
**Refer to 1249 - SK 23**

Security bars to align with window mullions

Like for like replacement of garage door



Charlton Brown Architects

Capo di Monte, Windmill Hill  
Proposed Ground Floor Plan

1249/ AP2 03 C

The Belvedere 2 Back Lane Hampstead London NW3 1HL  
T 020 7794 1234 E office@charltonbrown.com

Scale 1:50 @ A2  
This drawing is copyright