

Building buttress
To Architects details

Waterproofing
To Specialist's design

Building A edge
To Architects details

Armrest in background

Proposed seating type 2 - FSC certified timber Camden Seat Type 2 with armrests
Note: detailed design and fixing to be developed by manufacturer
NBS: Q21.221B

Illustrative steel support
To Seat manufacturer design

Illustrative fixing
To Seat manufacturer specification

Brick wall
To Architects details and specifications

Building A wall
To Architects details

Slot drain
To Engineers specification

Proposed PT3 - 200x100x65mm blue diamond chequered brick paving
NBS: Q24.122A

Paving build-up
To Engineers specification

Indicative connection to slot drain
To Engineers design

Lightweight infill to support planter and drainage gully
To Engineers specification

Indicative location and size of planter drainage gully
To Engineers detail and specification

Void former
To Engineers specification

Building capping beam
To Architects detail

NOTES:
- DRAINAGE TO BE INSTALLED DURING THE CONSTRUCTION OF THE SEATING WALL TO ALLOW FOR FUTURE USE AS PLANTER
- VOID FORMER TO BE INSTALLED TO PREVENT DEBRIS INGRESS AND TO PROVIDE ADDITIONAL SUPPORT TO SINGLE SKIN BRICK WALL

9 Seating Type 2 - Detail Section
L.434 SCALE 1:5@A1

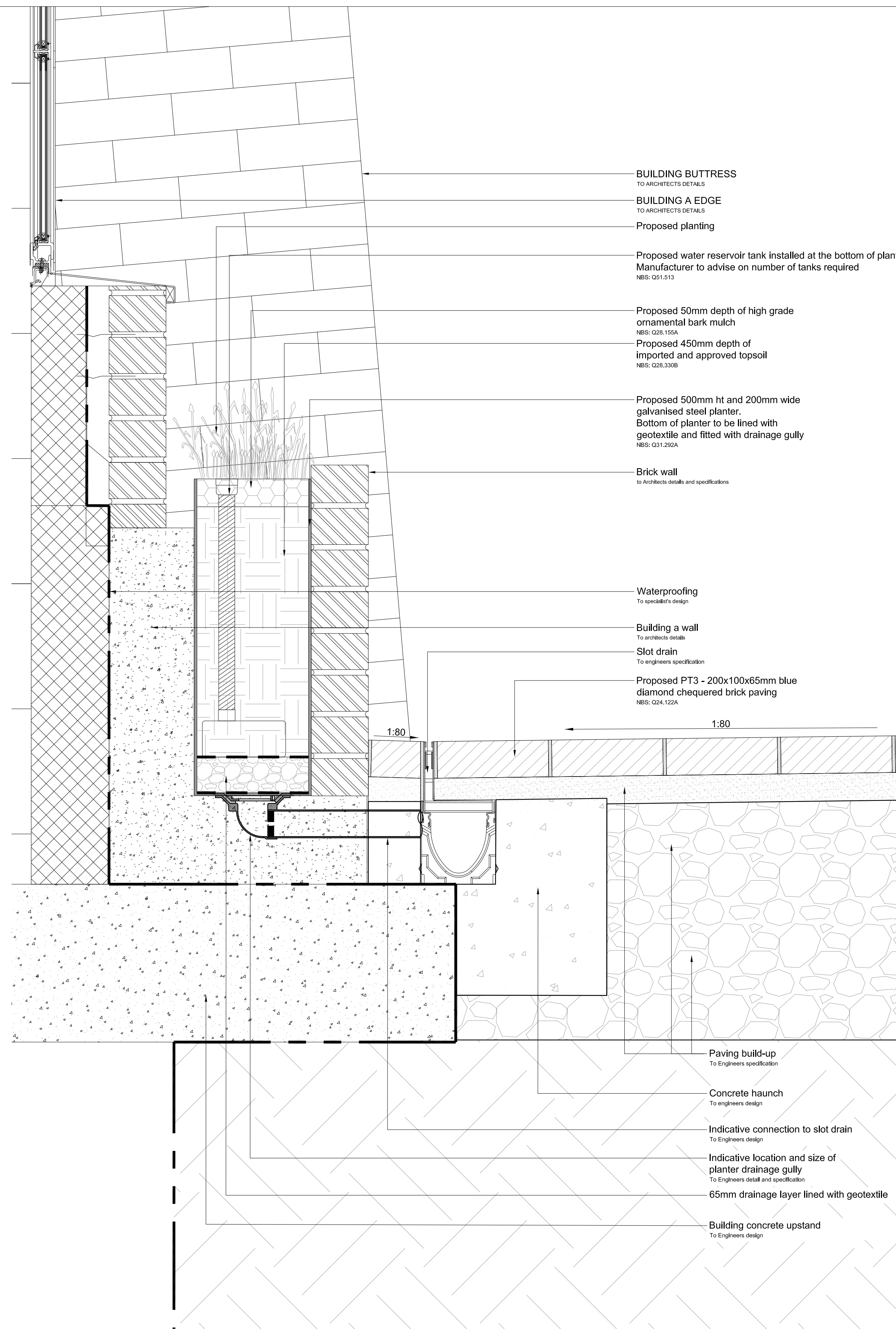

BUILDING BUTTRESS
TO ARCHITECTS DETAILS

BUILDING A EDGE
TO ARCHITECTS DETAILS

Proposed planting

Proposed water reservoir tank installed at the bottom of planter
Manufacturer to advise on number of tanks required
NBS: Q51.513

Proposed 50mm depth of high grade ornamental bark mulch
NBS: Q28.155A

Proposed 450mm depth of imported and approved topsoil
NBS: Q28.330B

Proposed 500mm ht and 200mm wide galvanised steel planter.
Bottom of planter to be lined with geotextile and fitted with drainage gully
NBS: Q31.292A

Brick wall
To Architects details and specifications

Waterproofing
To specialist's design

Building A wall
To architects details

Slot drain
To engineers specification

Proposed PT3 - 200x100x65mm blue diamond chequered brick paving
NBS: Q24.122A

Paving build-up
To Engineers specification

Concrete haunch
To engineers design

Indicative connection to slot drain
To Engineers design

Indicative location and size of planter drainage gully
To Engineers detail and specification

65mm drainage layer lined with geotextile

Building concrete upstand
To Engineers design

10 Furniture Type 6 - Detail Section
L.434 SCALE 1:5@A1

General Notes:

- This drawing is the property of fabrik. It must not be copied or reproduced without written consent.
- This drawing shall be read in conjunction with all relevant contract drawings and fabrik Landscape Specification with any conflicting information to be brought to the attention of fabrik before work commences
- All dimensions are in millimetres unless otherwise specified
- All levels in metres unless otherwise specified
- Only figured dimensions are to be taken from this drawing. All contractors must visit site and be responsible for taking and checking all dimensions related to the works shown on the drawing.
- All dimensions and sizes of units to be verified by the contractor on shop drawings for each element before the commencement of works
- All construction base layers to engineer's specification
- All steelwork to be galvanised unless otherwise stated
- All concrete structures/members to structural engineer's/architect's detail
- All supports/fixings to manufacturer's/engineer's detail
- All exposed concrete faces to waterproof engineer's/contractor's details
- All tree supporting measures to contractor design and approved by Fabrik Ltd. and the engineer
- All eyebolts to be stainless steel unless otherwise specified and to engineers detail
- All trees/shrubs/hedges planted at nursery level
- Falls are for guidance purposes only, setting out shall be to spot levels
- All concrete paving and associated foundation to comply with BS 7533:2006 Pavements constructed with clay, natural stone or concrete pavers;

Location Plan:

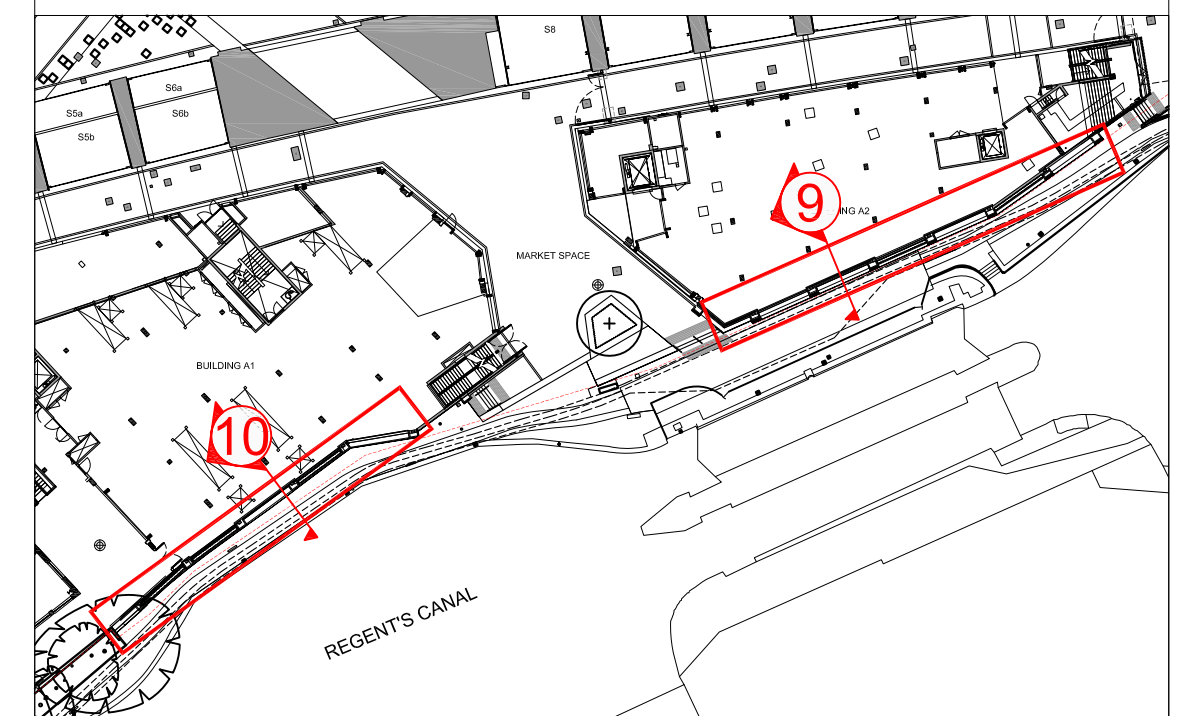

No.	Date	Reason	Author
P1	23.04.18	Issued for planning approval	mn
C2	28.07.17	PT3 Paving Build-up Updated Per Engineers Information	mn
C1	12.04.17	Issued for Construction	mn

Revisions

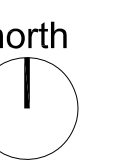

fabrik

First Floor
4-8 Emerson Street
London
SE1 9DU

T: 0207 620 1453
F: 0207 261 9126
E: london@fabrik.com
W: www.fabrik.com

Project
Camden Lock Village, Camden
for MACE

Drawing
Typical Detail - Seating Type 2 and
Furniture Type 6

Scale	Date	Checked	Drawn
1:5 @ A1	March '17	NB	MN

Drawing No.	Revision
D2456 L.434	P1

<input type="checkbox"/> Preliminary	<input type="checkbox"/> Issued for Design/Information
<input checked="" type="checkbox"/> Issued for Planning Approval	<input type="checkbox"/> Issued for Tender
<input type="checkbox"/> Issued for Construction	<input type="checkbox"/> As Built

Drawing sheet size - A1

Copyright Reserved ©