





BUILDING DESIGN PARTNERSHIP LTD SHALL HAVE NO RESPONSIBILITY FOR ANY USE MADE OF THIS DOCUMENT OTHER THAN FOR THAT WHICH IT WAS PREPARED AND ISSUED.  
 ALL DIMENSIONS SHOULD BE CHECKED ON SITE.  
 DO NOT SCALE FROM THIS DRAWING.  
 ANY DRAWING ERRORS OR DIVERGENCES SHOULD BE BROUGHT TO THE ATTENTION OF BUILDING DESIGN PARTNERSHIP LTD AT THE ADDRESS SHOWN BELOW.

**NOTES**

-  EXISTING SECONDARY STRUCTURE TO BE REMOVED. REMAINING ADJACENT CONSTRUCTION/FINISHES TO BE FULLY REPAIRED
-  NEW OPENING TO BE CREATED IN EXISTING WALL. REMAINING ADJACENT CONSTRUCTION/FINISHES TO BE FULLY REPAIRED
-  EXISTING BLOCKED OPENING TO BE OPENED UP. REMAINING ADJACENT CONSTRUCTION/FINISHES TO BE FULLY REPAIRED
-  EXISTING LIFT, RADIATORS, WINDOWS, LIGHT FITTINGS, FIXED AND LOOSE FURNITURE AND REDUNDANT SERVICES TO BE CAREFULLY REMOVED

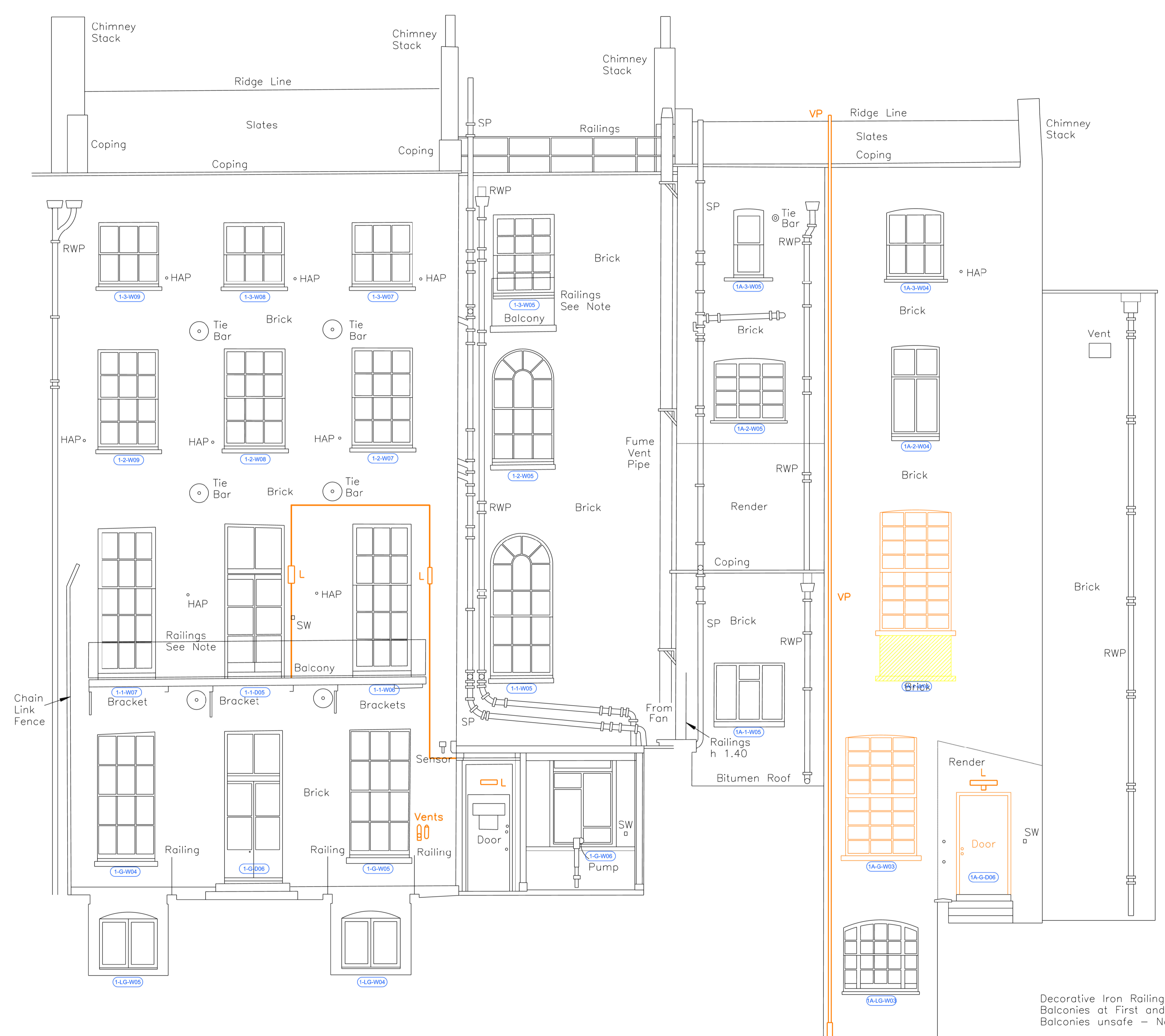

REVISION/DESCRIPTION	DRAWN	CHECKED	DATE

A - For Planning and Listed Building Consent Application LBE\_MB 01/06/17  
 FIRST ISSUE - FOR COMMENTS LB MB 12/05/17



**BDP.**

16 Brewhouse Yard  
 Clerkenwell  
 London, EC1V 4LJ  
 United Kingdom  
 T +44 (0)20 7812 8000  
 F +44 (0)20 7812 8399  
 www.bdp.com

British Museum  
 Perimeter Properties Refurbishment

P2007246

DRAWING TITLE: 1-1A Montague Street Strip out Rear Elevation  
 SCALE: 1:50@A1

DATE: May 17

DRAWING NO: (18)AE002  
 REVISION: A

