

Notes:
 This document is the property of John Rowe & Parr Architects and is not to be reproduced, stored in a retrieval system, or transmitted in any form or by any means, electronic, mechanical, photocopying, recording, or by any information storage and retrieval system, without the prior written permission of John Rowe & Parr Architects. This document is intended for the use of the client and is not to be used for any other purpose. The client acknowledges that the use of this document is at their own risk and that they are responsible for ensuring that the information contained herein is accurate and complete. The client also acknowledges that the use of this document is subject to the terms and conditions of the contract between the client and John Rowe & Parr Architects.

Revision notes:
 1. Initial design
 2. Final design

DATE: 11/11/14	11/11/14
DESIGNED BY: JRP	
CHECKED BY: JRP	
DATE: 11/11/14	
SCALE: 1:50	
TITLE: YORK STONE	
PROJECT: 108 ST. PANCRAS WAY	
CLIENT: MR & MRS ROWE PARR	
PLANNING	

108 ST PANCRAS WAY LONDON NW1 9NB

Method statement for repair of damaged stone slabs to external forecourt of property

- 1.0 In preparation of repair works, support all existing stone slabs with Acrow Props adjacent to where works are to be carried out. Allow for two stones to be supported at any one time.
- 2.0 Once individual stone is securely supported, carefully remove existing and defective timber lintels fixed to brickwork of external wall in basement. Replace with L shaped angle steel bracket 75 x 75 fixed with 100mm chemical bolts at 300 centres.
- 3.0 Upon completion of item 2.0 above. Examine and repair any defective brickwork support on other end of stone slab.
- 4.0 Replace one broken slab with new reclaimed stone slab to match. Seal all joints between all slabs with waterproof cement grout mortar. Clean all surfaces upon completion.
- 5.0 Replace the dislodged and damaged stone to corner of site with stone pieces kept for repair. Support stone pieces with steel plates carefully secured into brickwork below.
- 6.0 Remove the small concrete step to shop front and replace with new reclaimed stone slab to match.
- 7.0 Lift and set aside all small stone slabs to lower external perimeter step, make good brickwork below and replace slabs to existing positions.

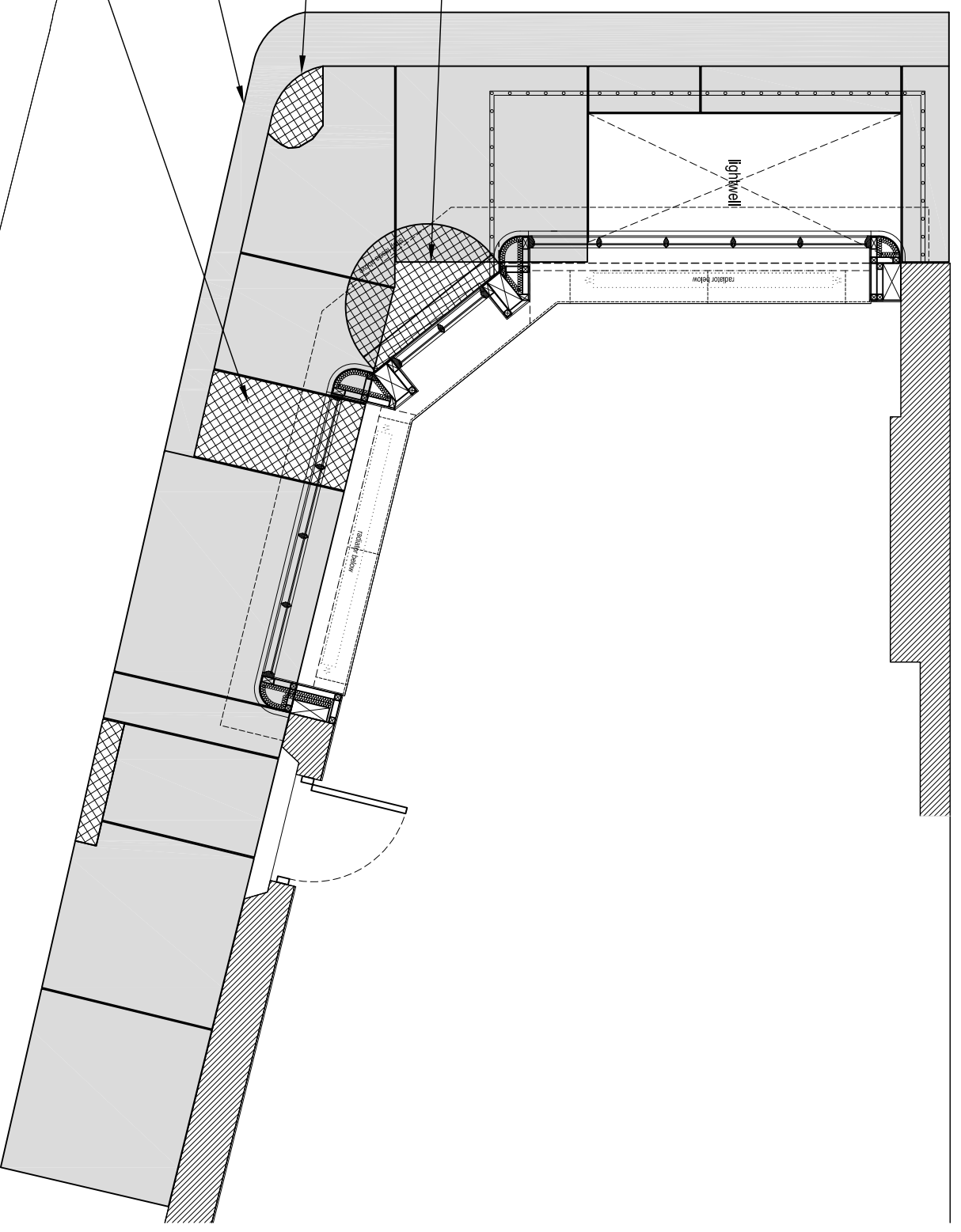

REPLACE WITH RECLAIMED NATURAL STONE SLAB

REPLACE AND SECURE BROKEN CORNER OF EXISTING STONE SLAB

LIFT AND RE-BED EXISTING STONES TO LOWER STEPS

REPLACE WITH RECLAIMED NATURAL STONE SLAB

EXISTING STONE

RECLAIMED STONE

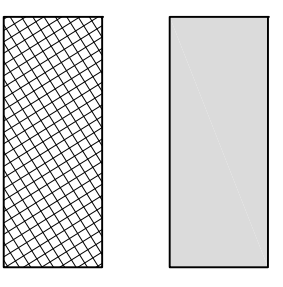

York Stone forecourt - 1:50 @ A3