

## CONSENT TO PLACE AMENITIES ON THE PUBLIC HIGHWAY

The Council of the London Borough of Camden under the provisions of the Highways Act 1980, hereby authorises the person(s) or company named below to place tables and chairs on the public highway for a period of one year from the date of this licence.

Full name of Licencee **PRET A MANGER (EUROPE) LTD**

Name/ Address of  
Premises **Pret A Manger**

**100 Tottenham Court Road, London, W1T 4TT**

Nature and number of  
amenities **15 TABLES, 30 CHAIRS AND 7 BARRIERS**

Days/Times to be placed  
on the highway **Monday to Thursday 08:00 - 23:00**  
**Friday - Saturday 08:00 - 23:30**  
**Sunday 08:00 - 22:30**

This consent is granted subject to the Council's Standard Conditions and to any special condition(s) given below. This licence is not transferable.

The amenities must not be placed on the Public Highway before the start of the time specified.

This consent must be displayed in a prominent position in the window of the premises.

In the event of any complaint about the amenities placed on the public highway under the grant of the consent, please contact London Borough of Camden.

Name **Barry May**

Telephone  
Number **020 7974 4444**

Signed



Date **23/04/2018**

For Director, Environment Department  
Duly authorised by the Council for this purpose)

**This consent is valid from 21 May 2018 to 21 May 2019**

## CONDITIONS OF CONSENT

1. Except with the previous written consent of the Council, only the amenities detailed on the consent are to be placed on the public highway, and the amenities detailed are only to be placed on the public highway between the times detailed on the consent.
2. It is intended that the Council will mark a defined area on the public highway. When these markings are provided the amenities must be sited within them but, in any event, a minimum clear footway width of 1.8 metres is to be provided at all times for through pedestrian movement.
3. The applicant shall indemnify the Council from and against any claim in respect of any injury damage or loss arising directly or indirectly out of the grant of this consent and the use by the public of the amenities.
4. The applicant shall be responsible for cleaning the public highway used under consent at the end of each day and, if requested to do so by the Council, provide mobile litter bins on the public highway, in such positions and for such time periods as the Council may specify.
5. The applicant shall remove the amenities from the public highway immediately if requested to do so by the Council, its agents or contractors or licensees or by a statutory undertaker, its agents or contractor, or by a Police officer. If unimpeded access to the surface of the public highway is required to enable the Council, the Statutory Undertaker or the Police to carry out any of their statutory duties or to enable a licensee of the Council to put into effect the terms of the license. The applicant shall not reposition the amenities on the public highway until notified by the Council, the Statutory Undertaker, or the Police, that he/she may do so.
6. If the Council serves a Notice on the applicant requiring him/her to take such steps as are necessary to remedy any breach of the terms of this consent, and the applicant fails to comply with the Notice, the Council may itself take the steps required by the Notice and recover from the applicant any expenses incurred.
7. The Council may withdraw this consent at any time upon giving the applicant seven days notice in writing. Upon withdrawal of the consent the applicant shall remove the amenities from the public highway and, in default, the Council may remove the amenities and recover from the applicant its costs in so doing.
8. Any Notice to be given to the applicant shall be deemed to be sufficiently served if addressed to the applicant and sent by post or left at the premises.
9. The consent hereby granted is for a period of one year from the date of the decision letter. At the end of the one year period, an application for renewal of the consent must be made.
10. This license must be displayed in a prominent position in the window of the premises, so that users of the amenities may see it. Failure to do so will result in the withdrawal of the license by the Council.
11. The amenities must be removed from the public highway at the end of the permitted period each day. (To be used in all cases, except where consent for picnic tables is granted).
12. The applicant shall ensure that the level of noise created by use of these facilities shall not reach a level that will cause a nuisance.
13. Uniform tables and chairs must be used.
14. No items may be placed in front of any adjoining property
15. This consent excludes A boards and any other amenities that are not specified on the license.
16. The footway must not be obstructed by patrons standing between tables, chairs and the kerb.
17. The applicant shall not in any way interfere with the surface of the public highway.

### **STANDARD INFORMATIVE**

**This consent is without prejudice to, and shall not be construed as derogating from, any of the rights, powers and duties of the Council pursuant to any of its statutory functions or in any other capacity and, in particular, shall not restrict the Council from exercising any of its powers and duties under the Highways Act 1980 (as amended).**

Date: 23/04/2018  
Ref: 2018/1437/TC  
Enqs: Paru Bhudia  
Tel: 0207 974 4444

**Contact Camden**  
Corporate Services Directorate  
London Borough of Camden  
Camden Town Hall  
Judd Street  
London  
WC1H 9JE

Tel: 020 7974 4444  
Fax: 020 7974 1898

[www.camden.gov.uk](http://www.camden.gov.uk)

Planning Potential  
C/o Tom Davis  
Magdalen House  
148 Tooley Street  
London  
SEL 2TU

Dear Tom Davis

**Licence to Place tables and Chairs on the Public Highway**

I enclose a copy of your current consent to place 15 Tables, 30 Chairs and 7 Barriers outside Pret A Manger, 100 Tottenham Court Road, London, W1T 4TT.

The consent permits you to have these items on the public highway between

Monday to Thursday 08:00 - 23:00  
Friday - Saturday 08:00 - 23:30  
Sunday 08:00 - 22:30

The consent requires renewal on 21 May 2019. You will need to make an application to renew your consent a minimum of 8 weeks before your consent expires.

I would ask you to note the enclosed conditions of the consent and ensure that they are complied with at all times. Any special conditions are detailed below.

Should you wish to discuss any aspect of either the consent or the conditions, please contact Paru Bhudia on the above 4444.

Yours sincerely,

**Afshar Ahmad**  
**Customer Service Processing Manager**

Enclosure



NO obj - Highway  
NO obj - Tran

APPLICATION TO PLACE AMENITIES ON THE PUBLIC HIGHWAY

DATE CONSULTATION ENDS: 18 APRIL 2018

## PUBLIC CONSULTATION

### THIS IS YOUR OPPORTUNITY TO COMMENT

The council has received an application to place tables and chairs on the public highway under the highways act 1980 outside the premises below. The details of the application are as follows:

Pret A Manger  
100 Tottenham Court Road  
London  
W1T 4TT

**PROPOSAL: TO PLACE 15 Tables, 30 Chairs and 7 Barriers**  
**Monday to Thursday 08:00 - 23:00**  
**Friday - Saturday 08:00 - 23:30**  
**Sunday 08:00 - 22:30**  
**Renewal Application**  
**ON THE PUBLIC HIGHWAY**

Any consent granted would only be valid for one year. If you have any comments or objections to this application please send them before **18 APRIL 2018** to:

Tables and Chairs Team

Contact Camden

Corporate Services Directorate

London Borough Of Camden

Camden Town Hall

Judd Street

London

WC1H 9JE

Alternatively, you may email your comments to  
[tablesandchairslicence@camden.gov.uk](mailto:tablesandchairslicence@camden.gov.uk) quoting our ref: 2018/1437/TC

Due to the provisions of the Local Government (access to information) Act 1985, you cannot be assured of any confidentiality, as any correspondence received will be available for public inspection. If you wish to comment on any other issue please do so in a separate letter.



Date: 21/03/18  
Ref: 2018/1437/TC  
Enqs: Paru Bhudia  
Tel: 0207 974 4444

Planning Potential  
C/o Tom Davis  
Magdalen House  
148 Tooley Street  
London  
SEL 2TU

**Contact Camden**  
Corporate Services Directorate  
London Borough of Camden  
Camden Town Hall  
Judd Street  
London  
WC1H 9JE

Tel: 020 7974 4444  
Fax: 020 7974 1898

[www.camden.gov.uk](http://www.camden.gov.uk)

Dear Tom Davis

**Application for consent to put tables and chairs on the public highway**

I enclose a copy of a notice about your application to put 15 Tables, 30 Chairs and 7 Barriers outside Pret A Manger 100 Tottenham Court Road, London, W1T 4TT.

Please check that the details are correct and make sure that you put it in an obvious place in your window as soon as possible.

If you don't put the attached notice in your window during the 28-day public consultation period, the consultation may not be valid, which could affect your application.

**During the consultation period you are not permitted to place any amenities on the public highway without a previous valid consent.**

If you want to discuss this, please contact Paru Bhudia on the number above.

Yours sincerely,

**Afshar Ahmad**  
**Customer Service Processing Manager**





## Application Form to Place Tables and Chairs on the Highway

Highways Act 1980 (as amended by the Local Government Act– Miscellaneous Provisions Act 1982)

### Please read the following instructions first

Before completing this form please read the associated notes. If you are completing this form by hand please write legibly in block capitals. In all cases ensure that your answers are inside the boxes and written in black ink. Use additional sheets if necessary. Please complete all sections including the indemnity form.

You may wish to keep a copy of the completed form for your records.

Please send your completed application form to:

Customer Support Team  
 Planning and Public Protection Division  
 London Borough of Camden  
 5<sup>th</sup> Floor Town Hall Extension  
 Argyle Street  
 London  
 WC1H 8EQ

Part One: Contact Details			
<input checked="" type="radio"/> Mr/ Mrs/ Miss/ Ms (please circle) Other Title (please state)	First names	Tom	
Surname	Daytime contact telephone number(s)	Davies 0207 357 8000	
Current postal address if different from premises address	Planning potential Magdalen house 148 Tooley Street		
Post Town	London	Postcode	SE1 2TV
E-mail address	Tom@planningpotential.co.uk		
Postal Address of Premises (if tables and chairs to be placed on more than one road please state name)			
Pret A Manger 100 Tottenham Court Road London			
Post Town	London	Postcode	W1T 4TT

### Part Two: Application Details

Please state the opening hours of your business:  
**Mon-Thu 08:00 - 23:00 Fri-Sat 08:00 - 23:30**  
**Sun 08:00 - 22:00**

Days and times requested to place tables and chairs on highway:  
**AS above**

Please see maximum permitted hours on guidance notes p.1.

Items to place on highway	Number
Tables	<b>15</b>
Chairs	<b>30</b>
Barriers	<b>7</b>
Umbrellas	
Picnic Tables	
Heaters (see p.3 guidance notes)	

Do you need to submit a seating plan? Please tick appropriate box.

1. Is this a renewal of your previous licence? YES  NO

If you answered 'NO' to the above question please submit a seating plan and ignore question 2.

2. Are you requesting the same number of items as on your previous licence? YES  NO

If you answered 'NO' to the above question please submit an amended seating plan

Please note: Seating plans must be detailed. Please see guidance notes p.4 for example.

### Part Three: Application Fees

The fee for processing this application is **£430 .00** per new application & **£ 380.00** per renewal application  
 Please note that Application fees are non refundable

An additional fee for **£45 per chair** is required - It is this part of the Application that will be refunded if the application is refused.

Please tick the appropriate box for your preferred method of payment:

I have attached a cheque made payable to 'London Borough of Camden'

I would like to pay via credit/debit card. Please contact me on receipt of my application

### Part Four: To be completed by Customer Support Team

Date of receipt:

Receipt no:

## Indemnity Form to Place Tables and Chairs on the Highway

Highways Act 1980 (as amended by the Local Government Act- Miscellaneous Provisions Act 1982)

Name: <i>please see enclosed letter</i>
Address:   
Contact Number(s):
Name and address of property at which tables and chairs are to be situated: <i>pret A Manger</i> <i>100 Tottenham Court Road</i> <i>London</i> <i>W1T 4TT</i>

We hereby agree to indemnify and save harmless the London Borough of Camden, their servants and agents from and against all actions in law or in equity, damages statutory or common law losses, costs, charges and expenses arising in any manner whatsoever out of the transportation, erection, dismantling and or use of tables and chairs, whether by means of defect (latent or otherwise) in the said equipment or otherwise pursuant to the authority of the London Borough of Camden above referred to arising out of works enabled by the consent.

In consideration of the London Borough of Camden authorising amenities to be placed on the highway as detailed above.

Signed: <i>Tom Davies</i>	Name: <i>Tom Davies</i>	Date: <i>06/03/2018</i>
---------------------------	-------------------------	-------------------------

(Please note that original signatures are required-photocopies are not accepted)





## VERIFICATION OF INSURANCE

### TO WHOM IT MAY CONCERN

**Insured:** PAM Group Limited and Pret A Manger (Europe) Ltd

We act as insurance brokers to the above client and in this capacity can provide brief details of their current cover details as follows:

### **PUBLIC/PRODUCTS LIABILITY**

**INSURER:** Zurich Insurance plc

**POLICY NUMBER:** GLRET1700431

**PERIOD OF INSURANCE:** 1<sup>st</sup> June 2017 to 31<sup>st</sup> May 2018

**LIMIT OF LIABILITY:** GBP 10,000,000 each and every occurrence unlimited in the period of insurance for Public Liability and in the aggregate in the period of insurance for Products Liability.

**DEDUCTIBLES:** GBP 1,000 any one Occurrence in respect of property damage and pollution clean-up costs only

This document is provided for information only and cover is subject to Insurer's policy terms, conditions, limitations and exclusions. Cover may also be subject to cancellation provisions and warranties.

The issuance of this document does not make the person or organisation to whom it has been issued an additional insured and confers no rights upon the recipient, nor does it modify in any manner the contract of insurance between the Insured and Insurers.

Without prejudice to the foregoing no assurance is given by us to the adequacy or otherwise of the sums insured /limit of liability/indemnity (as the case may be) under the insurance policies. Nor do we express any view or assume any liability as to the solvency or future ability to pay of any of the insurance companies with whom the insurance policies have been placed. In each case you must rely upon your own assessment of such matters. We cannot comment as to whether the client has done or omitted to do anything which has rendered or may render any policy of insurance (including the insurance policies noted in this document) taken out by it or by any other person in relation to any of the client's assets or liabilities void or voidable and you must similarly rely upon your own enquiries in this respect.

Lockton does not accept any liability or responsibility to any Third Party (including, but not limited to, any person to whom this document is addressed) in respect of the information provided nor do Lockton have any obligation to advise any changes to or cancellation of the insurances described.

This letter shall be governed by and shall be construed in accordance with English law and the courts of England and Wales shall have exclusive jurisdiction.

LOCKTON COMPANIES LLP  
RISK SOLUTIONS

The St Botolph Building, 138 Houndsditch, London EC3A 7AG  
Tel: 020 7933 0000 / FAX: 020 7933 0939  
[www.lockton.com](http://www.lockton.com)

A limited liability partnership registered in England & Wales at the above address. Company number: OC353198  
Authorised and regulated by the Financial Conduct Authority and a Lloyd's Broker  
A list of the designated members and individual members of Lockton Companies LLP is available for inspection at the registered office



**VERIFICATION OF INSURANCE**

We trust that this information is sufficient for your purposes however, should you require additional detail this can be provided upon agreement from our client.

**SIGNED DATED 31<sup>st</sup> May 2017**

**PRINT NAME: Emma Wedgbury For and on behalf of Lockton Companies LLP**

**SIGNED DATED 31<sup>st</sup> May 2017**

**PRINT NAME: Jack Reuter Town For and on behalf of Lockton Companies LLP**

LOCKTON COMPANIES LLP  
RISK SOLUTIONS

The St Botolph Building, 138 Houndsditch, London EC3A 7AG  
Tel: 020 7933 0000 / FAX: 020 7933 0939  
[www.lockton.com](http://www.lockton.com)

A limited liability partnership registered in England & Wales at the above address. Company number: OC353198  
Authorised and regulated by the Financial Conduct Authority and a Lloyd's Broker

A list of the designated members and individual members of Lockton Companies LLP is available for inspection at the registered office



London  
Magdalen House  
148 Tooley Street  
London SE1 2TU  
020 7357 8000

Harrogate  
14-15 Regent Parade  
Harrogate  
HG1 5AW  
01423 502115

Bristol  
13-14 Orchard Street  
Bristol  
BS1 5EH  
0117 214 1820

Customer Support Team  
Planning and Public Protection  
London Borough of Camden  
5<sup>th</sup> Floor Town hall Extension  
Argyle Street  
London  
WC1H 8EQ

6 March 2018

Our Ref: 10/1154

Dear Sir/Madam

Please see enclosed licence renewal for Pret A Manger 100 Tottenham Court Road and cheque for £1730, a copy of their public liability insurance certificate and plan. I trust this is all you need but if you have any queries please don't hesitate to contact me.

Yours sincerely,

A handwritten signature in black ink that reads "Tom Davies".

Tom Davies MRTPI

Planner

Planning Potential

London

Enc. As listed

Directors  
Helen Cuthbert | Stuart Slatter | Claire Temple | Alastair Close  
Dan Templeton  
Associate Director  
Katie Turvey

Consultant  
Caroline Dawson

Associates  
Sally Arnold | Rob Scadding | Heather Vickers | Alan Williams | David Williams

[www.planningpotential.co.uk](http://www.planningpotential.co.uk)

[info@planningpotential.co.uk](mailto:info@planningpotential.co.uk)

Planning Potential is a Limited Company registered in England No. 5419507 | Registered Office: 35 Ballards Lane, London N3 1XW





**EXTERIOR CHAIRS**

450 x 250 x 850mm powder coated metal mesh seat and backrest with a central mesh over hand strap (new edition) & 4500 x 2500 x 100mm (new edition) & 4500 x 2500 x 100mm (new edition)

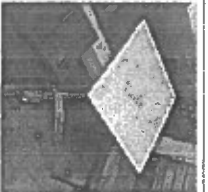
**SMALL EXTERIOR TABLES**

300 x 300 x 750mm rounded shape to table top allowing table to slide on for storage & table support & lower, tubular legs to be in 20mm dia (new edition) & 300 x 300 x 750mm (new edition)

**SEATING BALUSTRADES**

1200 wide with top of stainless steel balustrade with 30mm dia stainless steel balustrade on 400mm dia stainless steel balustrade post.

**FURNITURE - TOTAL COVERS = 30 NO.**  
 outdoor furniture to be brought in to store outside loading hours

<input type="checkbox"/>	SMALL SEATING TABLES - 1500mm x 300mm x 750mm (refer to schedule details, - no with legs to supplied where shown)
<input type="checkbox"/>	EXTERIOR CHAIRS BLACK - 500mm x 250mm x 850mm (refer to schedule details, - no with legs to supplied where shown)
<input type="checkbox"/>	SEATING BALUSTRADES - 1200mm x 300mm x 750mm (refer to schedule details, - no with legs to supplied where shown)

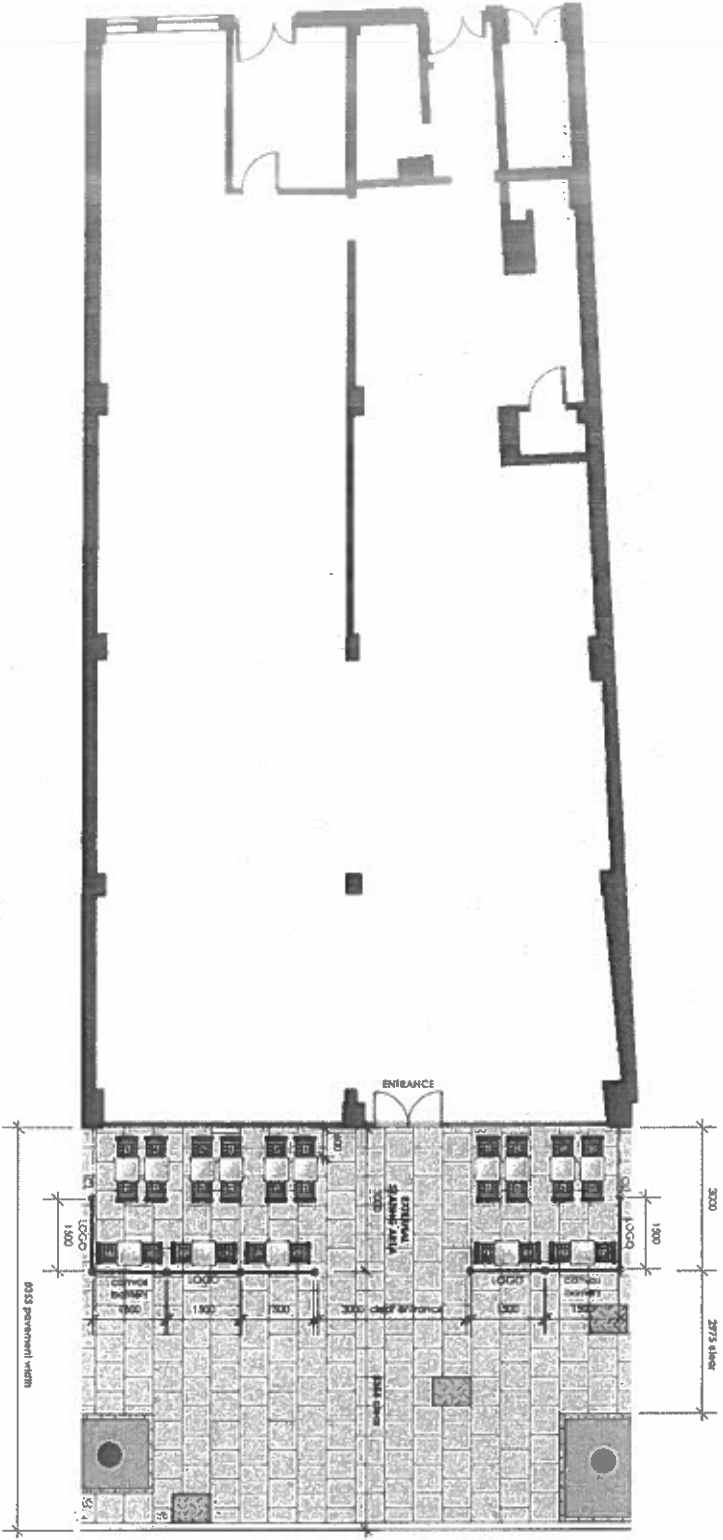

**\*PRELIMINARY\***  
 100 Tottenham Court Road  
 LONDON W1T 4RT

**TANNERdesign**  
 PROPOSED  
 EXTERIOR SEATING PLAN  
 100 TOTTENHAM COURT ROAD  
 LONDON W1T 4RT  
 DATE 08.05.15

**AS BUILT** 08.05.15 1:100

TANNERdesign  
 100 Tottenham Court Road  
 London W1T 4RT  
 020 7324 2000  
 www.tannerdesign.co.uk

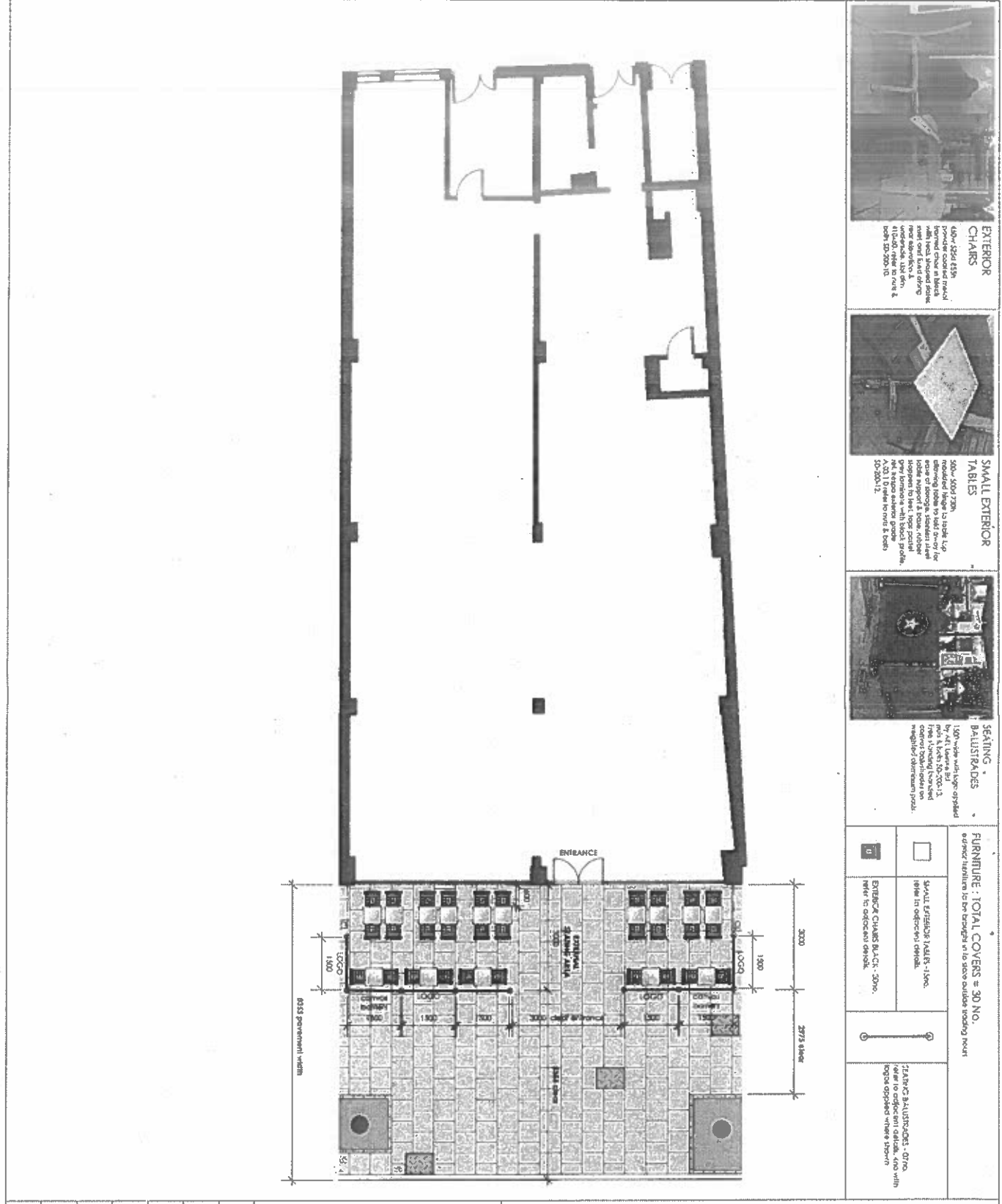



no obj.

**Bhudia, Paru**

---

**From:** Lambe, Niall  
**Sent:** 27 March 2018 16:30  
**To:** Bhudia, Paru  
**Cc:** Street Works; Dyer, Denise  
**Subject:** RE: Consultee letter for PlanningApplication Application: 2018/1437/TC

**Follow Up Flag:** Follow up  
**Flag Status:** Flagged

Hi Paru,

No objection to their licence renewal.

Many thanks,

Niall Lambe  
Streetworks Inspector

Telephone: 02079742127

-----Original Message-----

**From:** Dyer, Denise  
**Sent:** 23 March 2018 15:52  
**To:** Lambe, Niall <Niall.Lambe@camden.gov.uk>  
**Cc:** Street Works <streetworks@camden.gov.uk>; Bhudia, Paru <Paru.Bhudia@camden.gov.uk>  
**Subject:** FW: Consultee letter for PlanningApplication Application: 2018/1437/TC

Niall,

Can you please comment on the attached.

Regards

Denise Dyer  
Streetworks Operations Officer

Telephone: 020 7974 6954

-----Original Message-----

**From:** Bhudia, Paru  
**Sent:** 21 March 2018 12:27  
**To:** Street Works <streetworks@camden.gov.uk>  
**Subject:** Consultee letter for PlanningApplication Application: 2018/1437/TC

Please find attached Consultee letter for PlanningApplication application 2018/1437/TC

Y467680



po do)

**Bhudia, Paru**

---

**From:** Duffy, John  
**Sent:** 05 April 2018 12:52  
**To:** Bhudia, Paru  
**Subject:** 100 Tottenham Court Rd re Obs

Hi Paru,

I've reviewed the plans and documents that have been submitted in support of tables and chairs application 2018/1437/TC for Pret A Manger, 100 Tottenham Court Road, London, W1T 4TT and have the following observations.

This is a renewal application for the placing of 15 tables, 30 chairs (2 per table), and 7 barriers outside the premises on Tottenham Court Road.

The submitted plan indicates that there is an effective footway width of 3m past the tables and chairs zone, which is sufficient for pedestrians to pass unhindered on this busy shopping street.

Therefore I have no objections on transport grounds.

I trust that this is helpful. Please let me know if you have any queries.

Kind regards,

John Duffy  
Transport Planner  
Regeneration and Planning  
Supporting Communities  
London Borough of Camden

Telephone: 020 7974 3343  
Web: [camden.gov.uk](http://camden.gov.uk)  
5th Floor  
5 Pancras Square  
London N1C 4AG

Please consider the environment before printing this email.

