

Existing window to be removed and brickwork under to be removed to allow for new door with black painted iron railing juliet balcony. New door to be of timber construction to match existing windows in style, construction and finish.

Skylight to new roof construction

Existing bay window projection to be demolished at upper and lower ground levels shown blue dashed. New rear extension to upper and lower ground floors. Extension to be of brick construction. Brick to match the existing. New black metal framed windows to extension.

1 PROPOSED FIRST FLOOR PLAN
Scale: 1:50

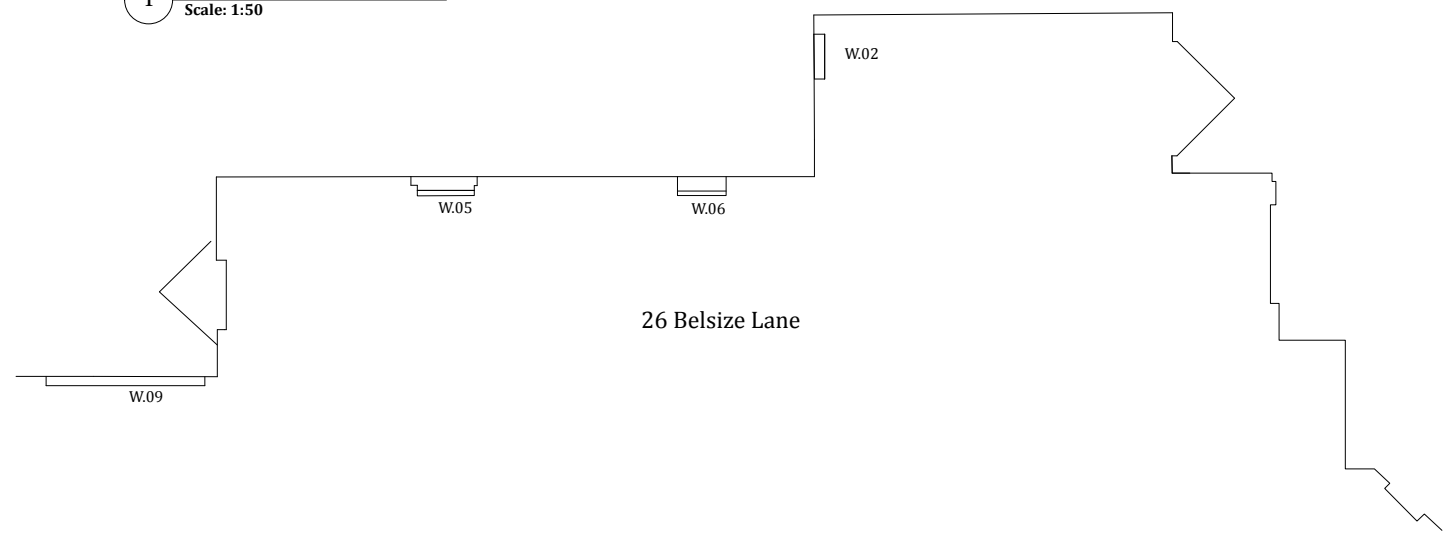

- LEGEND**
- EXISTING WALLS
 - EXISTING WALLS TO BE DEMOLISHED
 - NEW WALLS

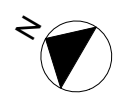

ISSUE:	DATE:	COMMENT:
D	March 2018	ISSUE FOR FULL PLANNING APPLICATION
C	February 2018	ISSUE FOR FULL PLANNING APPLICATION
B	September 2017	ISSUE FOR FULL PLANNING APPLICATION
A	August 2017	ISSUE FOR PRE PLANNING APPLICATION
-	May 2017	ISSUE FOR PRE PLANNING APPLICATION

CallenderHoworth		Morelands 5-23 Old Street London EC1V 9HL T: 020 7336 8560 F: 020 7549 2152 W: www.callenderhoworth.com	
Job no. 1216	Job title 24 Belsize Lane London NW3 5AB		
Drawing no. 815	Drawing title PROPOSED FIRST FLOOR PLAN		
Scale 1:50	Size A1	Drawn ML	Revision D

All works to be in accordance with relevant standards, British building codes, and other relevant codes, and with manufacturers recommendations and instructions. All dimensions to be checked on site. Do not scale from this drawing.