

20 / 22 Belsize Lane

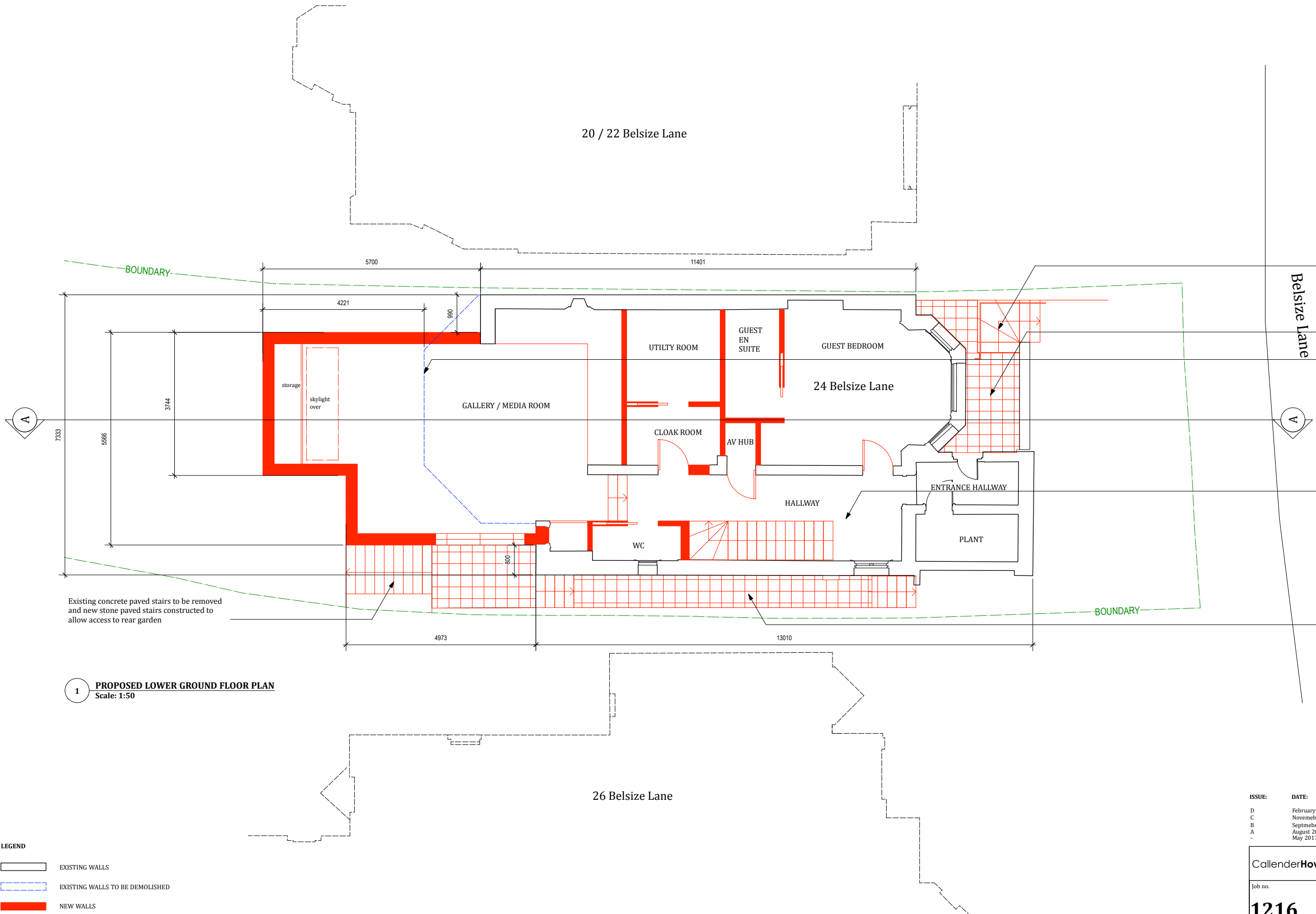

Belsize Lane

- Existing concrete paved stairs to be removed and new stone paved stairs constructed to same location.
- Existing concrete paving to be replaced with new stone paving.
- Existing bay window projection to be demolished at upper and lower ground levels shown blue dashed. New rear extension to be of brick construction. Brick to match the existing. New black metal framed windows to extension.
- Existing front lower ground floor level to be lowered by approximately 185mm to allow for 2500mm ceiling height. Existing rear lower ground floor level to be lowered by approximately 700mm to allow for 3000mm ceiling height.
- Existing concrete paving to be replaced with new stone paving.

1 PROPOSED LOWER GROUND FLOOR PLAN
Scale: 1:50

- LEGEND**
- EXISTING WALLS
 - EXISTING WALLS TO BE DEMOLISHED
 - NEW WALLS

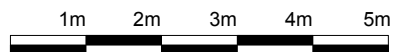

ISSUE:	DATE:	COMMENT:
D	February 2018	ISSUE FOR FULL PLANNING APPLICATION
C	November 2017	ISSUE FOR FULL PLANNING APPLICATION
B	September 2017	ISSUE FOR FULL PLANNING APPLICATION
A	August 2017	ISSUE FOR PRE PLANNING APPLICATION
-	May 2017	ISSUE FOR PRE PLANNING APPLICATION

CallenderHoworth		Morelands 5-23 Old Street London EC1V 9HL		T: 020 7336 8560 F: 020 7549 2152 W: www.callenderhoworth.com	
Job no.	Job title				
1216	24 Belsize Lane London NW3 5AB				
Drawing no.	Drawing title				
813	PROPOSED LOWER GROUND FLOOR PLAN				
Scale	Size	Drawn	Revision		
1:50	A1	ML	D		

All works to be in accordance with relevant standards, British building codes, and other relevant codes, and with manufacturers recommendations and instructions. All dimensions to be checked on site. Do not scale from this drawing.