

Disclaimer

1. Do not scale from drawings.
2. All dimensions must be checked on site and discrepancies verified with the Architect.
3. Unless shown otherwise all dimensions are to structural surfaces and are in mm.
4. Any discrepancies between the Engineer's and Architect's drawings must be verified with the Architect.
5. This drawing is only for the status shown below and should not be used for any other purpose.
6. To be read with all Contract Documents.

General Notes

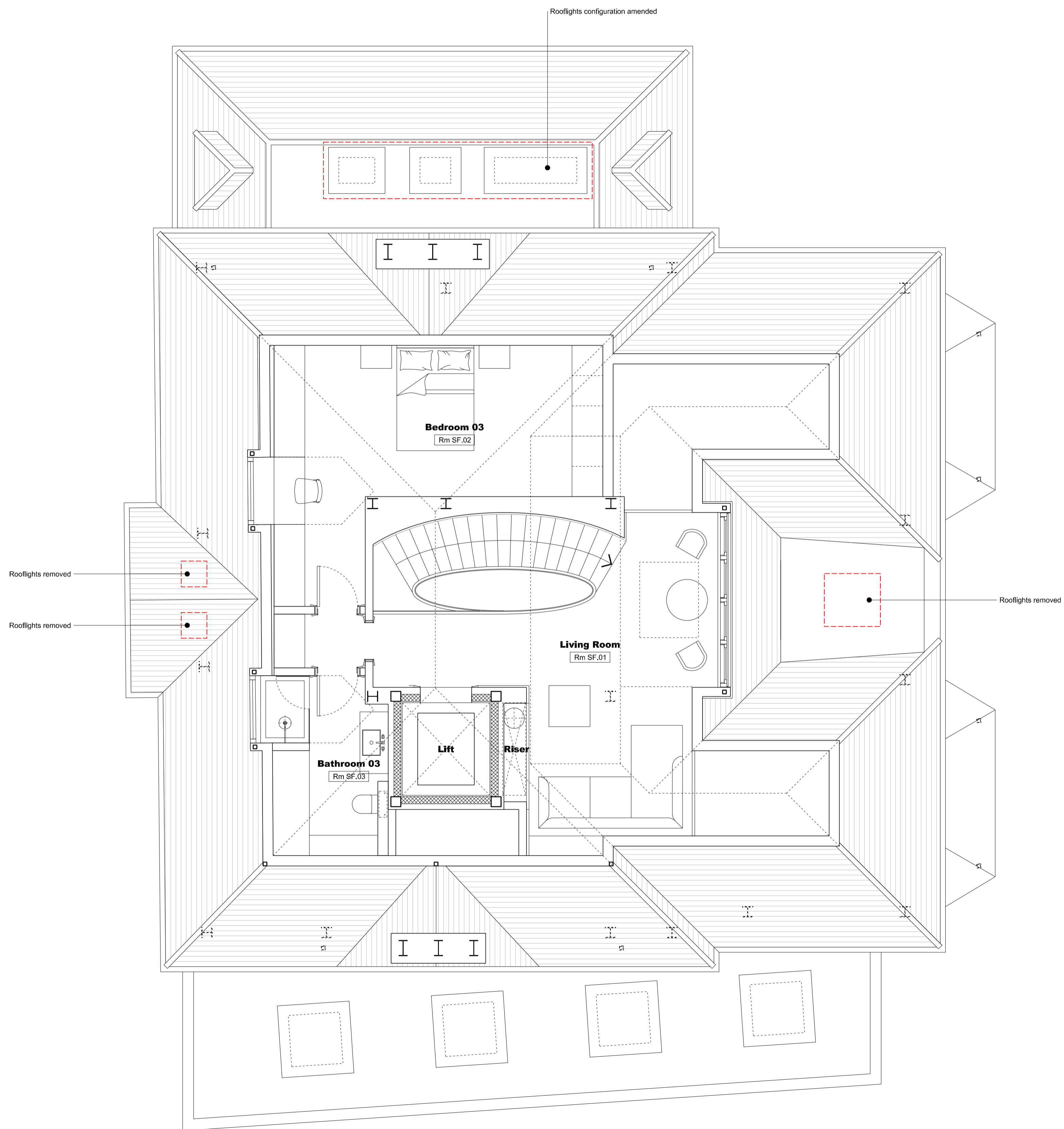

Rev.	Date	Description
A	05/02/18	Issued for Planning

Key/Location

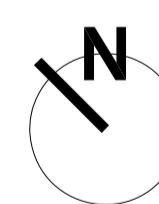

JASON GOOD ARCHITECTURE

The Old Stables
 Danmore Lane
 South Godstone
 Surrey, RH9 8JF
 T: 07901718877
 www.jasongood.uk.com copyright of Jason Good Architecture

ISSUED FOR PLANNING			
Project	36 Heath Drive NW3 7SD		Project No. 166
Client	T Sanjay and Seema Wadhvani		
Date	05/02/2018	Drawn	Revision
Scale / Format	1:50 / A1_1:100/A3	Checked	A
CAD Reference	-	Approved	
Drawing Name	Proposed	Drawing No.	F(02)_103
Second Floor Plan			