

Notes:
 This drawing is the property and copyright of John Kerr Associates, and written consent must be obtained before divulging to a third party or copying whole or part of the drawing by any method whatsoever.
 All dimensions are to be checked on site prior to construction.
 Any discrepancies are to be reported to the architect before works commence.
 All dimensions are in millimeters.
 Do not scale dimension.
 This drawing is to be read in conjunction with the specification and with all relevant consultants' specialists' drawings and/or documents.
 All relevant Statutory Approvals to be obtained before works commence.

revision	date	comments

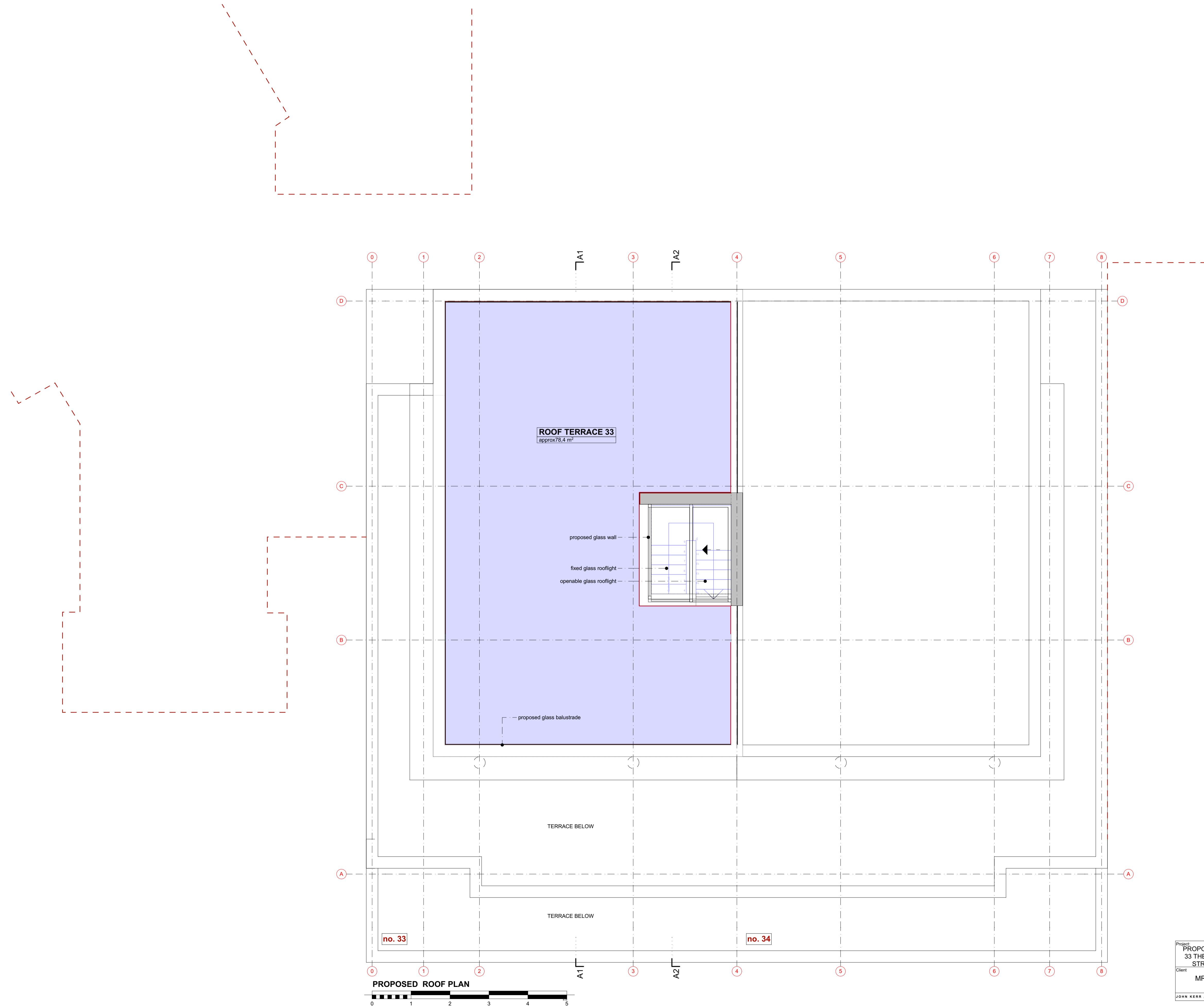

Project: PROPOSED ROOF TERRACE 33 THE PANORAMIC, POND STREET LONDON NW3	Client: MR JOHN KEEVILL	Drawing: PROPOSED ROOF PLAN	Scale: 1:50@A1, 1:100@A3	Date: NOVEMBER 2017	Drawn: PK
			No: 486/P/10/A		
JOHN KERR ASSOCIATES 57 CAMDEN MEWS LONDON NW1 9BY TEL 020 7259 2764 FAX 020 7259 2766 WWW.JOHNKERRASSOCIATES.COM					