

MANSFIELD ROAD

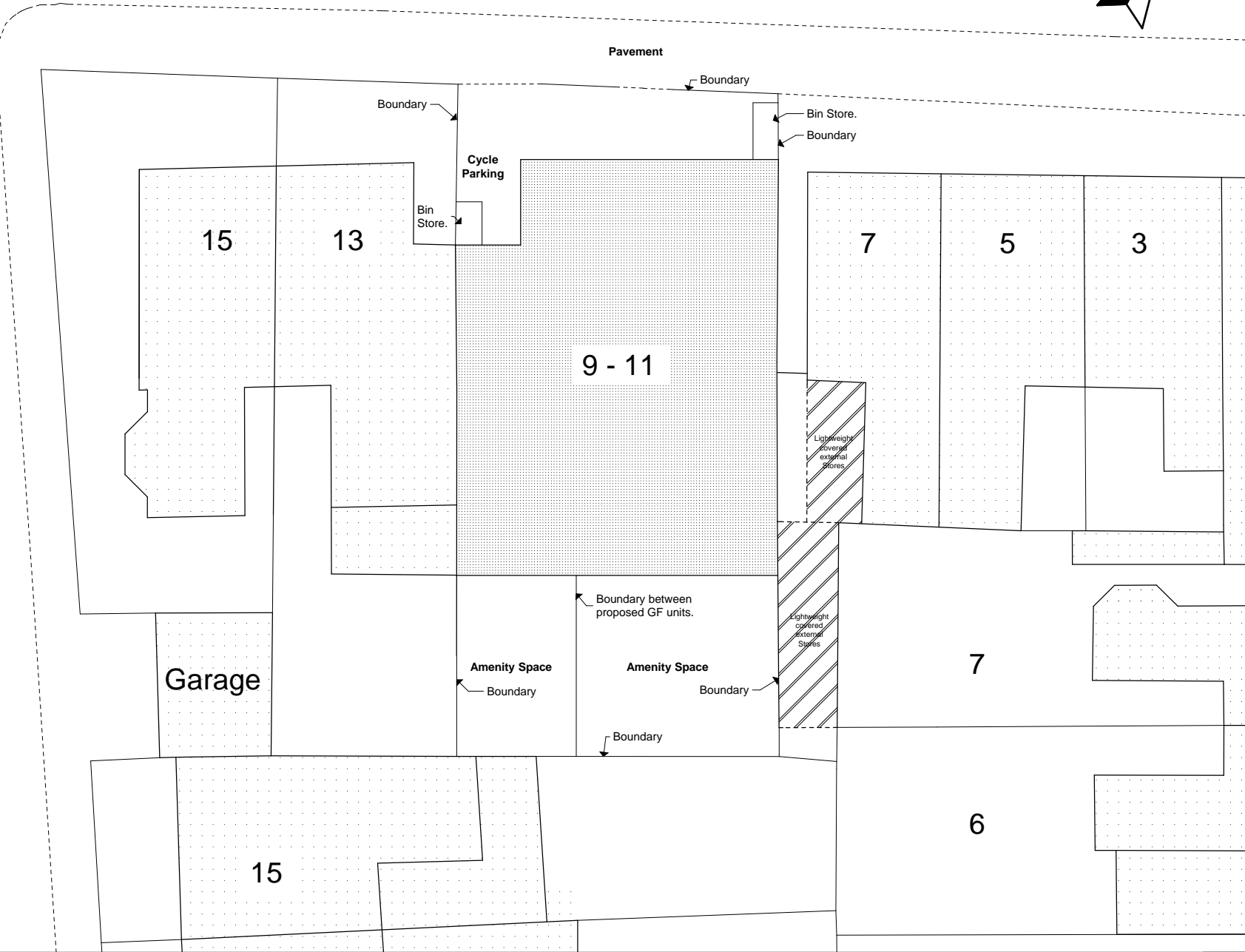
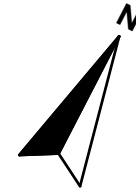

Please note that all dimensions must be checked on site and not scaled off this drawing

Preliminary	
Planning	
Building Regs.	
Tender	
Construction	
As-built	

Rev.	Date	Revision
A	04-03-14	Amendment to bin store.
B	25-03-14	Amendment to bin stores.
C	16-04-18	Amendment to footprint.

File Ref: 1401 - BA - Plans 3.pln © Copyright



Scholar's House, Shotton Brook Office Park, Timothy's Bridge Road, Stratford-upon-Avon, Warwickshire, CV37 9NR
Tel: 01789 294 560
ds-architects@hotmail.co.uk

Client	Mr. & Mrs. Hauser
Project	9-11 Mansfield Road

Drawing Title
Proposed Site Plan

Scale	1:200	Drawing size.	A4
Date	December 2013		

Reference No.	1110-BA-112	Rev.	C
---------------	-------------	------	---