

Rev	Details	Drawn	Checked	Date
A	Goodge Place vehicle route removed.	AS	DF	07.08.2017
B	Site traffic extended further into Tottenham Mews.	DW	DF	27.09.2017
C	Site traffic extended further into Maple St (Sheets 10 & 11 added).	DW	JT	06.10.2017

**NOTES :**

1. Do not scale from this drawing.
2. This drawing to be read & printed in colour.
3. This drawing is for illustrative purposes only, and not for construction.

**FTA DESIGN HG RIGID VEHICLE (1998)**

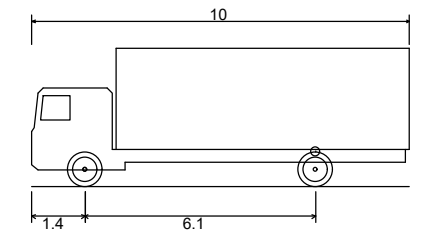

Overall Length	10.000m
Overall Width	2.500m
Overall Body Height	3.645m
Min Body Ground Clearance	0.440m
Track Width	2.470m
Lock to Lock Time	3.00s
Kerb to Kerb Turning Radius	11.000m

	<b>FORWARD MOVEMENTS</b> <i>(design speed - 5kph)</i>
	<b>REVERSE MOVEMENTS</b> <i>(design speed - 2.5kph)</i>

Client  
**8 Build Ltd**

Project  
**77 Charlotte Street**

Drawing Title  
**Vehicular Swept Paths Analysis using FTA Design HG Rigid Vehicle - Sheet 1 of 11 (Overview Plan)**

Scale	<b>N.T.S.</b>	Size	<b>A3</b>
Drawn	DW	06.06.2017	
Checked	JT	06.06.2017	



111 - 113 Great Portland Street  
London  
W1W 6QQ  
Tel. No. 0207 1000 753

Drawing Number	<b>2017-3115-TR02(1)</b>	Rev	<b>C</b>
----------------	--------------------------	-----	----------

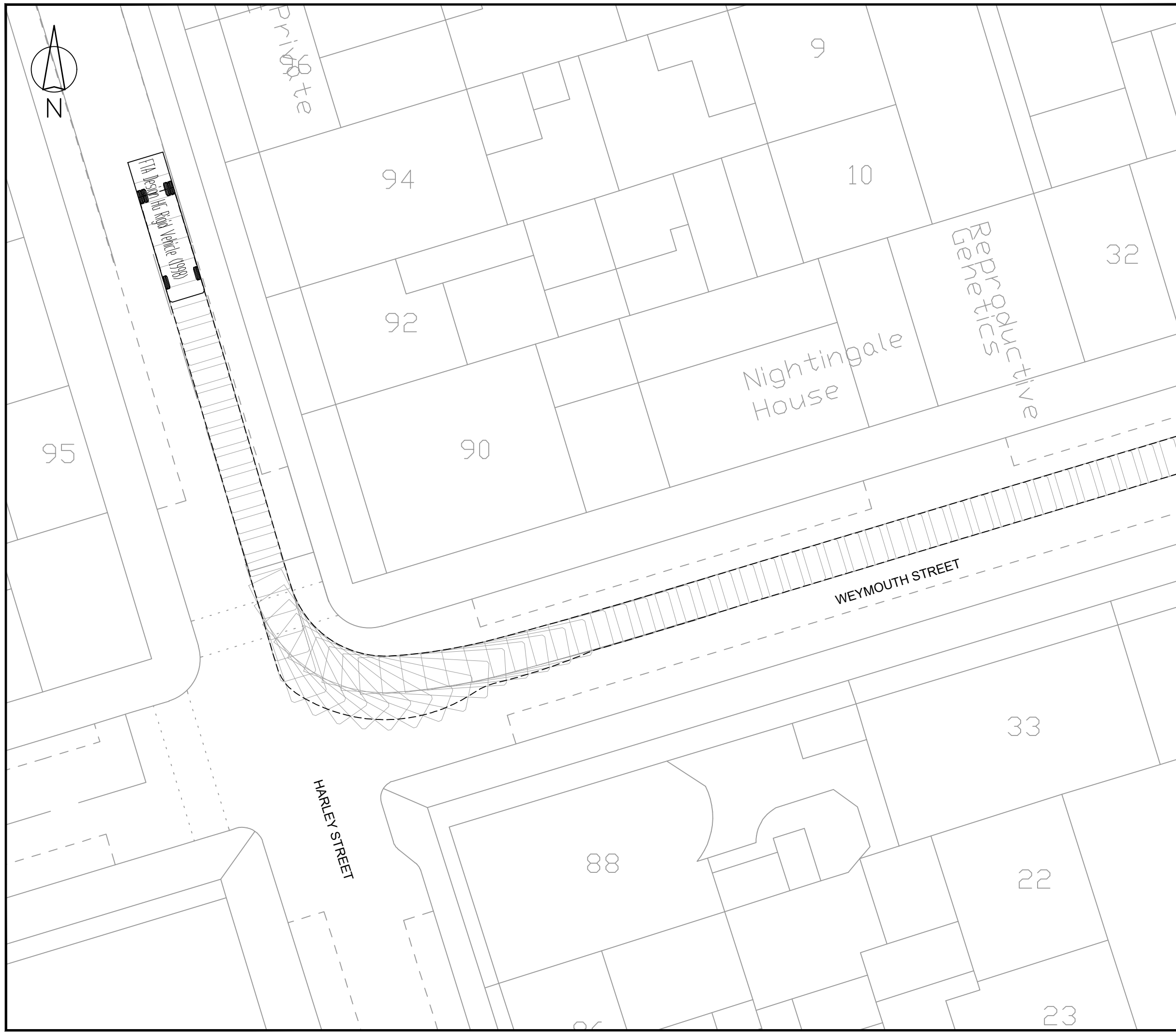

Rev	Details	Drawn	Checked	Date
A	Goodge Place vehicle route removed.	AS	DF	07.08.2017
B	Site traffic extended further into Tottenham Mews.	DW	DF	27.09.2017
C	Site traffic extended further into Maple St (Sheets 10 & 11 added).	DW	JT	06.10.2017

**NOTES:**

- Do not scale from this drawing.
- This drawing to be read & printed in colour.
- This drawing is for illustrative purposes only, and not for construction.

**FTA DESIGN HG RIGID VEHICLE (1998)**

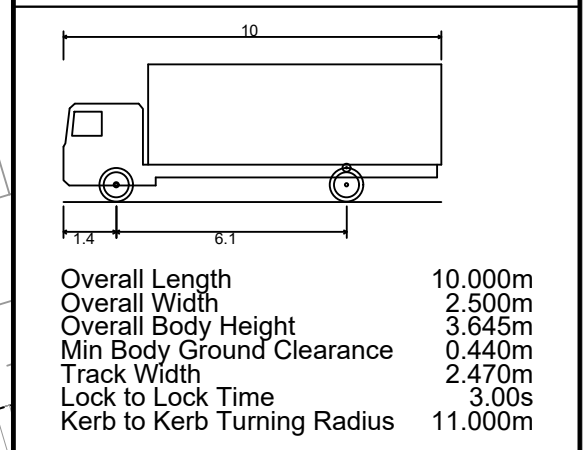

	<b>FORWARD MOVEMENTS</b> (design speed - 5kph)
	<b>REVERSE MOVEMENTS</b> (design speed - 2.5kph)

Client  
**8 Build Ltd**

Project  
**77 Charlotte Street**

Drawing Title  
**Vehicular Swept Paths Analysis  
using FTA Design HG Rigid  
Vehicle - Sheet 2 of 11**

Scale **1:250** Size **A3**

Drawn	DW	06.06.2017
Checked	JT	06.06.2017



111 - 113 Great Portland Street  
London  
W1W 6QQ  
Tel. No. 0207 1000 753

Drawing Number	<b>2017-3115-TR02(2)</b>	Rev	<b>C</b>
----------------	--------------------------	-----	----------

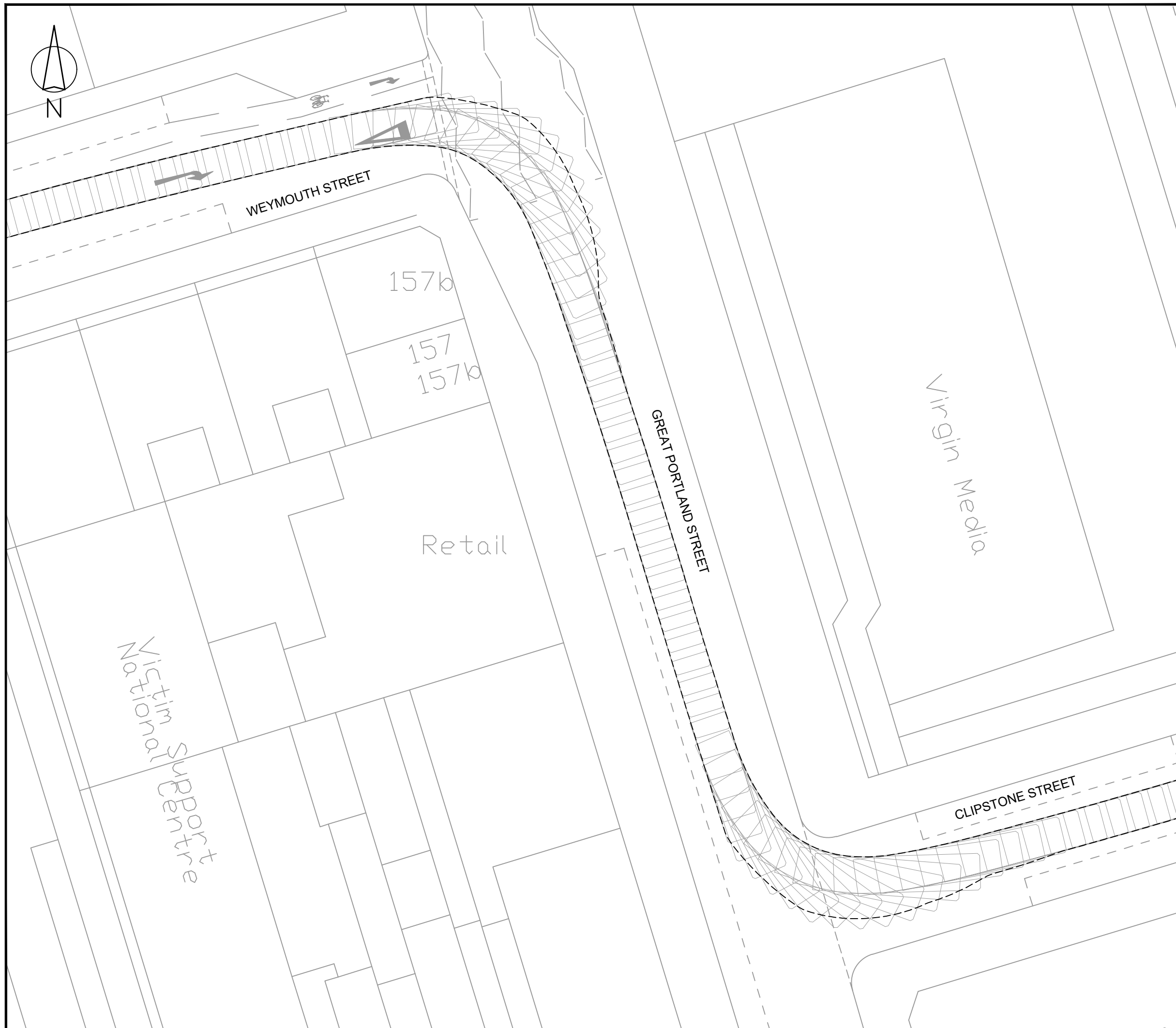

Rev	Details	Drawn	Checked	Date
A	Goodge Place vehicle route removed.	AS	DF	07.08.2017
B	Site traffic extended further into Tottenham Mews.	DW	DF	27.09.2017
C	Site traffic extended further into Maple St (Sheets 10 & 11 added).	DW	JT	06.10.2017

**NOTES:**

- Do not scale from this drawing.
- This drawing to be read & printed in colour.
- This drawing is for illustrative purposes only, and not for construction.

**FTA DESIGN HG RIGID VEHICLE (1998)**

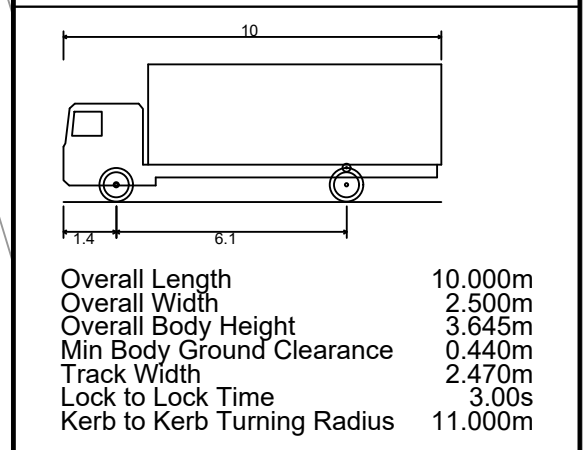

	<b>FORWARD MOVEMENTS</b> (design speed - 5kph)
	<b>REVERSE MOVEMENTS</b> (design speed - 2.5kph)

Client  
**8 Build Ltd**

Project  
**77 Charlotte Street**

Drawing Title  
**Vehicular Swept Paths Analysis using FTA Design HG Rigid Vehicle - Sheet 3 of 11**

Scale **1:250** Size **A3**

Drawn **DW** 06.06.2017  
Checked **JT** 06.06.2017



111 - 113 Great Portland Street  
London  
W1W 6QQ  
Tel. No. 0207 1000 753

Drawing Number **2017-3115-TR02(3)** Rev **C**

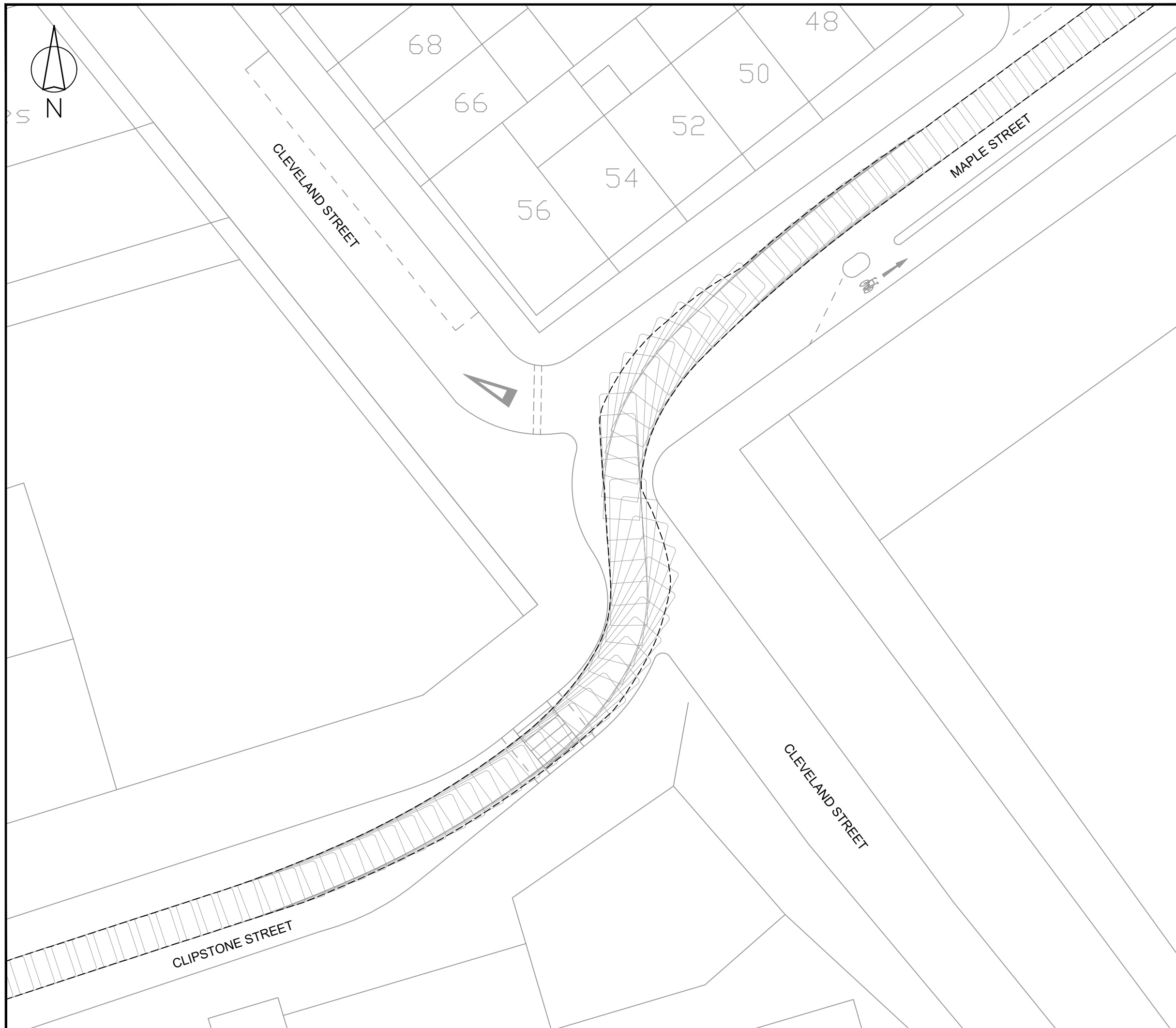

Rev	Details	Drawn	Checked	Date
A	Goodge Place vehicle route removed.	AS	DF	07.08.2017
B	Site traffic extended further into Tottenham Mews.	DW	DF	27.09.2017
C	Site traffic extended further into Maple St (Sheets 10 & 11 added).	DW	JT	06.10.2017

**NOTES:**

- Do not scale from this drawing.
- This drawing to be read & printed in colour.
- This drawing is for illustrative purposes only, and not for construction.

**FTA DESIGN HG RIGID VEHICLE (1998)**

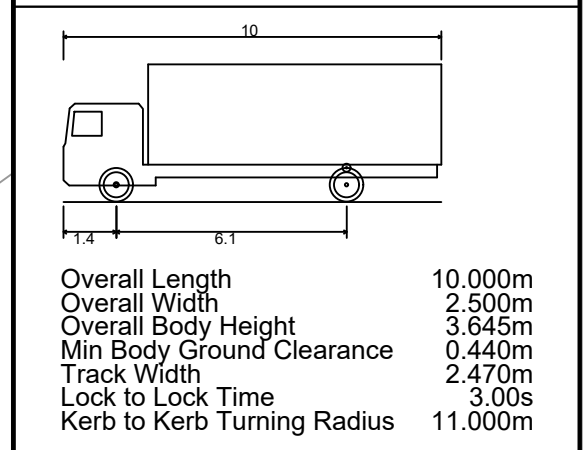

	FORWARD MOVEMENTS (design speed - 5kph)
	REVERSE MOVEMENTS (design speed - 2.5kph)

Client  
**8 Build Ltd**

Project  
**77 Charlotte Street**

Drawing Title  
**Vehicular Swept Paths Analysis using FTA Design HG Rigid Vehicle - Sheet 4 of 11**

Scale	<b>1:250</b>	Size	<b>A3</b>
Drawn	DW	06.06.2017	
Checked	JT	06.06.2017	



111 - 113 Great Portland Street  
London  
W1W 6QQ  
Tel. No. 0207 1000 753

Drawing Number	<b>2017-3115-TR02(4)</b>	Rev	<b>C</b>
----------------	--------------------------	-----	----------

C:\USERS\WALTERS\DESKTOP\31152017-3115-TR02 - VEHICULAR SWEEP PATHS ANALYSIS USING FTA DESIGN HG RIGID VEHICLE.DWG

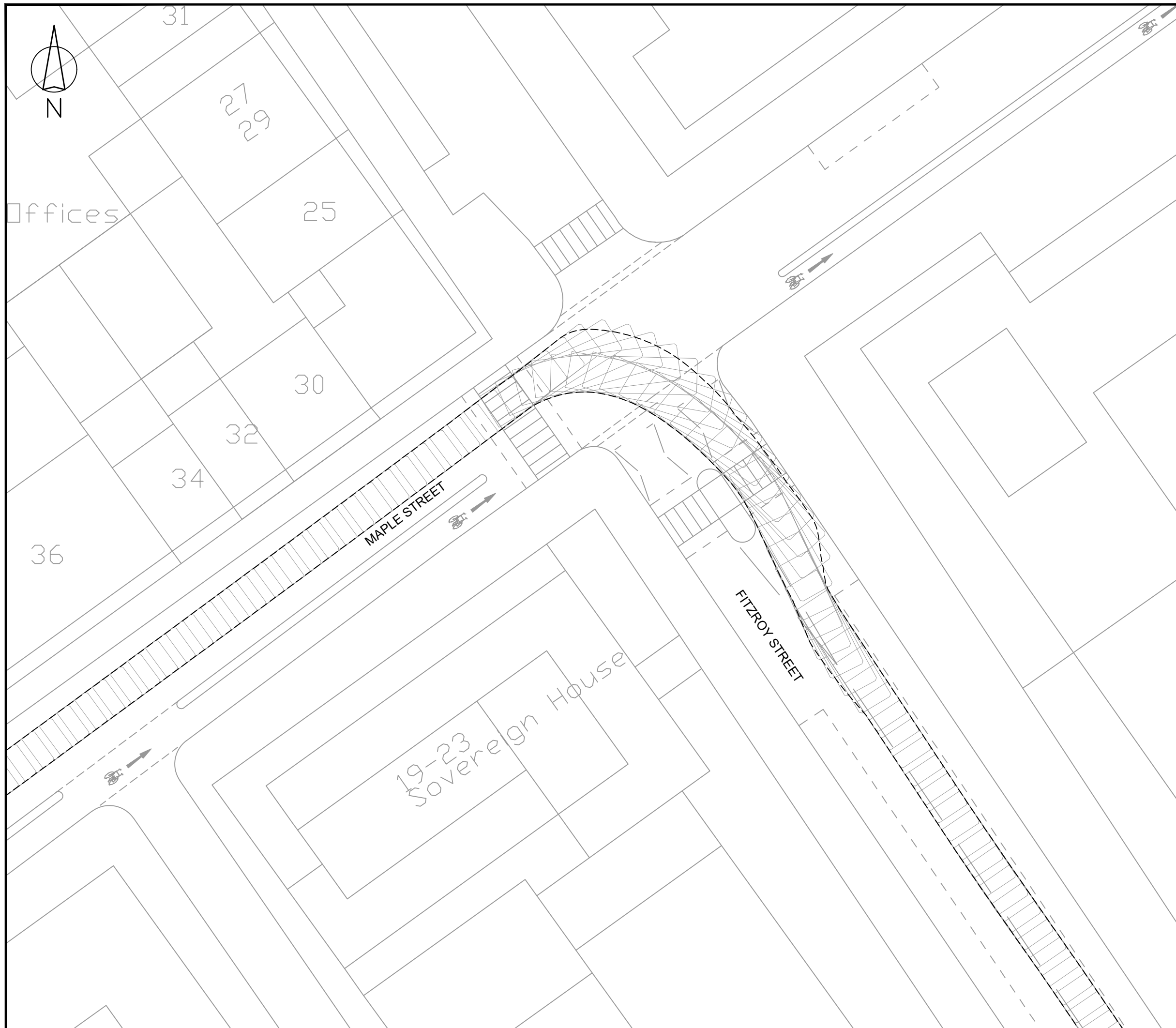

Rev	Details	Drawn	Checked	Date
A	Goodge Place vehicle route removed.	AS	DF	07.08.2017
B	Site traffic extended further into Tottenham Mews.	DW	DF	27.09.2017
C	Site traffic extended further into Maple St (Sheets 10 & 11 added).	DW	JT	06.10.2017

- NOTES:**
- Do not scale from this drawing.
  - This drawing to be read & printed in colour.
  - This drawing is for illustrative purposes only, and not for construction.

**FTA DESIGN HG RIGID VEHICLE (1998)**

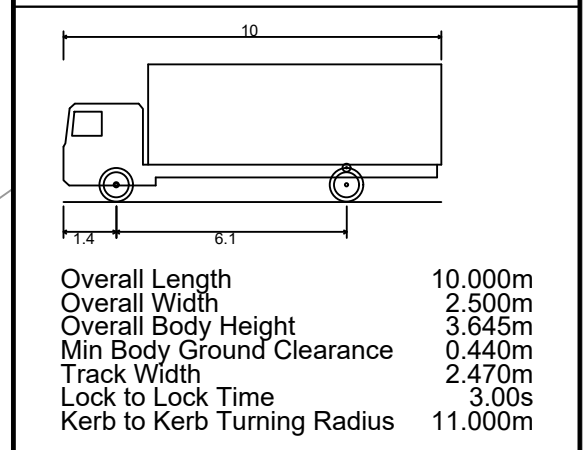

	<b>FORWARD MOVEMENTS</b> (design speed - 5kph)
	<b>REVERSE MOVEMENTS</b> (design speed - 2.5kph)

Client  
**8 Build Ltd**

Project  
**77 Charlotte Street**

Drawing Title  
**Vehicular Swept Paths Analysis  
using FTA Design HG Rigid  
Vehicle - Sheet 5 of 11**

Scale	<b>1:250</b>	Size	<b>A3</b>
Drawn	DW	06.06.2017	
Checked	JT	06.06.2017	



111 - 113 Great Portland Street  
London  
W1W 6QQ  
Tel. No. 0207 1000 753

Drawing Number	<b>2017-3115-TR02(5)</b>	Rev	<b>C</b>
----------------	--------------------------	-----	----------

C:\USERS\WALTERS\DESKTOP\3115-TR02 - VEHICULAR SWEEP PATHS ANALYSIS USING FTA DESIGN HG RIGID VEHICLE.DWG



Rev	Details	Drawn	Checked	Date
A	Goodge Place vehicle route removed.	AS	DF	07.08.2017
B	Site traffic extended further into Tottenham Mews.	DW	DF	27.09.2017
C	Site traffic extended further into Maple St (Sheets 10 & 11 added).	DW	JT	06.10.2017

**NOTES:**

- Do not scale from this drawing.
- This drawing to be read & printed in colour.
- This drawing is for illustrative purposes only, and not for construction.

**FTA DESIGN HG RIGID VEHICLE (1998)**

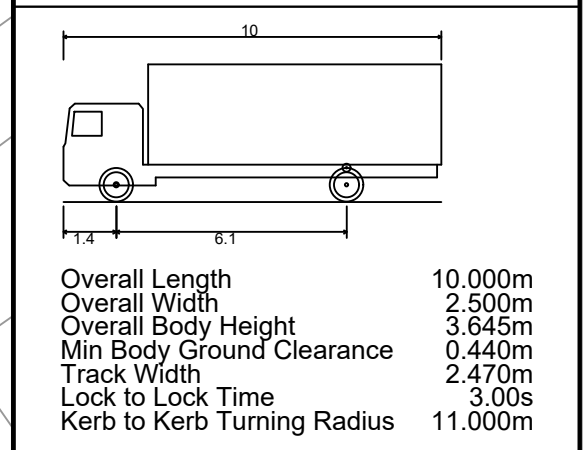

	<b>FORWARD MOVEMENTS</b> (design speed - 5kph)
	<b>REVERSE MOVEMENTS</b> (design speed - 2.5kph)

Client  
**8 Build Ltd**

Project  
**77 Charlotte Street**

Drawing Title  
**Vehicular Swept Paths Analysis  
using FTA Design HG Rigid  
Vehicle - Sheet 6 of 11**

Scale	<b>1:250</b>	Size	<b>A3</b>
Drawn	DW	06.06.2017	
Checked	JT	06.06.2017	



111 - 113 Great Portland Street  
London  
W1W 6QQ  
Tel. No. 0207 1000 753

Drawing Number	<b>2017-3115-TR02(6)</b>	Rev	<b>C</b>
----------------	--------------------------	-----	----------

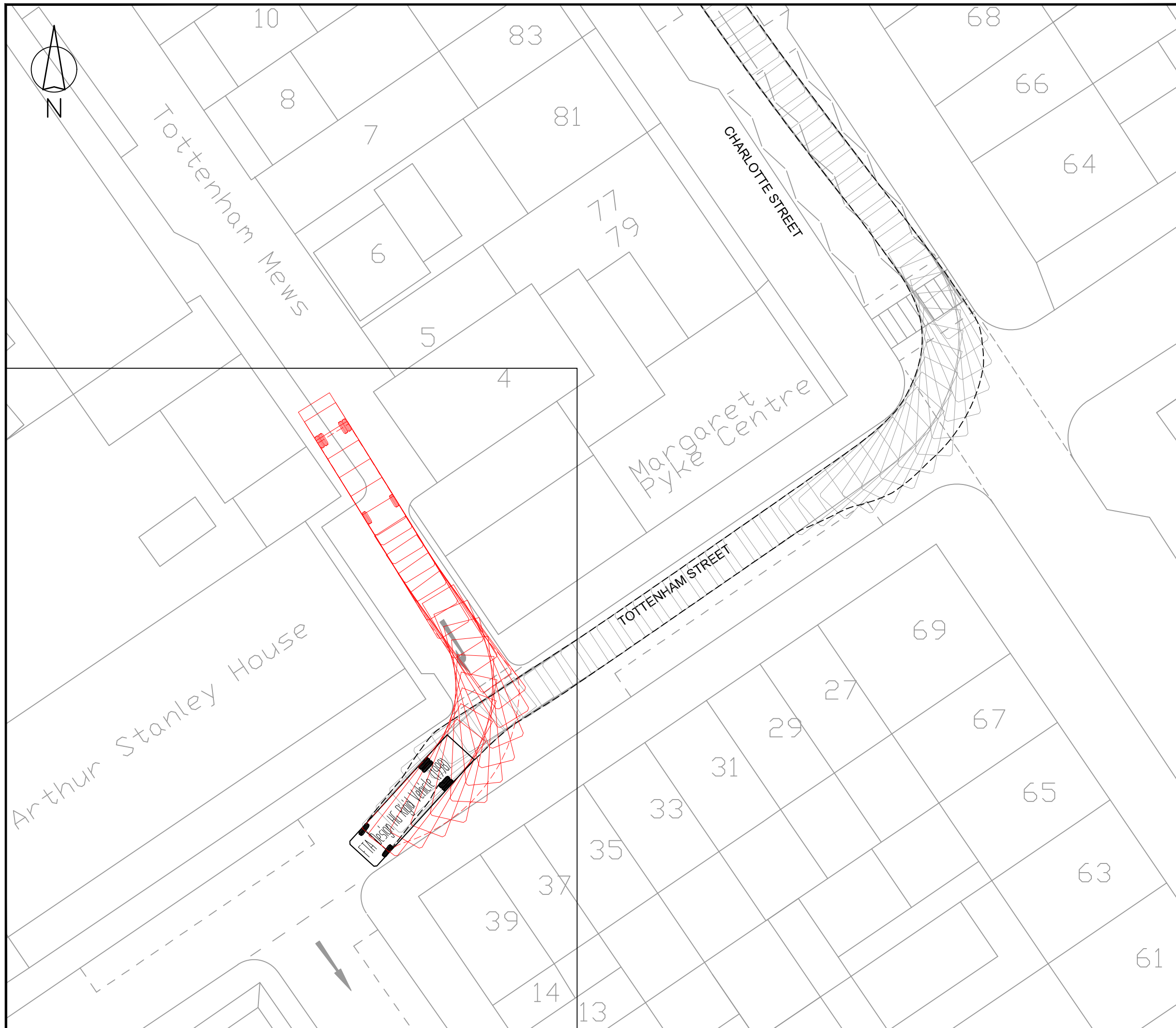

Rev	Details	Drawn	Checked	Date
A	Goodge Place vehicle route removed.	AS	DF	07.08.2017
B	Site traffic extended further into Tottenham Mews.	DW	DF	27.09.2017
C	Site traffic extended further into Maple St (Sheets 10 & 11 added).	DW	JT	06.10.2017

**NOTES:**

1. Do not scale from this drawing.
2. This drawing to be read & printed in colour.
3. This drawing is for illustrative purposes only, and not for construction.

**FTA DESIGN HG RIGID VEHICLE (1998)**

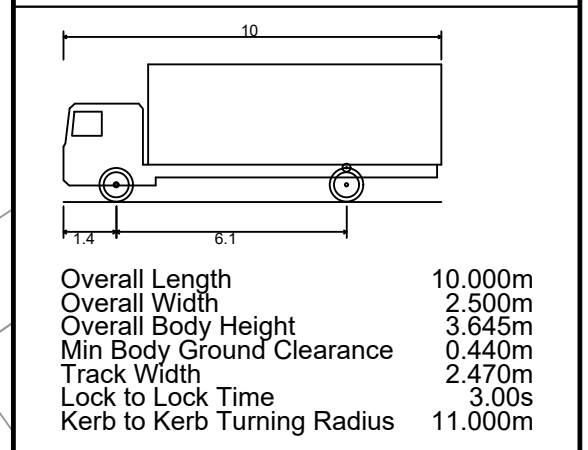

	<b>FORWARD MOVEMENTS</b> (design speed - 5kph)
	<b>REVERSE MOVEMENTS</b> (design speed - 2.5kph)

Client  
**8 Build Ltd**

Project  
**77 Charlotte Street**

Drawing Title  
**Vehicular Swept Paths Analysis using FTA Design HG Rigid Vehicle - Sheet 7 of 11**

Scale	<b>1:250</b>	Size	<b>A3</b>
Drawn	DW	06.06.2017	
Checked	JT	06.06.2017	



111 - 113 Great Portland Street  
London  
W1W 6QQ  
Tel. No. 0207 1000 753

Drawing Number	<b>2017-3115-TR02(7)</b>	Rev	<b>C</b>
----------------	--------------------------	-----	----------

C:\USERS\WALTERS\DESKTOP\3115-TR02 - VEHICULAR SWEEP PATHS ANALYSIS USING FTA DESIGN HG RIGID VEHICLE.DWG

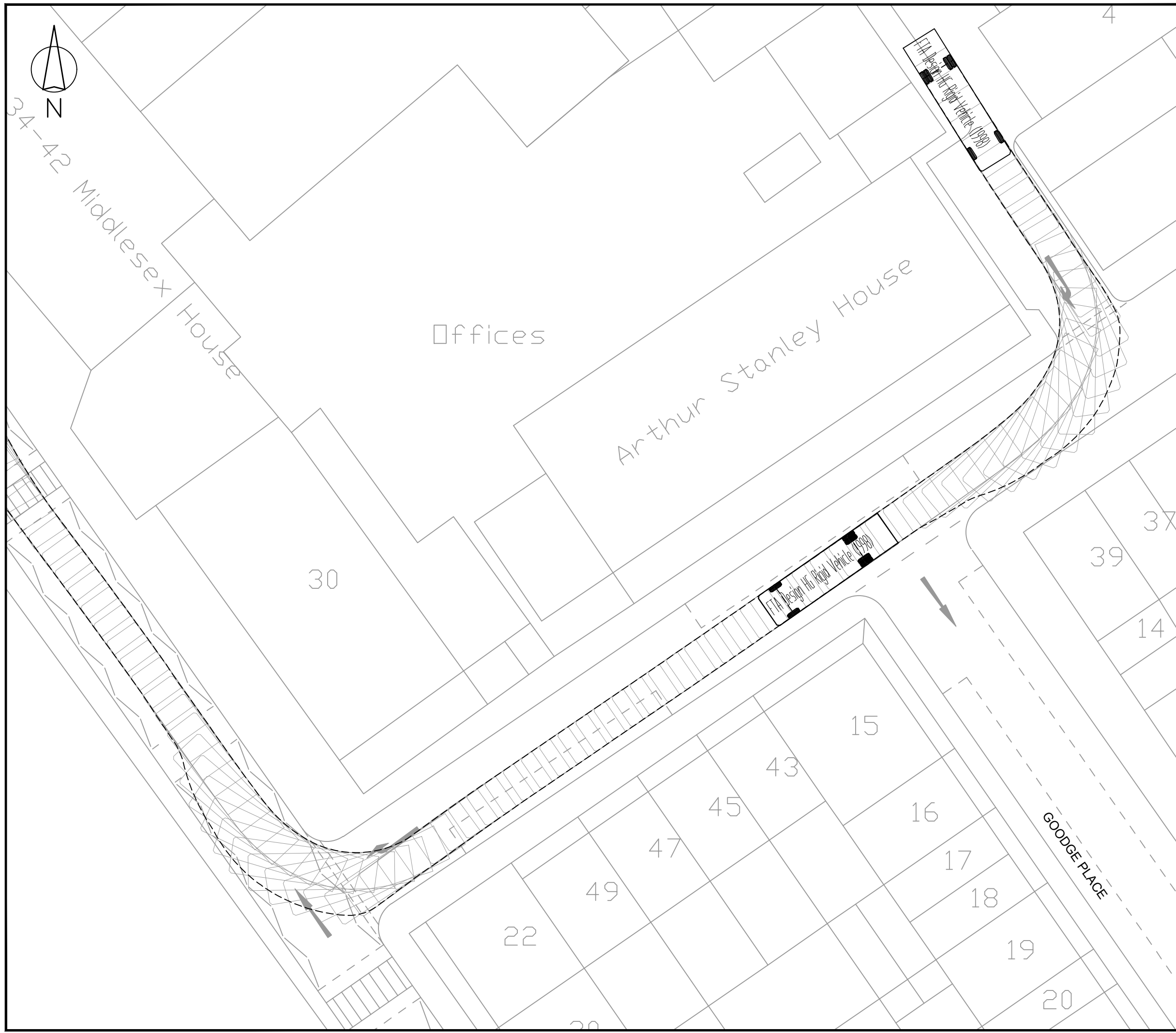

Rev	Details	Drawn	Checked	Date
A	Godge Place vehicle route removed.	AS	DF	07.08.2017
B	Site traffic extended further into Tottenham Mews.	DW	DF	27.09.2017
C	Site traffic extended further into Maple St (Sheets 10 & 11 added).	DW	JT	06.10.2017

**NOTES:**

1. Do not scale from this drawing.
2. This drawing to be read & printed in colour.
3. This drawing is for illustrative purposes only, and not for construction.

**FTA DESIGN HG RIGID VEHICLE (1998)**

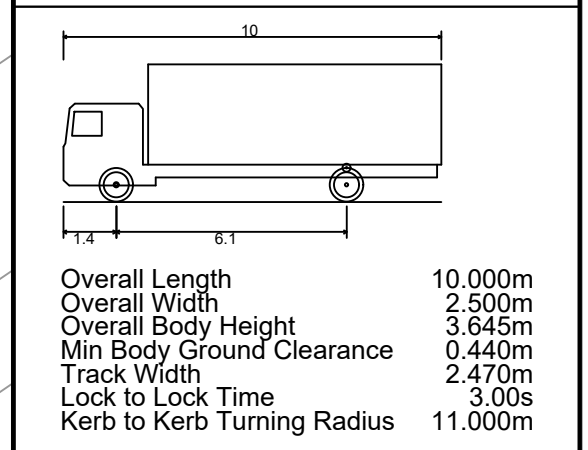

	FORWARD MOVEMENTS (design speed - 5kph)
	REVERSE MOVEMENTS (design speed - 2.5kph)

Client  
**8 Build Ltd**

Project  
**77 Charlotte Street**

Drawing Title  
**Vehicular Swept Paths Analysis  
using FTA Design HG Rigid  
Vehicle - Sheet 8 of 11**

Scale **1:250** Size **A3**

Drawn DW 06.06.2017  
Checked JT 06.06.2017



111 - 113 Great Portland Street  
London  
W1W 6QQ  
Tel. No. 0207 1000 753

Drawing Number **2017-3115-TR02(8)** Rev **C**



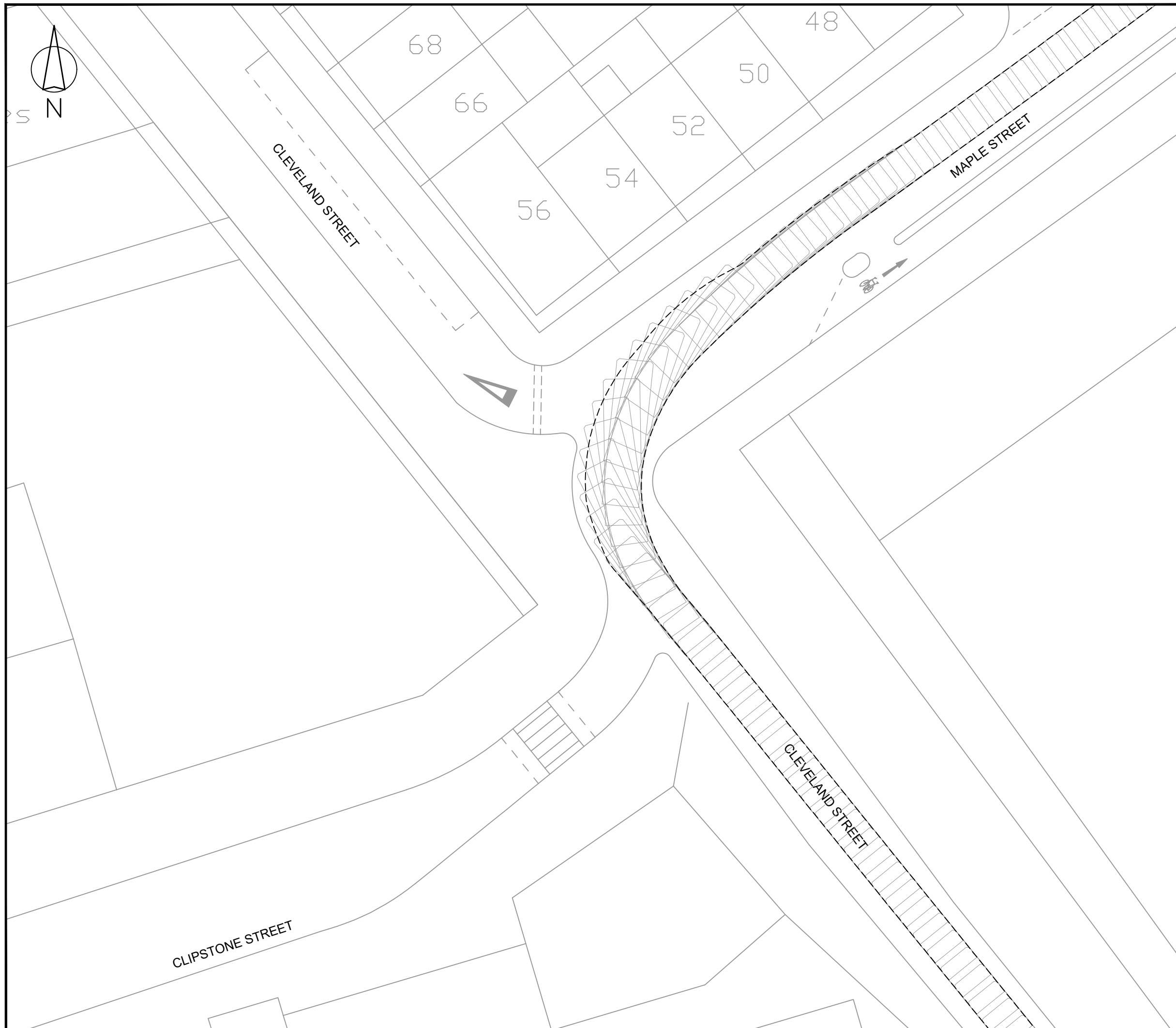

Rev	Details	Drawn	Checked	Date
A	Goodge Place vehicle route removed.	AS	DF	07.08.2017
B	Site traffic extended further into Tottenham Mews.	DW	DF	27.09.2017
C	Site traffic extended further into Maple St (Sheets 10 & 11 added).	DW	JT	06.10.2017

- NOTES:**
- Do not scale from this drawing.
  - This drawing to be read & printed in colour.
  - This drawing is for illustrative purposes only, and not for construction.

**FTA DESIGN HG RIGID VEHICLE (1998)**

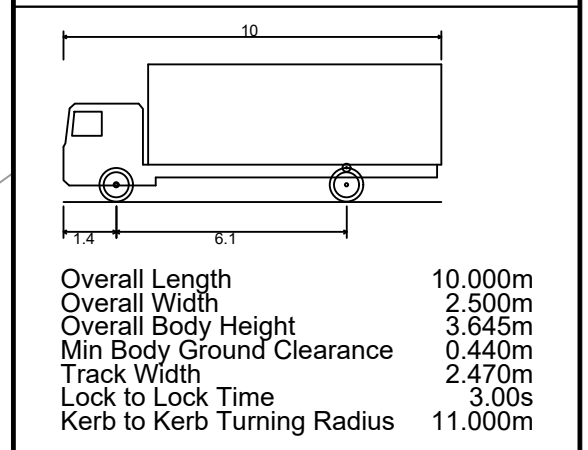

- FORWARD MOVEMENTS  
(design speed - 5kph)
- REVERSE MOVEMENTS  
(design speed - 2.5kph)

Client  
**8 Build Ltd**

Project  
**77 Charlotte Street**

Drawing Title  
**Vehicular Swept Paths Analysis using FTA Design HG Rigid Vehicle - Sheet 9 of 11**

Scale	<b>1:250</b>	Size	<b>A3</b>
Drawn	DW	06.06.2017	
Checked	JT	06.06.2017	



111 - 113 Great Portland Street  
London  
W1W 6QQ  
Tel. No. 0207 1000 753

Drawing Number	<b>2017-3115-TR02(9)</b>	Rev	<b>C</b>
----------------	--------------------------	-----	----------

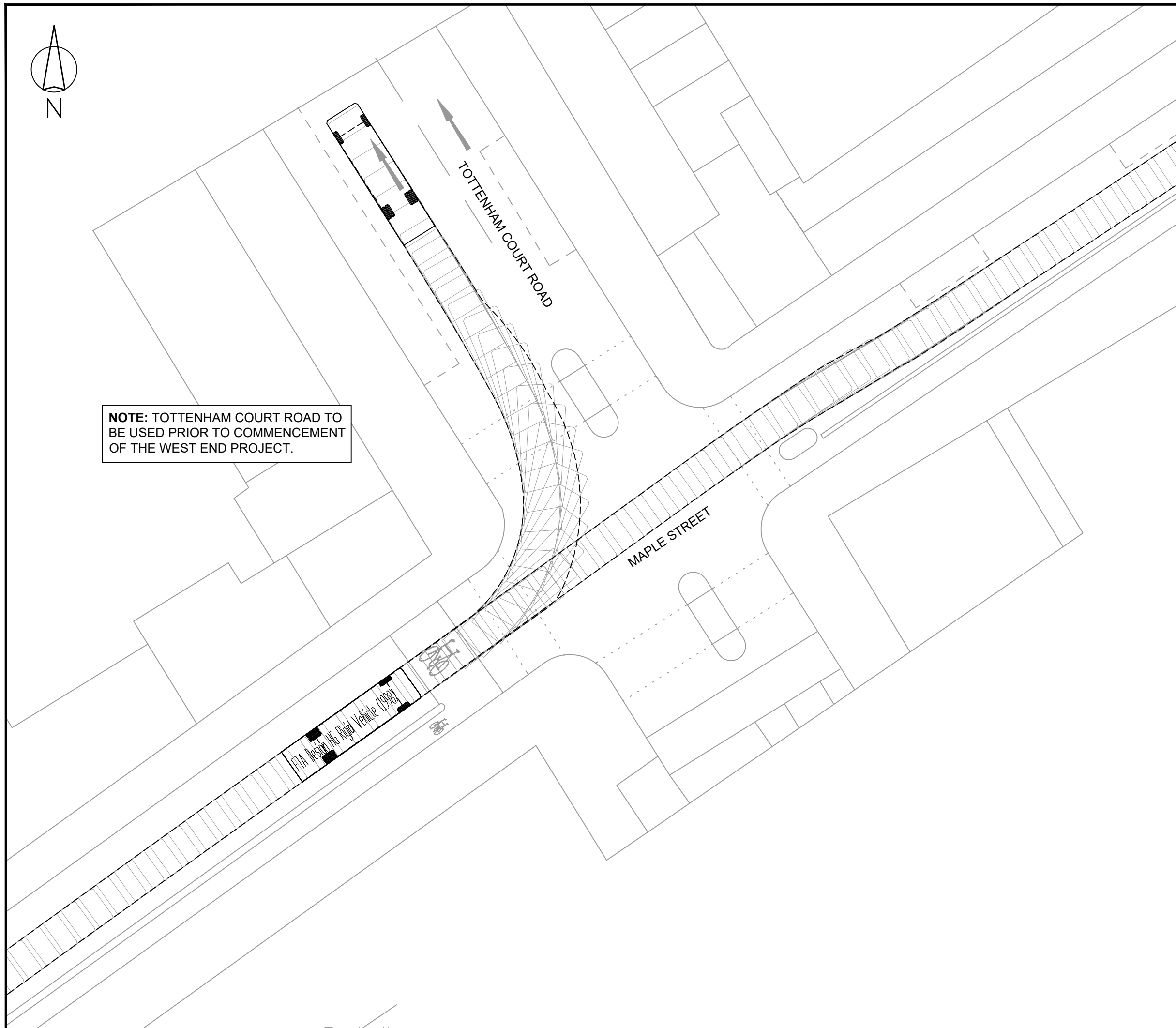

**NOTE:** TOTTENHAM COURT ROAD TO BE USED PRIOR TO COMMENCEMENT OF THE WEST END PROJECT.

Rev	Details	Drawn	Checked	Date
A	Goodge Place vehicle route removed.	AS	DF	07.08.2017
B	Site traffic extended further into Tottenham Mews.	DW	DF	27.09.2017
C	Site traffic extended further into Maple St (Sheets 10 & 11 added).	DW	JT	06.10.2017

- NOTES:**
- Do not scale from this drawing.
  - This drawing to be read & printed in colour.
  - This drawing is for illustrative purposes only, and not for construction.

**FTA DESIGN HG RIGID VEHICLE (1998)**

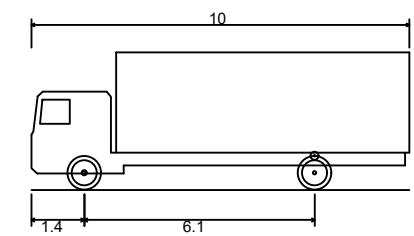

Overall Length	10.000m
Overall Width	2.500m
Overall Body Height	3.645m
Min Body Ground Clearance	0.440m
Track Width	2.470m
Lock to Lock Time	3.00s
Kerb to Kerb Turning Radius	11.000m

- FORWARD MOVEMENTS (design speed - 5kph)
- REVERSE MOVEMENTS (design speed - 2.5kph)

Client  
**8 Build Ltd**

Project  
**77 Charlotte Street**

Drawing Title  
**Vehicular Swept Paths Analysis using FTA Design HG Rigid Vehicle - Sheet 10 of 11**

Scale	<b>1:250</b>	Size	<b>A3</b>
Drawn	DW	06.06.2017	
Checked	JT	06.06.2017	



111 - 113 Great Portland Street  
London  
W1W 6QQ  
Tel. No. 0207 1000 753

Drawing Number	<b>2017-3115-TR02(10)</b>	Rev	<b>C</b>
----------------	---------------------------	-----	----------

C:\USERS\WALTERS\DESKTOP\3115-TR02 - VEHICULAR SWEEP PATHS ANALYSIS USING FTA DESIGN HG RIGID VEHICLE.DWG

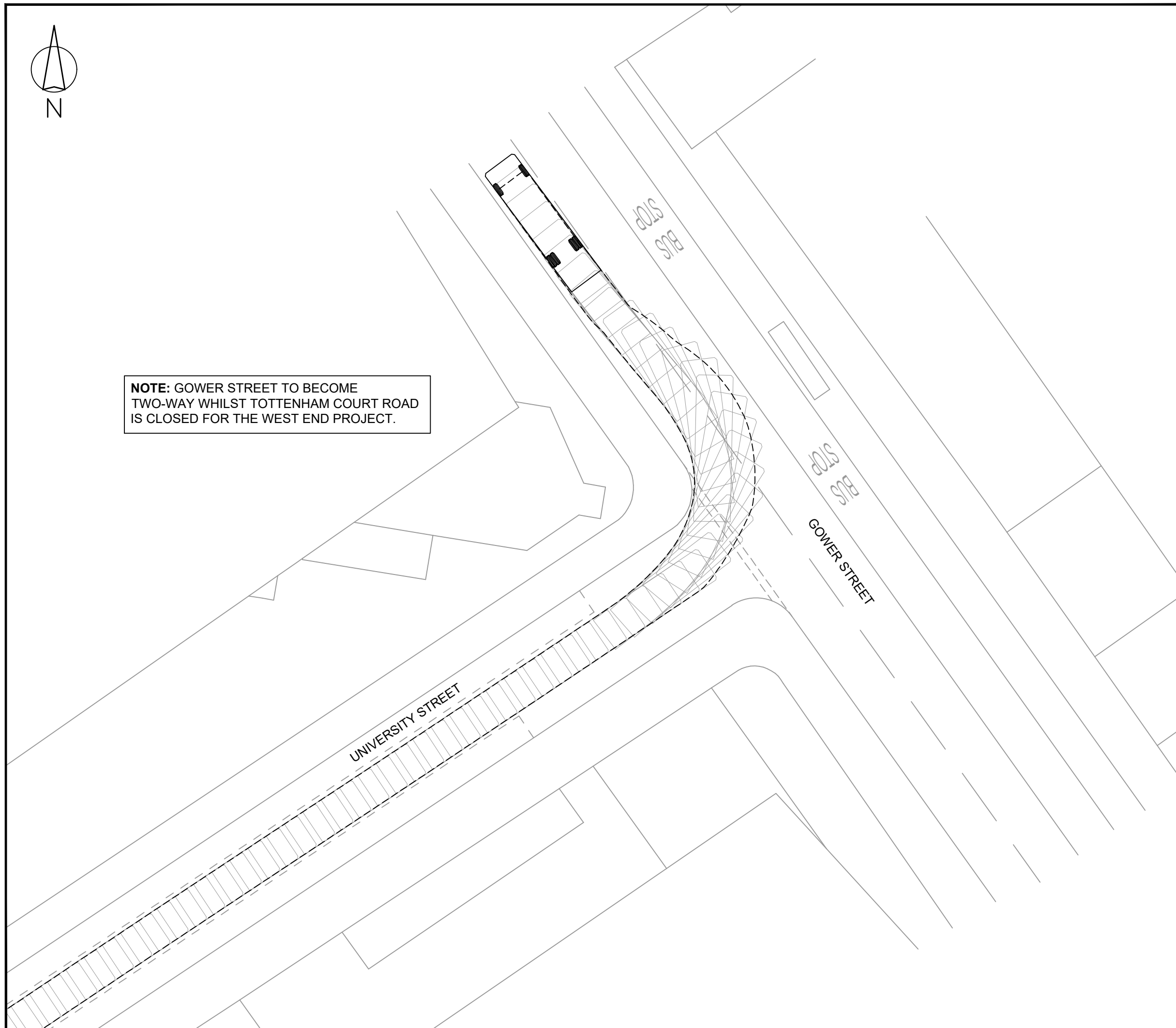

**NOTE:** GOWER STREET TO BECOME TWO-WAY WHILST TOTTENHAM COURT ROAD IS CLOSED FOR THE WEST END PROJECT.

Rev	Details	Drawn	Checked	Date
A	Goodge Place vehicle route removed.	AS	DF	07.08.2017
B	Site traffic extended further into Tottenham Mews.	DW	DF	27.09.2017
C	Site traffic extended further into Maple St (Sheets 10 & 11 added).	DW	JT	06.10.2017

**NOTES:**

- Do not scale from this drawing.
- This drawing to be read & printed in colour.
- This drawing is for illustrative purposes only, and not for construction.

**FTA DESIGN HG RIGID VEHICLE (1998)**

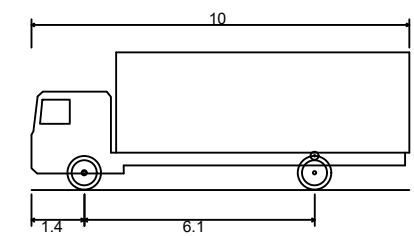

Overall Length	10.000m
Overall Width	2.500m
Overall Body Height	3.645m
Min Body Ground Clearance	0.440m
Track Width	2.470m
Lock to Lock Time	3.00s
Kerb to Kerb Turning Radius	11.000m

	FORWARD MOVEMENTS (design speed - 5kph)
	REVERSE MOVEMENTS (design speed - 2.5kph)

Client  
**8 Build Ltd**

Project  
**77 Charlotte Street**

Drawing Title  
**Vehicular Swept Paths Analysis using FTA Design HG Rigid Vehicle - Sheet 11 of 11**

Scale	<b>1:250</b>	Size	<b>A3</b>
Drawn	DW	06.06.2017	
Checked	JT	06.06.2017	



111 - 113 Great Portland Street  
London  
W1W 6QQ  
Tel. No. 0207 1000 753

Drawing Number	<b>2017-3115-TR02(11)</b>	Rev	<b>C</b>
----------------	---------------------------	-----	----------