

NOTES

→ Drainage

**LOCATION OF SOAKAWAYS**

Soakaway No. 1 is at the location of Percolation Test No. 1. This soakaway will be 3.25m x 1.5m x 1.5m deep and meets in full the requirements of the SUDS report.

Soakaway No. 2 is at the location of Percolation Test No. 2. This soakaway will be identical in size to Soakaway No. 1 but will be connected to the Green Roof from roof (188) via an  $\phi=75$  diameter of also exceedance flows above 100 years + CC via an overflow from soakaway No. 1.

**DETAILS OF PIPEWORK**

Pipe connections to soakaways to be 100mm dia. PVC, laid at gradient of 1 in 100.

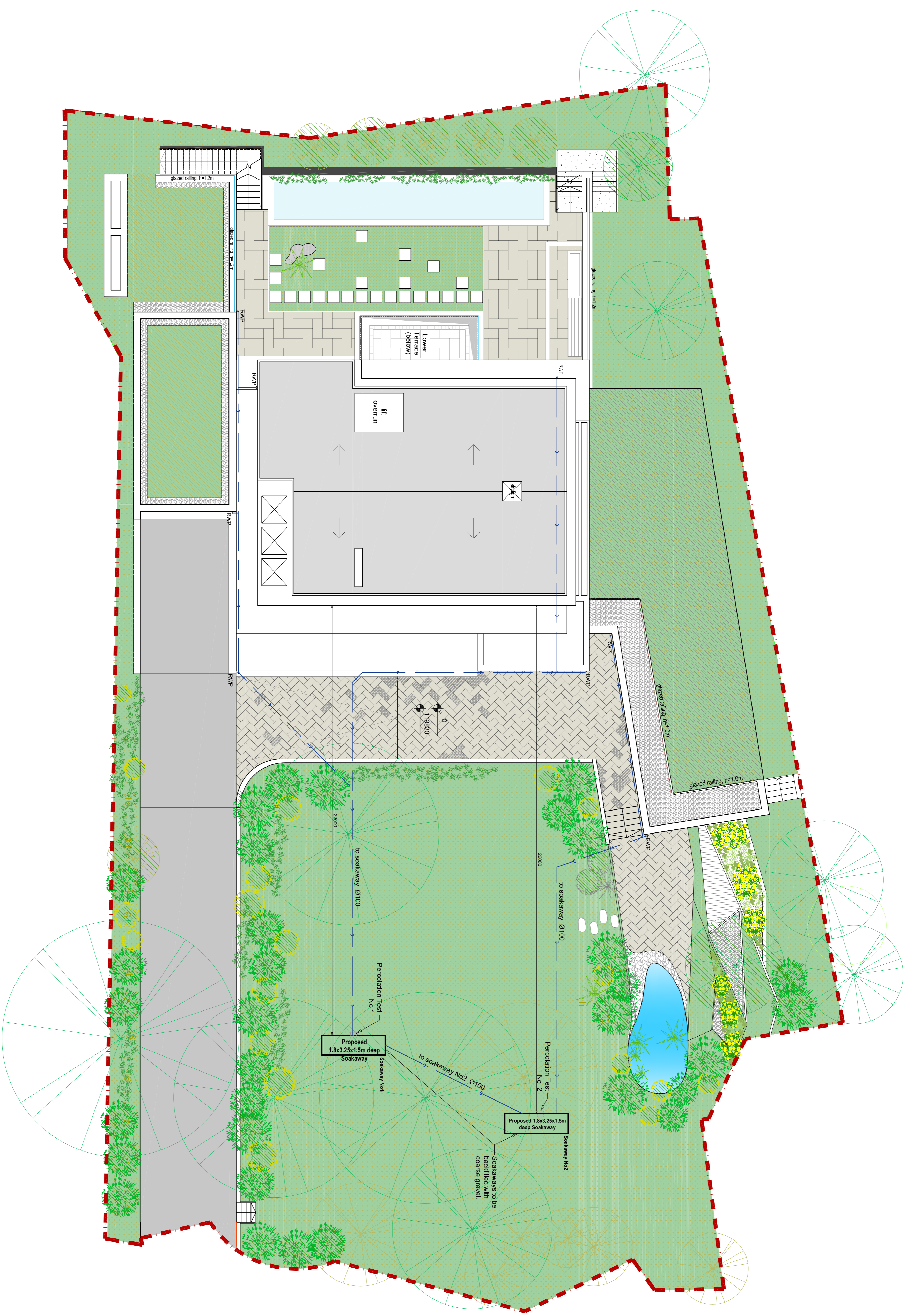

Title  
Approved Roof Plan  
showing soakaway position

Drawn	KK	Date	Aug'17	Scale	1:100
Checked	SS	Date	Aug'17	Size	A1
Approved	SS	Date	Aug'17	Rev.	A

Drawing No.  
**1706-1057-S01**

Client  
M Roman Jankowski

Rev.	Amendments	Date	Chkd.

**S T S Structural Engineering Ltd**  
 88 Gosway, Wilton Garden City, Hertfordshire, AL8 7TE  
 Tel: 01707 695466 Fax: 01707 692306  
 Web: www.sts-ec.co.uk Email: sales@sts-ec.co.uk

Project  
99a Froggnal, London NW3 6XR