

- PLANNING APPLICATION NOTES:**
- This Planning Application covers the following four items:
 - Replacement Windows
 - Replacement Rooflights
 - Metal balustrades to front steps
 - Dormer Window at third floor
 - All windows to be replaced with double glazed white painted hardwood timber frame windows - style to replicate and match existing windows.

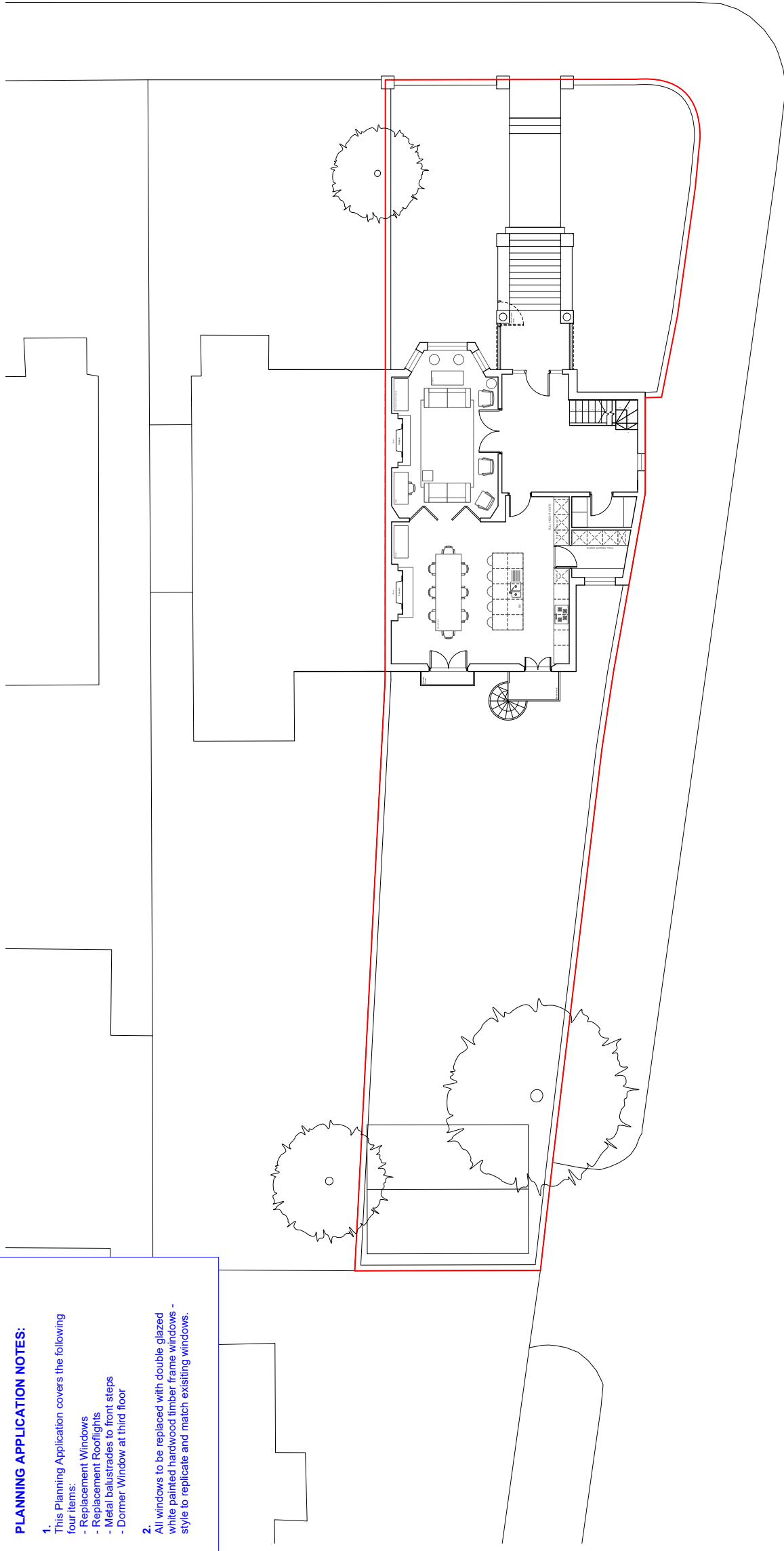

ETON ROAD

FELLOWS ROAD

REVISION	PURPOSE	DATE	REVISION	PURPOSE	DATE
A	XXXX	X/XX/XXXX			

<p>CLIENT: hampson williams</p> <p>151-153 Tottenham Court Road, 1st Floor, London, W1P 0LP 020 7739 9900 @hampsonwilliams</p>		<p>PROJECT: 16 Eton Road, London, NW3 4SS</p> <p>DWG TITLE: PROPOSED SITE PLAN</p> <p>DWG NO: HW/382 P010-1</p> <p>SCALE: 1:100@A1 1:200@A3</p> <p>PURPOSE OF ISSUE: PLANNING</p>	
<p>KEY PROJECT DATES:</p>		<p>REVISION: -</p> <p>DRAWN BY: R/J/ET</p> <p>CHECKED BY: ch</p>	

<p>GENERAL NOTES:</p> <p>1. This drawing is the property of Hampson Williams and is not to be reproduced without their written consent.</p> <p>2. This drawing is to be read in conjunction with all relevant drawings and specifications provided by Hampson Williams and other documents referred to in the schedule of work.</p> <p>3. All dimensions are in millimetres unless otherwise stated.</p> <p>4. The drawings are to be approved for construction by the relevant authority.</p> <p>5. The drawings are to be approved for construction by the relevant authority.</p> <p>6. The drawings are to be approved for construction by the relevant authority.</p> <p>7. The drawings are to be approved for construction by the relevant authority.</p> <p>8. The drawings are to be approved for construction by the relevant authority.</p> <p>9. The drawings are to be approved for construction by the relevant authority.</p> <p>10. The drawings are to be approved for construction by the relevant authority.</p>		<p>PLANNING</p>	
--	--	------------------------	--