

DRAWING NOT TO BE USED OTHER THAN THE PURPOSE FOR WHICH IT WAS PREPARED. IT IS SUPPLIED WITHOUT LIABILITY FOR ERRORS OR OMISSIONS. DO NOT SCALE FROM THE DRAWING. ALL DIMENSIONS ARE TO BE CHECKED ON SITE.

This drawing is to be read in conjunction with all other drawings. NOTES ON THIS DRAWING WILL APPLY TO ALL OTHER DRAWINGS WHERE A SIMILAR POSITION EXISTS.

PLEASE NOTE

- 1). ALL DIMENSIONS TO BE CHECKED ON SITE BEFORE FABRICATION.
- 2). CONTRACTOR IS TO REFER TO THE ENGINEERS DRAWINGS BEFORE PROCEEDING WITH WORKS.
- 3). ALL DRAWINGS AND DESIGNS ARE COVERED BY DESIGN RIGHT (INTELLECTUAL PROPERTY) AND MAY NOT BE DISTRIBUTED, COPIED OR ISSUED WITHOUT WRITTEN PERMISSION OF THE ARCHITECT.
- 4). ALL DESIGN CONCEPTS CONTAINED ON THIS DRAWING ARE THE SOLE PROPERTY OF THE ARCHITECT AND NO ADAPTIONS, REPRODUCTIONS OR COPIES MAY BE MADE WITHOUT WRITTEN PERMISSION OF THE ARCHITECT.
- 5). THESE DRAWINGS MAY BE SUBJECT REVISION FOR THE PROPER CARRYING OUT OF THE WORKS.
- 6). LOCAL AUTHORITY AND STATUTORY REQUIREMENTS MAY OVERRIDE THESE DRAWINGS AND AMENDMENTS MAY BE REQUIRED.
- 7). SAMPLES OF MATERIALS WILL BE REQUIRED TO BE SUPPLIED BY THE CONTRACTOR. THE CONTRACTOR SHALL NOT RELY SOLELY OF THE WRITTEN DESCRIPTION CONTAINED WITHIN THE WORDING ON THESE DRAWINGS.
- 8). ALL FINISHES SHALL BE TO THE ARCHITECTS SATISFACTION.
- 9). ALL CRITICAL DIMENSIONS SHALL BE APPROVED BY THE ARCHITECT BEFORE CONSTRUCTION.
- 9). ANY DISCREPANCY BETWEEN THIS DRAWING AND ON-SITE DIMENSION SHALL BE REFERRED TO THE ARCHITECT FOR CLARIFICATION AND INSTRUCTION BEFORE WORKS ON THAT PART SHALL COMMENCE.

REVISIONS

NO	DATE	DESCRIPTION	BY
A	28.03.18	Information added	GJP

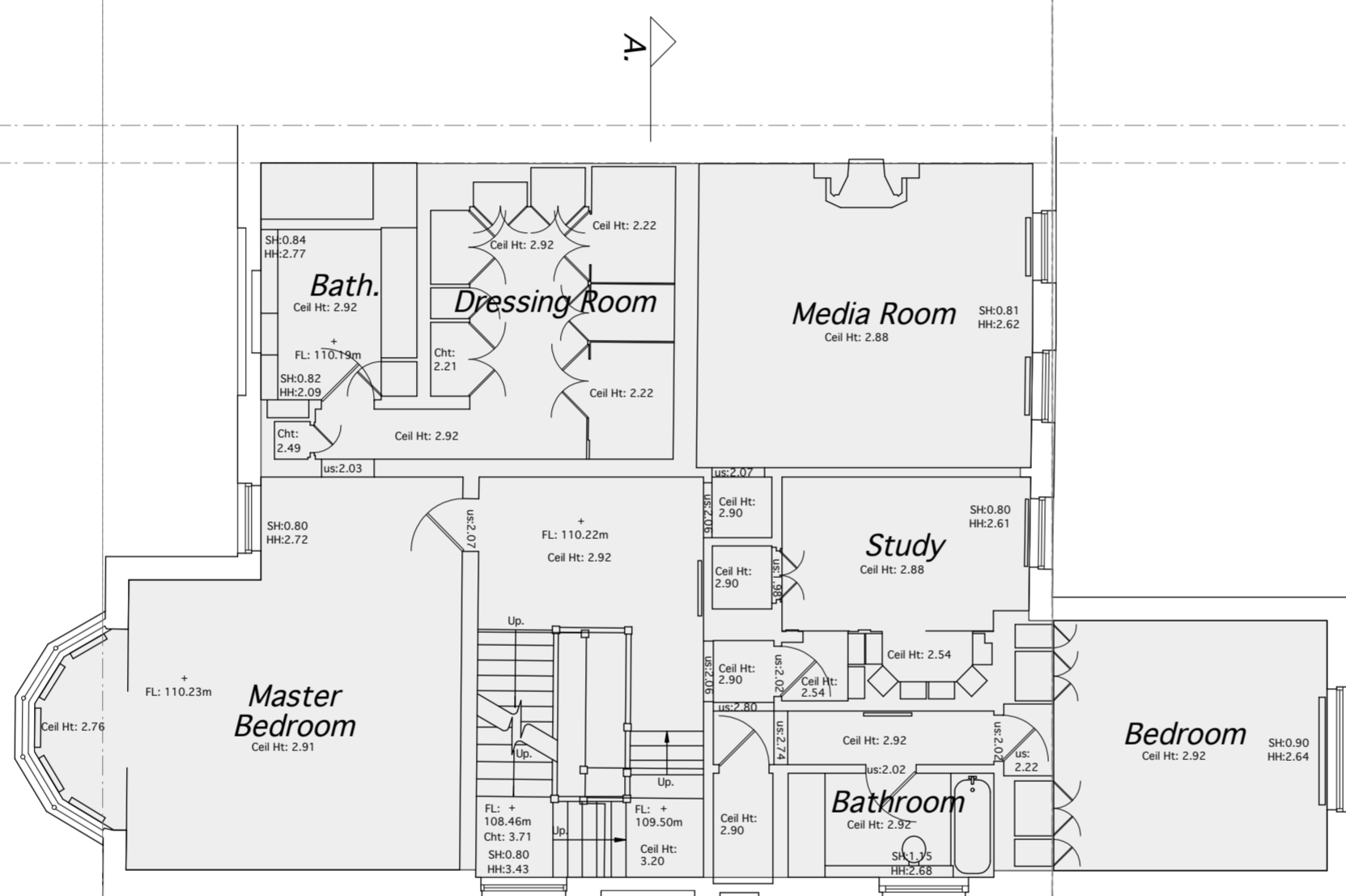

A.

South Elevation

A.

EXISTING FIRST FLOOR PLAN

5d ARCHITECTS
 764 FINCHLEY ROAD
 TEMPLE FORTUNE
 NW11 LONDON 7TH

TELEPHONE 020 8458 4326
 FAX NUMBER 020 8458 4322
 MOBILE NUMBER 07721 598207
 E-mail geoff@5darchitects.org.uk

PROJECT
**6 ROSECROFT AVENUE,
 HAMPSTEAD, LONDON. NW3 7QB.**

DRAWING TITLE
EXISTING FIRST FLOOR PLAN

SCALE **1:100** DATE **16 March 2018**

DRAWING NUMBER
Drawing No. 06.961.03 Rev A