

**KEY**

**PLANNING APPROVAL BOUNDARY**  
2013/1573/P

**EXTENT OF BASEMENT**  
Below Jellicoe Gardens & Peppercorn Lane

**HARD SURFACING: SANDSTONE**

**PAVING TYPE 2: R3 Envelope, Q2 door threshold**  
400mm length x 200mm width x 50mm depth  
Diamond Sawn Scoutmoor Sandstone Paving by Miller Druck or equal and approved  
6mm mortar joints  
Refer to drawing ALD766\_LD722

**HARD SURFACING: GRANITE**

**PAVING TYPE 6 - RECLAIMED GRANITE SETTS - ROUGH:**  
To sidewalk tree pits and cycle stands  
Sourced from site, contractor to confirm mix availability  
120-250mm length x 3 band widths x approx. 100mm depth  
Band 1 80-100mm width  
Band 2 101-115mm width  
Band 3 116-125mm width  
Refer to drawing ALD766\_LD771

**PAVING ADJUSTMENT ROWS**  
Reduced width and/or angled rows of Yorkstone paving to achieve alignment with other paving features (tactile paving, granite setts etc.)

**FURNITURE**

**CYCLE STANDS**  
1000mm height x 1000mm width x 50mm Ø  
stainless steel cycle hoop satin polished finish by Kent Stainless Steel or equal and approved on reclaimed granite setts surround sourced form site

**BENCH TYPE 1**  
To Jellicoe Gardens. Meko bench seasoned european oak  
2000mm length x 471mm width x 448mm height by Wales and Wales or equal and approved

**DEMARICATION STUD**  
To demarcate spillout areas and loading bays  
30mm Ø stainless steel Grade 316 demarcation stud by Kent Stainless or equal and approved.

**LIGHTING FITTINGS**  
4m tall lighting column, LTM44 LED-FT by WE-EF

**MOVEABLE PLANTERS**  
3no. to south of R6, to match existing along Stable Street.  
By Atelier Vierkant and as per the below products:  
1no. type A80, 1no. type A110, 1no. type U80

**TREE SURROUNDS**  
reclaimed granite sett tree surround with:  
10mm wide stainless steel edge enclosing:  
6-10mm Royal White Granite Stone Chippings  
Dashed line denotes tree pit extents shown below  
Refer to drawings ALD766\_LD771

**SOFT LANDSCAPE**

**PROPOSED TREE PLANTING**  
To Tom Stuart-Smith details and specifications

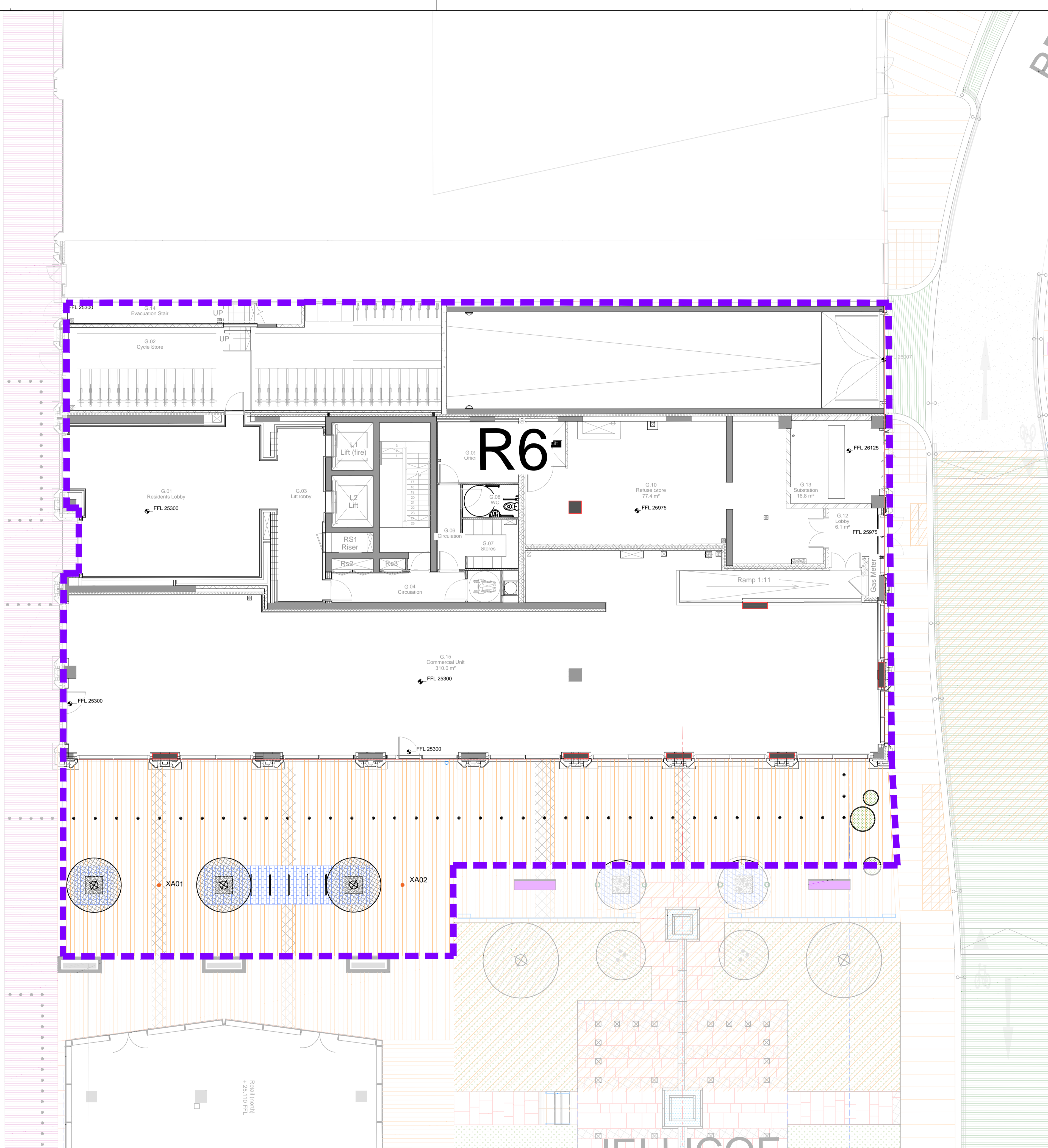

All dimensions to be verified on site. Figured dimensions to take precedent to those scaled. Any areas indicated on this drawing are for guidance only, no responsibility is taken for their accuracy.

The drawing is the property of Applied Landscape Design Limited. Copyright is reserved by them and the drawing is issued on the condition that it is not copied, reproduced, retained or disclosed to any unauthorized person, either wholly or in part without the written consent in writing of Applied Landscapes.

© 2017 Applied Landscape Design Limited. All rights reserved.

**CDM/H&S:**

The works illustrated on this drawing have been reviewed against the Design CDM Risk Register and significant risks are noted as:

**Construction:**

- Handling heavy materials
- Working at height
- Working adjacent to existing structures and buildings
- Trees in Highways

**Maintenance:**

- Light bulb changing

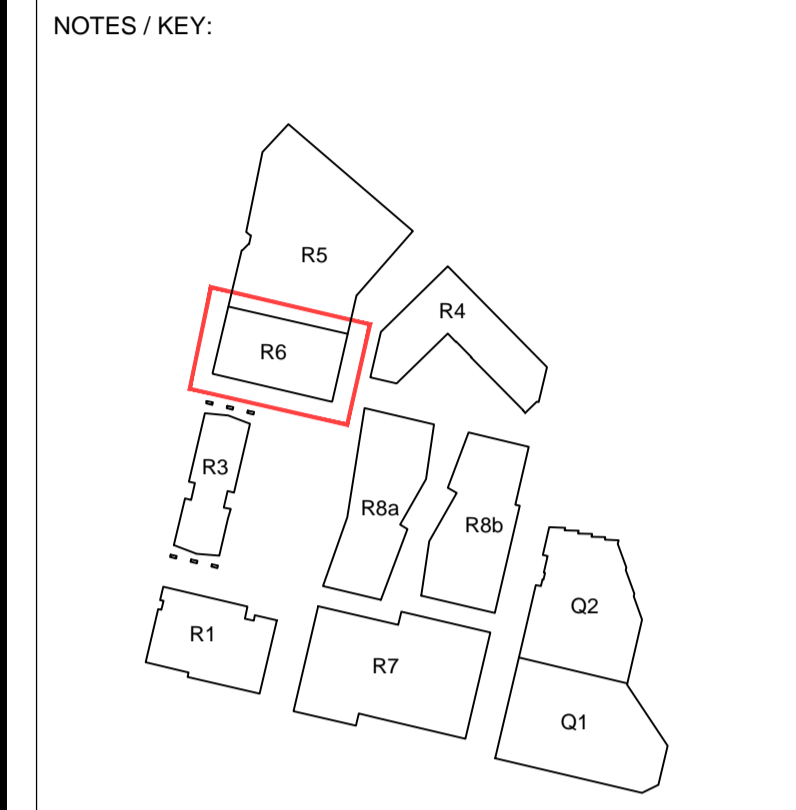

**REFERENCE DRAWINGS/DOCUMENTS**

no.	issued	date
C01	Construction issue - Client details amended	16.03.2018
P01	Issue for approval	14.07.2017

**REVISIONS**

no.	issued	date
C01	Construction issue - Client details amended	16.03.2018
P01	Issue for approval	14.07.2017

**CLIENT:**

**King's Cross**

**LANDSCAPE ARCHITECT:**

The Threshing Barn  
Bignell Park Barns  
Chesham, N. Bucks  
Oxfordshire, OX26 1TD

Tel: 01865 243776  
Email: mail@appliedlandscape.co.uk

**ALD**  
applied landscape design

**PROJECT:**

**Q & R ZONES**  
**KINGS CROSS CENTRAL**

**DRAWING TITLE:**

**R6 PUBLIC REALM**  
**HARD LANDSCAPE LAYOUT**

drawn:	scale:	
CW	1:100 @ A1	
checked:	status:	
KmJ	Construction	
date:	xref file ref:	
13.07.2017	ALD766_MPbase_planning	
PROJECT NO.	DRAWING NUMBER:	REVISION:
ALD766	HL190	C01