

FOR PLANNING APPLICATION PURPOSES ONLY
This drawing has been produced for Duffry Investment Corporation a project named as '6 Erskine Road' and is submitted as part of a planning application relating to the site name only and is not intended for use by any other person or organisation or for any other purpose.
© PKS Architects LLP
Dec 2011

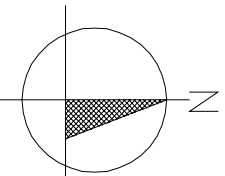
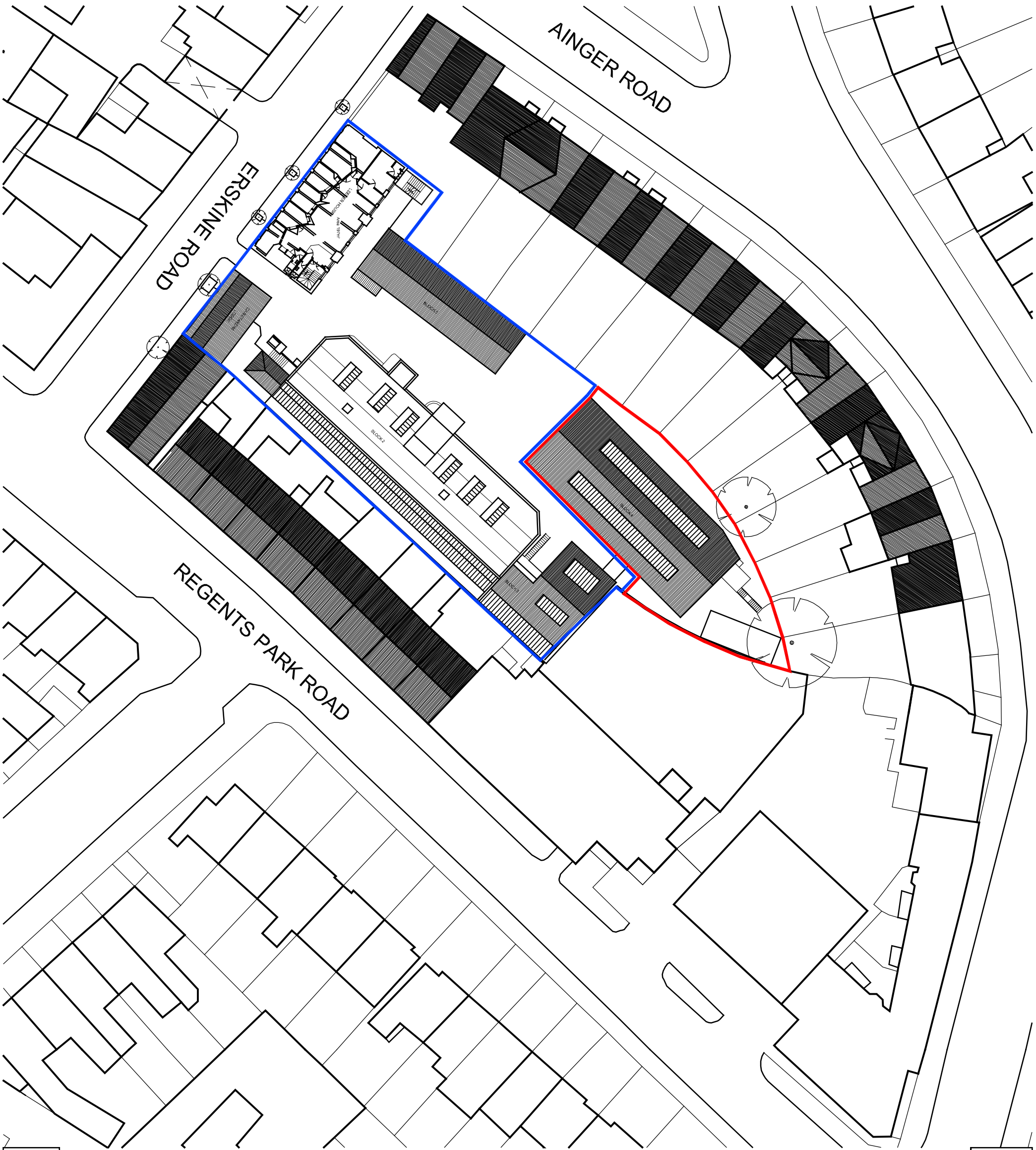

PLANNING

PKS architects
Project: 6 Erskine Road
Title: Site Location Plan
Scale: 1:500 @ A3
Date: 05/10/11
Drawing No: 000-10