

# Triple Doors technical detail

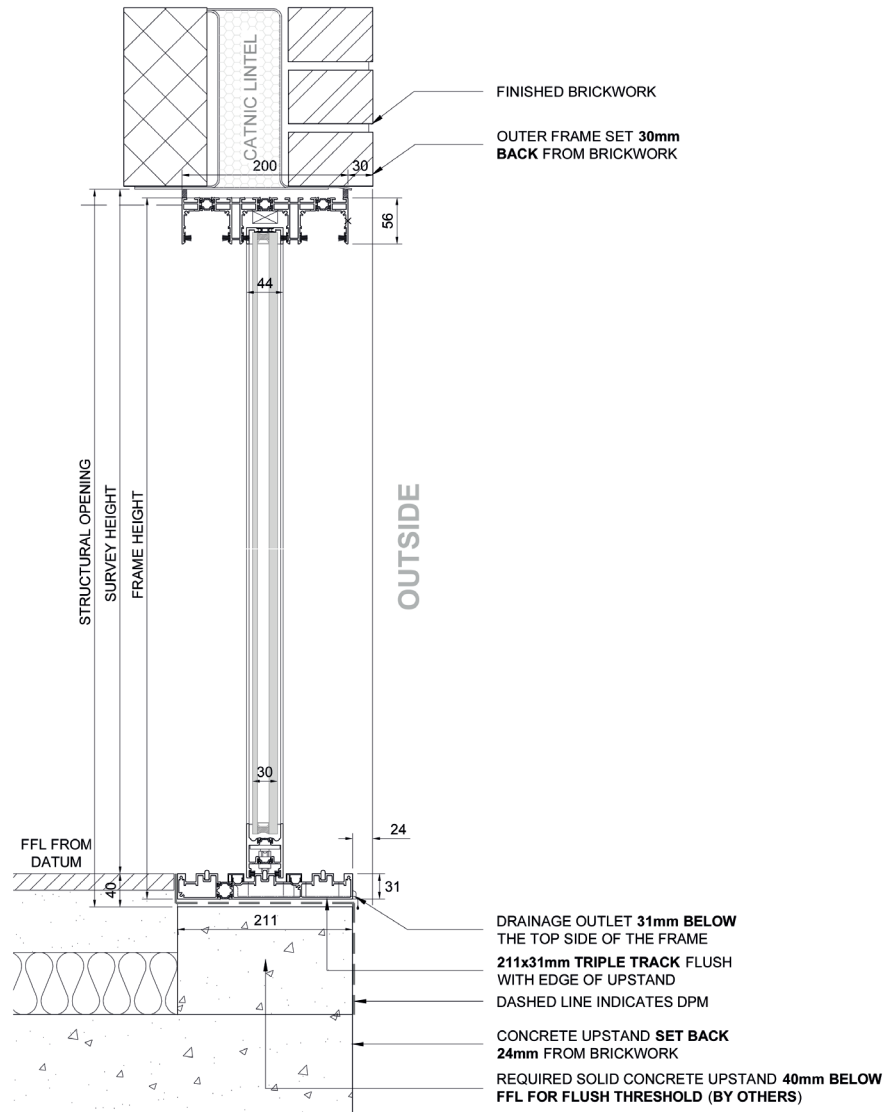

**MAXLIGHT**  
MADE IN LONDON. MADE BY MAXLIGHT.



Bottom lock

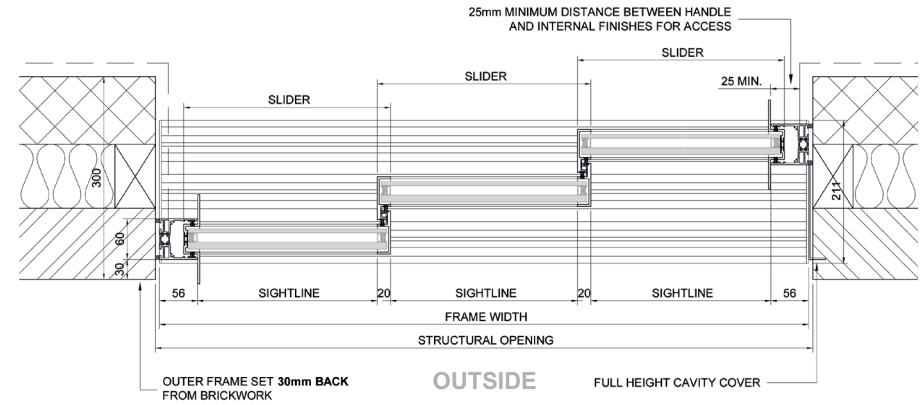

Side lock

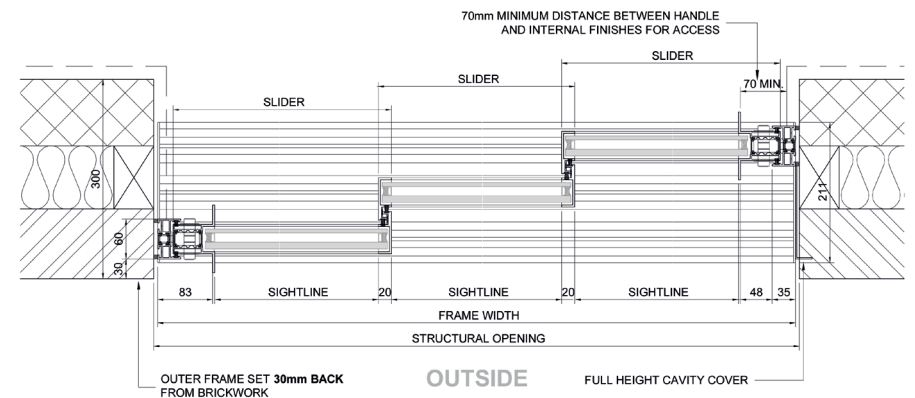



# MAXLIGHT

## PRODUCT SPECIFICATION

Thermally insulated aluminium system for sliding doors/windows, glazing and pivot doors designed for domestic applications. Doors are manufactured to client's requirements using 20mm slim profiles to various configurations.

Sections extruded from aluminium alloy specification 6060/6063 T6 in compliance with BS EN 755-9:2001. Profiles assembled/manufactured to BS EN 1509001/9002

Standard glazing details: Hermetically sealed double glazed units to BS 6262, BS EN 12600, BS 5713. 30mm silicone sealed unit with 14mm argon filled cavity, comprising of 10mm toughened outer pane and inner pane of 6mm toughened low E glass to achieve a centre pane u-value of 1.6W/m<sup>2</sup>K. Glass toughened to BS 6260 BS EN 12150. Additional glazing options are available.

44mm frame depth with 20mm profile technology thermal break structurally bonded to the glass.

The system incorporates a flush threshold with concealed drainage.

Ironmongery/Accessories: Full height handle integrated within profile for unimpeded sightlines. Deadlock operated by 5 pin Euro cylinder. Optional trickle vents.

Finishes: Profiles can be powder coated to any RAL or BS colour to APA Qualicoat guidelines, BS EN 12206-1:2004. Profiles can have different internal and external colours.