

Existing Floor Plan

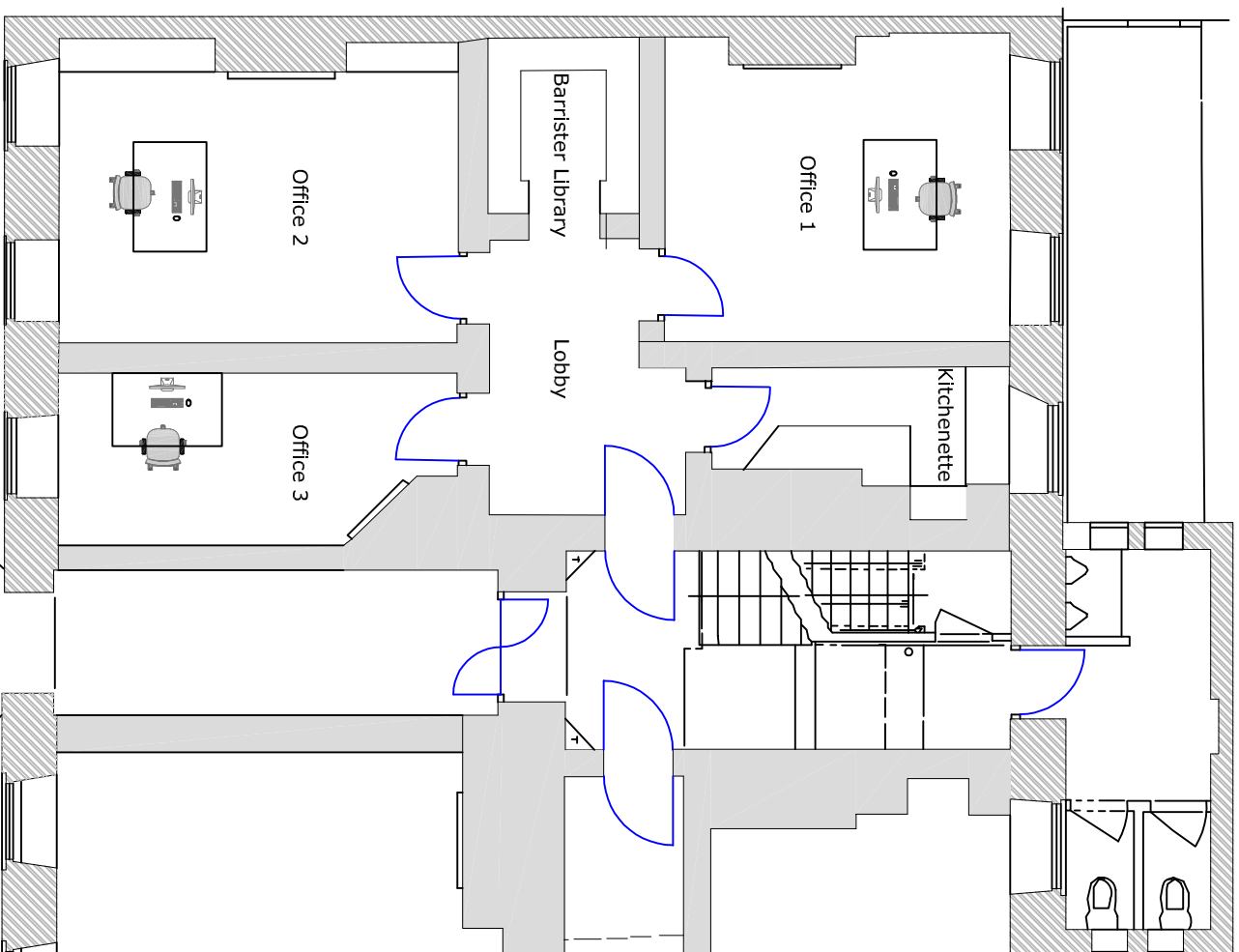

Proposed Floor Plan

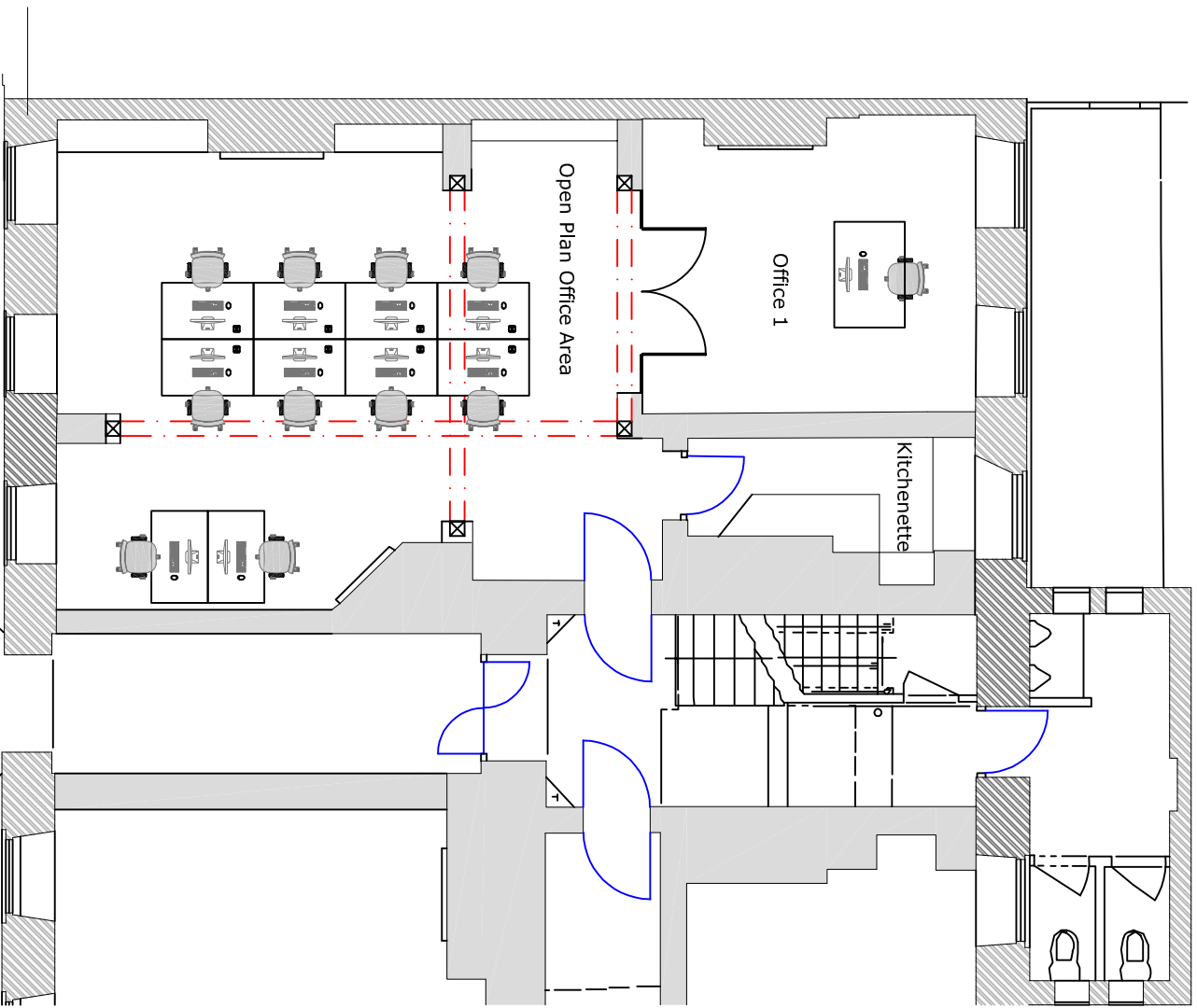

N:\Staff files\Dan Rees\marketing\Logo\wm logo.jpg

T 020 7378 5800  
 F 020 7357 6128  
 E mail@william-martin.co.uk  
 W www.william-martin.co.uk

75 King William Street  
 London  
 EC4N 7BE

JOB TITLE  
 11 New Square  
 Lincoln's Inn

CLIENT  
 Raddiffe Chambers

DWG TITLE  
 Existing and Proposed  
 Basement Layout Plan

SCALE 1/100@3  
 DATE 21/3/2018

TH  
 CHECK DRAWN

DATE REVISION

Rev.No. REV.

DWG NO.  
 11318/E/02