

62 60 58 56

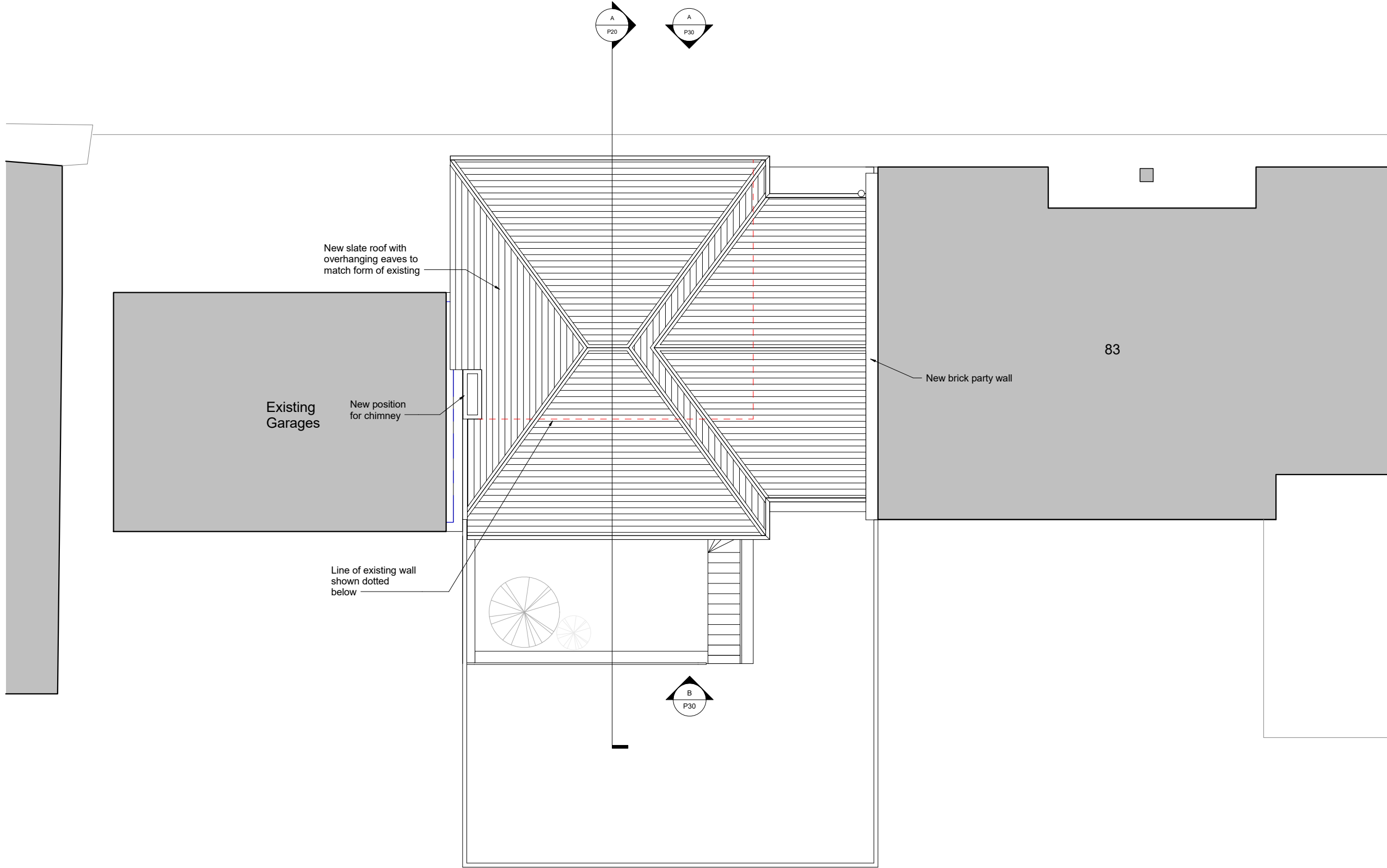

SAFETY, HEALTH AND ENVIRONMENTAL INFORMATION:
 IN ADDITION TO THE HAZARD/RISKS NORMALLY ASSOCIATED WITH THE TYPES OF WORK DETAILED ON THIS DRAWING, NOTE THE FOLLOWING:

Significant Residual Risks:	
Action to be Taken:	Refer to Health and Safety Plan

NOTES:

Only use figured dimensions from issued PDF drawings (not CAD files), where dimensions do not exist please request from architect. We are happy for you to make use of our drawings as long as the information is not used as the basis of any claim against us. If there are any discrepancies between our CAD files and dimensions given on the drawings or on any architectural drawing. Please note that DWG files are created from Dwg so errors may occur during exporting.

REV	DATE	DETAIL	DRN	CHK
P01	18.07.14	Issued for Planning Application	WY	AA
P02	08.03.18	Non-Material Amendment Application	SC	KG

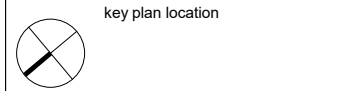

SHEET STATUS	Planning		
PROJECT TITLE	85 Camden Mews		
CLIENT			
DRAWING TITLE	Roof Plan - Proposed		
DATE	SCALE		
18.07.14	1:50 1:100	@A1 @A3	
MODEL STATUS	DRAWN	CHECKED	
S0	AA	JW	

DRAWING NUMBER	REVISION
85_CM - P13	P02

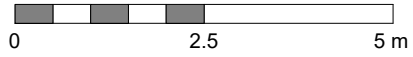

CULLINAN STUDIO
 5 BALDWIN TERRACE LONDON N1 7RU TEL: 020 7704 1975
 PROJECT EMAIL: 85_camdenmews@cullinastudio.com

© Cullinan Studio LTD