

This drawing is a design intent drawing only considering proportion, profiles and visual aesthetics only. All works to be carried out in accordance with the current Building Regulations and to the complete satisfaction of the Building Control and Fire Officers, and to the specific requirements of the relevant British and International Standard Codes of Practice.
 Dimensions shall not be scaled from this drawing.
 The shopfitter shall effect a site survey from which 1:20 scale layout plans and full size rod details shall be produced using information provided on the drawings & manuals issued for this project. The layout plans and primary rods shall be submitted for inspection.
 All material specifications and finishes to be derived from (current version) of the H&M Standard Fitting Out specification.

SHORTS GARDENS

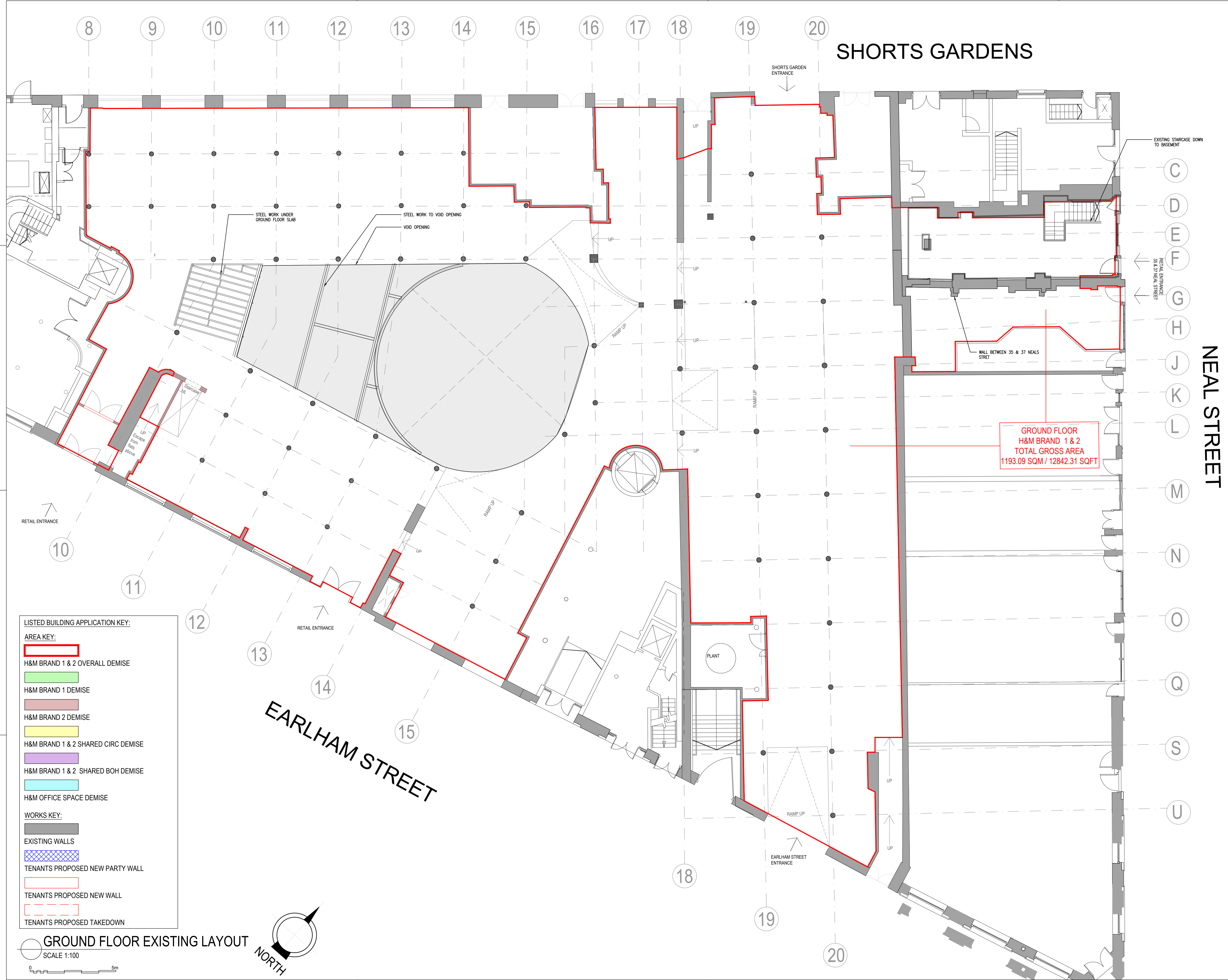

LISTED BUILDING APPLICATION KEY:

AREA KEY:

- H&M BRAND 1 & 2 OVERALL DEMISE
- H&M BRAND 1 DEMISE
- H&M BRAND 2 DEMISE
- H&M BRAND 1 & 2 SHARED CIRC DEMISE
- H&M BRAND 1 & 2 SHARED BOH DEMISE
- H&M OFFICE SPACE DEMISE

WORKS KEY:

- EXISTING WALLS
- TENANTS PROPOSED NEW PARTY WALL
- TENANTS PROPOSED NEW WALL
- TENANTS PROPOSED TAKEDOWN

GROUND FLOOR EXISTING LAYOUT
 SCALE 1:100

NEALS STREET

EARLHAM STREET

GROUND FLOOR
 H&M BRAND 1 & 2
 TOTAL GROSS AREA
 1193.09 SQM / 12842.31 SQFT

NO.	DATE	ISSUE	BY
A	27.02.18	Area key updated	AS
B	09.03.18	Area key wording update	AS

LISTED BUILDING
 APPLICATION #1

STORE NO : -

 CLIENT:
**H&M Hennes & Mauritz UK
 & Ireland Ltd**
 1ST FLOOR, 25 ARGYLL STREET, LONDON, W1F 7TS.
 TEL : + 44 (0) 207 434 8800

PROJECT LOCATION :
**Thomas Neal's Centre,
 29-41 Earlham Street
 Covent Garden**

PROJECT NO : J000987 DATE : 20/12/2017

SHEET TITLE :
GROUND FLOOR EXISTING LAYOUT

SCALE: 1:100 @ A1 / 1:200 @ A3 DRAWN BY: PT
 SHEET NO :

J000987-A1-01-B