

British Museum

**Panizzi Suite,
British Museum**

**HERITAGE, DESIGN AND ACCESS
STATEMENT**

March 2018

5 Bolton Street

London

W1J 8BA

Tel: 020 7493 4002

Fax: 020 7312 7548

www.montagu-evans.co.uk

CONTENTS

Section

- 1.0 Introduction
- 2.0 Site Description
- 3.0 Relevant Planning Policy
- 4.0 The Proposals
- 5.0 Design and Access Statement
- 6.0 Assessment against Planning Policy and Conclusion

APPENDICES

- 1.0 *List Entry: British Museum*

1.0 Introduction

- 1.1 This Heritage, Design and Access Statement has been prepared on behalf of the British Museum in support of an application for listed building consent relating to proposals to refurbish the Panizzi Suite at the British Museum. The description of development is as follows:

“Internal alterations to the existing kitchenette within the Panizzi Suite to create WCs and tea point. Introduction of an extract from existing WC.”

- 1.2 The Panizzi Suite is situated to the east of The King’s Library in the grade I listed British Museum.
- 1.3 The listed building consent application relates only to two rooms in the Panizzi Suite, which are currently used as a kitchenette and a toilet respectively.
- 1.4 The proposals were discussed with officers at the London Borough of Camden and it was agreed that these works were minor and would not harm the special interest of the Grade I listed British Museum. Notwithstanding this, this listed building consent application is being submitted to ensure the proposals are recorded.
- 1.5 This statement should be read in conjunction with the application documents as set out in the accompanying covering letter.

2.0 Site Description

- 2.1 The Panizzi Suite is situated to the east of The King’s Library in the grade I listed British Museum.
- 2.2 The British Museum was first established at Montagu House in 1759. The museum underwent a series of extensions and alterations, and Montagu House was demolished in 1840 to make way for a new purpose built main building.
- 2.3 Sir Robert Smirke (1780-1867) designed a large, neo-classical style building which was built in stages to occupy a block to the south of Montague Place. The building consisted of four wings, oriented around a central quadrangle, with projecting wings to the south west.
- 2.4 Smirke’s 1838 Plan for the ground floor (Plate 1) shows the layout of the museum, including a proposed extension to the south east indicated as ‘Site proposed for the Officers Apartments’. This is to the south of the boundary wall of the museum, in line with the gardens of the houses to Montague Street.
- 2.5 The scale of the Museum complex can be seen in the 1896 OS Map at Plate 2, occupying the centre of an entire block, with residential terraces to the north, east and west arranged along the distinctive grid street layout with open landscaped squares.

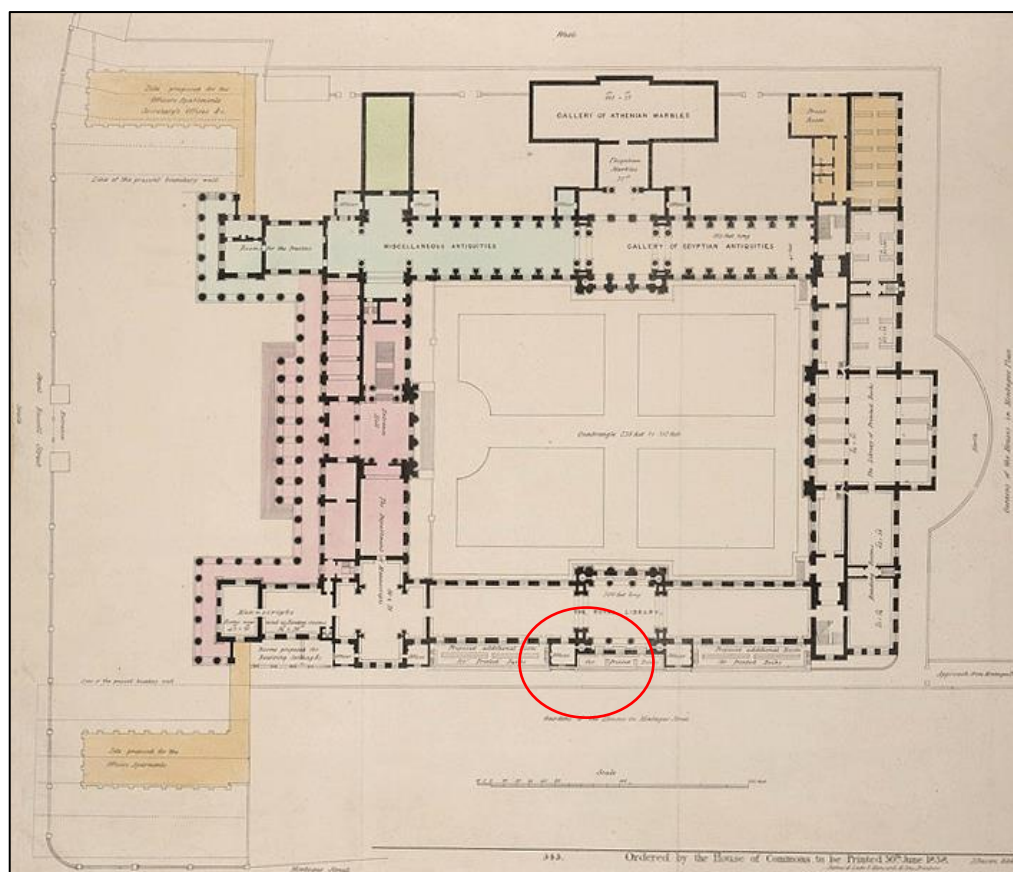

Plate 1: Smirke's 1838 plan for the museum

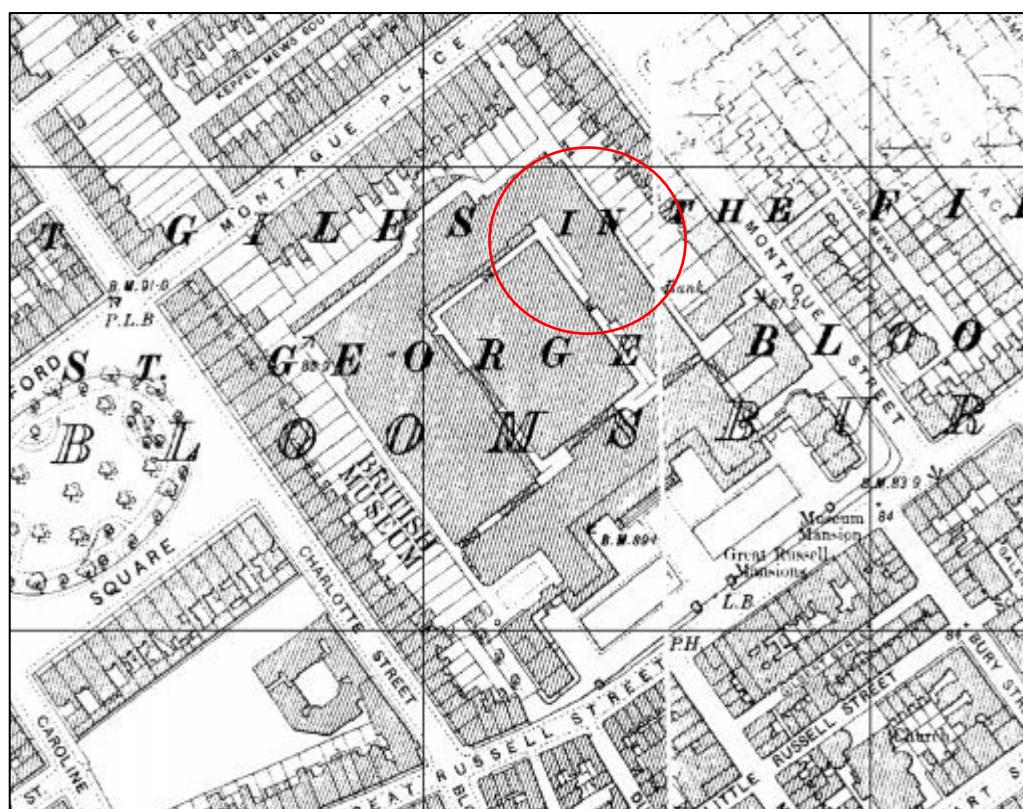

Plate 2: 1896 OS showing the Museum

- 2.6 The location of the Panizzi Suite, incorporated into the original layout from 1840, is shown indicatively by the red circle. The suite is named after the former Director of the British Library, Antonio Panizzi.
- 2.7 The Panizzi Suite currently comprises office rooms and associated kitchenette facilities. We understand that this underwent refurbishment in the 1970s and then again in the 1990s.
- 2.8 A recent visit to the kitchenette that is the subject of this application demonstrates that the suite has been re-fitted as a modern kitchen, and no features of historic or architectural interest remain. Whilst the room forms part of the Panizzi Suite, which is Grade I listed with the British Museum, the kitchenette does not possess intrinsic architectural or historic interest that contributes to the overall appreciation of the asset. The interiors of this room are not sensitive to change.
- 2.9 Similarly, the WC which is being refurbished also with these works, and which sits adjacent the office north end is understood to have formerly been Panizzi's own private WC, although the fittings have been replaced and it is now a modern bathroom.
- 2.10 Photographs of the kitchenette affected by the proposals are included at plate 3.



Plate 3. Photographs of the kitchenette and the area that will be affected by the soil pipes to be routed behind the wall

3.0 Relevant Planning Policy

- 3.1 This section sets out the planning policy context for the redevelopment of the Site, including national and local guidance and other material considerations.

Legislative Framework

- 3.2 The applicable legislative framework to this assessment includes the following:
- The Planning (Listed Buildings and Conservation Areas) Act 1990 (“the 1990 Act”).

Planning (Listed Buildings and Conservation Areas) Act 1990

- 3.3 Sections 16(2) states that in considering whether to grant listed building for any works the local planning authority or Secretary of State shall have special regard to the desirability of preserving the building or its setting or any features of special architectural or historic interest which it possesses.

Development Plan

- 3.4 Section 38(6) of the Planning and Compulsory Purchase Act 2004 states that planning applications must be determined in accordance with the adopted Statutory Development Plan, unless material considerations indicate otherwise. The currently adopted Statutory Development Plan is formed from the following documents:

- The London Plan (2016);
- The Camden Local Plan (2017).

London Plan (2011 with alterations 2016)

- 3.5 Policy 7.8 (Heritage Assets and Archaeology) outlines policy requirements for development affecting heritage assets. The supporting text states that crucial to the preservation of London’s unique character is the careful protection and adaptive re-use of heritage buildings and their settings.

Camden Local Plan (2017)

- 3.6 The relevant policies of Camden’s Local Plan are:

- 3.7 Policy D1 (Design), which requires that development:

- “a. respects local context and character;*
- b. preserves or enhances the historic environment and heritage assets in accordance with Policy D2 – Heritage;*

- c. Is sustainable in design and construction, incorporating best practice in resource management and climate change mitigation and adaptation;*
- d. is of sustainable and durable construction and adaptable to different activities and land uses;*
- e. comprises details and materials that are of high quality and complement the local character;*
- g. is inclusive and accessible for all;*

The council will resist development of poor design that fails to take the opportunities available for improving the character and quality of an area and the way it functions.”

- 3.8 The following relevant parts of the policy relate to Listed Buildings.

“To preserve or enhance the borough’s listed buildings, the Council will:

- i. resist the total or substantial demolition of a listed building;*
- j. resist proposals for a change of use or alterations and extensions to a listed building where this would cause harm to the special architectural and historic interest of the building.”*

Material Considerations

National Planning Policy Framework (NPPF) 2012

- 3.9 At the outset, paragraph 14 sets out the presumption in favour of sustainable development that “should be seen as a golden thread running through both plan-making and decision-taking”, subject to specific policies in the NPPF that indicate development should be restricted, such as those towards heritage assets.

Heritage

- 3.10 Paragraph 128 requires applicants to describe the significance of any heritage assets affected by a Proposed Development, including any contribution made by their setting. The level of detail should be proportionate to the assets’ importance and no more than is sufficient to understand the potential impact of the proposal on their significance. This requirement is fulfilled through the provision of this Planning and Heritage Statement.
- 3.11 Paragraph 129 states that *“Local planning authorities should identify and assess the particular significance of any heritage asset that may be affected by a proposal (including by development affecting the setting of a heritage asset) taking account of the available evidence and any necessary expertise. They should take this assessment into account when considering the impact of a proposal on a heritage asset, to avoid or minimise conflict between the heritage asset’s conservation and any aspect of the proposal.”*
- 3.12 Paragraph 131 states that:

“In determining planning applications, local planning authorities should take account of:

- The desirability of sustaining and enhancing the significance of heritage assets and putting them to viable uses consistent with their conservation;*
- The positive contribution that conservation of heritage assets can make to sustainable communities including their economic vitality; and*
- The desirability of new development making a positive contribution to local character and distinctiveness.”*

3.13 Paragraph 132 states:

“When considering the impact of a proposed development on the significance of a designated heritage asset, great weight should be given to the asset’s conservation. The more important the asset, the greater the weight should be. Significance can be harmed or lost through alteration or destruction of the heritage asset or development within its setting. As heritage assets are irreplaceable, any harm or loss should require clear and convincing justification.”

3.14 The Glossary contained in Annexe 2 of the NPPF defines ‘conservation’ in relation to heritage as:

“The process of maintaining and managing change to a heritage asset in a way that sustains and, where appropriate, enhances its significance.”

3.15 Ultimately, the preservation of significance is paramount in planning considerations relating to the historic environment. Therefore, concern for the preservation of fabric or particular features, although likely to be relevant considerations for an individual case, is superseded by the necessity of sustaining significance.

3.16 Additional Material Considerations include:

- Planning Practice Guidance (First Live 2014) (“PPG”);
- Historic Environment Good Practice Advice in Planning, Note 2, Managing Significance in Decision-Taking in the Historic Environment (2015);
- Conservation Principles: English Heritage (2008); and
- Bloomsbury Conservation Area Appraisal and Management Strategy (2011).

Emerging Policy

New London Plan

3.17 A consultation version of the New London Plan was issued in November 2017. Heritage policies are contained in Chapter 7 called ‘Heritage and Culture’. Part C of Policy HC1 ‘Heritage Conservation and Growth’ states that development proposals affecting

heritage assets, and their settings, “*should conserve their significance, by being sympathetic to the assets’ significance and appreciation within their surroundings.*”

4.0 The Proposals

- 4.1 The proposals comprise the creation of WC facilities and beverage bay to the second floor of the Panizzi Suite, British Museum. The proposals include also the replacement of the bathroom facilities in an existing WC connected to the north office.
- 4.2 The works include for the insertion of an extract fan and a louvre to the eastern elevation of the Panizzi suite in association with these refurbishments.
- 4.3 The scope of works that are the subject of this application is as follows:
- Creation of two cubicles, one ambulant disabled with wall and floor mounted grab rails;
 - New stud partitioning to full height formed of 100 x 50mm timber studs;
 - Ducted ventilation to extract through external wall
 - New painted doors to bathroom cubicles;
 - Temporary removal of existing oak faced door and frame from kitchen, and reinstatement in the same position;
 - Infilling of roof lights at ceiling level to beverage bay;
 - Replacement of WC facilities
- 4.1 The proposals affect two small rooms of the internal layout. The layout is shown on the proposed plan Ref AB 1/3.
- 4.2 Turning to the kitchenette area, the proposals will require the insertion of modern partitions into the space, and the installation of new services which will require the routing of new soil pipes through the floors.
- 4.3 The existing WC will be re-fitted to replace the basin and wet fittings, repair the window opening and provide mechanical extract in the east elevation via a louvre.
- 4.4 The proposals were discussed with officers at the London Borough of Camden and it was agreed that these works were minor and would not affect the overall significance of the Grade I listed building. Notwithstanding this, this listed building consent application is being submitted to ensure the proposals are recorded.

5.0 Design and Access Statement

- 5.1 This Design and Access Statement has been completed in accordance with the Government Circular 01/2006 and the guidance provided in the CABE document, entitled '*Design and Access Statements: How to write, read and use them*'.

Use

- 5.2 The Panizzi Suite at the British Museum is in office use in association with and in support of the Museum functions (D1). The proposals comprise the replacement of the existing, modern WC and kitchenette fittings with a new tea point and WC facilities. These will support the improvements being made to the quality of the existing office accommodation.

Amount

- 5.3 One of the rooms at present is a kitchenette facility, the other WC. The modern fixtures in the kitchenette will be removed, and replaced with a smaller tea point and two WC cubicles, in accordance with the 'Proposed' drawing Ref AB 1/3. One extract is proposed to ventilate this area also, as shown on drawing 226961-FCG-MB-02-DR-M-5602-D2-C01 – the Panizzi Suite Level 2 Mechanical Services Proposed Heating and Ventilation Layout.
- 5.4 The existing WC facilities within the WC connected to the north office will be replaced and a new louvre added to the east elevation as shown on drawing 226961-FCG-MB-02-DR-M-5602-D2-C01.

Layout

- 5.5 The new tea point and WCs will be located within the second floor of the existing Panizzi Suite. They affect a small area of the internal layout. The layout is shown on the proposed plan Ref AB 1/3.

Scale

- 5.6 The application relates only to two rooms in the Panizzi Suite.

Landscaping

- 5.7 This aspect is not applicable to the application.

Appearance

- 5.8 The new services will be located within two room, with one extract fan and one louvre manifest on the east elevation of the Panizzi Suite.

Access

- 5.9 Access to the new kitchenette and WCs will be via Corridor A/2/012, as shown on drawings AS 1/3 and AB 1/3. A new opening will be created in the existing window to provide access to the tea point.
- 5.10 One of the two new WC cubicles will be suitable for ambulant disabled use, including wall and floor mounted grab rails and door measuring 2040 x 826 x 44mm.

6.0 Assessment against Planning Policy and Conclusion

- 6.1 As set out in **Section 4.0** this listed building consent application relates to internal alterations to an existing kitchenette at second floor level within the Panizzi Suite, to create two WC cubicles, one ambulant disabled accessible, and a new tea point.
- 6.2 The improved kitchenette and new WC provisions will improve the quality of the office accommodation for the British Museum.
- 6.3 The proposals are discretely located within the Panizzi Suite, an early 20th century addition to Robert Smirke's British Museum complex. As illustrated in the photographs at **Section 2.0**, there are no features of interest within the existing space, which is not publicly accessible.
- 6.4 The proposals will necessitate the removal of a small amount of fabric to facilitate the installation of ducted ventilation and drainage for WCs. Whilst the original masonry walls and the floor structures may retain some original fabric, this will have previously been altered and disturbed through the insertion of modern facilities and services. Any further removal or alteration as part of these works will not affect the special interest of the grade I listed building.
- 6.5 The addition of the extract fan and the louvre to provide mechanical ventilation to the east elevation will be discreet, small openings formed for the efficient function of these spaces. The location of these openings are shown in drawing with reference: 226961-FCG-MB-02-DR-M-5602-D2-C01 – the Panizzi Suite Level 2 Mechanical Services Proposed Heating and Ventilation Layout. The overall character and appearance of the elevation will not be affected as a result of the changes.
- 6.6 Our conclusion, as discussed with officers, is that the proposed works to both the kitchenette and the existing WC will not affect the significance of the Grade I listed building. The proposals are to support the improvements being made to the quality of the existing office accommodation in the Panizzi Suite and support overall the functions of the British Museum.
- 6.7 Furthermore, the changes will not be visible in public views, and will not have any effect on the conservation area.
- 6.8 As discussed at **Section 3.0**, the preservation of significance is paramount in planning considerations relating to the historic environment. Therefore, concern for the preservation of fabric, although likely to be a relevant consideration for an individual case, is superseded by the necessity of sustaining significance. In this case, the fabric to be removed is of no particular interest, and therefore the significance of the listed building will be preserved.
- 6.9 Therefore, we judge that the proposals preserve the historic environment and heritage assets in accordance with Policy D1 of the Camden Local Plan, Policy 7.8 of the London Plan and the Section 66(1) of the Planning (Listed Buildings and Conservation Areas) Act.

Appendix 1

List Entry

THE BRITISH MUSEUM KING EDWARD VII GALLERIES AND ATTACHED WALL AND LIONS

List Entry Summary

This building is listed under the Planning (Listed Buildings and Conservation Areas) Act 1990 as amended for its special architectural or historic interest.

Name: THE BRITISH MUSEUM KING EDWARD VII GALLERIES AND
ATTACHED WALL AND LIONS

List entry Number: 1322129

Location

THE BRITISH MUSEUM KING EDWARD VII GALLERIES AND
ATTACHED WALL AND LIONS, MONTAGUE PLACE

The building may lie within the boundary of more than one authority.

County: Greater London Authority

District: Camden

District Type: London Borough

Parish:

National Park: Not applicable to this List entry.

Grade: I

Date first listed: 24-Oct-1951

Date of most recent amendment: 11-Jan-1999

Legacy System Information

The contents of this record have been generated from a legacy data system.

Legacy System: LBS

UID: 477532

Asset Groupings

This list entry does not comprise part of an Asset Grouping. Asset Groupings are not part of the official record but are added later for information.

List entry Description

Summary of Building

Legacy Record - This information may be included in the List Entry Details.

Reasons for Designation

Legacy Record - This information may be included in the List Entry Details.

History

Legacy Record - This information may be included in the List Entry Details.

Details

CAMDEN

TQ2981NE MONTAGUE PLACE 798-1/99/1144 (North side) 24/10/51 The British Museum King Edward VII Galleries and attached wall and lions (Formerly Listed as: GREAT RUSSELL STREET (North side) King Edward VII Gallery, British Museum)

GV I

Museum gallery forming part of The British Museum (qv). 1905-14. By Sir John Burnet, assisted by Thomas Tait. Portland stone and marble. EXTERIOR: 2 storeys and semi-basement, 21 bays. Symmetrical Edwardian Beaux Arts facade with a screen of attached Ionic columns on a podium and flat, higher square erections at the angles. Commercial metal framed windows, on both floors, between the columns. Granite door frame with inner frame of enriched marble. Above this an inscribed foundation stone and gilded wreaths on the flanking columns. Cornice with protruding carved lions' heads at intervals. Deep blocking course with guttae at intervals and parapet above having, at intervals, carved crowns with the initials ER under. INTERIOR: in fine neo-Classical style. Low top-lit hall. Stair lined with Greek marble; a pair of black columns with a large Buddha between in the well and a gilt bronze lift cage to one side. Galleries in trabeated Smirke style; stripped Classical detailing. North Library, behind the stair, altered from Burnet's original mannerist concept. SUBSIDIARY FEATURES: attached stone wall to areas terminating at either side of the main entrance with carved stone lions, having crossed front paws, by Sir George Frampton.

Listing NGR: TQ2997681722

Selected Sources

Legacy Record - This information may be included in the List Entry Details

National Grid Reference: TQ 29991 81801

Map

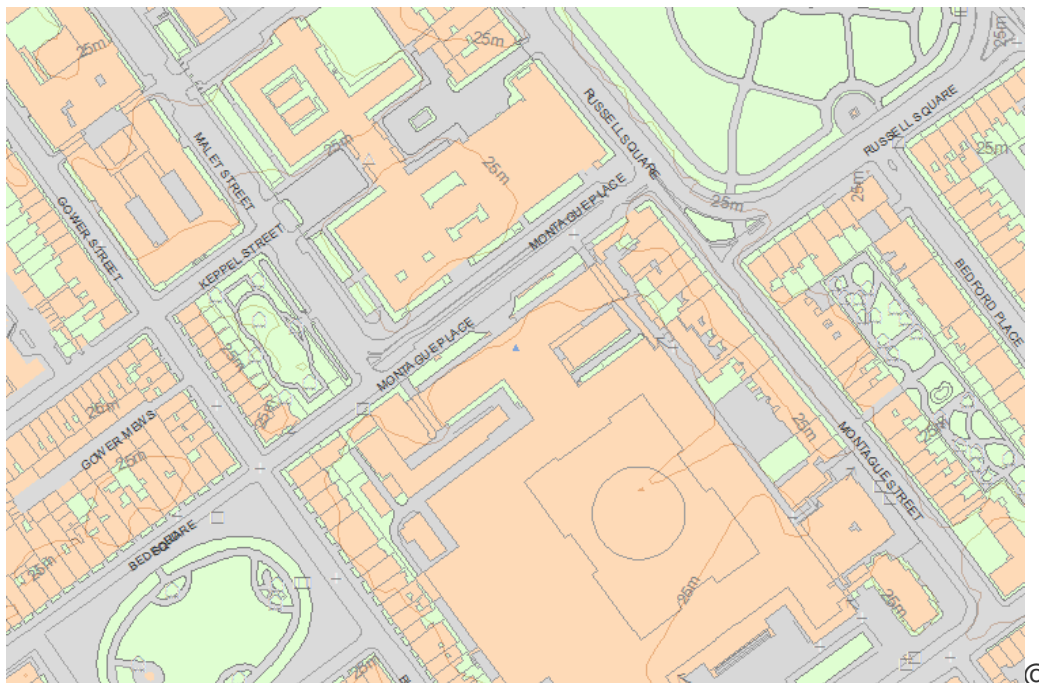

Crown Copyright and database right 2018. All rights reserved. Ordnance Survey Licence number 100024900.

© British Crown and SeaZone Solutions Limited 2018. All rights reserved. Licence number 102006.006.

Use of this data is subject to [Terms and Conditions](#).

The above map is for quick reference purposes only and may not be to scale. For a copy of the full scale map, please see the attached PDF - [1322129 .pdf](#)

The PDF will be generated from our live systems and may take a few minutes to download depending on how busy our servers are. We apologise for this delay.

This copy shows the entry on 19-Mar-2018 at 11:09:48.

End of official listing