

FIRST FLOOR PLAN
 EXISTING STRUCTURE

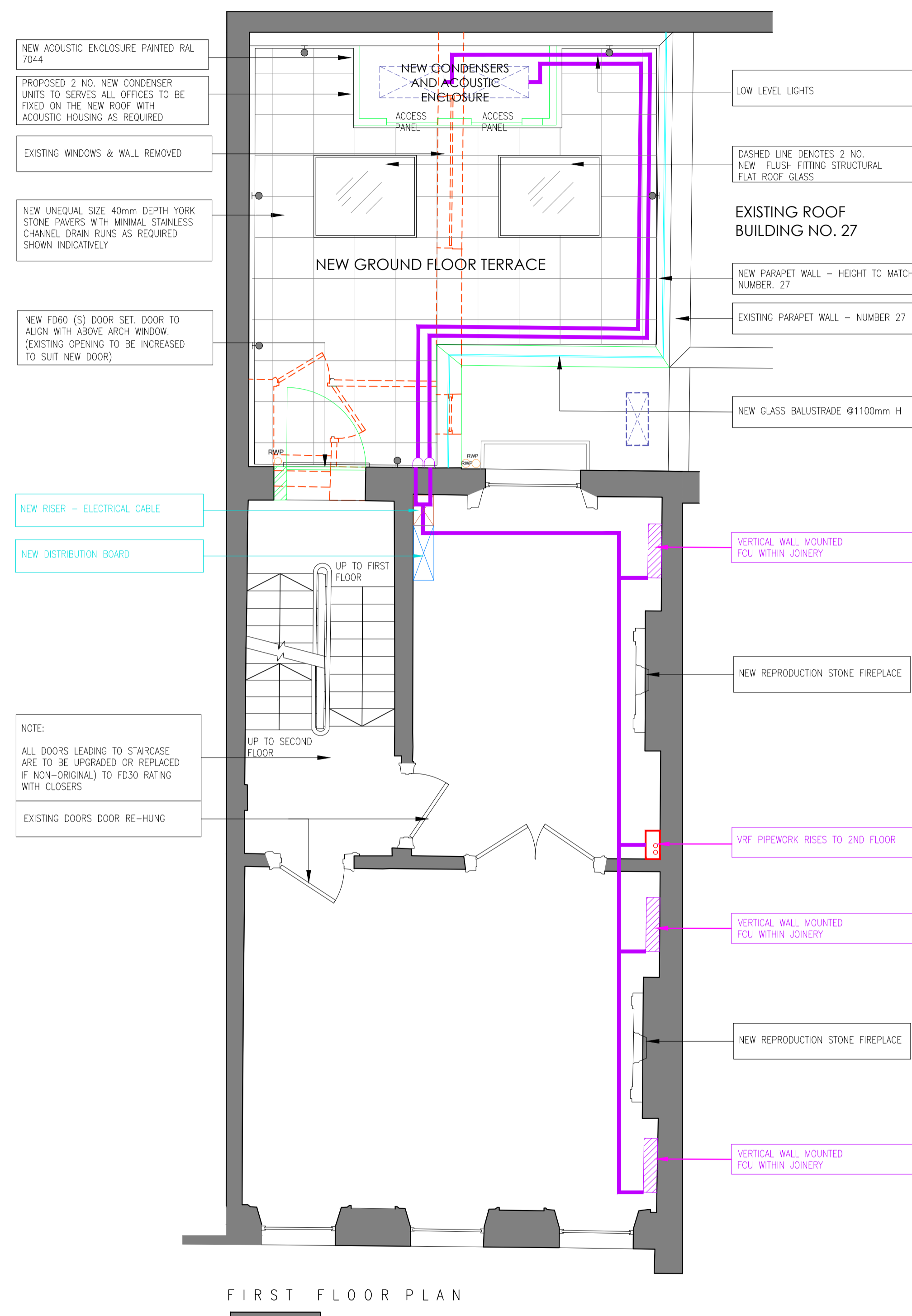
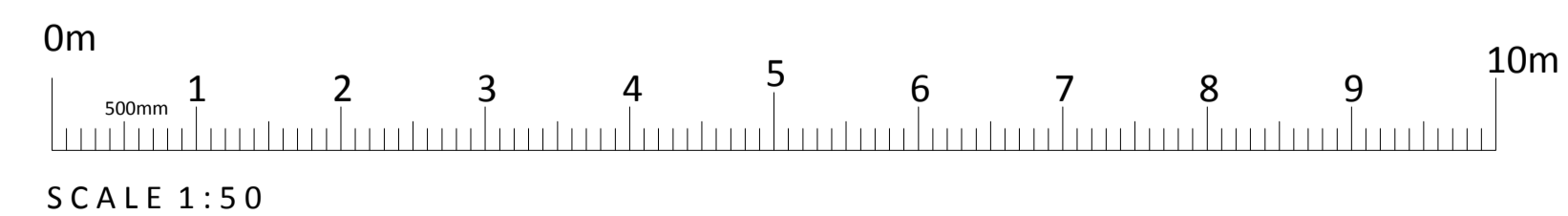

FIRST FLOOR PLAN
 EXISTING STRUCTURE - - - - - DEMOLITION

PROPOSED

LEGEND - MECHANICAL SERVICES

- NEW FAN COIL UNIT
- NEW PIPEWORK AT LOW LEVEL
- NEW PIPEWORK AT HIGH LEVEL

LEGEND - ELECTRICAL

- RISER FOR ELECTRICAL CABLES
- ELECTRICAL DISTRIBUTION BOARD

REV	DATE	PURPOSE	DRAWN
F	22/02/18	ISSUED FOR PLANNING	VP
E	22/01/18	ISSUED TO TEAM FOR COMMENTS V4	VP
D	06/11/17	ISSUED TO CAMDEN CITY COUNCIL	VP
C	25/10/17	ISSUED FOR PSC COMMENTS	VP
B	31/08/17	ISSUED TO CAMDEN CITY COUNCIL	VP
A	25/08/17	ISSUED FOR COMMENTS	VP

CLIENT PSG GLOBAL
 PROJECT 28 FITZROY SQUARE
 TITLE EXISTING & PROPOSED FIRST FLOOR PLANS

REVISION	DWG No.	SCALE	1:50 @ A1
F	SKK2131/103	DRAWN	CHECKED
	AUG '17	VP	APF

PSG GLOBAL

senken DESIGN

INTERIOR, ARCHITECTURAL & RETAIL DESIGN

The Mill
 Stortford Road
 Hatfield Health
 CM22 7DL
 Tel: 01279 873010
 www.senken.co.uk