

SECOND FLOOR PLAN

EXISTING STRUCTURE

EXISTING

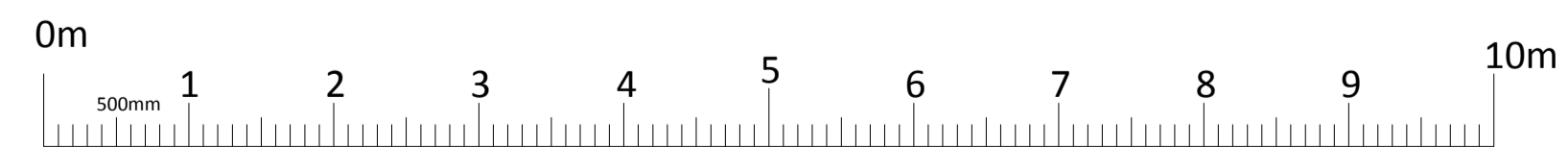

SCALE 1:50

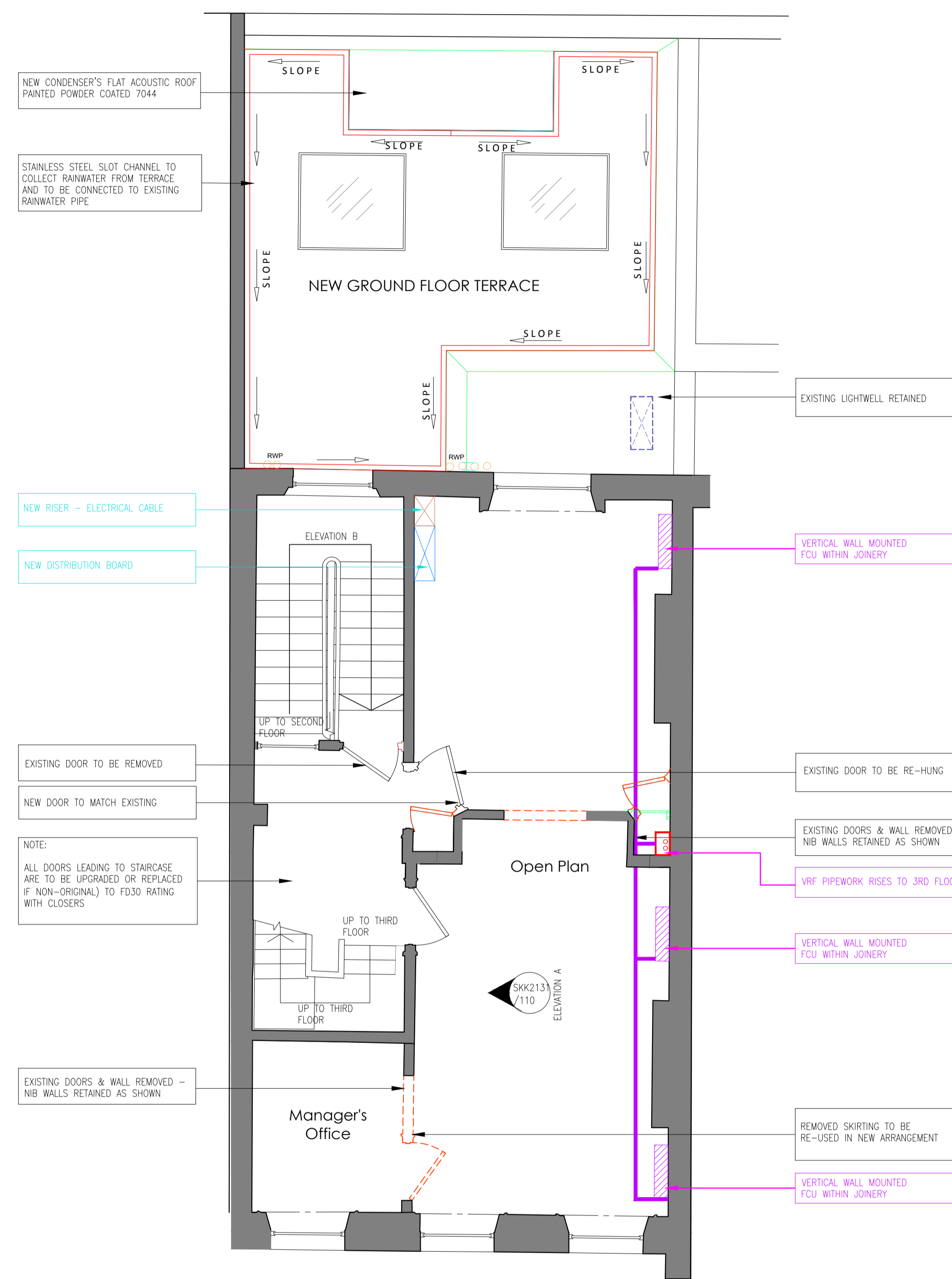

SECOND FLOOR PLAN

EXISTING STRUCTURE NEW PARTITION DEMOLITION

PROPOSED

LEGEND - MECHANICAL SERVICES

- NEW FAN COIL UNIT
- NEW PIPEWORK AT LOW LEVEL
- NEW PIPEWORK AT HIGH LEVEL

LEGEND - ELECTRICAL

- RISER FOR ELECTRICAL CABLES
- ELECTRICAL DISTRIBUTION BOARD

F	22/02/18	ISSUED FOR PLANNING	VP
E	22/01/18	ISSUED TO TEAM FOR COMMENTS V4	VP
D	06/11/17	ISSUED TO CAMDEN CITY COUNCIL	VP
C	25/10/17	ISSUED FOR PSC COMMENTS	VP
B	31/08/17	ISSUED TO CAMDEN CITY COUNCIL	VP
A	25/08/17	ISSUED FOR COMMENTS	VP

REV	DATE	PURPOSE	DRAWN
CLIENT PSG GLOBAL			
PROJECT 28 FITZROY SQUARE			
TITLE EXISTING & PROPOSED SECOND FLOOR PLANS			
REVISION	DATE	DRAWN	CHECKED
F	AUG '17	VP	APF



INTERIOR, ARCHITECTURAL & RETAIL DESIGN

The Mill
Storford Road
Hatfield Health
CM22 7DL

Tel: 01279 873010
www.senken.com