

ALL ELEVATIONS VIEWED FROM THE OUTSIDE UNLESS OTHERWISE STATED

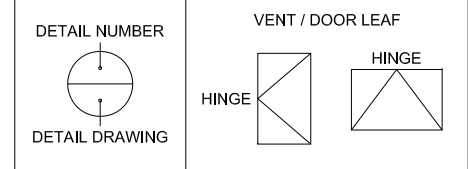

KEY PLAN

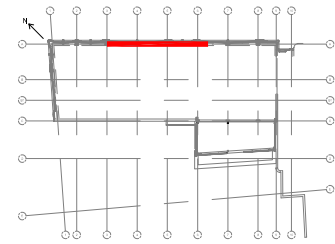

01	ISSUED FOR INFORMATION	23.02.18	MAV	CA
No	Revision	Date	Initial	Chkd

<p style="text-align: center;">WINTech FACADE ENGINEERING CONSULTANCY</p> <p style="text-align: center;">Quartz House, Pendeford Business Park, Wobaston Road, Wolverhampton, WV9 5HA Tel: +44(0)1902 307430 Email: enquiries@wintech-group.co.uk</p>				
Project Name : 182 - LONA HIGH HOLBORN, LONDON				
Drawing Title : EWS-05 - PROPOSED CILL DESIGN TO REDESIGNED AREA				
Status : INFORMATION		Scale :1:5 @ A3	Date : 17.02.18	
Project No :		Drawing No :	Rev :	
02164		SK-503	01	