

NOTES:
All dimensions must be checked on site and not scaled from this drawing.
All cross references are to the latest revision of the relevant drawing or specification being referenced.

Drawing to be printed at A1 size only to ensure clarity

- 2.55m high boundary wall and gates to entrance - Refer to Jestico and Whites details
- Existing boundary retained
- Brick supporting piers with metal railings
- 3.0m high weldmesh balltop fence with integrated lockable gates Q40.125A
- New boundary with primary school retaining wall and weldmesh fence to a total height of 2.2m. Refer to engineers details Q40.125B
- Vertical panels to encourage plant growth and provide screening- Refer to drawing 1566_LD_502 Q40.340A
- 1.8m timber and steel fence with double leaf gate to be carried out by Camden Council 1566_LD_501 Q40.310A
- PCC paving to frontage to match existing. Paving works to be carried out by Camden Council
- Type 1 - New permeable asphalt surface to external sports pitch. To engineer specification
- Type 2 - New impermeable asphalt To engineer specification
- Type 3 - Cast in-situ concrete surfacing to bin store. To engineer specification
- Type 4 - Vehicular asphalt paving. To engineer specification
- Flat top PCC edging 50mm Q10.110
- 150x305 PCC Kerb Q10.112
- Cast in situ concrete retaining wall to engineers design and specification
- Handrail to steps L37.110
- Proposed tree planting
- Proposed planting
- Proposed aco drain to civil engineers specification
- Proposed gully to civil engineers specification
- Lighting columns to mechanical and electrical engineers specification

- Frontage works carried out by Camden Council
- Pedestrian guard rail Q41.130A
- Door Restraining Hoop Q41.130B
- Manhole cover to civil engineers specification
- Recessed manhole cover to civil engineers specification
- Covered cycle shelter B91.340
- Bin store. Refer to drawing 1566_LD_501 Q40.310A
- Cycle parking - 140 Sheffield cycle hoops to London Plan requirements Q20.210
- New 1.8m high weld mesh gate to match adjacent boundary weldmesh fence. Q40.570B
- New 1.8m high timber gate 1566_LD_504 Q40.550A
- Gate - refer to architects details Q25.320A
- Staff covered cycle shelter B91.340A
- Location of attenuation tank. Refer to civil engineers drawings
- Possible location of rainwater harvesting tank by others. Refer to M+E engineers drawings
- Stairs to architects details

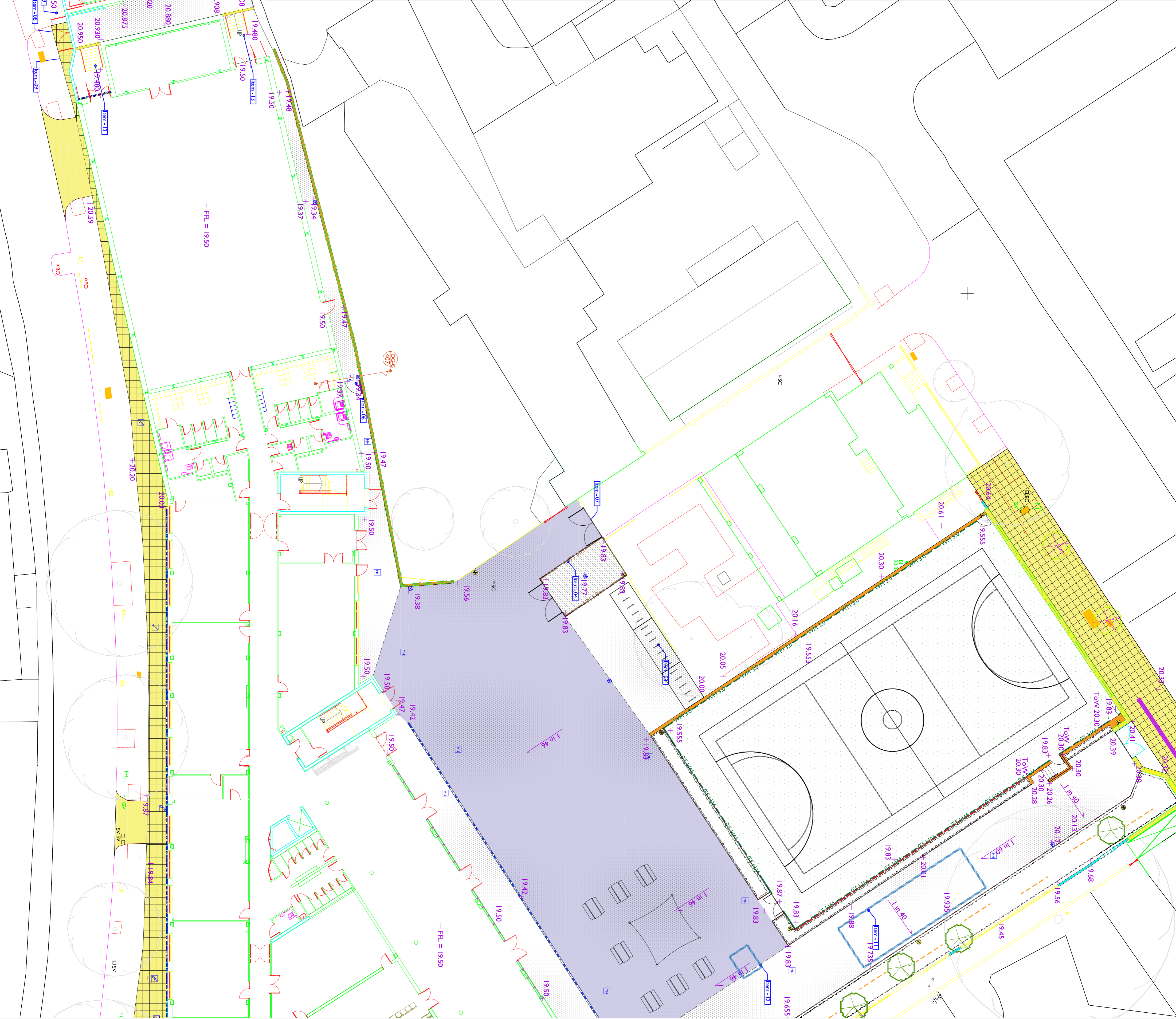
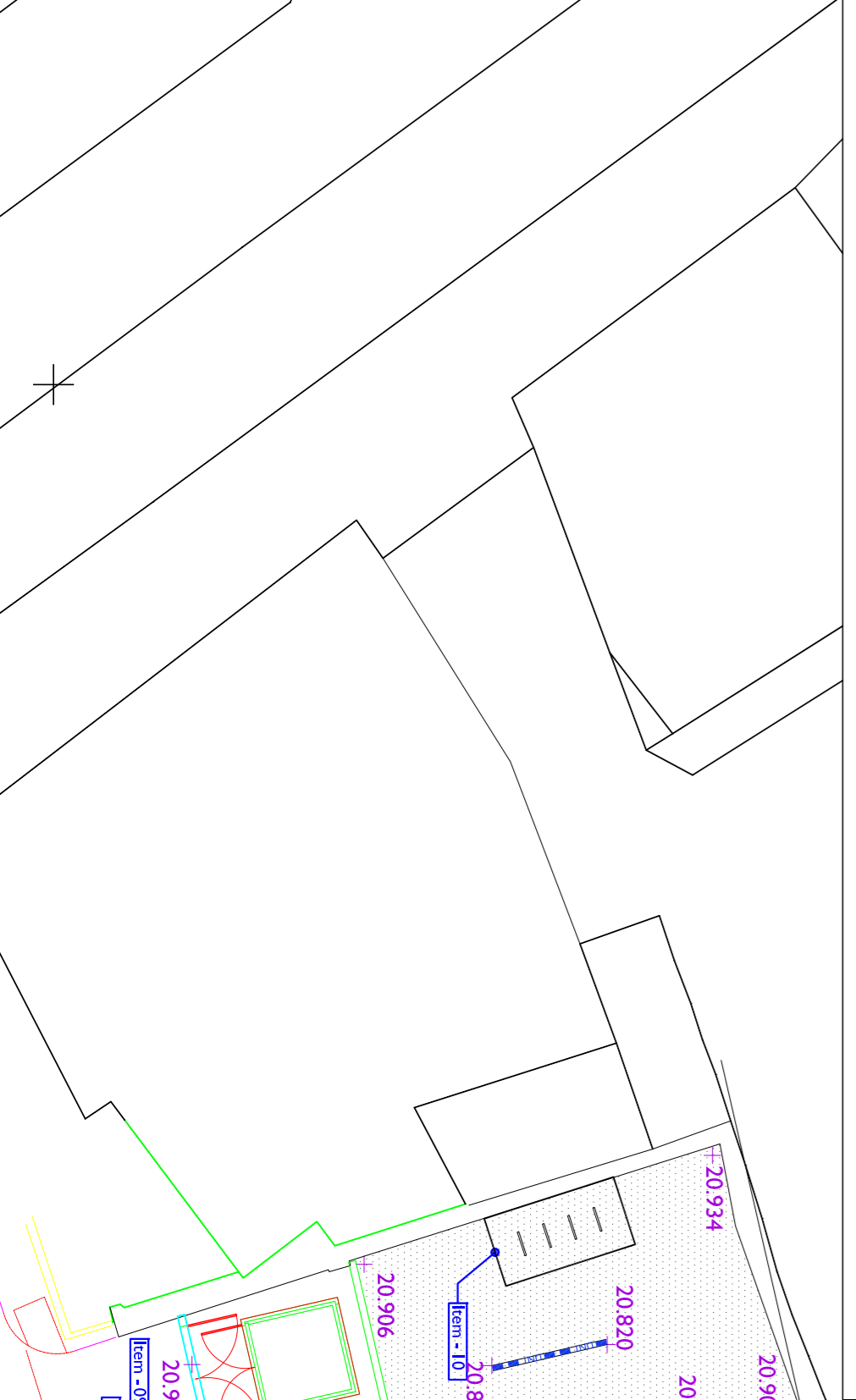

Rev	Date	By	Checked	Revisions
01	03/10/18	JL	MJB	Gate not reduced.
02	03/11/17	JL	MJB	Extent of vehicle mezzanum reduced.
03	15/09/17	JL	MJB	Layout updated. Plantables shown.
04	04/08/17	JL	MJB	Doors amended.
05	31/01/17	JL	MJB	Construction sports pitch amended.
06	14/11/16	JL	MJB	Key amended.
07	14/11/16	JL	MJB	Key amended.

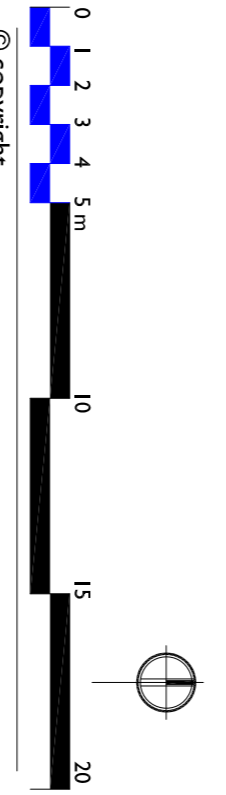

© copyright
wynne-williams associates Ltd
3 The Quadrant, Barnet Park
Finchley Road
London N12 8JG
Tel: 01753 523850
landscapew@wynne-williams.co.uk
www.wynne-williams.co.uk

Client
Kier London

Job Title
Maria Fidelis

Drawing Title
Landscape Layout Plan West

CONSTRUCTION	
Issue	1:200@A1
Date	04.08.16
Date	04.08.16
Drawn	TJ
Checked	AH
Drawing Number	1566_LL_104
Rev	C06