

1 Flat Type B1 Kitchen Plan  
1:20

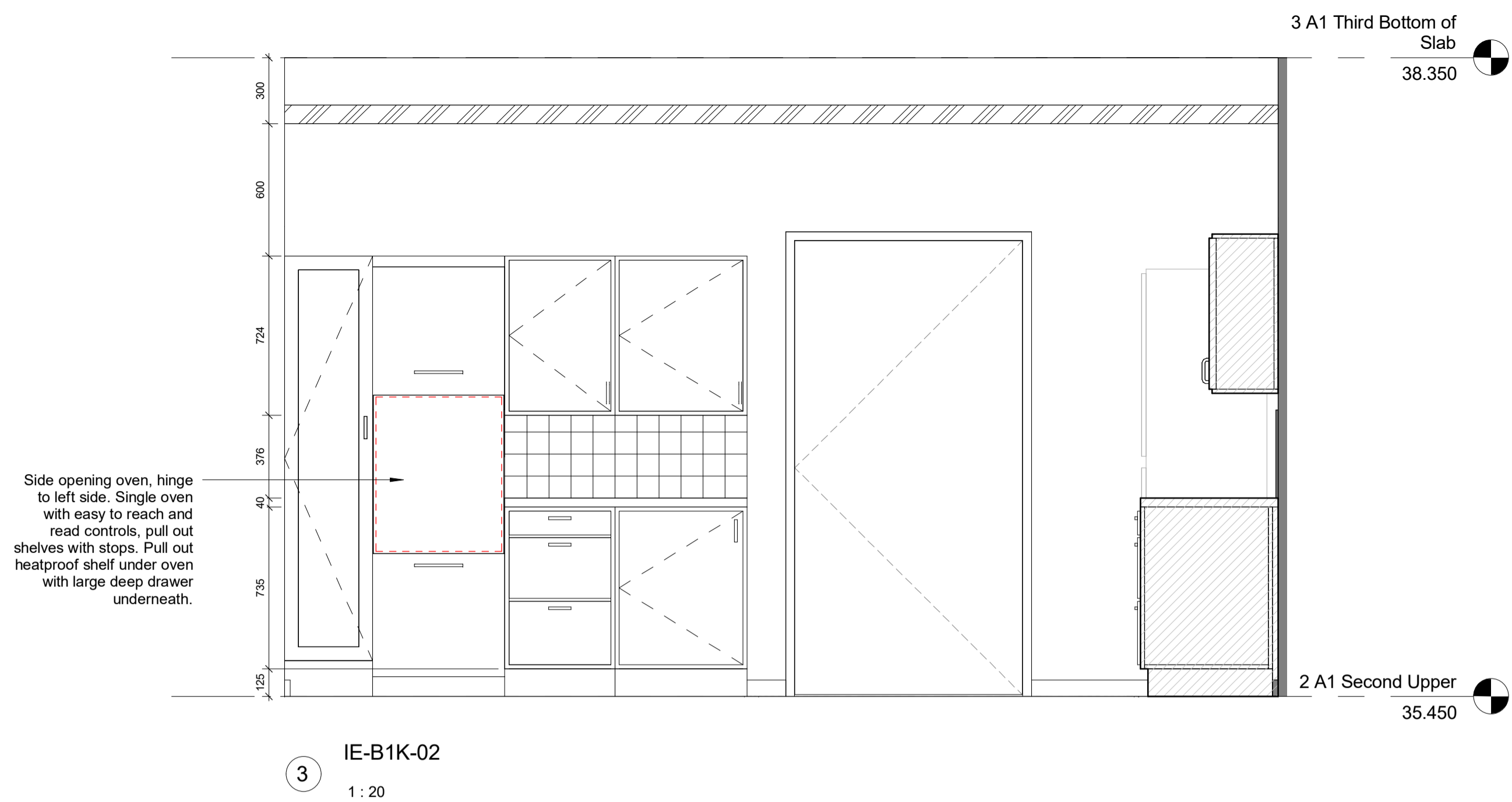

3 IE-B1K-02  
1:20

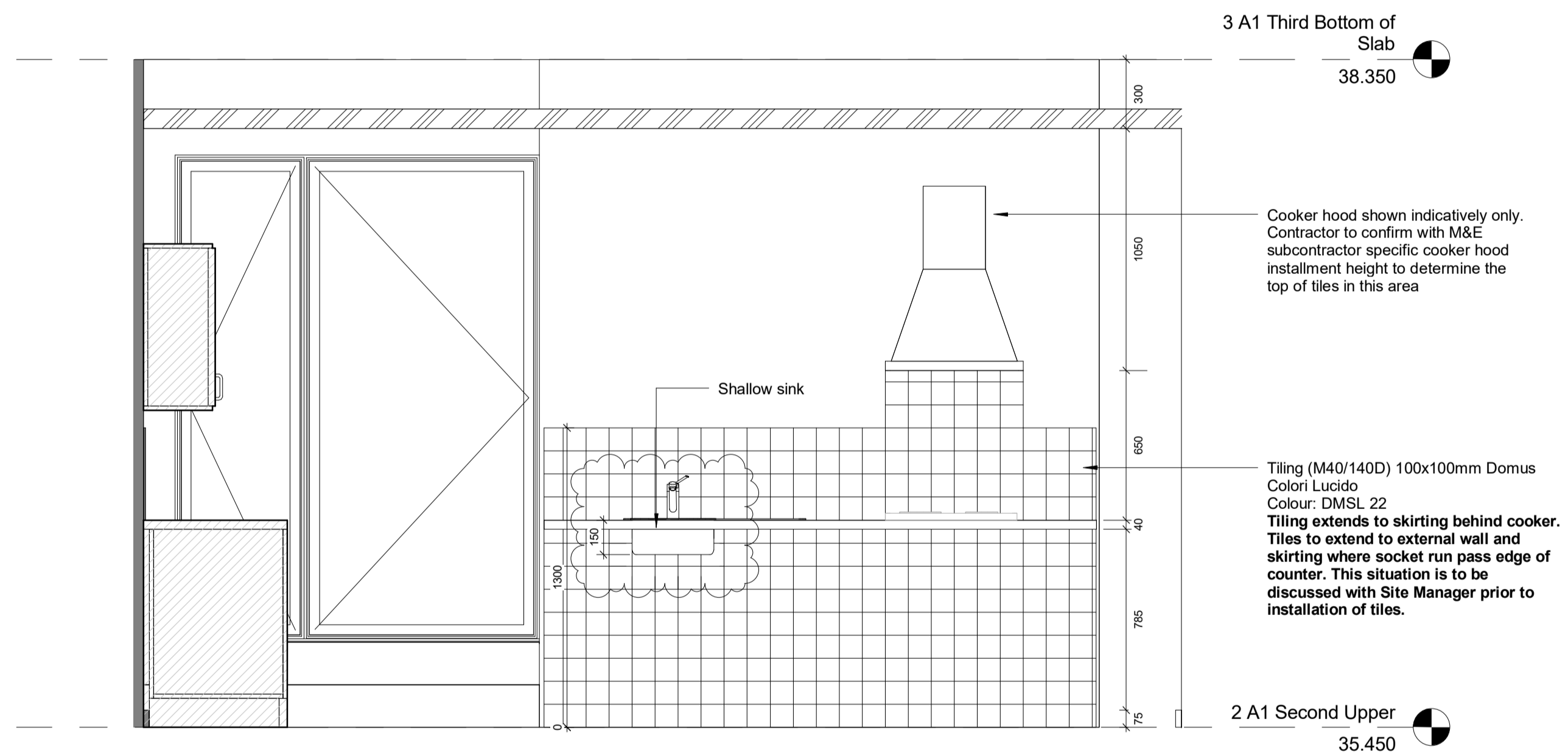

4 IE-B1K-03  
1:20

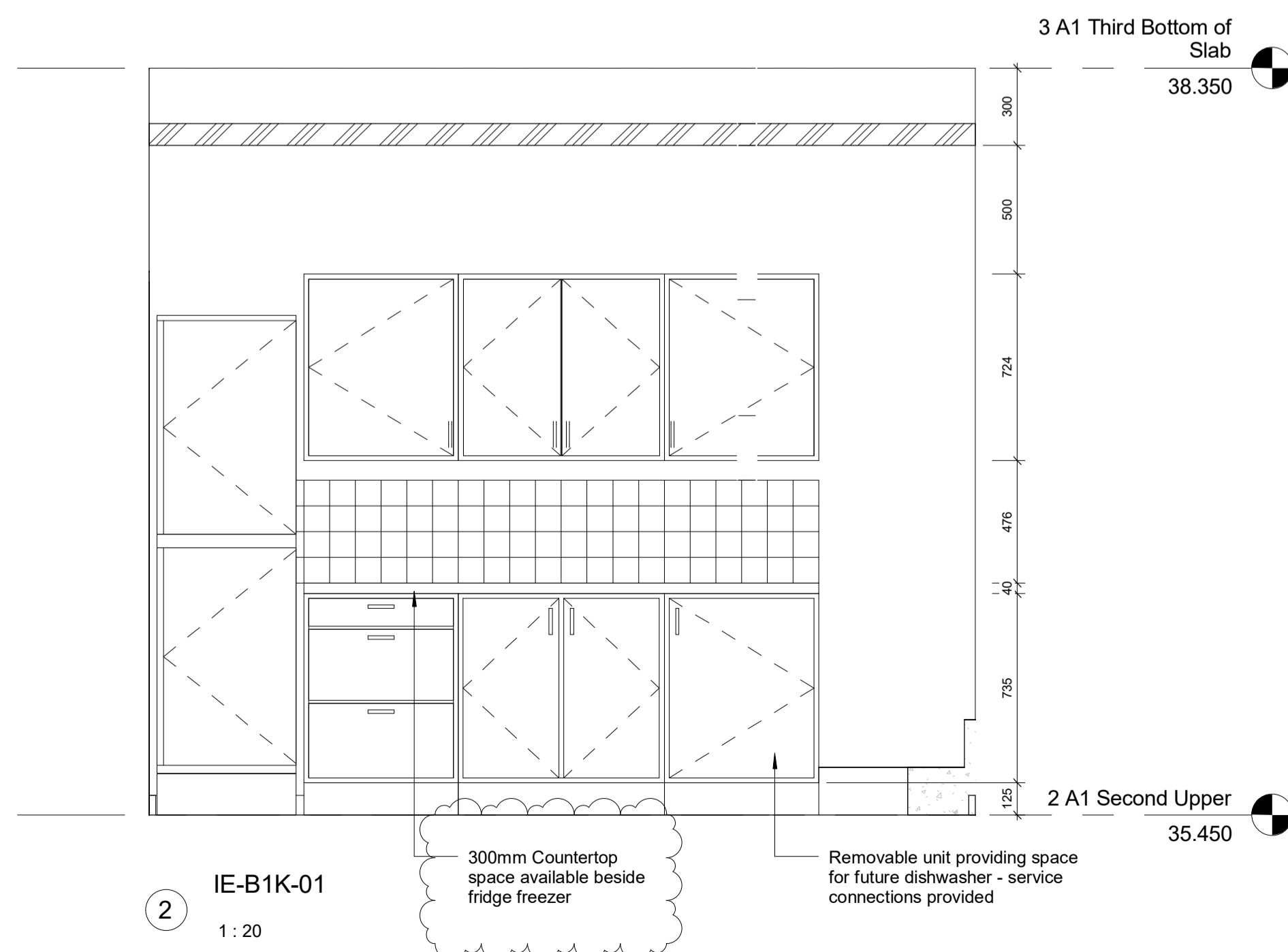

2 IE-B1K-01  
1:20

Casework Schedule IE-B1K				
Description	Mark	Width	Height	Depth
40mm Worktop	IE-B1K-WT01	900.0	625.0	
40mm Worktop	IE-B1K-WT02	900.0	625.0	
40mm Worktop	IE-B1K-WT03	900.0	625.0	
3				
400mm Larder unit	IE-B1K-LA01	400.0	2000.0	600.0
1				
500mm Base unit 3 drawers	IE-B1K-BU04	500.0	860.0	600.0
1				
500mm Wall unit	IE-B1K-WU04	500.0	724.0	300.0
1				
600mm Base unit	IE-B1K-BU03	600.0	860.0	600.0
600mm Base unit	IE-B1K-BU05	600.0	860.0	600.0
2				
600mm Base unit 3 drawers	IE-B1K-BU01	600.0	860.0	600.0
1				
600mm Tall oven unit	IE-B1K-TO01	600.0	2000.0	600.0
1				
600mm Wall unit	IE-B1K-WU01	600.0	724.0	300.0
600mm Wall unit	IE-B1K-WU03	600.0	724.0	300.0
600mm Wall unit	IE-B1K-WU05	600.0	724.0	300.0
3				
800mm Base unit, double doors	IE-B1K-BU02	800.0	860.0	600.0
1				
800mm Wall unit double doors	IE-B1K-WU02	800.0	724.0	300.0
1				
Grand total: 15				

Kitchen Equipment Schedule IE-B1K		
Description	Mark	Comments
Extractor Fan	IE-B1K-EX01	Client supplies
1		
Fridge Freezer	IE-B1K-FF01	Tenant supplies
1		
Electric Hob	IE-B1K-H01	Client supplies
1		
Oven	IE-B1K-OV01	Client supplies
1		
Sink	IE-B1K-SK01	Shallow sink
1		
Grand total: 5		

Note: Refer to Archetype NBS for specification of all Contractor supplied items

Please refer to kitchen subcontractors kitchen drawings for set-out.

NOTE - Kitchen type occurs 2no. times in Block A

**Notes**  
This drawing is © Archetype Ltd.  
Check this drawing is the latest revision.  
Do not scale from this drawing.  
Do not use the information on this drawing without checking all dimensions on site.  
Do not use any areas indicated for either valuation, purchase, sale or any other form of legally binding contract.  
Do not reproduce any part of this drawing without prior written consent.  
Report any discrepancies on this document to Archetype.  
Read this drawing in conjunction with the associated models, specifications and related consultant's documents.  
Equivalent products / materials may be Approved where the Employer's Requirements, Thermal Performance, Airtightness and any other specified performance requirements are met. Subject to Archetype "Acceptance".  
All materials to be certified to comply with BS 14001 or BES6001 or be able to provide a Chain of Custody certificate in order to comply Code for Sustainable Homes. All timber species and sources used in this development are not to be listed on the CITES appendices for endangered or threatened species (appendix I, II or III)

Rev	Date	Description	Drawn	Checked
9	28.02.18	Amendments for planning	CR	AMF
8	31.01.18	LAST ISSUE FOR CONSTRUCTION	IC	RW
7	09.06.17	Update to kitchen drawings to reflect kitchen subcontractor set-out. Tiling layout adapted to suit.	MF	RW
6	06.12.17	Updates in response to Occupational Therapist comments	IC	RW
5	28.07.18	Tiling size and specification updated. Unit schedule updated.	IC	EB
4	08.08.18	Adjustments to tiling as per Hawkins/Dimmer comments	IC	EB
3	18.04.18	Issued for Construction. Kitchen layouts updated following M&E and kitchen supplier coordination.	AP	EB
2	19.10.18	Issued for Building Control	CD	EB
1	02.09.15	Preliminary Issue	IC	CD

LAST ISSUE FOR CONSTRUCTION

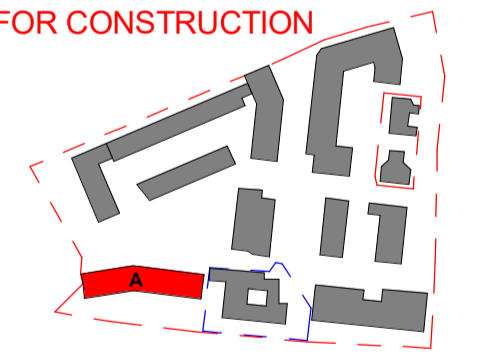

LONDON: 020 7403 2889 WWW.ARCHETYPE.CO.UK HEREFORD: 01981 542 111

Client: Hill Partnership Ltd for Camden Council

Project: Agar Grove Block A

Drawing Title: Flat Type B1 Kitchen

Project Originator Type Role Phase Block Unit Unique ID  
T14011 - ART - DR - A - 1a A 00 - DD-665

Status: Code Suitability Description  
A Issued for Construction

Revision: Code Revision Description  
Z9 Revision description as above

Scale: As indicated @ A1 Date: 02 Sep 15

Drawn by: IC Checked by: CD

Internal Project Ref: 8090 Model Ref: AG-RAC2015-A-A