

FIRST FLOOR PLAN PROPOSED

- LOWER GROUND FLOOR DOORS**
- DF-16 - bathroom (existing) - to be retained 'as existing'
 - DF-17 - bedroom (rear) - to be retained 'as existing'
 - DF-18 - bedroom (front) - to be retained 'as existing'
 - DF-19 - under stair cupboard (rear) - to be retained 'as existing'
 - DF-20 - under stair cupboard (front) - to be retained 'as existing'
 - DF-21 - rear en-suite - to be retained 'as existing'
 - DF-22* - jib door to bathroom - NEW

ALL DOORS AS IDENTIFIED ABOVE AND ON THE ASSOCIATED PLANS ARE TO BE RETAINED AND REDECORATED UNLESS OTHERWISE STATED

(NEW DOORS ARE HIGHLIGHTED WITH ASTERISK* PLEASE REFER TO DRAWING 406/209 to 406/212 FOR: "Plan, elevation and section drawings of all new doors at a scale of 1:10 with typical moulding and architrave details at a scale of 1:1")

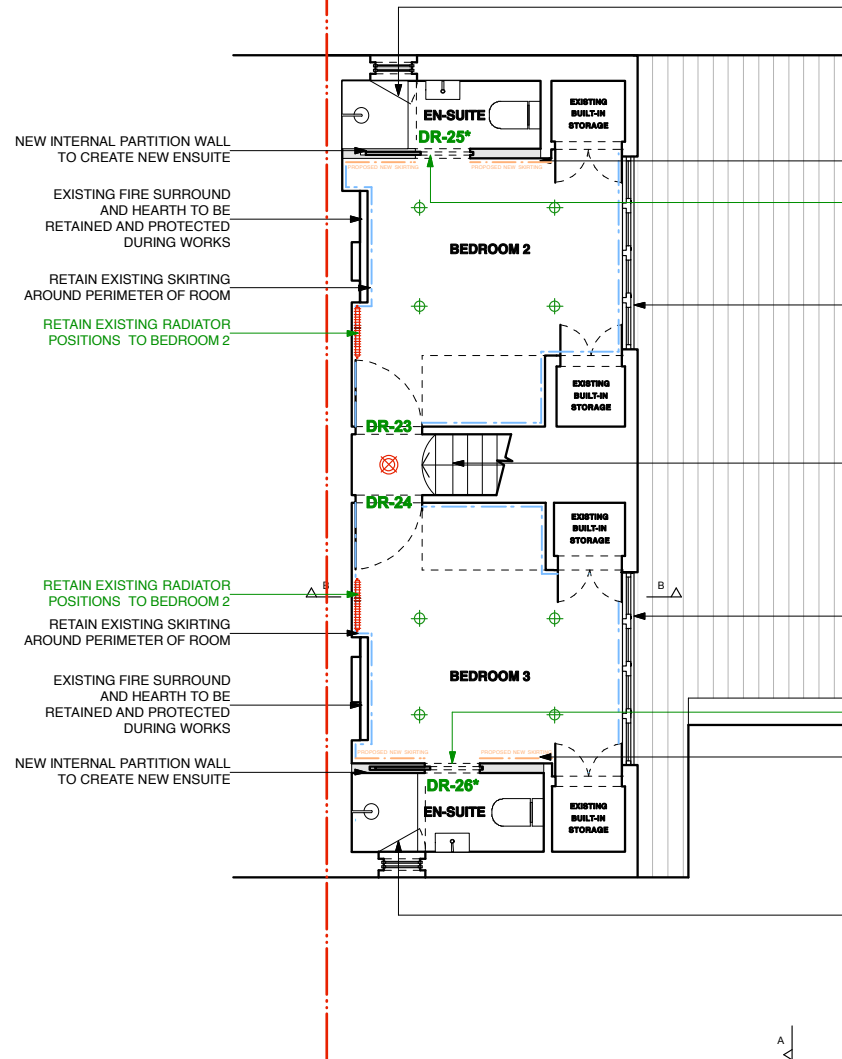

SECOND FLOOR PLAN PROPOSED

- UPPER GROUND FLOOR DOORS**
- DR-23 - loft bedroom (rear) - to be retained 'as existing'
 - DR-24 - loft bedroom (front) - to be retained 'as existing'
 - DR-25* - loft en-suite sliding door (rear) - NEW
 - DR-26* - loft en-suite sliding door (front) - NEW

ALL DOORS AS IDENTIFIED ABOVE AND ON THE ASSOCIATED PLANS ARE TO BE RETAINED AND REDECORATED UNLESS OTHERWISE STATED

(NEW DOORS ARE HIGHLIGHTED WITH ASTERISK* PLEASE REFER TO DRAWING 406/209 to 406/212 FOR: "Plan, elevation and section drawings of all new doors at a scale of 1:10 with typical moulding and architrave details at a scale of 1:1")

NEW INTERNAL FROSTED GLAZED SIDE HUNG WINDOW (OPENING INWARD) TO ALLOW NATURAL VENTILATION OF BATHROOM AND PROTECT EXISTING WINDOW (TO BE RETAINED)

PROPOSED NEW SKIRTING TO MATCH EXISTING

NEW SLIDING POCKET DOOR TO ENSUITE.

PLEASE NOTE EXISTING DORMER WINDOWS TO BE RETAINED AS EXISTING

NEW TRADITIONAL CARPET RUNNER TO STAIRCASE. 100MM OFFSET FROM EDGE OF STEPS

PLEASE NOTE EXISTING DORMER WINDOWS TO BE RETAINED AS EXISTING

NEW SLIDING POCKET DOOR TO ENSUITE.

PROPOSED NEW SKIRTING TO MATCH EXISTING

NEW INTERNAL FROSTED GLAZED SIDE HUNG WINDOW (OPENING INWARD) TO ALLOW NATURAL VENTILATION OF BATHROOM AND PROTECT EXISTING WINDOW (TO BE RETAINED)

- KEY: HEATING & ELECTRICS TO BE REMOVED**
- ⊗ - CEILING MOUNTED PENDANT LIGHT
 - ⊕ - CEILING MOUNTED RECESSED SPOT LIGHT
 - ⊕ - IP CEILING MOUNTED RECESSED SPOT LIGHT
 - ⚡ - RADIATOR

- KEY: PROPOSED NEW HEATING & ELECTRICS**
- ⊗ - NEW CEILING MOUNTED PENDANT LIGHT
 - ⊕ - NEW CEILING MOUNTED RECESSED SPOT LIGHT
 - ⊕ - NEW IP CEILING MOUNTED RECESSED SPOT LIGHT
 - ⚡ - NEW WALL-MOUNTED LIGHT
 - ⚡ - NEW TRADITIONAL STYLE RADIATOR
 - ⚡ - NEW ELECTRIC HEATED TOWEL RAIL

- KEY: EXISTING HEATING AND ELECTRICS TO BE RETAINED**
- ⊗ - CEILING MOUNTED PENDANT LIGHT
 - ⊕ - CEILING MOUNTED RECESSED SPOT LIGHT
 - ⊕ - IP CEILING MOUNTED RECESSED SPOT LIGHT
 - ⚡ - WALL MOUNTED BULKHEAD LIGHT
 - ⚡ - CEILING MOUNTED BULKHEAD LIGHT
 - ⊗ - EXTERNAL CEILING MOUNTED PORCH PENDANT LIGHT
 - ⚡ - RADIATOR

- INTERIOR DETAILS & FINISHES KEY**
- — — ORIGINAL CORNICE
 - — — RETAIN ORIGINAL SKIRTING
 - — — NEW SKIRTING TO MATCH ORIGINAL



INTERNAL ALTERATIONS - LISTED BUILDING CONSENT



Rev. Comments Date

Project **NO. 3 ETON VILLAS • LONDON • NW3 4SX**

Drawing Title **PROPOSED FIRST & SECOND FLOOR PLANS**

Dwg No. **406/105** Revision **C**

Scale **1:100 @ A3** Date **FEB 2018** Drawn by **TW**

ATELIERwest

ARCHITECTURE / DESIGN / PROJECT MANAGEMENT

SUITE 5 / 26 CADOGAN SQUARE / LONDON / SW1X 0JP
INFO@ATELIERWEST.CO.UK / WWW.ATELIERWEST.CO.UK

0203 587 7227
07801 650 531