

DETAIL 1:1
Existing / Proposed skirting detail in FIRST FLOOR bedrooms
(all other mouldings, architraves and cornices to remain unaltered by proposed works)
All existing skirting to be retained and reused as required, new skirting to match existing skirting on a like-for-like basis

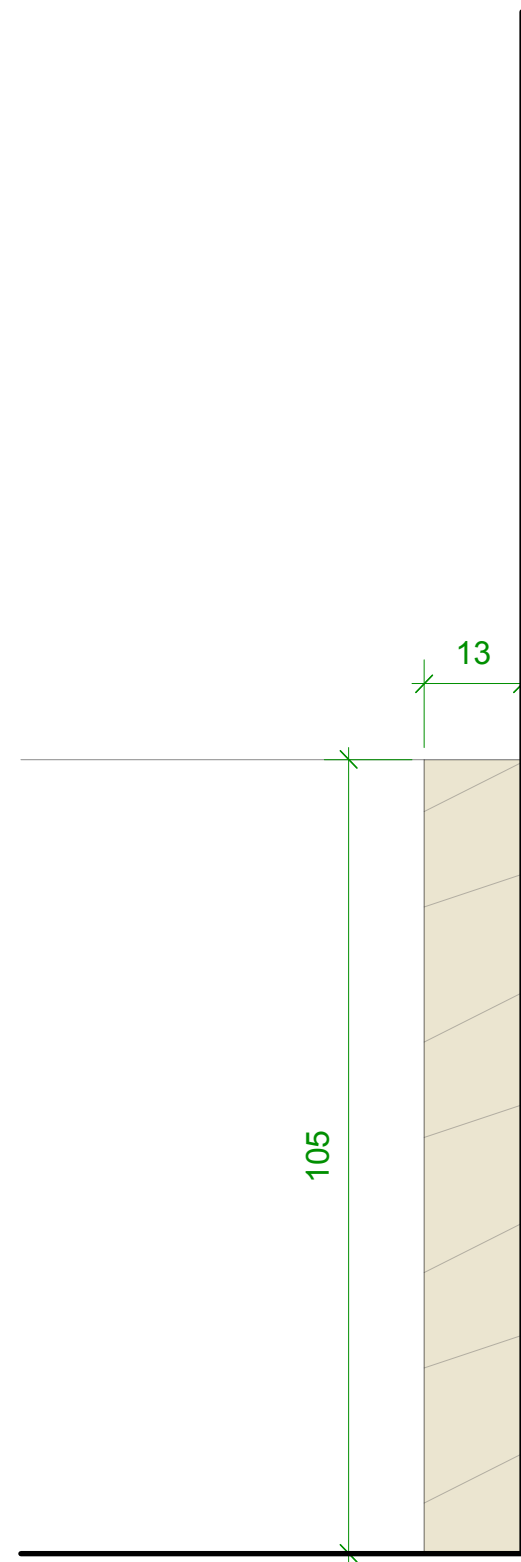

DETAIL 1:1
Existing / Proposed skirting detail in SECOND FLOOR bedrooms
(all other mouldings, architraves and cornices to remain unaltered by proposed works)
All existing skirting to be retained and reused as required, new skirting to match existing skirting on a like-for-like basis

	Rev.	Comments	Date	Project	NO. 3 ETON VILLAS • LONDON • NW3 4SX			<div>ATELIERwest</div> <div>ARCHITECTURE / DESIGN / PROJECT MANAGEMENT</div> <div>SUITE 5 / 26 CADOGAN SQUARE / LONDON / SW1X 0JP INFO@ATELIERWEST.CO.UK / WWW.ATELIERWEST.CO.UK</div> <div>0203 587 7227 07801 650 531</div>		
				Drawing Title	EXISTING / PROPOSED SKIRTING					
				Dwg No.	406/212					
					Revision					
				Scale	1:1 @ A3	Date	FEB 2018	Drawn by	TW	

DO NOT SCALE FROM THIS DRAWING. USE FIGURED DIMENSIONS ONLY. ANY DISCREPANCIES ARE TO BE REPORTED TO AW IMMEDIATELY. PRIOR TO THE EXECUTION OF THE WORKS ON SITE ALL DIMENSIONS TO BE VERIFIED ON SITE BEFORE ANY WORK IS PUT IN HAND