

### Survey Control Details.

Stn	Eastings	Northings	Level
S1	527712.917	187465.387	112.508
S2	527694.885	187449.796	112.504
S3	527759.941	187497.520	113.061
S4	527736.770	187504.657	113.606
S5	527700.025	187425.801	111.873
S6	527660.027	187438.631	112.438
S7	527671.179	187485.034	112.909

Note:  
Some services may have been omitted due to parked vehicles.  
The Ordnance Survey site is to be used as a guide only.

OS Buildings Surveyed Buildings

This survey has been oriented to the Ordnance Survey (OS) National Grid (OSNG) via Global Navigation Satellite Systems (GNSS) and the O.S. Active Network (OS Net).  
A true OSGB36 coordinate has been established near to the site centre via a transformation using the OSTN02 & OSGM02 transformation modes.  
The survey has been correlated to this point and a further one or more OSGB36 points established to create a true O.S. bearing for angle orientation.  
No scale factor has been applied to the survey therefore the coordinates shown are arbitrary & not true O.S. coordinates which have a scale factor applied.  
Please refer to Survey Station Table to enable identification of the on-site grid.

### Topographical Legend:

	Contour Lines		Buildings
	Fences		Walls
	Roads		Paths
	Trees		Grass
	Water		Paved Areas
	Steps		Drains
	Manholes		Light Poles
	Boundary Lines		Utility Lines
	Survey Points		Other Features

J 11.01.18	Plan Amendments	TC GH1999
H 11.01.15	Tree Survey/Update	GH1996
G 26.11.17	Tree Survey/Update	TC/GB GH1999
A 19.09.2018	Tree Survey/Update	TC/GB GH1999
	Tree Survey/Update	GP GH1555

**greenhatch group**

Topographical surveys  
Site Engineering  
Utility / CCTV Surveys  
Measured Building Surveys  
3D Laser Scanning  
Revit & BIM Models

**Rowan House**  
Duffield Road  
Little Eaton  
Derby  
DE21 5DR

Tel (01332) 830044 Fax (01332) 830055  
admin@greenhatch-group.co.uk  
www.greenhatch-group.co.uk

St Albans	Newcastle	Poland
Unit 6, The Courtyard, St Albans Herts SG8 5DZ t. (01727) 854481	24 Riverside Studios Riverside Road Newcastle-U-Tyne NE4 6LJ t. (0191) 2763991	ul. Papiernicza 91 40-153 Babolnice Poland t. 0048 32 202 2292 www.greenhatch.pl

CLIENT  
**SHH Architects**

PROJECT  
**Athlone House**  
Hamstead lane  
N6 4SA

North boundary wall  
Tree locations where works required (highlighted numbers, or offsite in red text)

DRAWN <b>GP</b>	QUALITY REF <b>F1573</b>
Level datum OS GPS	Grid orientation OS GPS
Job number 22929	Rev. <b>I</b>
Drawing No. <b>22929c_01_P</b>	
Comments This plan should only be used for its original purpose. Greenhatch Group accepts no responsibility for this plan if supplied to any party other than the original client. All dimensions should be checked on site prior to design and construction. Drainage information (where applicable) has been visually inspected from the surface and therefore should be treated as approximate only. Notes:	



**OS Note:**  
Some services may have been omitted due to parked vehicles. The Ordnance Survey file is to be used as a guide only.

**OS Buildings** Surveyed Buildings

This survey has been orientated to the Ordnance Survey (O.S.) National Grid OSGB36(15) via Global Navigational Satellite Systems (GNSS) and the O.S. Active Network (OS Net).  
A true OSGB36 coordinate has been established near to the site centre via a transformation using the OSTN15GB & OSGM15GB transformation models.  
The survey has been correlated to this point and a further one or more OSGB36 (15) points established to create a true O.S. bearing for angle orientation.  
No scale factor has been applied to the survey therefore the coordinates shown are arbitrary & not true O.S. Coordinates which have a scale factor applied.  
Please refer to Survey Station Table to enable establishment of the on-site grid and datum.

**Legend:**

	Overhead Cable		IC Inspection chamber		Bs Borehole
	PInv Pipe invert		IB Illuminated bollard		Rb Rubbish bin
	Gy Gully		Vp Vent pipe		GL Ground light
	BG Back gully		Lb Letter box		TS Tree stump
	Dp Down pipe		WL Water level		FL Floor level
	DP Down pipe		IFL Internal floor level		TL Threshold level
	CL Cable line		Sp Sign post		TD Tree diameter
	MH Manhole		TCL Tree canopy level		TD Tree diameter
	SN Station and Name		TD Tree diameter		TD Tree diameter
	SL Station Level		TD Tree diameter		TD Tree diameter
	TBS Tree / Bush / Sapling		TD Tree diameter		TD Tree diameter
	AU Area of Undergrowth		TD Tree diameter		TD Tree diameter
	Wd Woodland		TD Tree diameter		TD Tree diameter
	RL Ridge Level		TD Tree diameter		TD Tree diameter
	EL Eaves Level		TD Tree diameter		TD Tree diameter
	FR Flat Roof Level		TD Tree diameter		TD Tree diameter
	Gas Gas		TD Tree diameter		TD Tree diameter
	GV Gas valve		TD Tree diameter		TD Tree diameter
	GV Gas valve		TD Tree diameter		TD Tree diameter
	GV Gas valve		TD Tree diameter		TD Tree diameter

Rev	Date	Description	Drawn	Q. Ref.

**greenhatch group**

- Topographical Surveys
- Site Engineering
- Utility / CCTV Surveys
- Measured Building Surveys
- 3D Laser Scanning
- Revit & BIM Models

**Rowan House**  
Duffield Road  
Little Eaton  
Derby  
DE21 5DR

Tel (01332) 830044 Fax (01332) 830055  
admin@greenhatch-group.co.uk  
www.greenhatch-group.co.uk

St Albans Unit B, The Courtyard Alban Park St Albans Hertfordshire AL4 0LA t. (01727) 854481	Newcastle 24 Riverside Studios Amethyst Road Newcastle Bus, Park Newcastle-U-Tyne NE4 7YL t. (01912) 736391	London 27, Cornwall Terrace Mews Regents Park London NW1 5LL t. (02072) 241806
--	---	---

**CLIENT**  
**SHH Architects**

**PROJECT**  
**Athlone House**  
Hampstead Lane  
N6 4SA

**Wood west**  
Tree locations where works required (highlighted numbers, or offsite in red text) &/or roots affected (blue clouded)

Drawing No. **22929\_01-16\_PES** Rev. **1**

**Comments**  
This plan should only be used for its original purpose. Greenhatch Group accepts no responsibility for this plan if supplied to any party other than the original client.  
All dimensions should be checked on site prior to design and construction.  
Drainage information (where applicable) has been visually inspected from the surface and therefore should be treated as approximate only.  
Notes:

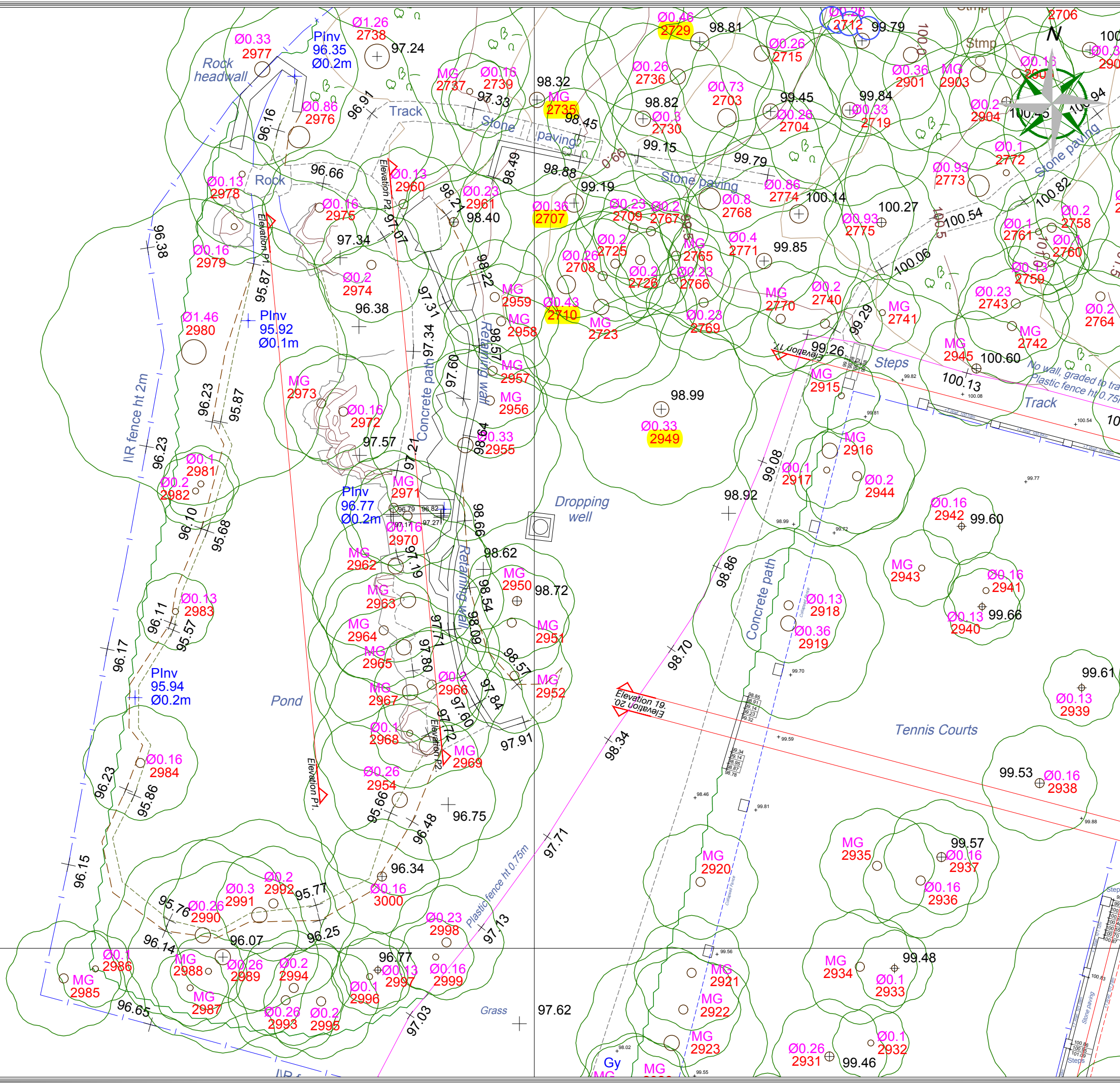



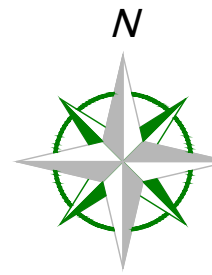

OS Note:  
Some services may have been omitted due to parked vehicles.  
The Ordnance Survey file is to be used as a guide only.

OS Buildings Surveyed Buildings

This survey has been orientated to the Ordnance Survey (O.S.) National Grid OSGB36(15) via Global Navigational Satellite Systems (GNSS) and the O.S. Active Network (OS Net).  
A true OSGB36 coordinate has been established near to the site centre via a transformation using the OSTN15GB & OSGM15GB transformation models.  
The survey has been correlated to this point and a further one or more OSGB36 (15) points established to create a true O.S. bearing for angle orientation.  
No scale factor has been applied to the survey therefore the coordinates shown are arbitrary & not true O.S. Coordinates which have a scale factor applied.  
Please refer to Survey Station Table to enable establishment of the on-site grid and datum.

### Legend:

	Overhead Cable		Inspection chamber		Bifold
	Wall		Pipe invert		Illuminated bollard
	Kerb line		Gully		Rubbish bin
	Line marking		Back gully		Vent pipe
	Drop kerb		Down pipe		Ground light
	Control line		Pipe above ground		Letter box
	Station and Name		Manhole		Tree stump
	Station Level		Flood light		Sky
	Tree / Bush / Sapling		Lamp post		Internal floor level
	Area of Undergrowth		Telegraph post		Sign post
	Woodland		Electricity pylon		Threshold level
	Ridge Level		Traffic light		Trunk hole
	Eaves Level		Bus stop		Electric
	Flat Roof Level		Stop valve		British Telecom
	Gate		Stop top		Control box
	Gas valve		Earth rod		Tactile
	Intervenor		Water meter		Block paving
	Iron Railings		Gas cover		Concrete paving slab
	Wire Mesh		Air vent		CSR Cover
	Road & Rail		Unearthed inspection		Roofing panel
	Chain Link		Wash out		Wash out
	Close Boarded		Roading eye		Tree canopy level
	Wood Paving		Tree Diameter		Tree Diameter
			Cable to MG		Multi grids
			Marker post		Inspection chamber
			Gas marker post		Cover level
			Soil		Invert level
			Tree location		Gravel to fill

Rev	Date	Description	Drawn	Q	Ref

**greenhatch group**

- Topographical Surveys
- Site Engineering
- Utility / CCTV Surveys
- Measured Building Surveys
- 3D Laser Scanning
- Revit & BIM Models

**Rowan House**  
Duffield Road  
Little Eaton  
Derby  
DE21 5DR

Tel (01332) 830044 Fax (01332) 830055  
admin@greenhatch-group.co.uk  
www.greenhatch-group.co.uk

St Albans Unit B, The Courtyard Alban Park St Albans Hertfordshire AL4 0LA t. (01727) 854481	Newcastle 24 Riverside Studios Amethyst Road Newcastle Bus Park Newcastle-U-Tyne NE4 7YL t. (01912) 736391	London 27, Cornwall Terrace Mews Regents Park London NW1 5LL t. (02072) 241806
--	--	---

CLIENT  
**SHH Architects**

PROJECT  
**Athlone House  
Hampstead Lane  
N6 4SA**

Wood central  
Tree locations where  
works required  
(highlighted numbers, or  
offsite in red text ) &/or  
roots affected (blue  
clouded) roots

Drawing No.	Rev.
22929_01-16_PES	I

Comments  
This plan should only be used for its original purpose. Greenhatch Group accepts no responsibility for this plan if supplied to any party other than the original client.  
All dimensions should be checked on site prior to design and construction.  
Drainage information (where applicable) has been visually inspected from the surface and therefore should be treated as approximate only.

Notes:

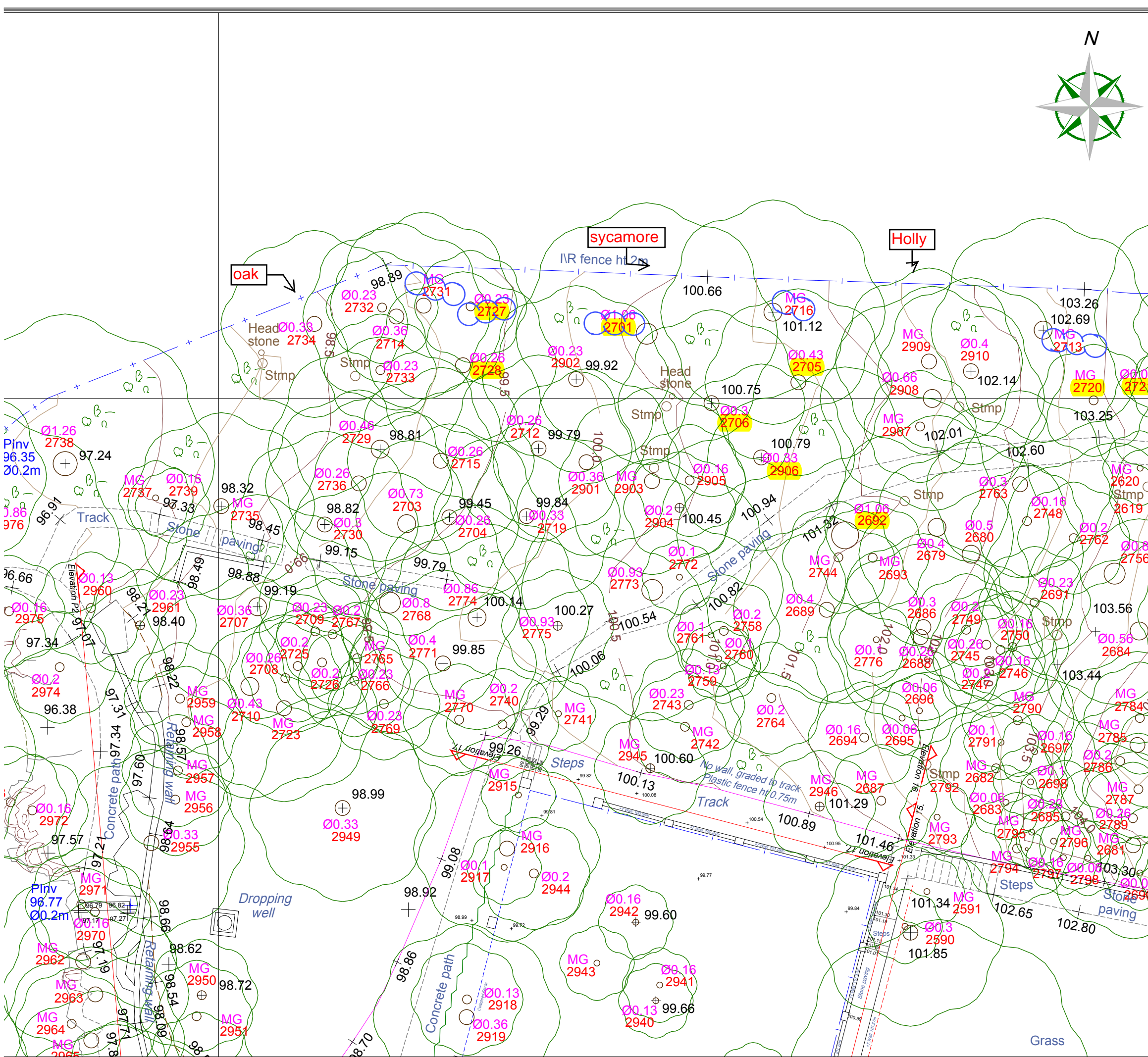



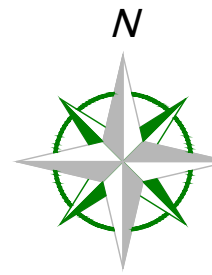

**OS Note:**  
Some services may have been omitted due to parked vehicles.  
The Ordnance Survey file is to be used as a guide only.

**OS Buildings** **Surveyed Buildings**

This survey has been orientated to the Ordnance Survey (O.S.) National Grid OSGB36(15) via Global Navigational Satellite Systems (GNSS) and the O.S. Active Network (OS Net).  
A true OSGB36 coordinate has been established near to the site centre via a transformation using the OSTN15GB & OSGM15GB transformation models.  
The survey has been correlated to this point and a further one or more OSGB36 (15) points established to create a true O.S. bearing for angle orientation.  
No scale factor has been applied to the survey therefore the coordinates shown are arbitrary & not true O.S. Coordinates which have a scale factor applied.  
Please refer to Survey Station Table to enable establishment of the on-site grid and datum.

**Legend:**

	Overhead Cable		Inspection chamber		Borehole
	Wall		Pipe invert		Illuminated bollard
	Kerb line		Gully		Rubbish bin
	Line marking		Back gully		Vent pipe
	Drop kerb		Down pipe		Ground light
	Centre line		Pipe above ground		Letter box
	Station and Name		Manhole		Tree Stump
	Station Level		Flood light		Floor level
	Tree / Bush / Sapling		Lamp post		Threshold level
	Area of Undergrowth		Telegraph post		Sign post
	Woodland		Electricity post		Traffic light
	Ridge Level		Traffic light		Borehole
	Eaves Level		Bus stop		Electric
	Flat Roof Level		Step valve		British Telecom
	Gas		Stop sign		Control box
	Gas valve		Earth rod		Tactile
	Air valve		Water meter		Block paved
	Air cover		Gas cover		Concrete paving slab
	Unidentified inspection point		Gas cover		Curb
	Wash out		Roofing panel		Hoarding post
	Roofing eye		Cable to MG		Tree Tag
	Chain Link		Marker post		Tree Diameter
	Wooden Planks		Gas marker post		Multi grids
	Close Boarded		Soil		Inspection chamber
	Wood Paving		Tree Tag		Cover level
			Tree Tag		Invert level
			Tree Tag		Grade to RL

Rev	Date	Description	Drawn	D. Ref.
-----	------	-------------	-------	---------

**greenhatch group**

- Topographical Surveys
- Site Engineering
- Utility / CCTV Surveys
- Measured Building Surveys
- 3D Laser Scanning
- Revit & BIM Models

**Rowan House**  
Duffield Road  
Little Eaton  
Derby  
DE21 5DR

Tel (01332) 830044 Fax (01332) 830055  
admin@greenhatch-group.co.uk  
www.greenhatch-group.co.uk

**CLIENT**

**SHH Architects**

**PROJECT**

**Athlone House**  
Hampstead Lane  
N6 4SA

**TITLE**

**Wood east**  
Trees where works required (highlighted numbers, or offsite in red text) or tree roots affected (clouded blue)

Drawing No. **725.12**

**Comments**  
This plan should only be used for its original purpose. Greenhatch Group accepts no responsibility for this plan if supplied to any party other than the original client.  
All dimensions should be checked on site prior to design and construction.  
Drainage information (where applicable) has been visually inspected from the surface and therefore should be treated as approximate only.

**Notes:**

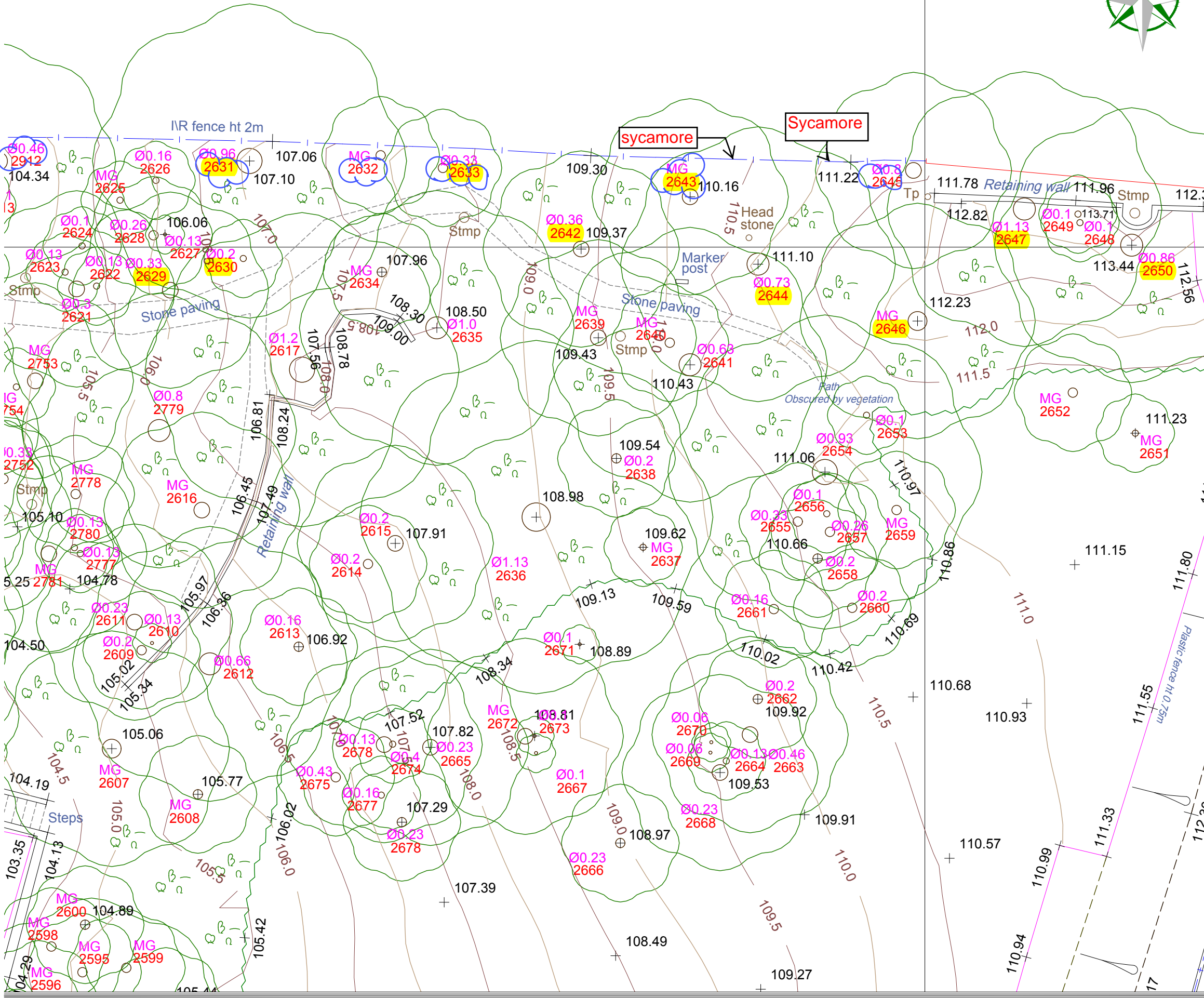



**OS Note:**  
Some services may have been omitted due to parked vehicles. The Ordnance Survey file is to be used as a guide only.

**OS Buildings**

This survey has been orientated to the Ordnance Survey (O.S.) National Grid OSGB36(15) via Global Navigational Satellite Systems (GNSS) and the O.S. Active Network (OS Net).  
A true OSGB36 coordinate has been established near to the site centre via a transformation using the OSTN15GB & OSGM15GB transformation models.  
The survey has been correlated to this point and a further one or more OSGB36 (15) points established to create a true O.S. bearing for angle orientation.  
No scale factor has been applied to the survey therefore the coordinates shown are arbitrary & not true O.S. Coordinates which have a scale factor applied.  
Please refer to Survey Station Table to enable establishment of the on-site grid and datum.

**Legend:**

	Overhead Cable		IC Inspection chamber		Bo Boilermaker
	Manhole		PIV Pipe invert		IB Illuminated bollard
	Tarmac edge		Gy Grully		RB Rubbish bin
	Line marking		BG Back gully		VP Vent pipe
	Grass		DP Down pipe		GL Ground light
	Drop kerb		PAG Pipe above ground		LB Letter box
	Concrete line		MH Manhole		TS Tree stump
	Station and Name		WL Water level		SI Site
	100,000		FL Flood light		IFL Internal floor level
	Tree / Bush / Sapling		LP Lamp post		TLH Threshold level
	Area of Undergrowth		TP Telegraph post		SP Sign post
	Ridge Level		EP Electricity post		TL Traffic light
	Eaves Level		TL Traffic light		ELC Electric
	Flat Roof Level		BS Bus stop		BT British Telecom
	Fence types:		SV Step valve		ST Step
	RW Interwoven		SO Step out		ER Earth rod
	RR Iron Railings		WM Water meter		BP Block paving
	WM Wire Mesh		GV Gas valve		CPS Concrete paving slab
	PW Post & Rail		AV Air valve		CVR Cover
	PWS Post & Wire		UI Unearthed inspection		RP Roofing panel
	CL Chain Link		WO Wash out		TT Tree Tag
	WPF Wooden Panels		RE Riding eye		TCL Tree canopy level
	CB Close Boarded		BB Barkhite beam		TD Tree Diameter
	SP Steel Pickets		CTV Cable to		MG Multi grids
			MR Marker post		IC Inspection chamber
			GMP Gas marker post		CL Cover level
			Ss Soils		IL Invert level
			Fl Fire hydrant		GRL Ground to RL

Rev	Date	Description	Drawn	Q. Ref.

**greenhatch group**

- Topographical Surveys
- Site Engineering
- Utility / CCTV Surveys
- Measured Building Surveys
- 3D Laser Scanning
- Revit & BIM Models

**Rowan House**  
Duffield Road  
Little Eaton  
Derby  
DE21 5DR

Tel (01332) 830044 Fax (01332) 830055  
admin@greenhatch-group.co.uk  
www.greenhatch-group.co.uk

St Albans	Newcastle	London
Unit B, The Courtyard Alban Park St Albans Hertfordshire AL4 0LA t. (01727) 854481	24 Riverside Studios Amethyst Road Newcastle Bus, Park Newcastle-U-Tyne NE4 7YL t. (01912) 736391	27, Cornwall Terrace Mews Regents Park London NW1 5LL t. (02072) 241806

**CLIENT**  
**SHH Architects**

**PROJECT**  
**Athlone House  
Hampstead Lane  
N6 4SA**

**Western boundary  
Tree locations where  
works required  
(highlighted numbers, &/  
or off site in red text)**

Job number: 22929

Drawing No. **725.12**

**Comments**  
This plan should only be used for its original purpose. Greenhatch Group accepts no responsibility for this plan if supplied to any party other than the original client.  
All dimensions should be checked on site prior to design and construction.  
Drainage information (where applicable) has been visually inspected from the surface and therefore should be treated as approximate only.

Notes:  
Copyright Greenhatch Group. 09/2013

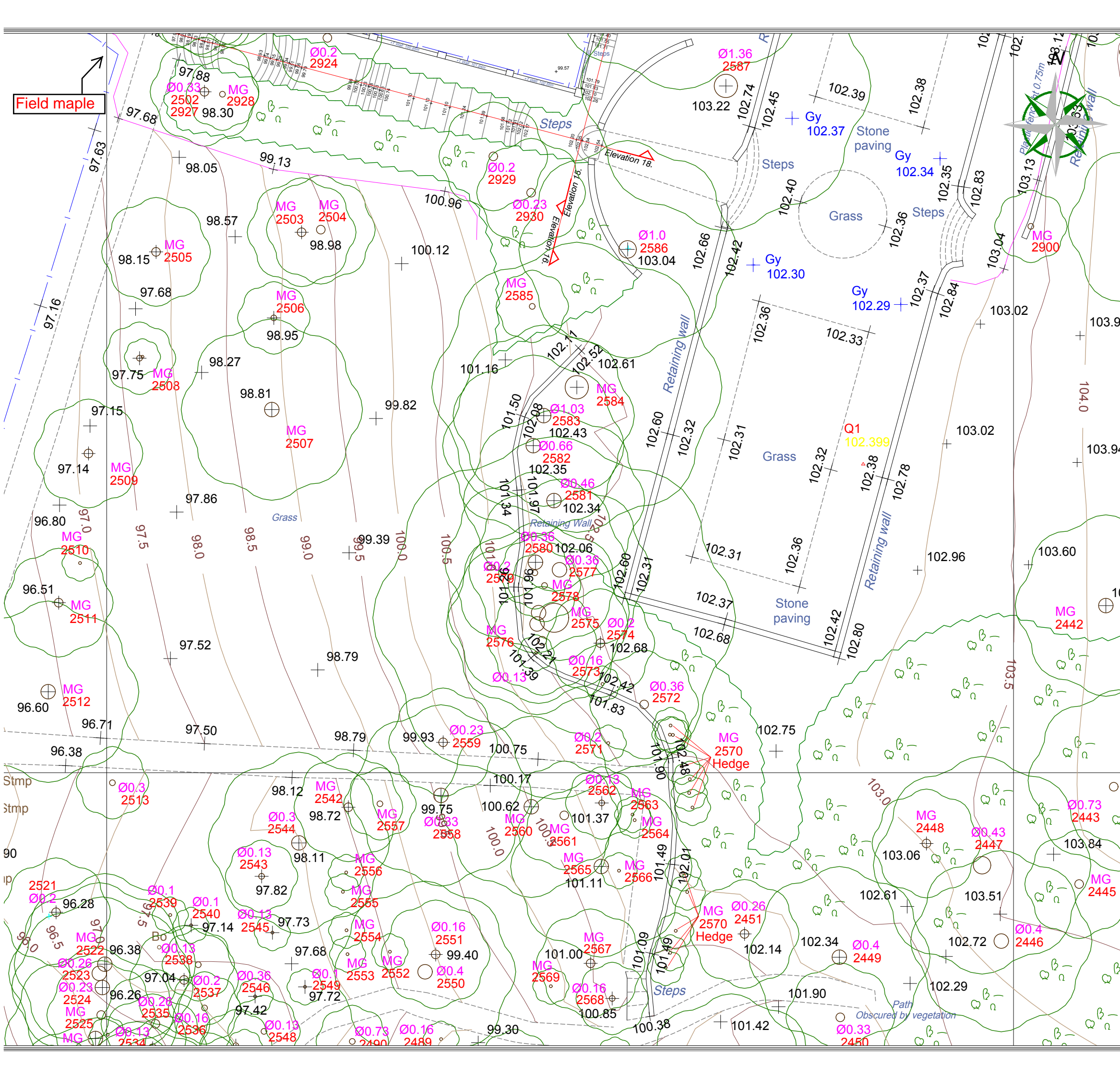



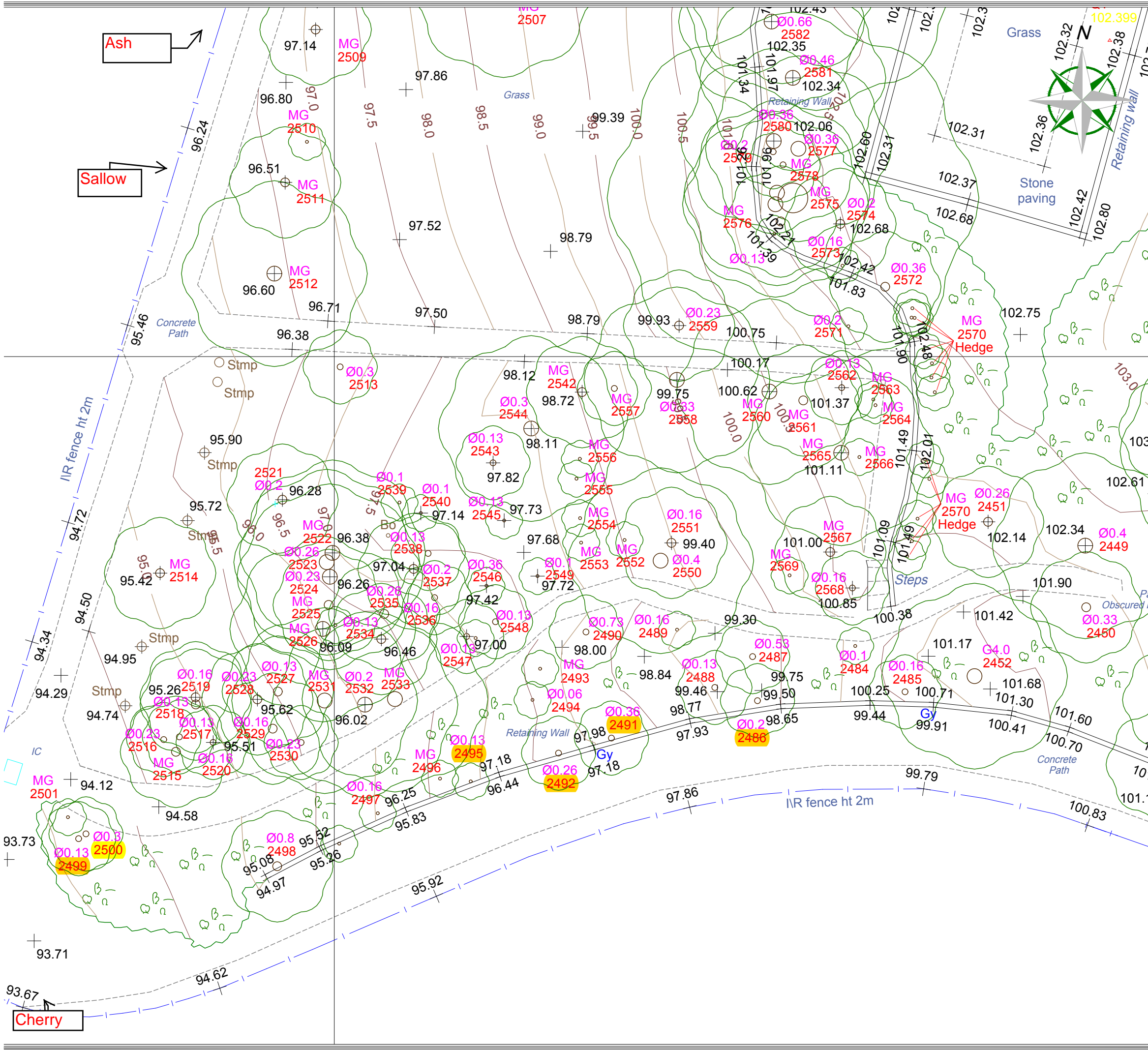

**OS Note:**  
Some services may have been omitted due to parked vehicles. The Ordnance Survey file is to be used as a guide only.

**OS Buildings**  Surveyed Buildings

This survey has been orientated to the Ordnance Survey (O.S.) National Grid OSGB36(15) via Global Navigational Satellite Systems (GNSS) and the O.S. Active Network (OS Net).  
A true OSGB36 coordinate has been established near to the site centre via a transformation using the OSTN15GB & OSGM15GB transformation models.  
The survey has been correlated to this point and a further one or more OSGB36 (15) points established to create a true O.S. bearing for angle orientation.  
No scale factor has been applied to the survey therefore the coordinates shown are arbitrary & not true O.S. Coordinates which have a scale factor applied.  
Please refer to Survey Station Table to enable establishment of the on-site grid and datum.

**Legend:**

Overhead Cable	IC	Inspection chamber	Bo	Boiler
Manhole	PI	Pipe invert	BS	Illuminated bollard
Wall	GL	Gully	BM	Rubbish bin
Asphalt	BP	Back gully	VP	Vent pipe
Gravel	DP	Down pipe	GL	Ground light
Grass	PG	Pipe above ground	LB	Letter box
Concrete	MP	Manhole	ST	Tree stump
Concrete Path	WL	Water level	SK	Skylight
Concrete Wall	FL	Flood light	RL	Internal floor level
Concrete Wall	LP	Lamp post	THL	Threshold level
Concrete Wall	TP	Telegraph post	SP	Sign post
Concrete Wall	EP	Electric post	TH	Trunk hole
Concrete Wall	TI	Traffic light	BH	Bonhole
Concrete Wall	BS	Bus stop	ELC	Electric
Concrete Wall	SV	Stop valve	BT	British Telecom
Concrete Wall	ST	Stop top	CB	Control box
Concrete Wall	ER	Earth rod	TT	Tank
Concrete Wall	W	Water meter	BP	Block paved
Concrete Wall	GV	Gas valve	CP	Concrete paving slab
Concrete Wall	AV	Air valve	CR	Cover
Concrete Wall	CU	Unventilated inspection	KS	Keystone
Concrete Wall	WM	Wash out	TR	Tree Tag
Concrete Wall	PR	Post & Rail	RE	Road sign
Concrete Wall	PL	Post & Line	CTV	Cable to TV
Concrete Wall	CL	Chain Link	M	Marker post
Concrete Wall	WP	Wooden Pile	GM	Gas marker post
Concrete Wall	CB	Close Boarded	So	Soil
Concrete Wall	SP	Steel Pile	FL	Face Level
Concrete Wall	FL	Face Level	GR	Gravel to fill

Rev	Date	Description	Drawn	Q. Ref.

**greenhatch group**

- Topographical Surveys
- Site Engineering
- Utility / CCTV Surveys
- Measured Building Surveys
- 3D Laser Scanning
- Revit & BIM Models

**Rowan House**  
Duffield Road  
Little Eaton  
Derby  
DE21 5DR

Tel (01332) 830044 Fax (01332) 830055  
admin@greenhatch-group.co.uk  
www.greenhatch-group.co.uk

St Albans Unit B, The Courtyard Alban Park St Albans Hertfordshire AL4 0LA t. (01727) 854481	Newcastle 24 Riverside Studios Amethyst Road Newcastle Bus, Park Newcastle-U-Tyne NE4 7YL t. (01912) 736391	London 27, Cornwall Terrace Mews Regents Park London NW1 5LL t. (02072) 241806
--	---	---

**Southern boundary west**  
**Tree locations where works required (highlighted numbers, or offsite in red text)**

**Topographical Plan**

SCALE	DATE
A3@ 1: 200	17.07.2017
DRAWN	QUALITY REF
GP	F1573
Level datum	OS GPS
Grid orientation	OS GPS
Job number	22929
Drawing No.	Rev.
<b>725.12</b>	

**Comments**  
This plan should only be used for its original purpose. Greenhatch Group accepts no responsibility for this plan if supplied to any party other than the original client.  
All dimensions should be checked on site prior to design and construction.  
Drainage information (where applicable) has been visually inspected from the surface and therefore should be treated as approximate only.

Notes:

Copyright Greenhatch Group, 08/07/13

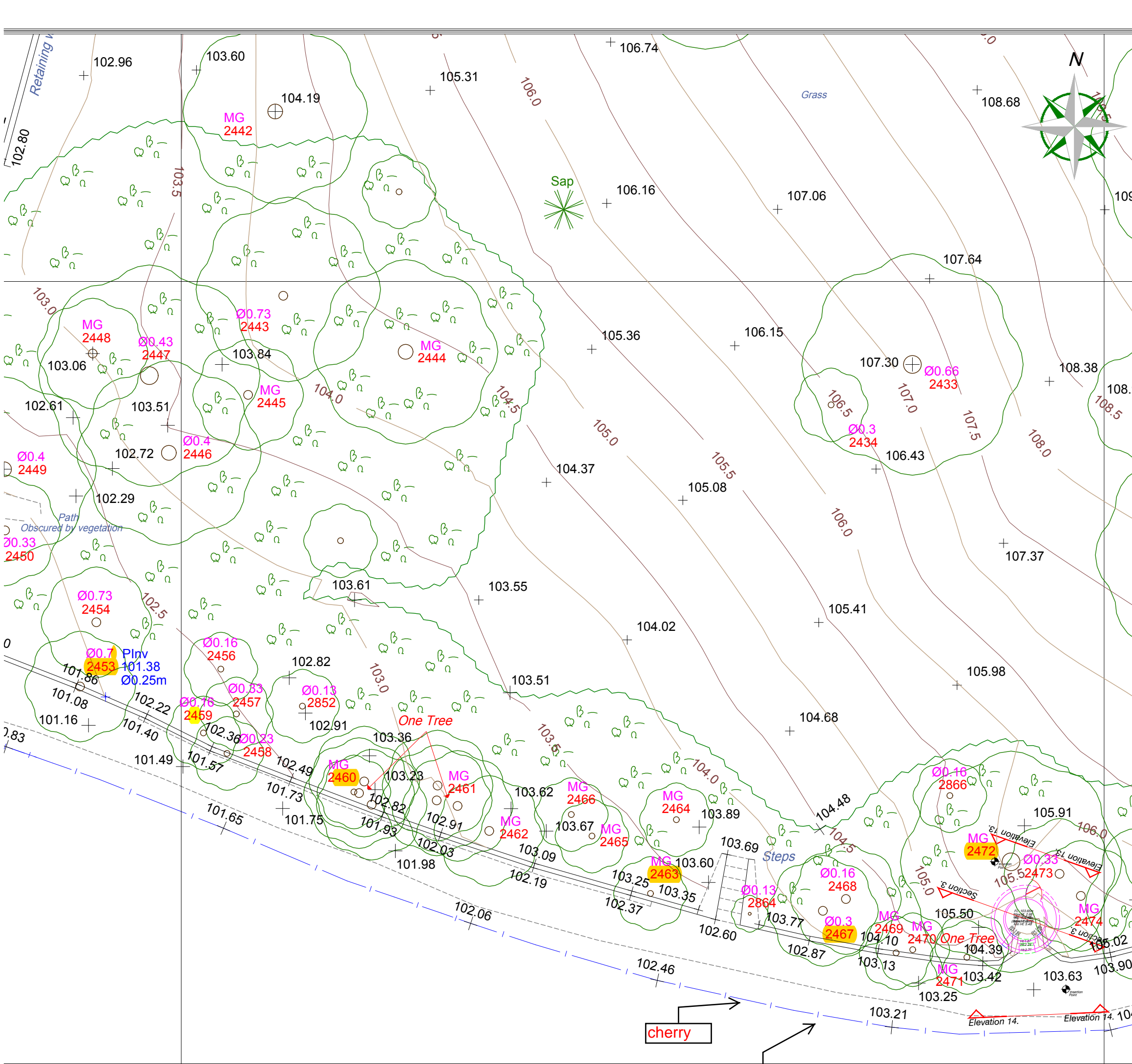

**OS Note:**  
Some services may have been omitted due to parked vehicles. The Ordnance Survey file is to be used as a guide only.

**OS Buildings** **Surveyed Buildings**

This survey has been orientated to the Ordnance Survey (O.S.) National Grid OSGB36(15) via Global Navigational Satellite Systems (GNSS) and the O.S. Active Network (OS Net).  
A true OSGB36 coordinate has been established near to the site centre via a transformation using the OSTN15GB & OSGM15GB transformation models.  
The survey has been correlated to this point and a further one or more OSGB36 (15) points established to create a true O.S. bearing for angle orientation.  
No scale factor has been applied to the survey therefore the coordinates shown are arbitrary & not true O.S. Coordinates which have a scale factor applied.  
Please refer to Survey Station Table to enable establishment of the on-site grid and datum.

**Legend:**

Wall	Overhead Cable	IC Inspection chamber	Bo Bolland
Kerb line	Concrete edge	Pluv Pipe invert	B Illuminated bollard
Kerb line	Tarmac edge	Gully	Bm Rubbish bin
Line marking	Glass verge	Bg Back gully	Vp Vent pipe
Drop kerb	Concrete kerb	Dp Down pipe	Gt Ground light
Centre line	Verge	Pipe	Lbox Letter box
Station and Name	Station Level	MH Manhole	Stp Tree Stump
Station Level	Flood light	FL Flood light	Sfy Site
Tree / Bush / Sapling	Lamp post	Lp Lamp post	THL Threshold level
Area of Undergrowth	Telegraph post	Tp Telegraph post	Sp Sign post
Woodland	Electricity post	Ep Electricity post	TH Traffic light
Ridge Level	Traffic light	Tl Traffic light	BH Bonhole
Eaves Level	Bus stop	Bus Bus stop	ELC Electric
Flat Roof Level	Stop valve	Sv Stop valve	BT British Telecom
Gate	Stop top	St Stop top	Cbox Control box
Gas	Earth rod	Er Earth rod	TT Tactile
Gas valve	Water meter	Wm Water meter	BP Block paved
Av Air valve	Concrete paving slab	Cpr Concrete paving slab	Cpr Concrete paving slab
CU Unearthed inspection	Cover	Cvr Cover	Cvr Cover
Wash out	Roofing post	Roof Roofing post	Red Numbers
Roofing eye	Tree Tag	Red Numbers	Red Numbers
Barbed beacon	Tree canopy level	Tree Diameter	Tree Diameter
Cable to	Multi grids	MG Multi grids	MG Multi grids
Marker post	Inspection chamber	IC Inspection chamber	IC Inspection chamber
Gas marker post	Cover level	CL Cover level	CL Cover level
So Soils	Invert level	IL Invert level	IL Invert level
Tree location	Utility to 10	UTL Utility to 10	UTL Utility to 10

Rev	Date	Description	Drawn	D. Ref.

**greenhatch group**

Topographical Surveys     Measured Building Surveys  
 Site Engineering     3D Laser Scanning  
 Utility / CCTV Surveys     Revit & BIM Models

**Rowan House**  
 Duffield Road  
 Little Eaton  
 Derby  
 DE21 5DR  
 Tel (01332) 830044    Fax (01332) 830055  
 admin@greenhatch-group.co.uk  
 www.greenhatch-group.co.uk

St Albans Unit B, The Courtyard Alban Park St Albans Hertfordshire AL4 0LA t. (01727) 854481	Newcastle 24 Riverside Studios Amethyst Road Newcastle Bus, Park Newcastle-U-Tyne NE4 7YL t. (01912) 736391	London 27, Cornwall Terrace Mews Regents Park London NW1 5LL t. (02072) 241806
--	---	---

CLIENT

**SHH Architects**

PROJECT

**Athlone House  
Hampstead Lane  
N6 4SA**

**Southern boundary central**  
**Tree locations where works required**  
**(highlighted numbers, or offsite in red text)**

Job number 22929

Drawing No. **725.12**

Rev.

Comments  
This plan should only be used for its original purpose. Greenhatch Group accepts no responsibility for this plan if supplied to any party other than the original client.  
All dimensions should be checked on site prior to design and construction.  
Drainage information (where applicable) has been visually inspected from the surface and therefore should be treated as approximate only.

Notes:



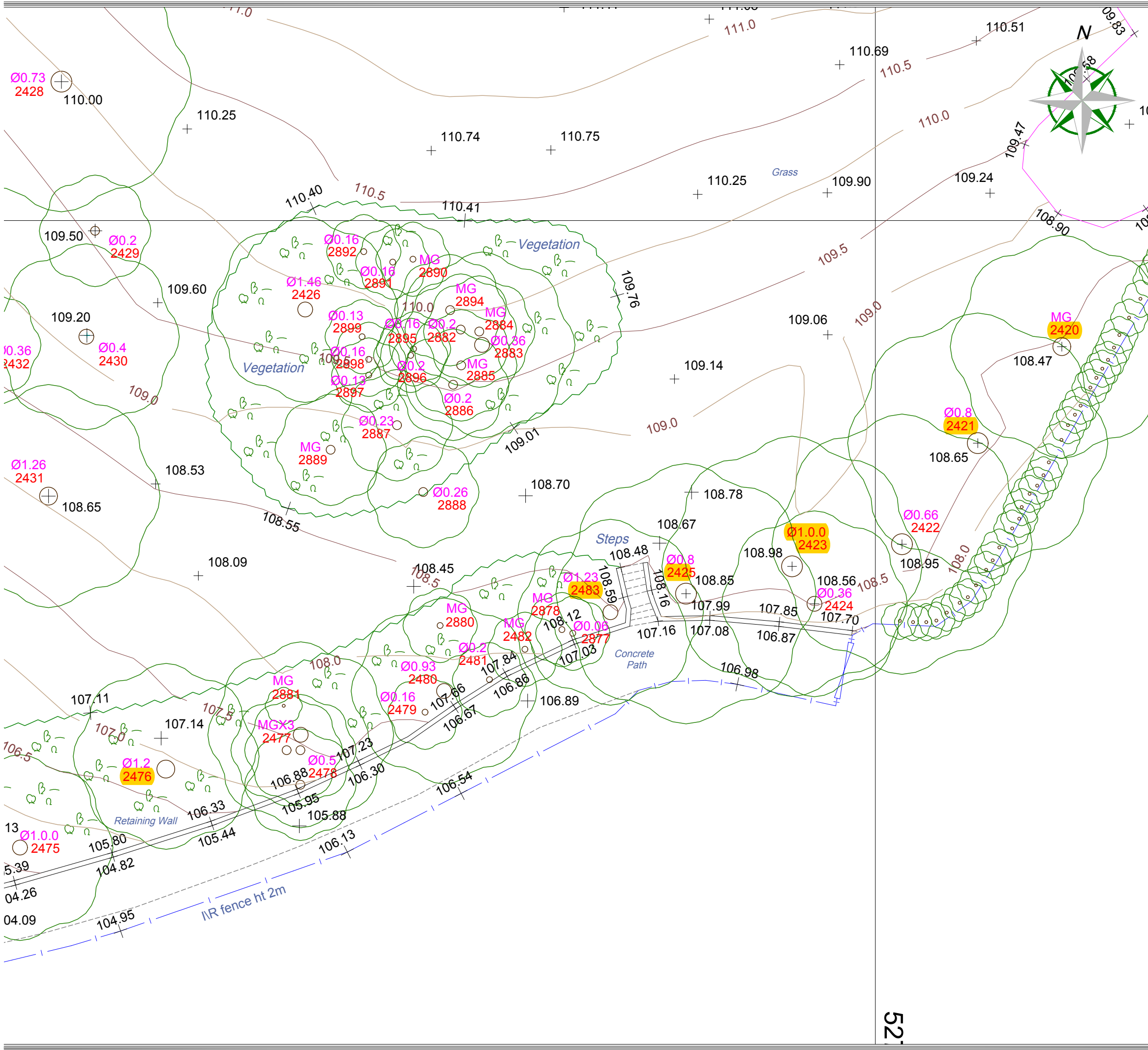

**OS Note:**  
Some services may have been omitted due to parked vehicles. The Ordnance Survey file is to be used as a guide only.

**OS Buildings**

This survey has been orientated to the Ordnance Survey (O.S.) National Grid OSGB36(15) via Global Navigational Satellite Systems (GNSS) and the O.S. Active Network (OS Net).  
A true OSGB36 coordinate has been established near to the site centre via a transformation using the OSTN15GB & OSGM15GB transformation models.  
The survey has been correlated to this point and a further one or more OSGB36 (15) points established to create a true O.S. bearing for angle orientation.  
No scale factor has been applied to the survey therefore the coordinates shown are arbitrary & not true O.S. Coordinates which have a scale factor applied.  
Please refer to Survey Station Table to enable establishment of the on-site grid and datum.

**Legend:**

Overhead Cable	IC	Inspection chamber	Bo	Boiler
Wall	PIW	Pipe invert	IS	Illuminated bollard
Asphalt	Gr	Gravel	BN	Rubbish bin
Line marking	Blg	Black gully	Vp	Vent pipe
Drop kerb	Dp	Down pipe	Gr	Ground light
Centre line	Pipe	Pipe above ground	Lbox	Letter box
Water of drain	MH	Manhole	Stp	Tree stump
Station and Name	FL	Flood light	SK	Site
Station Level	Lp	Lamp post	RL	Internal floor level
Tree / Bush / Sapling	Tp	Telegraph post	THL	Threshold level
Area of Undergrowth	Ep	Electric post	Sp	Sign post
Woodland	Tl	Traffic light	TH	Trunkhole
Ridge Level	Bus	Bus stop	BN	Bonhole
Essex Level	Sv	Stop valve	ELC	Electric
Flat Roof Level	St	Stop top	BT	British Telecom
Gate	Er	Earth rod	Cbox	Control box
Gas	Wm	Water meter	TT	Tactics
Gas valve	CPR	Concrete paving slab	BP	Block paved
Iron Railings	Av	Air valve	COR	Cover
Wire Mesh	CU	Unearthed inspection	Knuff	Knocking post
Post & Rail	Wp	Wash out	Red Numbers	Tree Tag
Chain Link	Rd	Rodding eye	TCL	Tree canopy level
Wooden Panels	BB	Belted beacon	CD	Tree Diameter
Close Boarded	CTV	Cable to	MG	Multi grids
Close Boarded	Mkr	Marker post	IC	Inspection chamber
Close Boarded	Gmr	Gas marker post	CL	Cover level
Close Boarded	So	Soils	IL	Invert level
Close Boarded	Fl	Tree location	UTL	Utility to lift

Rev	Date	Description	Drawn	D. Ref.

**greenhatch group**

Topographical Surveys     Measured Building Surveys  
 Site Engineering     3D Laser Scanning  
 Utility / CCTV Surveys     Revit & BIM Models

**Rowan House**  
Duffield Road  
Little Eaton  
Derby  
DE21 5DR

Tel (01332) 830044    Fax (01332) 830055  
admin@greenhatch-group.co.uk  
www.greenhatch-group.co.uk

St Albans Unit B, The Courtyard Alban Park St Albans Hertfordshire AL4 0LA t. (01727) 854481	Newcastle 24 Riverside Studios Amethyst Road Newcastle Bus, Park Newcastle-U-Tyne NE4 7YL t. (01912) 736391	London 27, Cornwall Terrace Mews Regents Park London NW1 5LL t. (02072) 241806
--	---	---

CLIENT

**SHH Architects**

PROJECT

**Athlone House  
Hampstead Lane  
N6 4SA**

**Southern boundary east  
Tree locations where  
works required  
(highlighted numbers, or  
offsite in red text )**

Grid orientation OS GPS

Job number 22929

Drawing No. **725.12** Rev.

Comments  
This plan should only be used for its original purpose. Greenhatch Group accepts no responsibility for this plan if supplied to any party other than the original client.

All dimensions should be checked on site prior to design and construction.  
Drainage information (where applicable) has been visually inspected from the surface and therefore should be treated as approximate only.

Notes: