

# Declaration of performance

DoP number: 133850-A1W1111

Product name:

THORN BRONSGROEN WDF

(1) Identification code of product-type is DoP-number

(2) Reference number: 133850-A1W1111

(4)

  
**Wienerberger**

Wienerberger B.V.  
5301 LK Zaltbommel Hogeweg 95  
Nederland

(3) Intended use(s) in masonry walls, columns and partitions for:

unprotected masonry

(6) Assessment and verification of constancy of performance:

System 2+

(7) Notified Body:

0957

Performed:

(i) initial inspection of the manufacturing plant and of factory production control

(ii) continuous surveillance, assessment and evaluation of factory production control and issued certificate number 0957-CPD-0621

## (9) Declared performance:

Type of unit: HD -masonry unit

### Dimensions and tolerances

			Tm	Rm
Length:	mm	215	± 4	9
Width:	mm	102	± 3	6
Height:	mm	66	± 2	5
Tolerance:	category		T2	
Range:	category		R1	
Flatness of bed faces:	mm		NPD	
Plane parallelism:	mm		NPD	

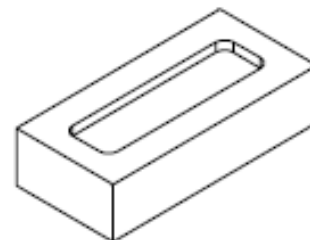

actual configuration may vary slightly

### Configuration

Group of the unit:	-	1
Volume of all formed voids:	%	NPD
Volume of frogs:	%	NPD

### Density

Gross dry density:	kg/m <sup>3</sup>	1700
Net dry density:	kg/m <sup>3</sup>	NPD
Tolerance:	category / %	D1 / 10

### Compressive strength

Category:	-	1
Perpendicular to bedface:	N/mm <sup>2</sup>	25
Perpendicular to header:	N/mm <sup>2</sup>	NPD
Perpendicular to header 2:	N/mm <sup>2</sup>	NPD

Bond strength: N/mm<sup>2</sup> NPD

Thermal conductivity  $\lambda_{10}$ , dry, unit: W/(m·K) 0.51

Water vapour permeability: -  $\mu = 5\text{-okt}$

Durability: category F2

Water absorption: % 12

Initial rate of water absorption: kg/(m<sup>2</sup>·min) 0.3-2

Active soluble salt content: category S2

Moisture movement: mm/m NPD

Reaction to fire: class A1

Dangerous substances: - Voldoet aan BBk

(10) The performance of the product is in accordance with the specification above.

Signed on behalf of the manufacturer:

CEO  
2013-07-01

B.J. Koekoek

Wienerberger B.V.  
5301 LK Zaltbommel Hogeweg 95  
Nederland

EN 771-1:2011

## Supplementary national information:

DoP number: 133850-A1W1111

Product name:

THORN BRONSGROEN WDF

(1) Identification code of product-type is DoP-number

(2) Reference number: 133850-A1W1111

(4)



# Wienerberger

Wienerberger B.V.

5301 LK Zaltbommel Hogeweg 95

Nederland