

This drawing is © C4 Consulting and is not to be copied, reproduced or re-distributed either in whole or in part without the prior written permission of the originator.

The originator shall have no responsibility for any liability, loss, cost, damage or expense arising from or relating to any use of this document other than for its intended purpose on this project.

This drawing shall be read in conjunction with all other relevant drawings, specifications and associated documentation. Any discrepancies, errors or omissions are to be reported to the originator before proceeding with work.

All dimensions are to be checked on site by the contractor prior to proceeding with any work. This drawing shall not be scaled to ascertain any dimensions, work to figured dimensions only.

**DISCLAIMER**  
When this drawing is issued in CAD, it is an uncontrolled version issued for information only, to enable the recipient to prepare their own documents/drawings for which they are solely responsible.

**SOFTWARE INTEROPERABILITY**  
C4 Consulting prepared this drawing using Autodesk REVIT Architecture.  
C4 Consulting does not accept liability for any loss or degradation of any information held in the drawing resulting from the translation from the original file format to any other file format or from the recipient's reading of it in any other programme.

Hazard Identification		
ref	hazard	date



VISUAL SCALE 1:150 @ A1

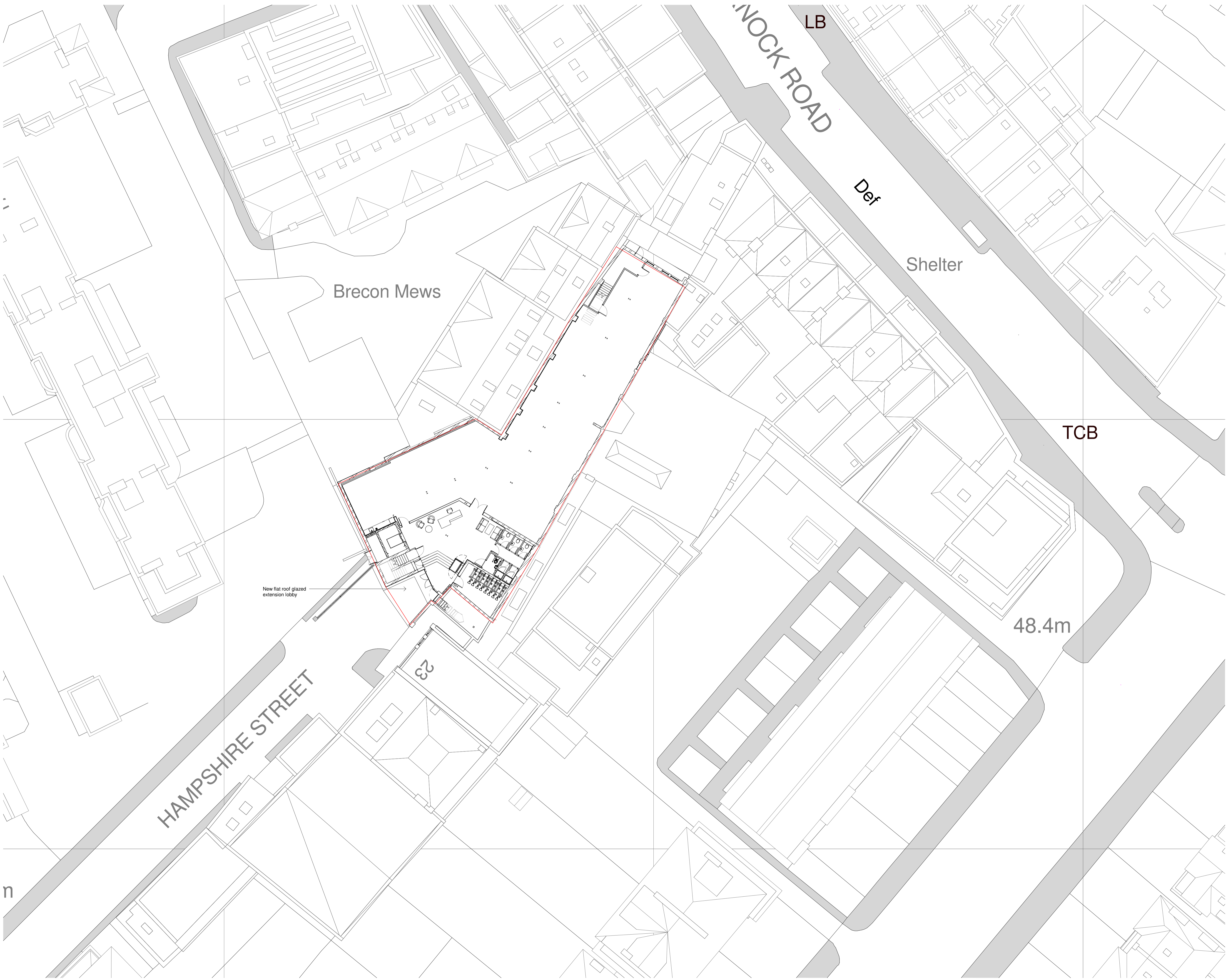
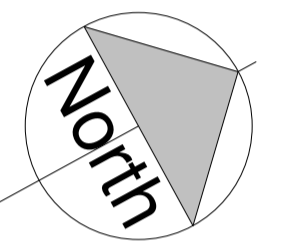

New flat roof glazed extension lobby

C	Updated for PLANNING	SW	05.02.18
B	Issued for TENDER PHASE 1	SW	16.01.18
A	Updated for PLANNING	SW	16.01.18
rev	revision details	by	date

**C4 Consulting**  
The Chapel, Old Cherry Lane,  
Lymington, Warrington  
WA13 0TA  
t: 01925 751 852  
e: info@c4consulting.co.uk  
www.c4consulting.co.uk

Project Management • Architecture • Building Surveying • Cost Consultancy

**Client**  
Industry House Developments Limited

**Project**  
Industry House  
23-25 Hampshire Street, London NW5 2TE

**Drawing Title**  
Site Plan as Proposed

Drawn by	P.Mahaffy	Date	22.12.2017
Checked by	J.Pass	Date	22.12.2017
Job no.	17-048	Scale	1 : 200 @ A1

Dwg no.	C4C-B1-Z1-A1-00-P2-01-001	Revision	C
---------	---------------------------	----------	---