

Proposed Dormer Windows: W2-06, W2-07
Second Floor
Elevation

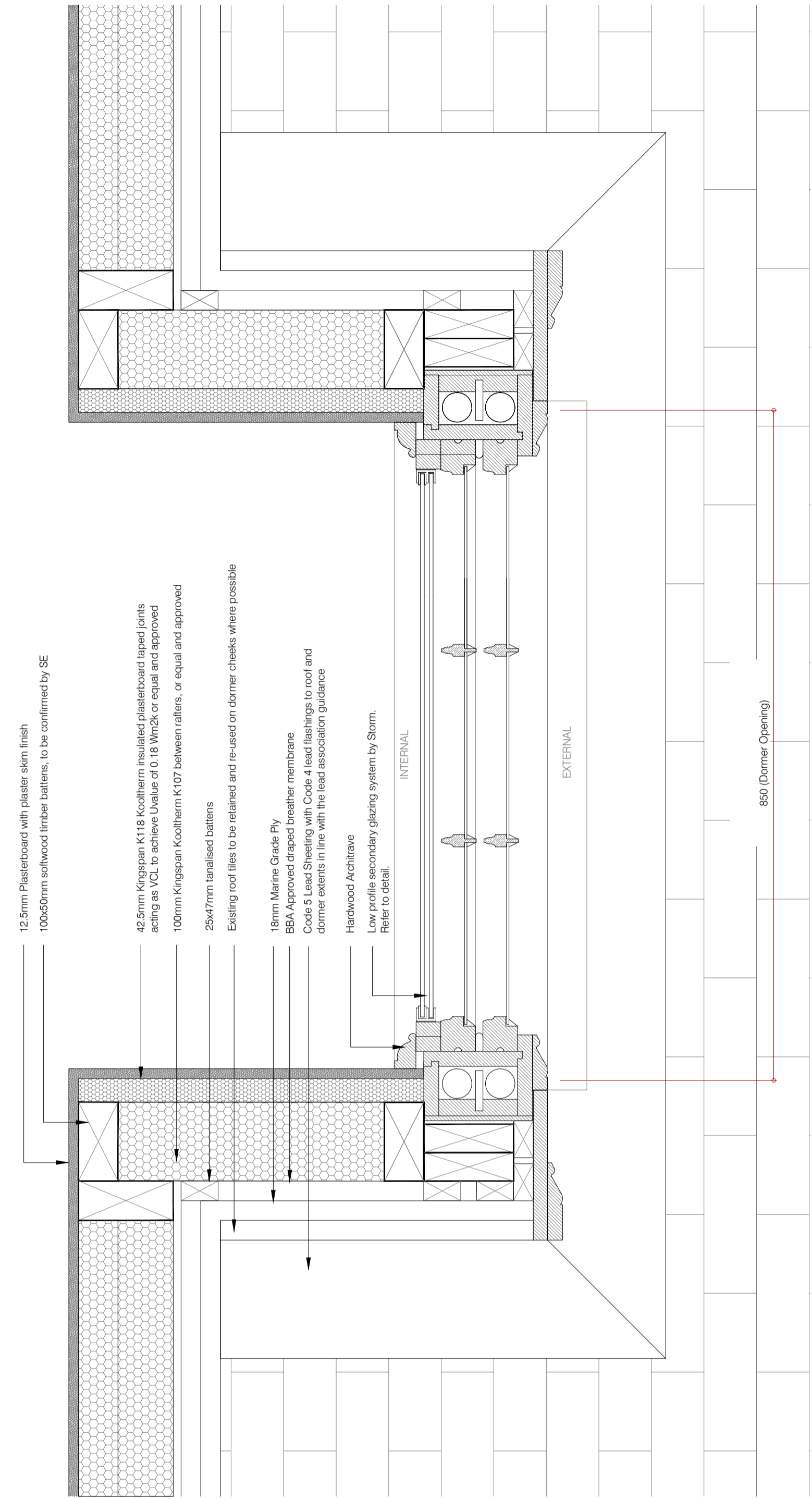

- 12.5mm Plasterboard with plaster skim finish
- 100x50mm softwood timber battens, to be confirmed by SE
- 42.5mm Kingspan K118 Kooltherm insulated plasterboard taped joints acting as VCL to achieve U-value of 0.18 W/m2K or equal and approved
- 100mm Kingspan Kooltherm K107 between rafters, or equal and approved
- 25x47mm insulaloc battens
- Existing roof tiles to be retained and re-used on dormer cheeks where possible
- 18mm Marine Grade Ply
- BBA Approved draped breather membrane
- Code 5 Lead Sheeting with Code 4 lead flashings to roof and dormer eaves in line with the lead association guidance
- Halfwood ACHIZIVE
- Low profile secondary glazing system by Storm.
- Refer to detail.

Proposed Dormer Windows: W2-06, W2-07
Second Floor
Plan

SCALE - 1:5

Rev.	Comments:	By:	Date:

Do not scale this drawing. All dimensions must be checked on site. All rights reserved. No reproduction in any material form is permitted without consent.

PLANNING

Client:

Project Title:
24 Heath Drive, London, NW3 7SB

Drawing Title:
Proposed Window Schedule - New Dormer Windows

Scale: 1:5@A1 Date: JAN 18 Drawn: ST Checked: HV

kyson[®]

Studio
28 Scrutton Street
London
UK
EC2A 4RP

T: +44(0) 20 7247 2462
E: enquiries@kyson.co.uk
W: www.kyson.co.uk

Project No.: 508-16 Drawing No.: 6110 Revision: -