

Proposed Dormer Window W2-05
Second Floor
Elevation

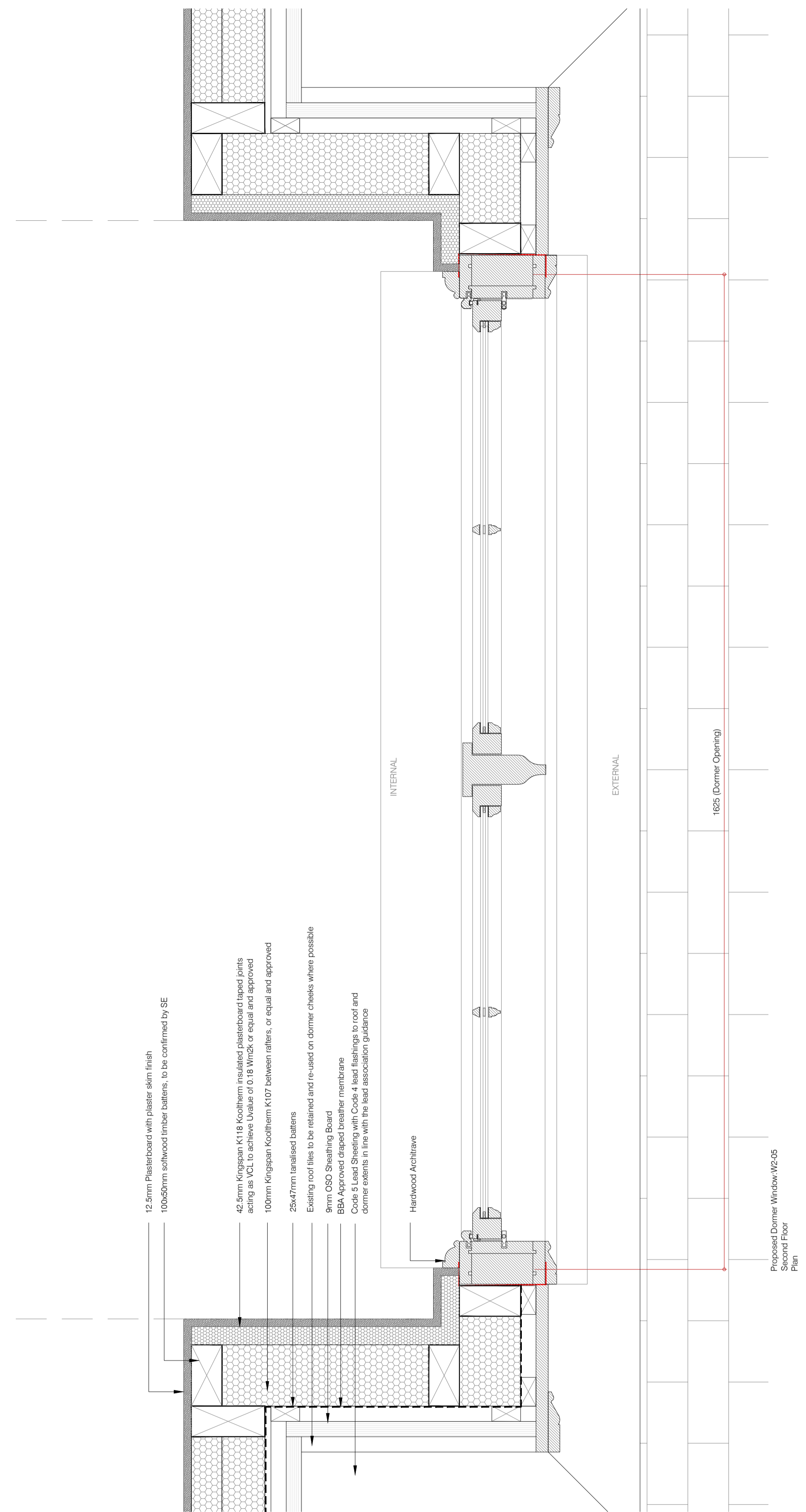

- 12.5mm Plasterboard with plaster skim finish
- 100x50mm softwood timber battens, to be confirmed by SE
- 42.5mm Kingspan K118 Kooltherm insulated plasterboard board joints acting as VCL to achieve U-value of 0.18 W/m²K or equal and approved
- 100mm Kingspan Kooltherm K107 between rafters, or equal and approved
- 25x47mm laminated battens
- Existing roof tiles to be retained and re-used on dormer cheeks where possible
- 9mm OSB Sheathing Board
- BB-A Approved drippet breather membrane
- Code 5 Lead Sheeting with Code 4 lead flashings to roof and dormer cheeks in line with the lead association guidance
- Hardwood Architrave

Proposed Dormer Window W2-05
Second Floor
Plan

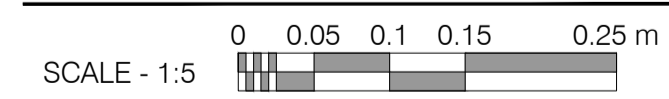

Rev: Comments: By: Date:

PLANNING

Client:

Project Title:
24 Heath Drive, London, NW3 7SB

Drawing Title:
Proposed
Window Schedule - New Dormer Windows

Scale: 1:5@A1 Date: JAN 18 Drawn: ST Checked: HV

Studio

28 Scrutton Street
London
UK
EC2A 4RP

T: +44(0) 20 7247 2462
E: enquiries@kyson.co.uk
W: www.kyson.co.uk

Project No.: 508-16 Drawing No.: 6108 Revision: -

Do not scale this drawing. All dimensions must be checked on site. All rights reserved. No reproduction in any material form is permitted without consent.

kyson[®]