

Detail 01
Floor Compartmentation - Existing Flooring - Typical Finish

Note 1: Fixing Method for historic floorboards to be in accordance with recommendations by Heritage Advisor.
Note 2: All junctions/gaps to be intumescently sealed.

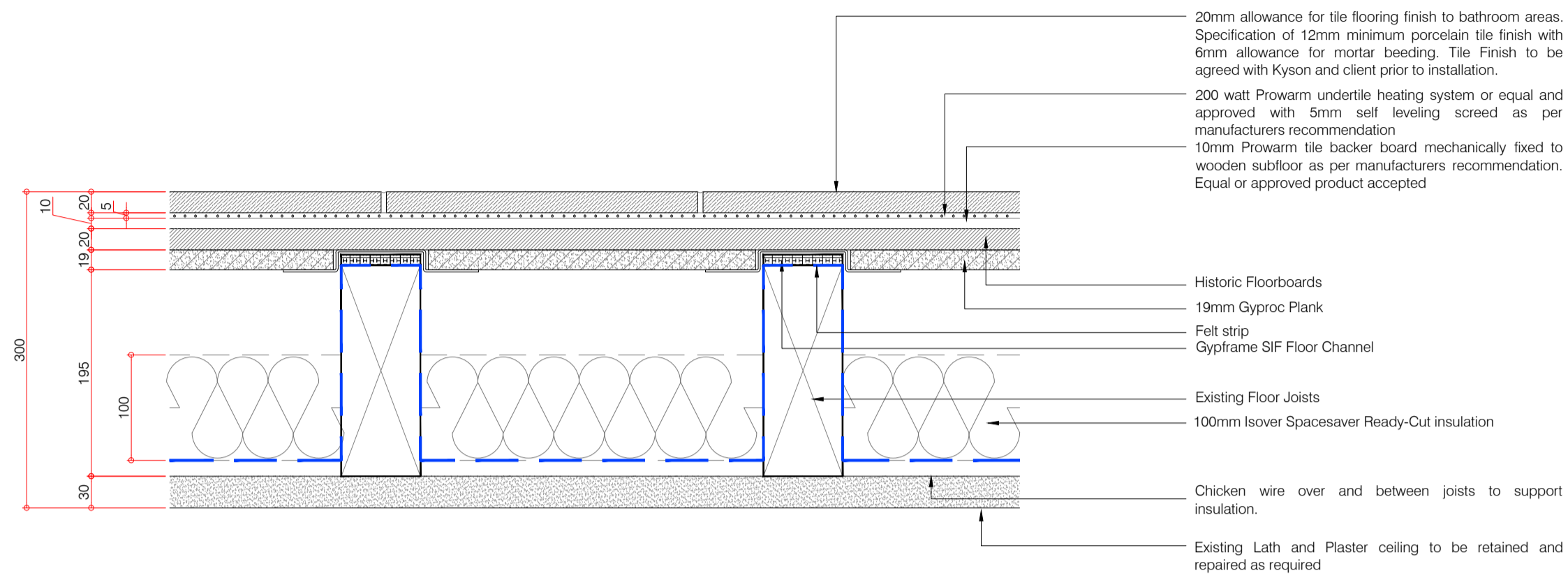

Detail 02
Floor Compartmentation - Existing Flooring with Underfloor heating

Note 1: Fixing Method for historic floorboards to be in accordance with recommendations by Heritage Advisor.
Note 2: All junctions/gaps to be intumescently sealed.

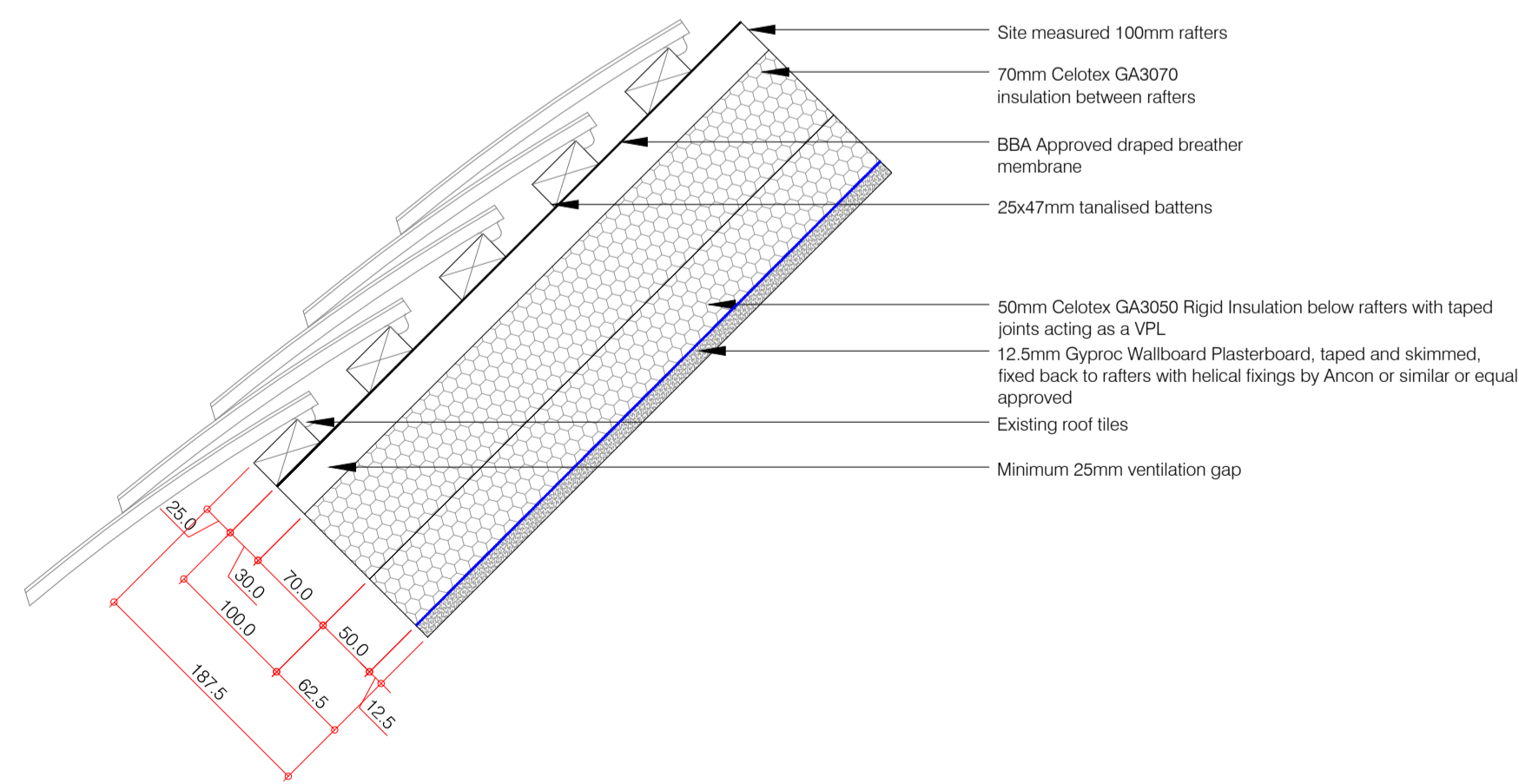

Detail 03
Pitched Roof proposal

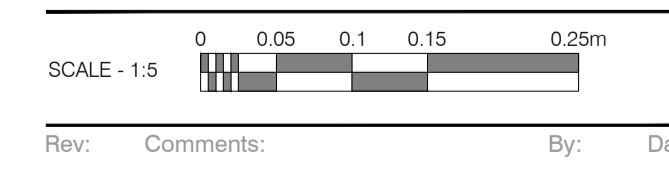

Rev.	Comments	By:	Date:
-	-	-	-

Do not scale this drawing. All dimensions must be checked on site. All rights reserved. No reproduction in any material form is permitted without consent.

PLANNING

Client:
-

Project Title:
24 Heath Drive, London, NW3 7SB

Drawing Title:
Typical Upgrading Detail

Scale: 1:5@A1
Date: Jan 18
Drawn: BAC
Checked: AH

kysonⁱ

Studio
28 Scrutton Street
London
UK
EC2A 4RP

T: +44(0) 20 7247 2482
E: enquiries@kyson.co.uk
W: www.kyson.co.uk

Project No.: 508-16
Drawing No.: 5002
Revision: A