

Ground Floor

Existing Internal Elevation

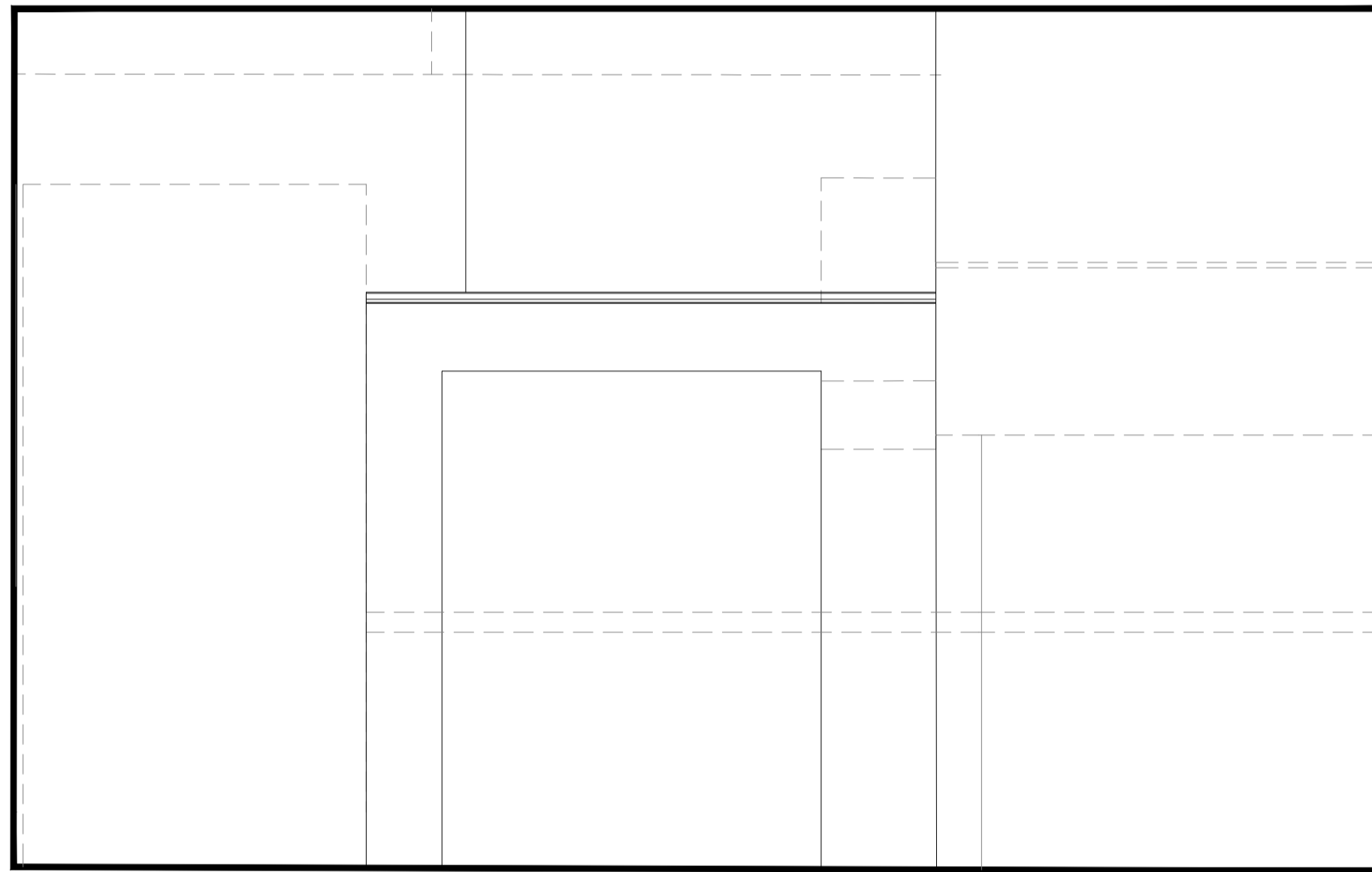

Proposed Internal Elevation

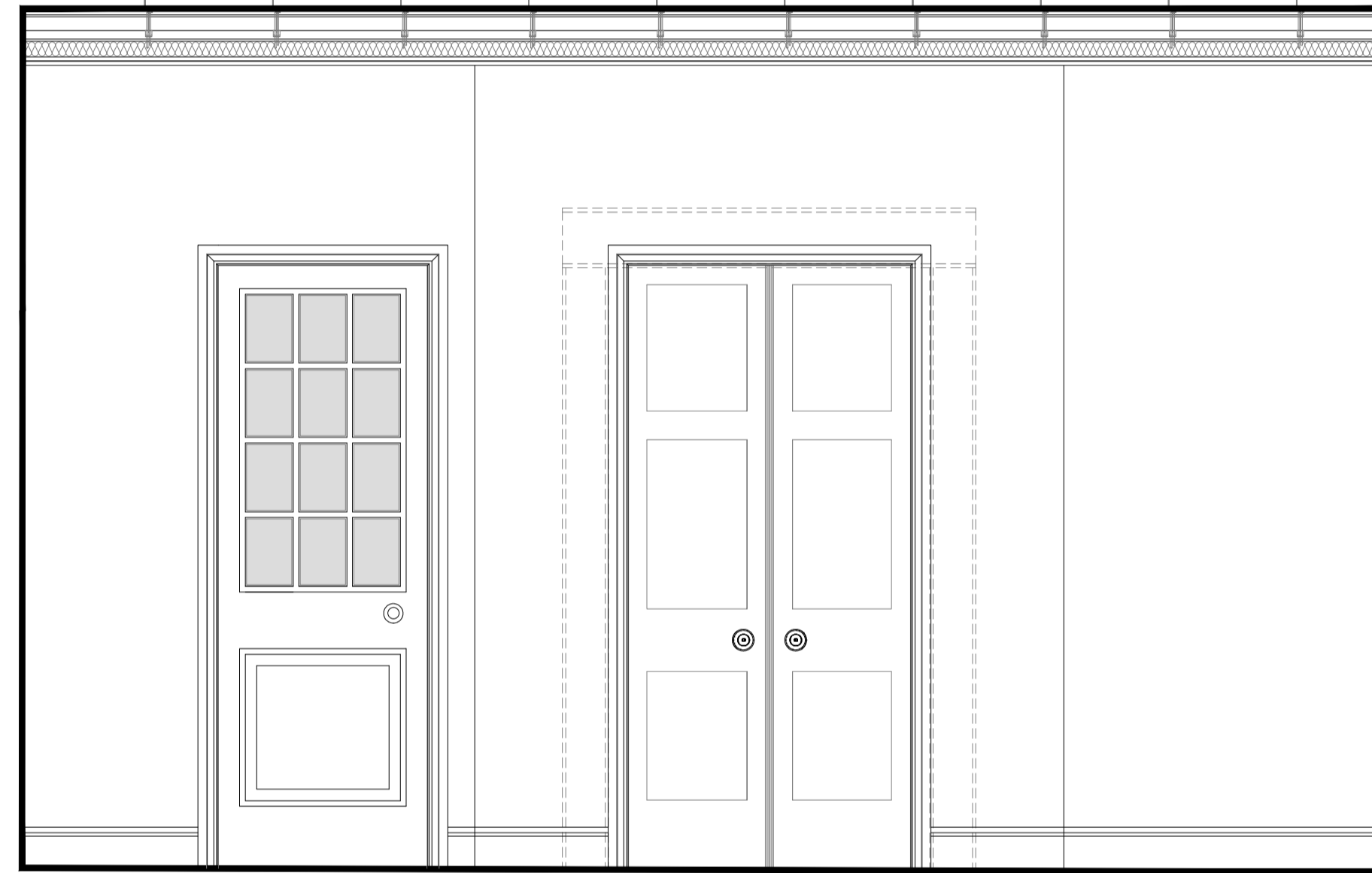

- Summary of changes:
- New door within existing masonry
 - Brickwork to be carefully cut and toothed in to form opening
 - New suspended ceiling to allow for installation of services (existing ceiling to be kept in situ)
 - Grey dashed line indicates structural goal post, refer to Structural Engineer's proposals for details

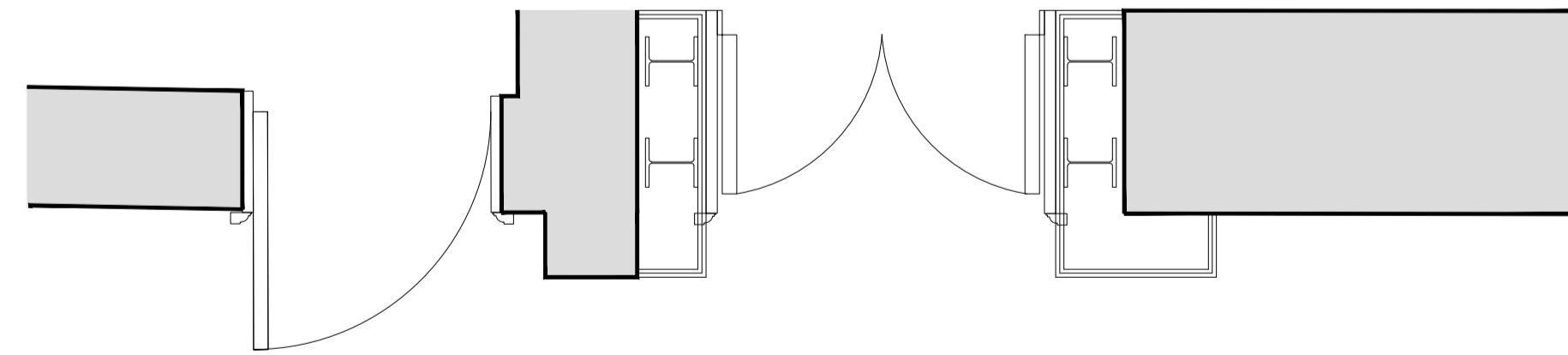

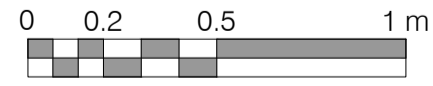
SCALE - 1:20 

Rev: Comments: By: Date:

Do not scale this drawing. All dimensions must be checked on site. All rights reserved. No reproduction in any material form is permitted without consent.

PLANNING

Client:

Project Title:
24 Heath Drive, London, NW3 7SB

Drawing Title:
Internal Elevations
Ground Floor - Kitchen

Scale: Date: Drawn: Checked:
1:20@A1 JAN 18 ST HV

kyson[®]

Studio

28 Scrutton Street
London
UK
EC2A 4RP

T: +44(0) 20 7247 2462
E: enquiries@kyson.co.uk
W: www.kyson.co.uk

Project No.: Drawing No.: Revision:
508-16 3106 -