

Wall Types Key (All to be installed in accordance with Manufacturer's written guidelines and instructions)	
	Wall Type 1 - Dry lining to Basement External Wall (U Value 0.28W/m²K): Delta MS500 wall tanking membrane or similar or equal approved with 60mm Celotex GA3050 insulation with 30mm air gap in front with independent 100mm blockwork. Blockwork density and head restraint/indirect requirements to Structural Engineer's detailed design and specification. Finishes vary. Allow for 30mm tile zone to Swimming Pool, Wet Room, Jet Shower, Sauna, WC and Shower/Steam Room. Allow for 2No. Layers 12.5mm Gyproc Wallboard Plasterboard on 10mm dabs with D12 shadow gap propriety channel by Qc Trims Ltd (or similar approved or equal approved) to Changing Room, Poolside Gallery, Treatment Room, Gym/Media Room and Stair Area. Allow for 15mm Render parge coat to walls within rooms housing Plant equipment. Plasterboard to be taped and skimmed. Waterproofing details TBC by Specialist Subcontractor. 30 years warranty certificate to be provided upon completion. NOTE: All works to be in strict accordance with manufacturer's written recommendations.
	Wall Type 2 - External Wall (U Value 0.29W/m²K): 1No. Layer 12.5mm Gyproc Wallboard Plasterboard on 10mm dabs, Plasterboard to be taped and skimmed; 100mm Blockwork (Blockwork Thermal Conductivity of 0.15W/mK), min. 100mm Cavity with 100mm Earthwool DiTherm Cavity Slab 32 Ultimate (thermal conductivity of 0.032 W/mK), 102.5mm facing brickwork 'Old Victorian Pressed Medium Dark by Funness to match existing. Block and Brick to be tied with Ancon Wall ties (or similar or equal approved) at maximum 750mm spacing horizontally and 450mm spacing vertically to Structural Engineer's design and specification. NOTE: All works to be in strict accordance with manufacturer's written recommendations.
	Wall Type 3 - Partition (Blockwork): 2No. Layers 12.5mm Gyproc Wallboard Plasterboard on 10mm dabs either side of 100mm blockwork as per Structural Engineer's specification. D12 shadow gap propriety channel by Qc Trims Ltd (or similar approved or equal approved) to be used throughout. Plasterboard to be taped and skimmed. NOTE: All works to be in strict accordance with manufacturer's written recommendations.
	Wall Type 4 - Partition (Rows of Blockwork): 1No. Layer 12.5mm Gyproc Wallboard Plasterboard on 10mm dabs either side of 2No. rows of 100mm blockwork as per Structural Engineer's specification with 100mm cavity between fully filled with 100mm Earthwool DiTherm Cavity Slab 32 Ultimate. Plasterboard to be taped and skimmed. NOTE: All works to be in strict accordance with manufacturer's written recommendations.
	Wall Type 5 - Partition between Room and Wet Area (Blockwork): 2No. Layers 12.5mm Gyproc Wallboard Plasterboard on 10mm dabs to room side of 100mm blockwork as per Structural Engineer's specification. D12 shadow gap propriety channel by Qc Trims Ltd (or similar or equal approved) to be used throughout (not in WC/Shower/Steam/Sauna/Jet Shower). 1No. Layer Tile Backer Board to Wet Area side to take 12mm tile finish and 8mm adhesive bed. Walls adjacent to shower areas and underside of shower trays to have Bal waterproofing system applied. Plasterboard to be taped and skimmed. NOTE: Where wall forms partition within Wet Area (WC/Shower/Steam/Sauna/Jet Shower), wall make-up to be as per specification of bathroom side for both sides of blockwork. Note: All works including fixing through tanking membrane to be in strict accordance with manufacturer's written recommendations.
	Wall Type 6 - Internal Blockwork Wall (215mm): 215mm high density solid block (Minimum 1900kg/m³) with nominal 15mm Render parge coat (minimum 13mm) to either side and 2No. Layers 12.5mm Gyproc Wallboard Plasterboard on 10mm dabs to Treatment room side with D12 shadow gap propriety channel by Qc Trims Ltd (or similar or equal approved). High density block to be laid in a single course stretcher bond arrangement, on its side. Mortar beds may be 10-15mm thick to permit coursing to junction with inner leaf. Plasterboard to be taped and skimmed. NOTE: All works to be in strict accordance with manufacturer's written recommendations.
	Wall Type 7 - Partition (Metal Studs): 2No. Layers 12.5mm Gyproc Wallboard Plasterboard fixed either side of Gyproframe 48 S 50 C studs @ 600mm centres cross braced with Gyproframe 99 FC 50 Firing Channel @ 1200mm centres fixed to each stud with 2No. British Gypsum Water Head Drywall Screws with 50mm Isover APR 1200 acoustic insulation. Allow for 1No. Layer Tile Backer Board to Wet Area side to take 12mm tile finish and 8mm adhesive bed. Plasterboard to be taped and skimmed. NOTE: All works to be in strict accordance with manufacturer's written recommendations.
	Wall Type 8 - Partition between Rooms (Timber Studs): 2No. Layers 12.5mm Gyproc Wallboard Plasterboard fixed to room side of either 1 or 2 rows of 89x44mm timber studs at 300mm C/Cs (TBC by Structural Engineer) with 50mm Isover APR 1200 acoustic insulation between studs. 1No. Gyproc Moisture Resistant Board and 1No. Layer Tile Backer Board to bathroom side to take 12mm tile finish and 8mm adhesive bed (Note: 12mm ply patress to be used where required to replace moisture resistant board for fixing sanitaryware). Walls adjacent to shower areas and underside of shower trays to have Bal waterproofing system applied. Plasterboard to be taped and skimmed. NOTE: Where wall forms partition within bathroom, wall make-up to be as per specification of bathroom side for both sides of stud. All works including fixing through tanking membrane to be in strict accordance with manufacturer's written recommendations.
	Wall Type 9 - Wall lining within En-suites/Bathrooms: 1No. Layer Gyproc Moisture Resistant Board. 1No. Layer Tile Backer Board to bathroom side to take 12mm tile finish and 8mm adhesive bed (Note: 12mm ply patress to be used where required to replace moisture resistant board for fixing sanitaryware). Boards to be fixed to 89x44mm timber studs at 300mm C/Cs (TBC by Structural Engineer). Walls adjacent to shower areas and underside of shower trays to have Bal waterproofing system applied. Plasterboard to be taped and skimmed. NOTE: All works to be in strict accordance with manufacturer's written recommendations.
	Wall Type 10 - Independent Wall Lining - Type 1: 1No. Layer of 12.5mm Gyproc Wallboard Plasterboard on 12mm plywood fixed to 89x44mm timber studs at 300mm C/Cs (TBC by Structural Engineer). Plasterboard to be taped and skimmed. NOTE: All works to be in strict accordance with manufacturer's written recommendations.
	Wall Type 11 - Independent Wall Lining - Type 2: 1No. Layer of 12.5mm Gyproc Wallboard Plasterboard on 12mm plywood fixed to 50x25mm timber battens at 300mm C/Cs. No fixing into brickwork permitted. Plasterboard to be taped and skimmed. NOTE: All works to be in strict accordance with manufacturer's written recommendations.
	Wall Type 12 - New Dormer Cheeks and Roof (U Value 0.18W/m²K): 4mm Welded Weathering Steel Cladding (Cortens) fixed to steel Frame (Size and specification TBC by SE) with Celotex GA3050 PIR Insulation to fully fill frame depth with inner layer of 50mm Celotex GA3050 insulation within 50x50mm timber sub frame with 18mm Plywood Sheathing board with Tyvek Vapour Control Layer with 1No. Layers 12.5mm Gyproc Wallboard Plasterboard. D12 shadow gap propriety channel by Qc Trims Ltd (or similar approved or equal approved). Plasterboard to be taped and skimmed. NOTE: All works to be in strict accordance with manufacturer's written recommendations.
	Wall Type 13 - Existing Walls: Refer to Kyscon 1500 series of Drawings for information and specification of required works.
	Wall Type 14 - Rear Extension Walls: 4mm Welded Weathering Steel Cladding (Cortens) fixed to steel Frame (Size and specification TBC by SE) with Celotex GA3050 PIR Insulation to fully fill frame depth with inner layer of 50mm Celotex GA3050 insulation within 50x50mm timber sub frame with 18mm Plywood Sheathing board with Tyvek Vapour Control Layer with 1No. Layers 12.5mm Gyproc Wallboard Plasterboard. D12 shadow gap propriety channel by Qc Trims Ltd (or similar approved or equal approved). Plasterboard to be taped and skimmed. NOTE: All works to be in strict accordance with manufacturer's written recommendations.

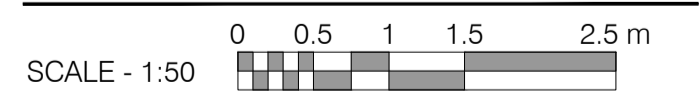
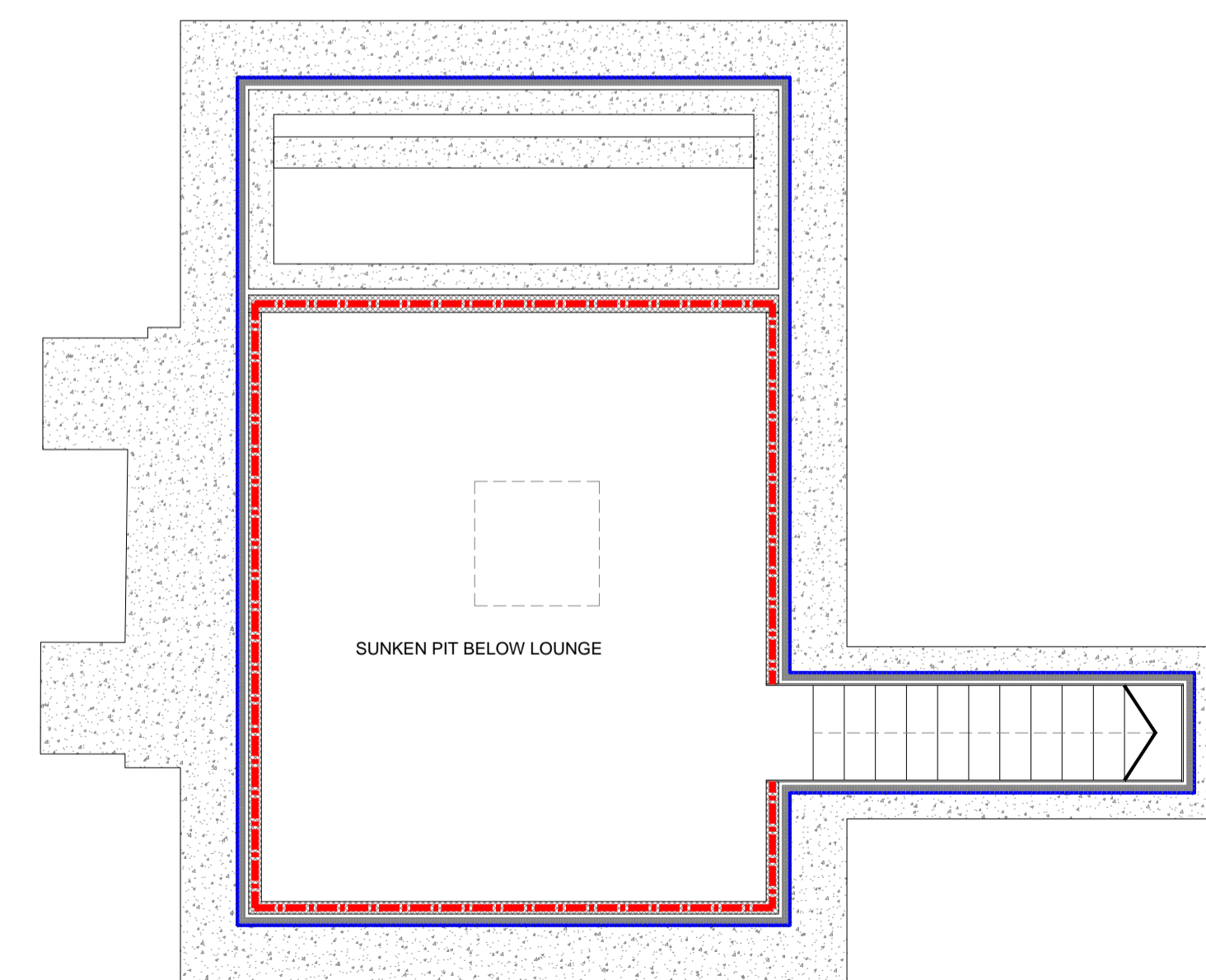

SCALE - 1:50

Rev:	Comments:	By:	Date:

PLANNING

Client: _____

Studio: _____

28 Scrutton Street
London
UK
EC2A 4RP

Project Title:
24 Heath Drive, London, NW3 7SB

T: +44(0) 20 7247 2462
E: enquiries@kyson.co.uk
W: www.kyson.co.uk

Scale:	Date:	Drawn:	Checked:	Project No.:	Drawing No.:	Revision:
1:50@A1	JAN 18	KK	AH	508-16	2299	A

Do not scale this drawing. All dimensions must be checked on site. All rights reserved. No reproduction in any material form is permitted without consent.