

**NOTE:**  
DRAWING TO BE READ IN CONJUNCTION WITH SUGGESTED SEQUENCE OF CONSTRUCTION - DRAWING SERIES L(30)01 - 11

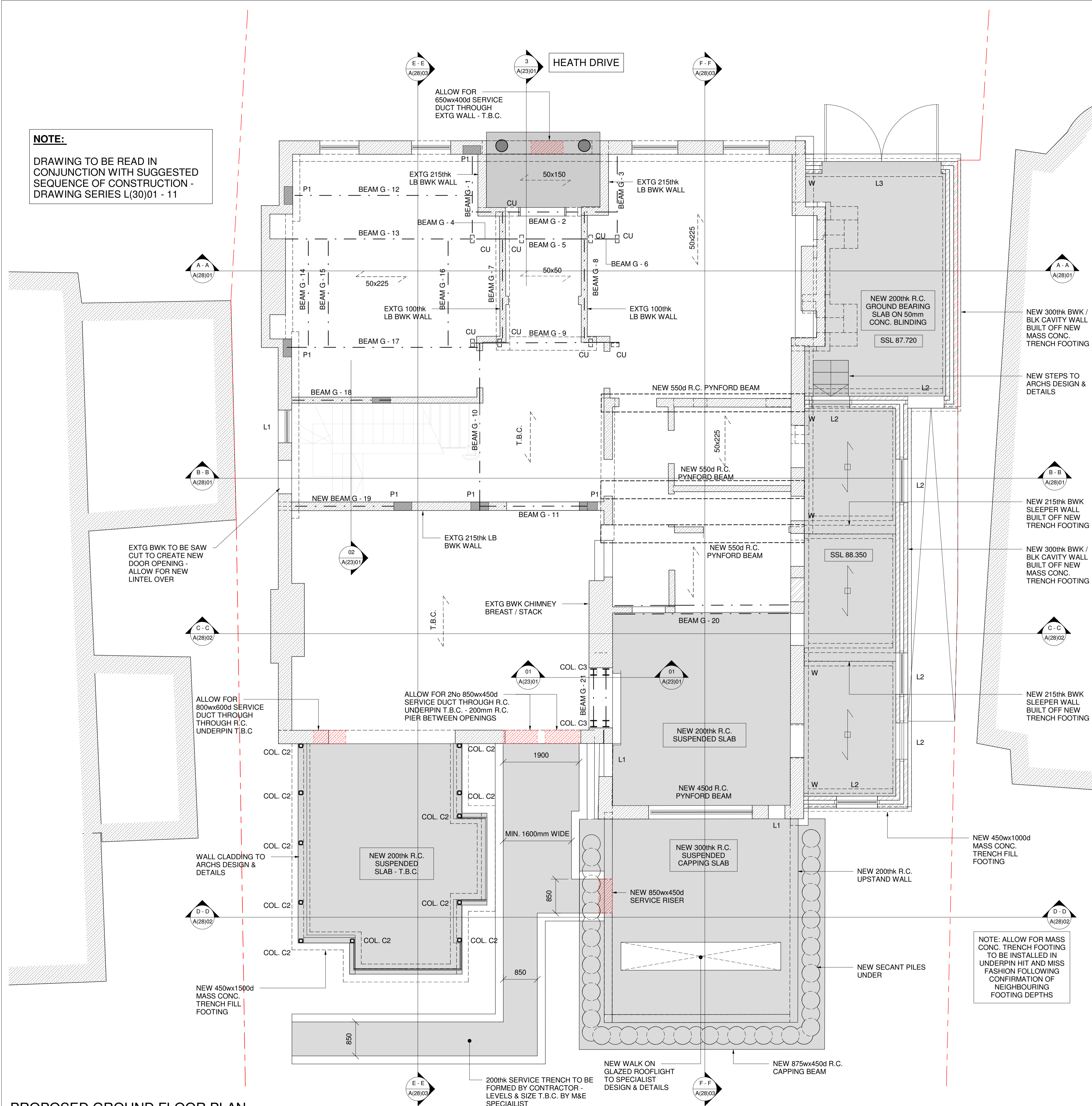

LINTEL SCHEDULE	
MARK	DESCRIPTION
L1	150dp PRE-STRESSED P.C LINTEL/S TO SUIT WIDTH OF WALL
L2	CG90/100 CATNIC CAVITY WALL LINTEL
L3	203x203 UC60

PADSTONE SCHEDULE	
MARK	DESCRIPTION
P1	450gx225dpxWIDTH OF WALL MASS CONCRETE

STRUCTURAL GROUND FLOOR STEEL BEAM SCHEDULE	
Mark	SIZE
BEAM G - 1	UC203x203x46
BEAM G - 2	UC203x203x46
BEAM G - 3	UC203x203x46
BEAM G - 4	UC203x203x46
BEAM G - 5	UC203x203x46
BEAM G - 6	UC203x203x46
BEAM G - 7	UC203x203x46
BEAM G - 8	UC203x203x46
BEAM G - 9	UC203x203x46
BEAM G - 10	UC203x203x46
BEAM G - 11	UB203x133x30
BEAM G - 12	UC203x203x60
BEAM G - 13	UC203x203x60
BEAM G - 14	UB203x133x30
BEAM G - 15	UB203x133x30
BEAM G - 16	UB203x133x30
BEAM G - 17	UC203x203x60
BEAM G - 18	UC203x203x60
BEAM G - 20	2No PFC200x90x30's WITH 12mm WELDED BOTTOM PLATE WELDED TO 1 BEAM & BOLTED TO OTHER (6mm C.F.W. & M12 BOLTS @ 350c/c)
BEAM G - 21	2No UC203x203x60's

STRUCTURAL COLUMN SCHEDULE	
MARK	SIZE
COL. C1	RHS200x100x5.0
COL. C2	SHS100x100x10.0
COL. C3	UC152x152x37

**Notes**  
THIS DRAWING IS COPYRIGHT OF FORM.  
DO NOT SCALE FROM THIS DRAWING WORK ONLY TO FIGURED DIMENSIONS.  
THE CONTRACTOR IS TO VERIFY ALL DIMENSIONS ON SITE BEFORE COMMENCING WORK. ALL ERRORS AND OMISSIONS ARE TO BE REPORTED TO THE ENGINEER.  
THIS DRAWING IS TO BE READ IN CONJUNCTION WITH ALL RELEVANT ARCHITECTS, SERVICES ENGINEERS AND ENGINEERS DRAWINGS AND SPECIFICATIONS.

KEY	
WALL TYPES	KEY
	EXISTING WALL
	NEW 20N/mm² BRICKWORK IN DESIGNATION (iii) MORTAR.
	NEW 7N/mm² MEDIUM DENSE BLOCKWORK IN DESIGNATION (iii) MORTAR.
	NEW LOADBEARING TIMBER STUD PARTITION (50x100 C24 STUDS AT 400c/c).
	NEW NON LOAD BEARING PARTITION.
	LOAD BEARING WALL UNDER.
	NEW BRICKWORK TO BE FULLY TOOTHED IN AND PACKED UP TO EXTG BRICKWORK
	STAINLESS STEEL WALL EXTENSION PROFILES.
ALL MASONRY BELOW DPC LEVEL TO BE FROST RESISTANT AND IN DESIGNATION (i) MORTAR.	
LEGEND	
	NEW BEAM UNDER.
	DOUBLED TIMBERS TRIMMING OPENINGS/ UNDER PARTITIONS.
	NOTES SPAN OF NEW 50x200 C24 TIMBER JOISTS AT 400c/c U.N.O.
	NOTES SPAN OF NEW 50x150 C24 TIMBER RAFTERS AT 400c/c U.N.O.
	NOTES SPAN OF NEW 75x100 C24 TIMBER RAFTERS AT 400c/c U.N.O.
	NOTES SPAN OF NEW CONCRETE SLAB
	NOTES SPAN OF NEW 150mm DEEP BEAM & BLOCK FLOOR.
	NOTES SPAN OF EXISTING TIMBER CEILING JOISTS. ASSUMED 50x100 T.B.C.
	NOTES SPAN OF EXISTING TIMBER FLOOR JOISTS. ASSUMED 50x200 T.B.C.
	NOTES DOUBLE TRIMMER JOIST/RAFTERS SIZED AS PER SPAN

Rev.	Date	Amendment	Drawn	Chkd
P4	06.02.18	SERVICE TRENCH REVISED	P.E	C.M
P3	29.01.18	SECTION MARK 03 ADDED	P.E	C.M
P2	26.01.18	ISSUED FOR PLANNING	P.E	C.M
P1	13.12.17	ISSUED FOR PLANNING	P.E	C.M

Drawing Status: **PRELIMINARY**

# Form

Job Title  
**24 HEATH DRIVE  
LONDON  
NW3 7SB**

Drawing Title  
**PROPOSED GROUND FLOOR PLAN**

Form Structural Design Ltd 77 St John Street London EC1M 4NN  
T:020 7253 2893 E:studio@form-sd.com W:www.form-sd.com

Date	Scale	Drawn	Checked
DEC 17	As indicated	P.E	C.M
Job No. 162637	Drawing No. L(23)02	Revision P4	

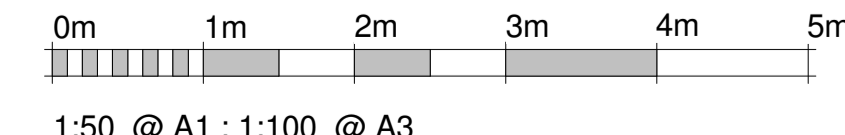

**PROPOSED GROUND FLOOR PLAN**