



- GENERAL NOTES:
1. ALL DIMENSIONS AND LEVELS SHALL BE CHECKED ON SITE PRIOR TO CONSTRUCTION WORK COMMENCING
 2. ALL LANDSCAPE DRAWINGS TO BE READ IN CONJUNCTION WITH ALL RELEVANT ENGINEERS AND ARCHITECTS DRAWINGS AND SPECIFICATIONS
 3. ALL DRAWINGS TO BE READ IN CONJUNCTION WITH THE LANDSCAPE SPECIFICATION
 4. ANY DISCREPANCY CONCERNING THE DRAWINGS SHOULD BE REFERRED TO THE CA IMMEDIATELY
 5. ALL DIMENSIONS IN MILLIMETRES UNLESS NOTED OTHERWISE
 6. ALL LEVELS IN METRES
 7. DO NOT SCALE OFF THIS DRAWING
 8. EXISTING SERVICE ALIGNMENTS SHALL BE CHECKED ON SITE BY THE CONTRACTOR PRIOR TO CONSTRUCTION WORK COMMENCING
 9. THE CONTENT OF THIS DRAWING IS TO BE READ IN CONJUNCTION WITH THE LATEST PROJECT CDM RISK REGISTER

- LEGEND:
- Red Line boundary
 - Existing trees to be retained without remedial works
 - Root Protection Zone (RPZ)
 - Existing trees to be removed.

NOTE:
1. DRAWING TO BE READ IN CONJUNCTION WITH THE ARBORICULTURAL IMPACT ASSESSMENT (AIA) BY HAYDENS ARBORICULTURAL CONSULTANTS.

Rev.	Date	Description	BP	CH
P01	10/12/2013	PLANNING		
			Drawn	Ch'd

grant associates
Landscape Architecture, Urban Design, Creative Ecology
22 Milk Street, Bath BA1 1UT
T: +44 (0) 1225 332664, F: +44 (0) 1225 420803
E: info@grant-associates.uk.com

CLIENT	LB CAMDEN
PROJECT	AGAR GROVE REGENERATION
TITLE	EXISTING TREE RETENTION & REMOVAL PLAN

Status:	Drawn:	Checked:
PLANNING	BP	CH
Scale:	Date:	Approved:
1:500 at A1	01/10/2013	TO
Drawing Number:		Rev:
377-AL-RT-0-001		P01



GENERAL NOTES:
1. ALL DIMENSIONS AND LEVELS SHALL BE CHECKED ON SITE PRIOR TO CONSTRUCTION WORK COMMENCING
2. ALL LANDSCAPE DRAWINGS TO BE READ IN CONJUNCTION WITH ALL RELEVANT ENGINEERS AND ARCHITECTS DRAWINGS AND SPECIFICATIONS
3. ALL DRAWINGS TO BE READ IN CONJUNCTION WITH THE LANDSCAPE SPECIFICATION
4. ANY DISCREPANCY CONCERNING THE DRAWINGS SHOULD BE REFERRED TO THE CA IMMEDIATELY
5. ALL DIMENSIONS IN MILLIMETRES UNLESS NOTED OTHERWISE
6. ALL LEVELS IN METRES
7. DO NOT SCALE OFF THIS DRAWING
8. EXISTING SERVICE ALIGNMENTS SHALL BE CHECKED ON SITE BY THE CONTRACTOR PRIOR TO CONSTRUCTION WORK COMMENCING
9. THE CONTENT OF THIS DRAWING IS TO BE READ IN CONJUNCTION WITH THE LATEST PROJECT CDM RISK REGISTER

- LEGEND:
- Red Line boundary
 - Urban Boulevard:
Street tree planting to strengthen existing TPO tree groups within linear beds of evergreen ground cover mix; *Tilia cordata* planted as semi-mature, rootballed trees.
 - Street Trees:
Street tree planting with oversized urban tree soil pits in hard paved areas, typically with evergreen shrub planting at each planting station; *Tilia cordata*, *Alnus cordata* planted as semi-mature, rootballed trees.
 - Rain Gardens:
Native species tree planting within the rain garden beds; *Salix alba*, *Alnus glutinosa* planted as semi-mature, rootballed trees.
 - Forager's Orchard:
Fruit tree planting within communal courtyards including appropriately sized specimen trees providing highlights with strong seasonal interest.
Orchard Trees:
Malus spp., *Prunus* spp., *Pyrus* spp., planted as standards, extra heavy standards and espaliers ensuring self-pollination or cross pollination of species.
Highlight Trees:
e.g. *Liquidambar styraciflua* planted as semi-mature, rootballed trees.
 - Garden Square:
Garden square frontages and public realm open space ornamental flowering trees; *Pyrus* spp., *Prunus* spp.
 - Garden Square & Gateway feature tree planting; *Platanus x hispanica*, *Quercus robur*.
 - Native Species Boundary Planting:
Native species woodland edge habitat boundary planting including small fruiting and flowering tree species; *Crataegus monogyna*, *Sorbus aucuparia*.
 - Espalier Tree Planting:
Pyrus spp., *Tilia* spp.
 - Existing tree to be retained

P01	12/12/2013	PLANNING	BP	CH
Rev.	Date	Description	Drawn	Ch'd

 **grant associates**
Landscape Architecture, Urban Design, Creative Ecology
22 Milk Street, Bath BA1 1UT
T: +44 (0) 1225 332654, F: +44 (0) 1225 420803
E: info@grant-associates.uk.com

CLIENT	LB CAMDEN
PROJECT	AGAR GROVE REGENERATION
TITLE	SOFT LANDSCAPE GENERAL ARRANGEMENT - TREE PLANTING

Status:	Drawn:	Checked:
PLANNING	BP	CH
Scale:	Date:	Approved:
1:500 at A1	08/10/2013	TO
Drawing Number:	Rev:	
377-AL-SW-0-001	P01	

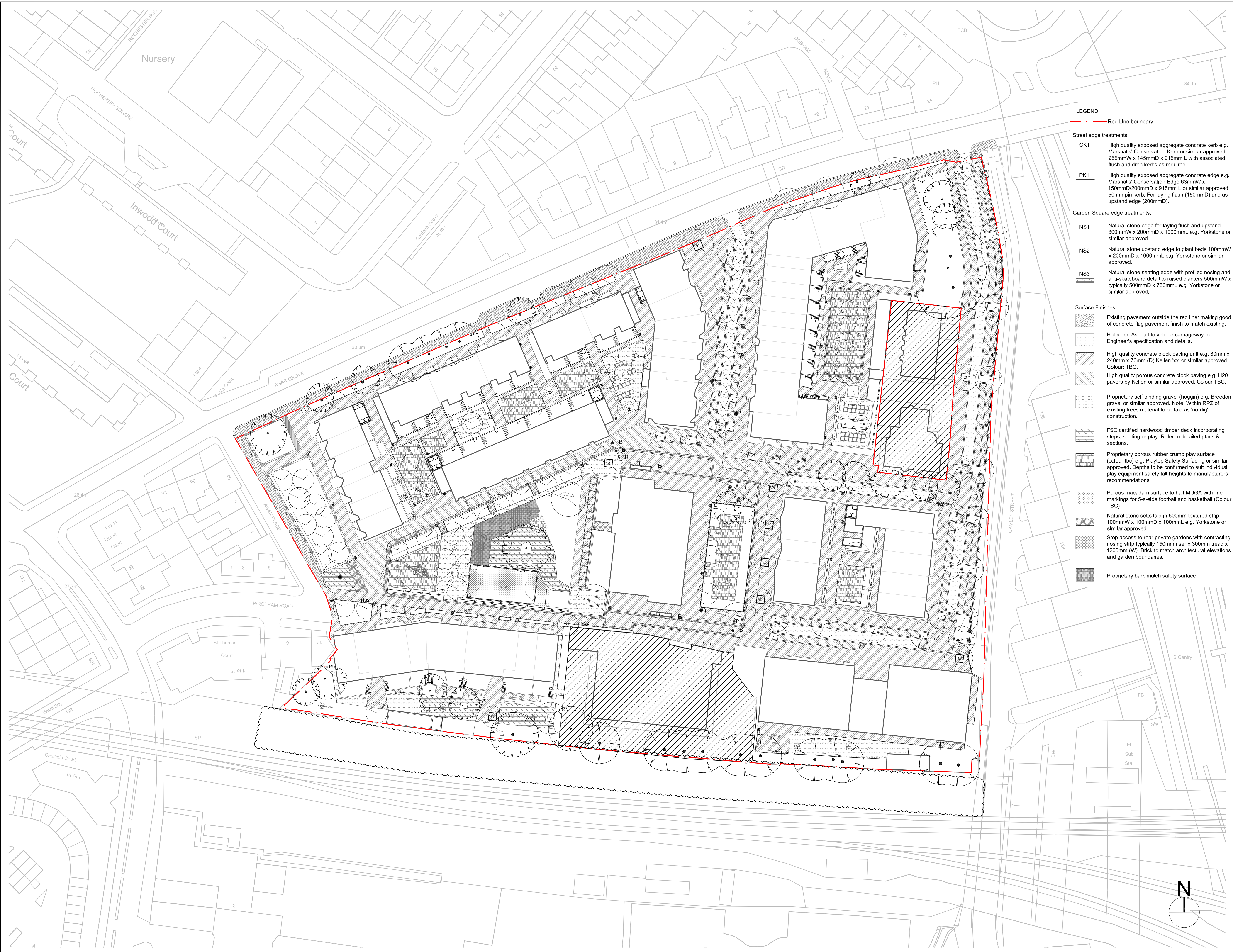

- GENERAL NOTES:
1. ALL DIMENSIONS AND LEVELS SHALL BE CHECKED ON SITE PRIOR TO CONSTRUCTION WORK COMMENCING
 2. ALL LANDSCAPE DRAWINGS TO BE READ IN CONJUNCTION WITH ALL RELEVANT ENGINEERS AND ARCHITECT'S DRAWINGS AND SPECIFICATIONS
 3. ALL DRAWINGS TO BE READ IN CONJUNCTION WITH THE LANDSCAPE SPECIFICATION
 4. ANY DISCREPANCY CONCERNING THE DRAWINGS SHOULD BE REFERRED TO THE CA IMMEDIATELY
 5. ALL DIMENSIONS IN MILLIMETRES UNLESS NOTED OTHERWISE
 6. ALL LEVELS IN METRES
 7. DO NOT SCALE OFF THIS DRAWING
 8. EXISTING SERVICE ALIGNMENTS SHALL BE CHECKED ON SITE BY THE CONTRACTOR PRIOR TO CONSTRUCTION WORK COMMENCING
 9. THE CONTENT OF THIS DRAWING IS TO BE READ IN CONJUNCTION WITH THE LATEST PROJECT CDM RISK REGISTER

LEGEND:

Red Line boundary

- Street edge treatments:
- CK1 High quality exposed aggregate concrete kerb e.g. Marshalls' Conservation Kerb or similar approved 255mmW x 145mmD x 915mm L with associated flush and drop kerbs as required.
- PK1 High quality exposed aggregate concrete edge e.g. Marshalls' Conservation Edge 63mmW x 150mmD/200mmD x 915mm L or similar approved. 50mm pin kerb. For laying flush (150mmD) and as upstand edge (200mmD).

- Garden Square edge treatments:
- NS1 Natural stone edge for laying flush and upstand 300mmW x 200mmD x 1000mmL e.g. Yorkstone or similar approved.
- NS2 Natural stone upstand edge to plant beds 100mmW x 200mmD x 1000mmL e.g. Yorkstone or similar approved.
- NS3 Natural stone seating edge with profiled nosing and anti-skateboard detail to raised planters 500mmW x typically 500mmD x 750mmL e.g. Yorkstone or similar approved.

- Surface Finishes:
- Existing pavement outside the red line: making good of concrete flag pavement finish to match existing.
- Hot rolled Asphalt to vehicle carriageway to Engineer's specification and details.
- High quality concrete block paving unit e.g. 80mm x 240mm x 70mm (D) Kellen 'xx' or similar approved. Colour: TBC.
- High quality porous concrete block paving e.g. H20 pavers by Kellen or similar approved. Colour TBC.
- Proprietary self binding gravel (hoggin) e.g. Breendon gravel or similar approved. Note: Within RPZ of existing trees material to be laid as 'no-dig' construction.
- FSC certified hardwood timber deck incorporating steps, seating or play. Refer to detailed plans & sections.
- Proprietary porous rubber crumb play surface (colour tbc) e.g. Playtop Safety Surfacing or similar approved. Depths to be confirmed to suit individual play equipment safety fall heights to manufacturers recommendations.
- Porous macadam surface to half MUGA with line markings for 5-a-side football and basketball (Colour TBC)
- Natural stone setts laid in 500mm textured strip 100mmW x 100mmD x 100mmL e.g. Yorkstone or similar approved.
- Step access to rear private gardens with contrasting nosing strip typically 150mm riser x 300mm tread x 1200mm (W). Brick to match architectural elevations and garden boundaries.
- Proprietary bark mulch safety surface

- Furniture/Landscape Structures:
- FSC Certified timber deck footbridge with associated handrails and balustrade panels.
- FSC treated hardwood timber seating edge to raised planters typically 500mmW x 500mmH.
- Proprietary stainless steel tree grille to trees in hard landscape e.g. Greenleaf Arborslot or similar approved.
- Fixed bollard.
- Collapsible bollard with electronic access control system.
- Timber bench seating.
- Stainless steel 'Sheffield' style cycle stands.
- FSC certified hardwood Rose Arbour structure within Lulworth Garden Square with tensioned stainless steel horizontal wire climbing plant supports.
- Metalwork trellis to support trailing and climbing plants.
- Metalwork espalier frames with horizontal SS wires to support espalier trees and climbers.
- 'Grow Your Own' FSC certified treated softwood planter boxes typically 1.0m x 1.0m x 0.9m high within communal courtyards.
- Raised planter structures within communal courtyards typically 500mm H. Brick finish to match Architectural elevations.
- Raised planter privacy strip structures to Plot frontages typically 300mm H. Brick finish to match Architectural elevations.
- Proprietary play equipment with associated safety surface zone. Refer to Play Strategy.
- Lighting column to Engineer's details
- Lighting bollard to Engineer's details
- Feature lighting e.g. uplighter to Engineer's details

- Boundary treatments:
- 1.2m high metalwork railings with 2 no. single leaf access gates to play area.
- 3.0m high weldmesh ballstop fence with 2 no. lockable double gate access to half MUGA. To include kick board.
- Camley Street boundary: 2.4m high metalwork vertical bar railings between brickwork pliers with double leaf access gates to Camley Street cycle route.

- NOTE:
1. ALL PAVEMENT MAKEUPS TO ENGINEER'S (PETER BRETT ASSOCIATES) DETAILS.
 2. ALL WALL / STRUCTURAL FOOTINGS SHOWN INDICATIVELY. TO ENGINEER'S (PETER BRETT ASSOCIATES) DETAILS.
 3. ALL TREE PITS SHOWN INDICATIVELY. EACH TREE PIT TO INCORPORATE GROWING MEDIUM (REFER TO DRAWING 377-AL-TZ-0-011) PLUS DRAINAGE LAYER, TREE PIT DRAINAGE AND ROOT BARRIERS WHERE APPROPRIATE IN PROXIMITY TO SERVICES AND STRUCTURES.
 4. FOR LOCATION OF SECTION LINES REFER TO KEY PLAN 377-AL-KP-0-002

P01	12/12/2013	PLANNING	BP	CH
Rev.	Date	Description	Drawn	Ch'd

grant associates
Landscape Architecture, Urban Design, Creative Ecology
22 Milk Street, Bath BA1 1UT
T: +44 (0) 1225 332664, F: +44 (0) 1225 420803
E: info@grant-associates.uk.com

CLIENT	LB CAMDEN
PROJECT	AGAR GROVE REGENERATION
TITLE	HARD LANDSCAPE GENERAL ARRANGEMENT

Status:	Drawn:	Checked:
PLANNING	BP	CH
Scale:	Date:	Approved:
1:500 at A1	02/10/2013	TO
Drawing Number:	Rev:	
377-AL-HD-0-001	P01	

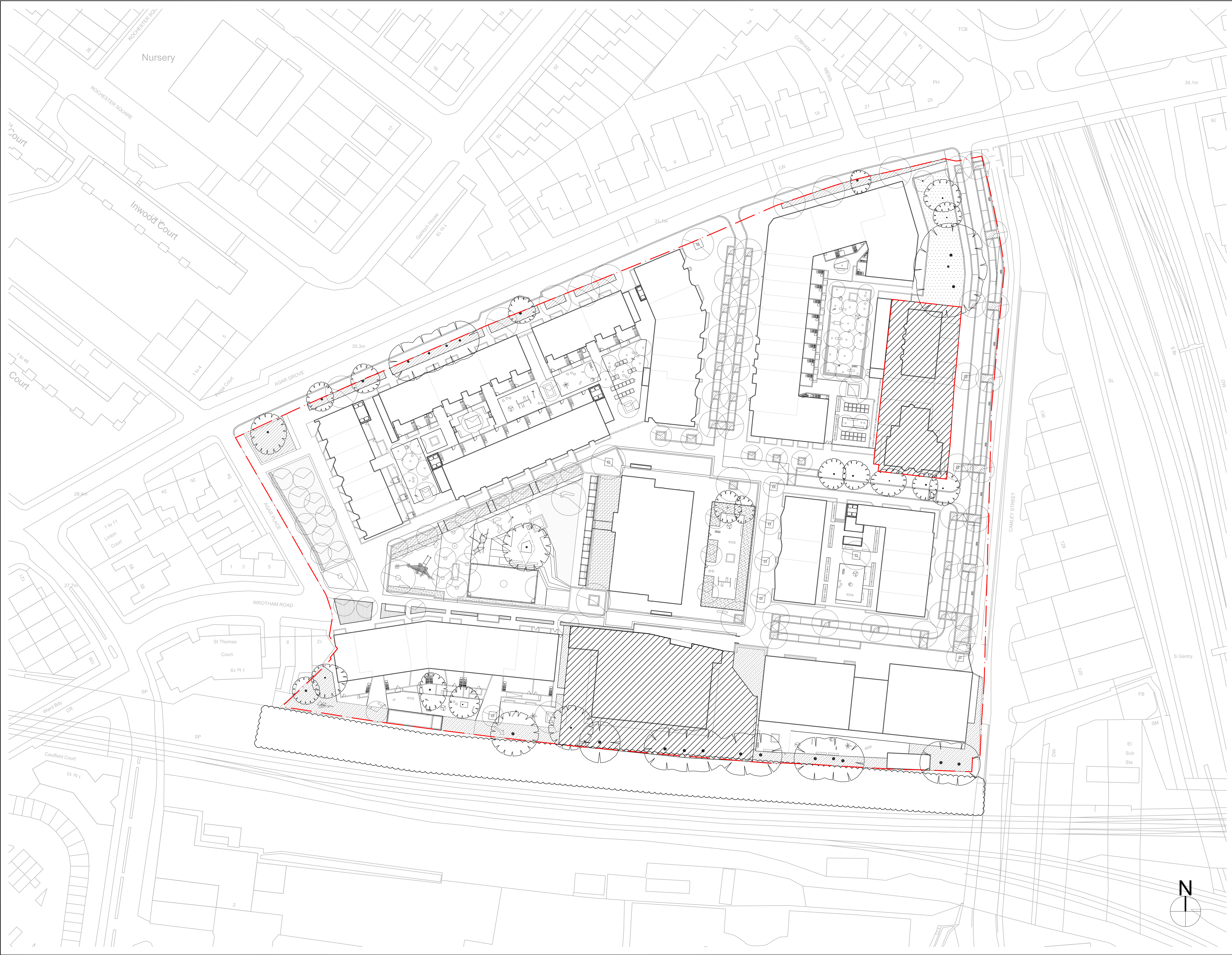

- GENERAL NOTES:
1. ALL DIMENSIONS AND LEVELS SHALL BE CHECKED ON SITE PRIOR TO CONSTRUCTION WORK COMMENCING
 2. ALL LANDSCAPE DRAWINGS TO BE READ IN CONJUNCTION WITH ALL RELEVANT ENGINEERS AND ARCHITECTS DRAWINGS AND SPECIFICATIONS
 3. ALL DRAWINGS TO BE READ IN CONJUNCTION WITH THE LANDSCAPE SPECIFICATION
 4. ANY DISCREPANCY CONCERNING THE DRAWINGS SHOULD BE REFERRED TO THE CA IMMEDIATELY
 5. ALL DIMENSIONS IN MILLIMETRES UNLESS NOTED OTHERWISE
 6. ALL LEVELS IN METRES
 7. DO NOT SCALE OFF THIS DRAWING
 8. EXISTING SERVICE ALIGNMENTS SHALL BE CHECKED ON SITE BY THE CONTRACTOR PRIOR TO CONSTRUCTION WORK COMMENCING
 9. THE CONTENT OF THIS DRAWING IS TO BE READ IN CONJUNCTION WITH THE LATEST PROJECT CDM RISK REGISTER

LEGEND:

Red Line boundary

Public Realm Planting:

- Ground cover shrub planting to Agar Grove. Ferns and sedge species groups to be included within the raised planter beneath existing tree Ref. T043. Note: Hand dug pit planting within the RPZ of existing trees.
- Native species woodland edge boundary planting
- Streets: Understorey evergreen shrub planting to street trees
- Climbing plant beds to Camley Street Boundary
- Lulworth Gardens East play area. Hedgerow perimeter with ornamental grass and herbaceous mix.
- Green Street amenity shrub mix
- Rain Gardens planting
- Hedgerow planting (height approx. 0.9m high).
- Lulworth Gardens West perimeter planting of ornamental grass and herbaceous mix with climbing plants to metalwork trellis.
- Species rich amenity turf
- Species rich amenity grass seed with bulb planting. Note plant beds within existing tree RPZ.

Planting Strategy to be read in conjunction with the Public Realm and Boundary Planting Plant Schedules AGC377-SCH-001

P01	12/12/2013	PLANNING	BP	CH
Rev.	Date	Description	Drawn	Ch'd

 **grant associates**
Landscape Architecture, Urban Design, Creative Ecology
22 Milk Street, Bath BA1 1UT
T: +44 (0) 1225 332664, F: +44 (0) 1225 420803
E: info@grant-associates.uk.com

CLIENT	LB CAMDEN
PROJECT	AGAR GROVE REGENERATION
TITLE	SOFT LANDSCAPE GENERAL ARRANGEMENT - PUBLIC REALM

Status:	Drawn:	Checked:
PLANNING	BP	CH
Scale:	Date:	Approved:
1:500 at A1	18/11/2013	TO
Drawing Number:	377-AL-SW-O-002	Rev: P01

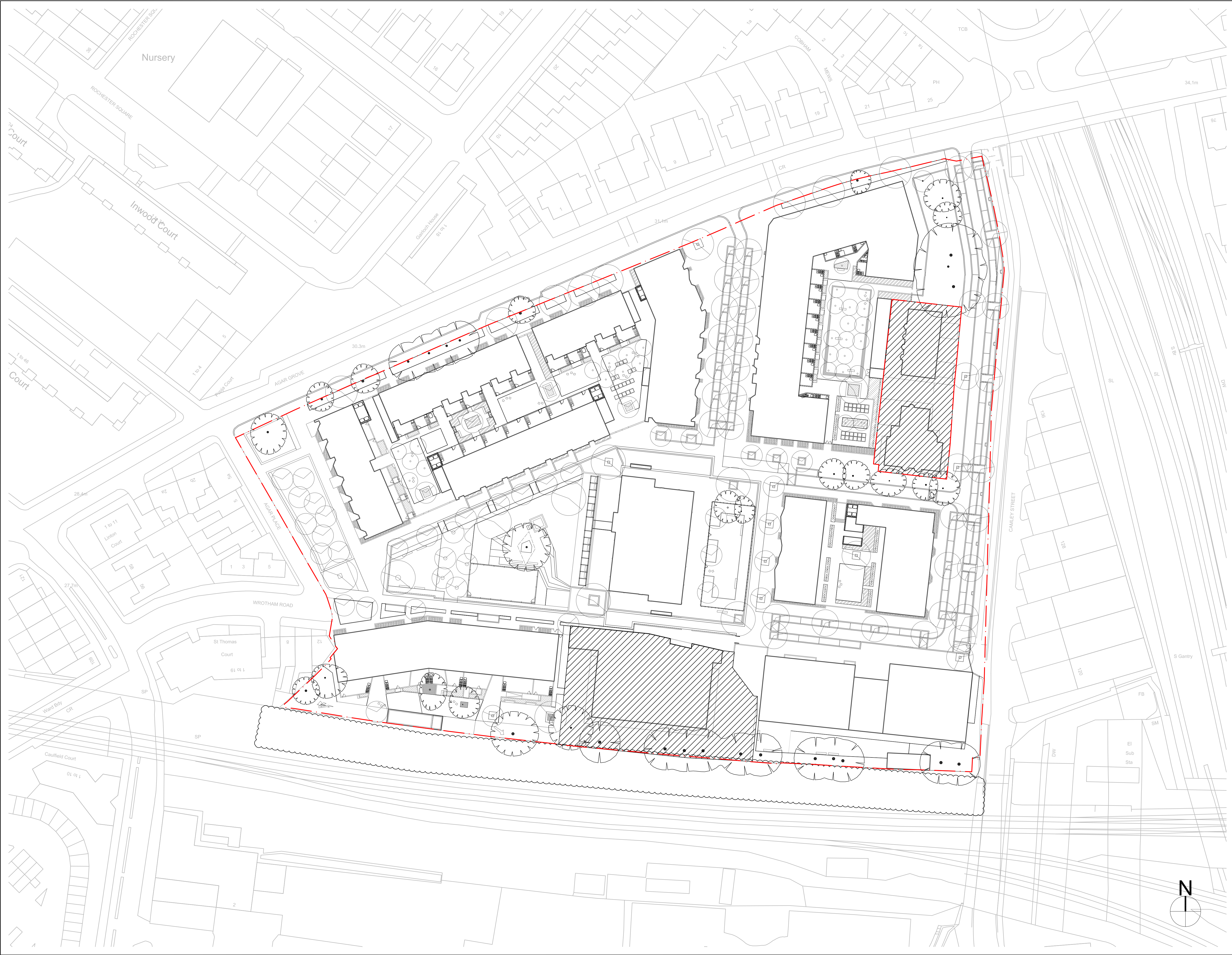

- GENERAL NOTES:
1. ALL DIMENSIONS AND LEVELS SHALL BE CHECKED ON SITE PRIOR TO CONSTRUCTION WORK COMMENCING
 2. ALL LANDSCAPE DRAWINGS TO BE READ IN CONJUNCTION WITH ALL RELEVANT ENGINEERS AND ARCHITECT'S DRAWINGS AND SPECIFICATIONS
 3. ALL DRAWINGS TO BE READ IN CONJUNCTION WITH THE LANDSCAPE SPECIFICATION
 4. ANY DISCREPANCY CONCERNING THE DRAWINGS SHOULD BE REFERRED TO THE CA IMMEDIATELY
 5. ALL DIMENSIONS IN MILLIMETRES UNLESS NOTED OTHERWISE
 6. ALL LEVELS IN METRES
 7. DO NOT SCALE OFF THIS DRAWING
 8. EXISTING SERVICE ALIGNMENTS SHALL BE CHECKED ON SITE BY THE CONTRACTOR PRIOR TO CONSTRUCTION WORK COMMENCING
 9. THE CONTENT OF THIS DRAWING IS TO BE READ IN CONJUNCTION WITH THE LATEST PROJECT CDM RISK REGISTER

LEGEND:

Red Line boundary

Communal Courtyards Planting Strategy:

- Raised planter beds with semi-ornamental grasses and herbaceous mix.
- Shade tolerant groundcover & fern mix below existing trees
- Semi-ornamental grasses and herbaceous mix providing including climbing plants to boundaries and building elevations.

Ground cover, herbaceous and bulb planting mix associated with fruiting espalier tree beds.

Raised planter privacy strips to residential frontages:

- Evergreen shrubs and climbing plants
- Rain Gardens to Plot F

Planting Strategy to be read in conjunction with the Communal Courtyards & Privacy Strips Plant Schedules AGC377-SCH-002

P01	12/12/2013	PLANNING	BP	CH
Rev.	Date	Description	Drawn	Ch'd

grant associates
Landscape Architecture, Urban Design, Creative Ecology
22 Milk Street, Bath BA1 1UT
T: +44 (0) 1225 332654, F: +44 (0) 1225 420803
E: info@grant-associates.uk.com

CLIENT	LB CAMDEN
PROJECT	AGAR GROVE REGENERATION
TITLE	SOFT LANDSCAPE GENERAL ARRANGEMENT - COMMUNAL & PRIVATE

Status:	Drawn:	Checked:
PLANNING	BP	CH
Scale:	Date:	Approved:
1:500 at A1	18/11/2013	TO
Drawing Number:	377-AL-SW-O-003	Rev:
		P01