

SUPPLY AND INSTALL TO EXISTING POSTS IN SAME POSITION
:MODERN DIMMABLE WALL SPOT LIGHTS OR SIMILAR. (16no.)
ALLOW FOR ALL NECESSARY ADJUSTMENTS TO EXISTING
ELECTRICAL CONNECTIONS - Ref : 6311 - See Appendix C

SUPPLY AND INSTALL NEW CEILING HUNG: LED LINEAR LIGHT
WITH FROSTED DEFUSER. (8no.)
ALLOW FOR ALL NECESSARY ADJUSTMENTS TO EXISTING
ELECTRICAL CONNECTIONS
Ref : 41411 - See Appendix C

NOTES
DO NOT SCALE. ALL DIMENSIONS TO BE CHECKED ON
SITE. ERRORS AND OMISSIONS TO BE REPORTED TO THE
EMPLOYERS AGENT.
To be read in conjunction with:
- Preliminaries
- Building and Accommodation Requirements
- Services Requirements
- Architectural Drawings: DS/LIR/01/200, DS/LIR/02/201,
DS/LIR/03/202
- Furniture Drawings: Reception Desk, Refer to Appendix A
- Electrical Drawings: All Electrical Drawings, Refer to Appendix B

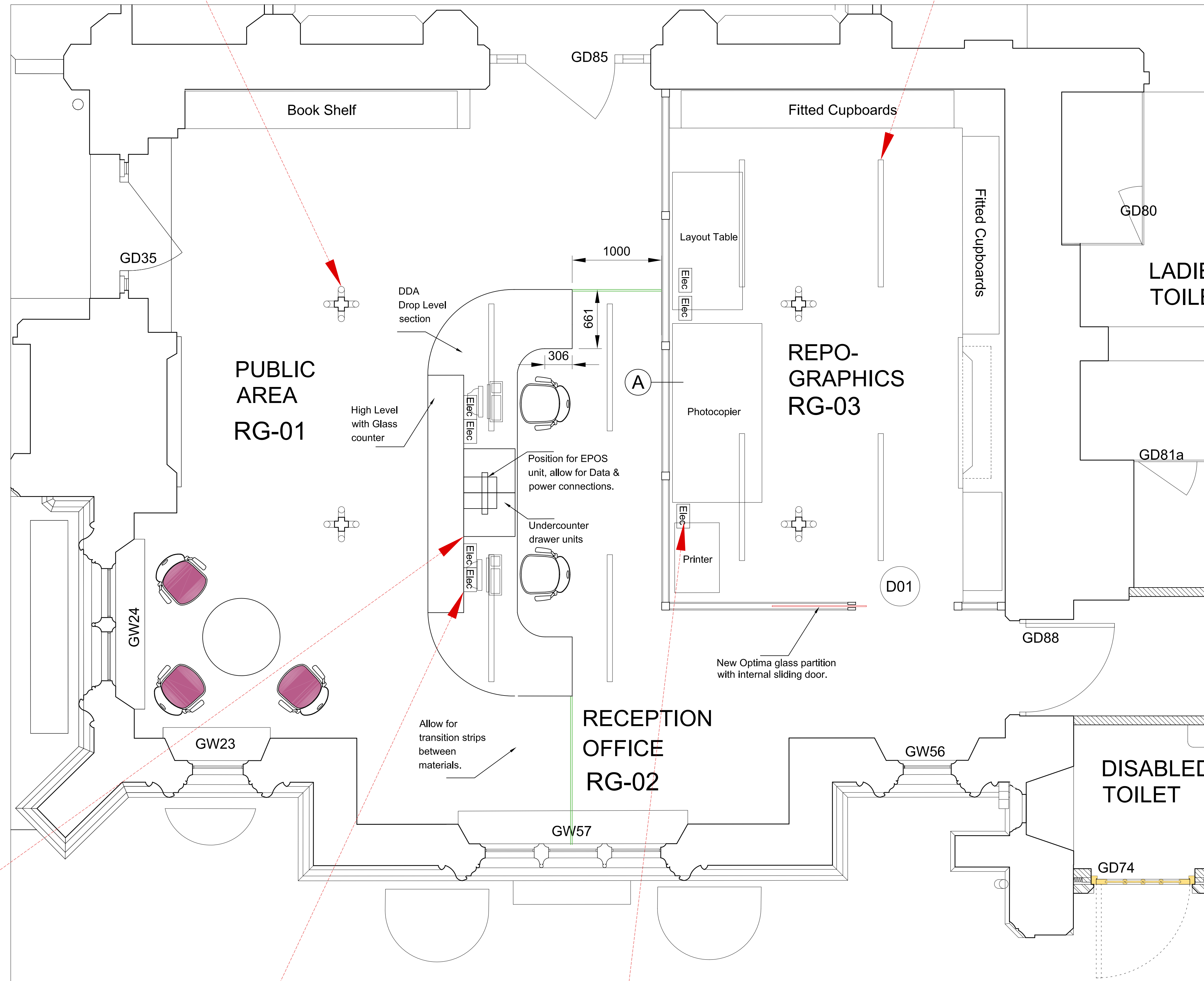

SUPPLY AND INSTALL
UNDER DESK PANIC
BUTTON LINKED TO
GATEHOUSE

SUPPLY AND INSTALL NEW LOW LEVEL
DOUBLE SOCKETS AND CABLE TRUNKING
FOR POWER, DATA & PHONE - AS SHOWN
FITTED BENEATH NEW RECEPTION DESK.
ALLOW FOR ALL ASSOCIATED ELECTRICAL
WORKS.

MODIFY EXISTING FLOOR TRUNKING
TO NEW POSITIONS.
SUPPLY AND INSTALL NEW FLOOR FITTED
DOUBLE SOCKETS AS SHOWN.
ALLOW FOR ALL ASSOCIATED ELECTRICAL
WORKS.