

DO NOT SCALE FROM THIS DRAWING
 DRAWING TO BE READ IN CONJUNCTION WITH ALL OTHER ARCHITECTS AND ENGINEER'S CONTRACT DRAWING & SPECIFICATIONS. ANY DISCREPANCIES MUST BE BROUGHT TO THE ATTENTION OF THE ARCHITECT IMMEDIATELY.
 THE CONTRACTOR MUST VERIFY ALL DIMENSIONS BY SITE MEASUREMENT BEFORE ORDERING MATERIALS OR MANUFACTURING COMPONENTS. SUBSTITUTE MATERIALS & PRODUCTS TO THOSE NAMED WILL BE ACCEPTABLE IF PROVEN TO BE OF EQUAL OR HIGHER PERFORMANCE AND NOT IN CONFLICT WITH OTHER ELEMENTS.

NOTES:
 KEY:
 - Area included in this application
 - Consented Demolition associated with Application ref: 2016/0840P & 2016/7148L
 - Proposed

Note:
 For windows and doors please refer to schedules.

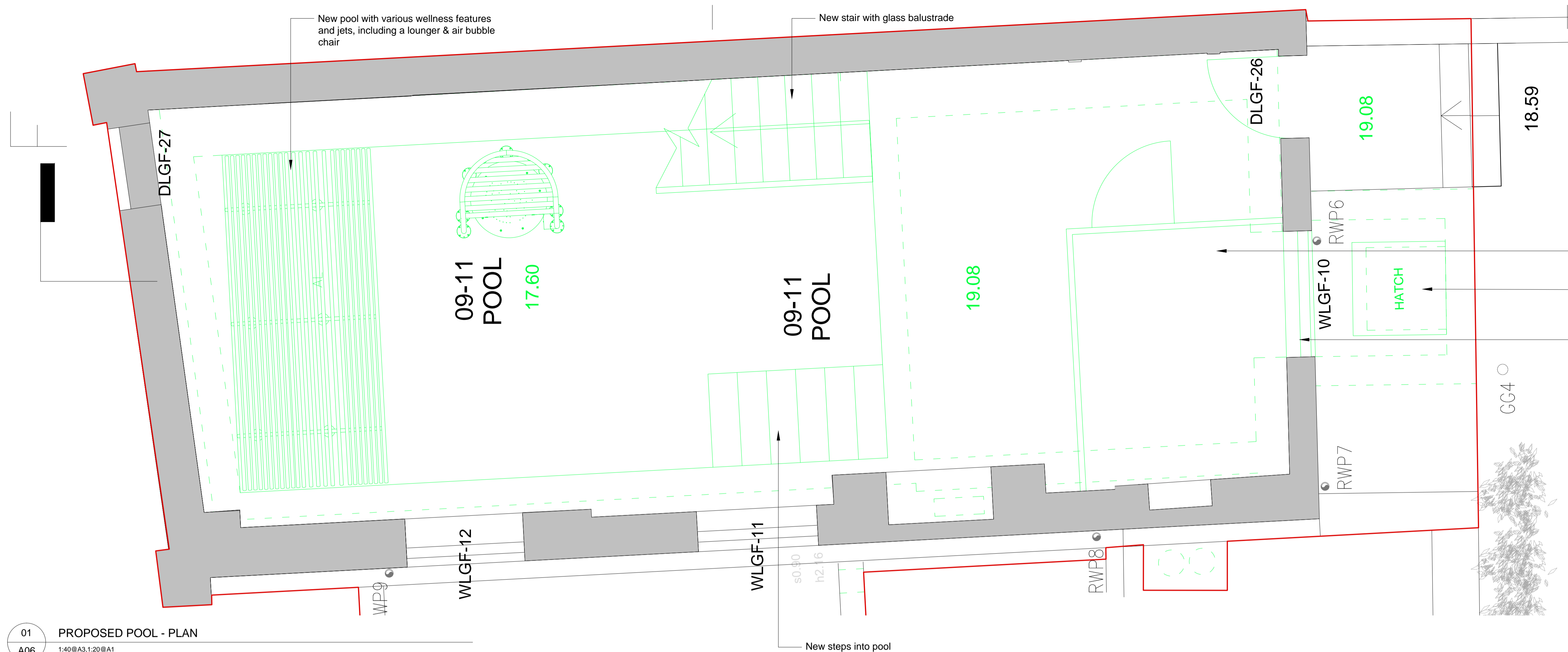

New stream room with glass partitions
 New access hatch to plant room with stone finish
 New enlarged sash window to match existing in main house

01 PROPOSED POOL - PLAN
 A06 1:40@A3, 1:20@A1

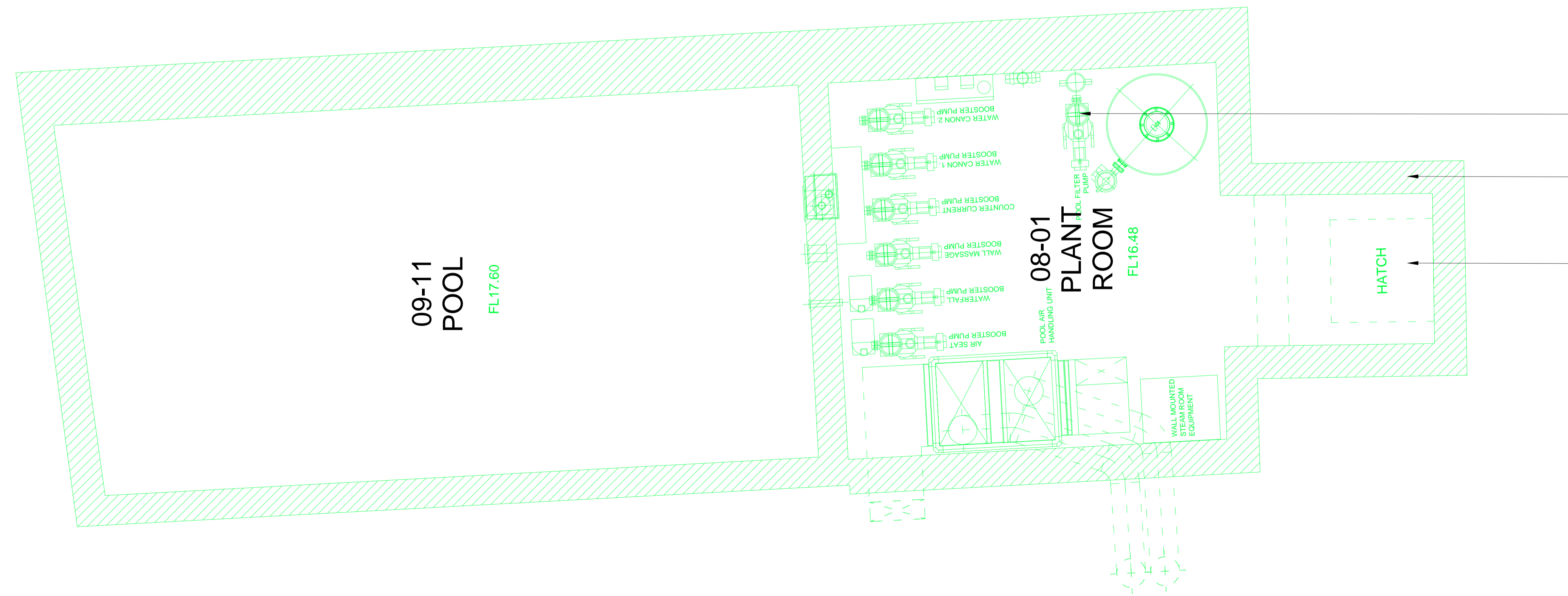

Plant room with pumps, air handling unit, steam room equipment and filter for pool
 New wall build-up to SE specification
 New access hatch to plant room with stone finish above

REV	DATE	DESCRIPTION
A	20.12.17	Underpinning revised

FOR PLANNING

JOB TITLE
Keats Grove
 Hampstead
 DRAWING TITLE
 Pool plans
 as proposed

JOB No	DWG No	REV
546	A06	A
DRAWN BY	SCALE (AT A1)	DATE
RFB	1:20	Oct17

02 PROPOSED PLANT ROOM - PLAN
 A06 1:40@A3, 1:20@A1