

**PLEASE NOTE:**

1. ALL DIMENSIONS TO BE CHECKED ON SITE BEFORE FABRICATION.
2. CONTRACTOR TO REFER TO ENGINEERS DRAWINGS BEFORE PROCEEDING WITH WORKS.
3. ALL DRAWINGS AND DESIGNS ARE COVERED BY DESIGN RIGHT (INTELLECTUAL PROPERTY), AND MAY NOT BE DISTRIBUTED, COPIED OR ISSUED WITHOUT WRITTEN PERMISSION BY XUL ARCHITECTURE.
4. ALL DESIGN CONCEPTS ARE THE SOLE PROPERTY OF XUL ARCHITECTURE AND NO ADAPTATIONS, REPRODUCTIONS OR COPIES MAY BE MADE WITHOUT WRITTEN PERMISSION OF XUL ARCHITECTURE.
5. THESE DRAWINGS ARE SUBJECT TO ANY VARIATION AUTHORITY OR RECOMMENDATION BY ANY STATUTORY AUTHORITY OR FOR THE BETTER CARRYING OUT OF THE WORKS.
6. SAMPLES TO BE PROVIDED BY CONTRACTOR FOR APPROVAL BY XUL ARCHITECTURE.
7. ALL FINISHES TO XUL ARCHITECTURE'S SATISFACTION.
8. ALL FABRICATION DRAWINGS TO BE APPROVED BY XUL ARCHITECTURE PRIOR TO CONSTRUCTION.

**ADDITIONAL NOTES:**

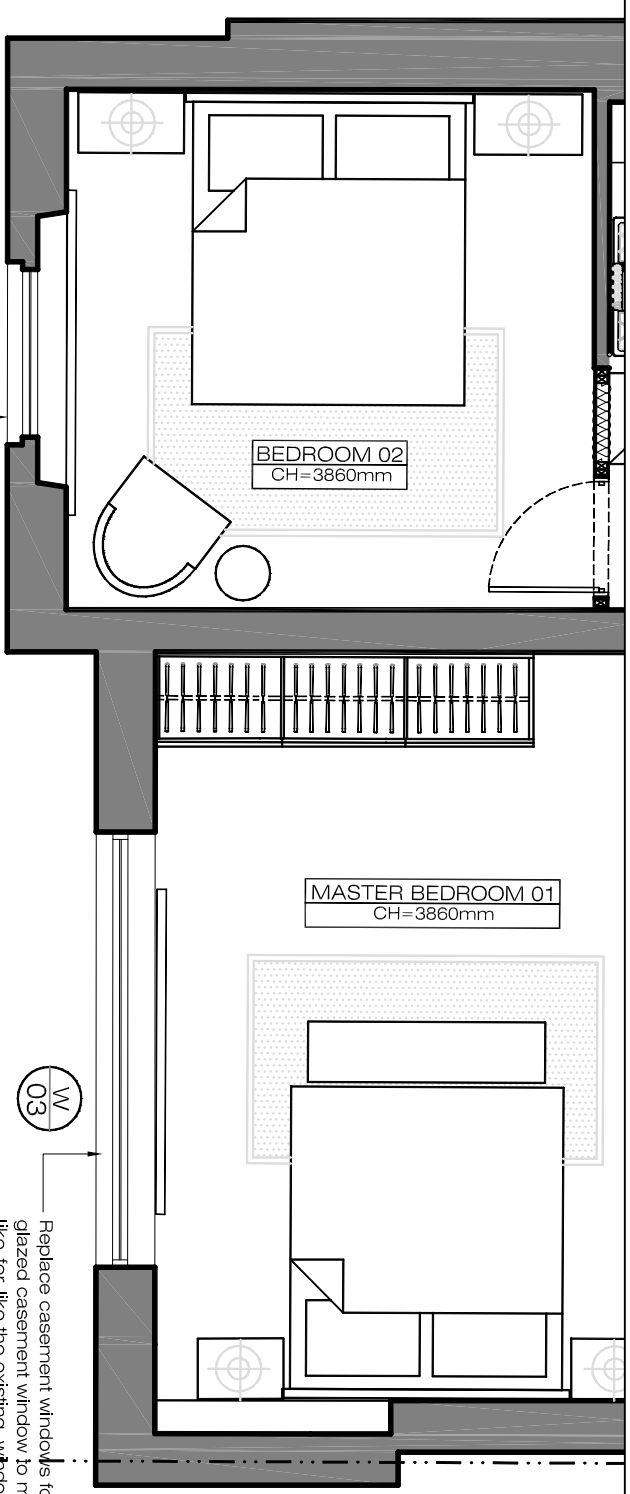

**PROPOSED**  
 Rear Elevation  
 SCALE 1:50@A3  
 PA-07

Replace casement windows for a double glazed casement window to match like-for-like the existing window (Conservation area style)

Replace casement windows for a double glazed casement window to match like-for-like the existing window (Conservation area style)

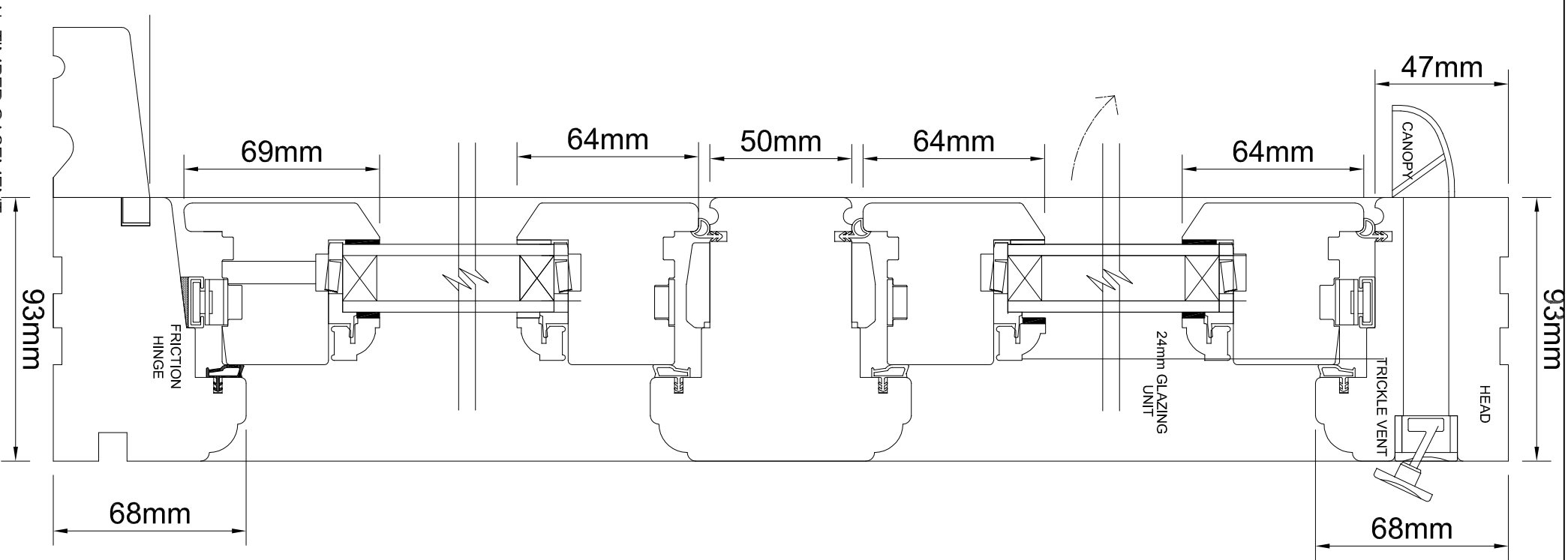

**TYPICAL TIMBER CASEMENT WINDOW DETAIL SECTION**  
 SCALE 1:2@A3  
 PA-07

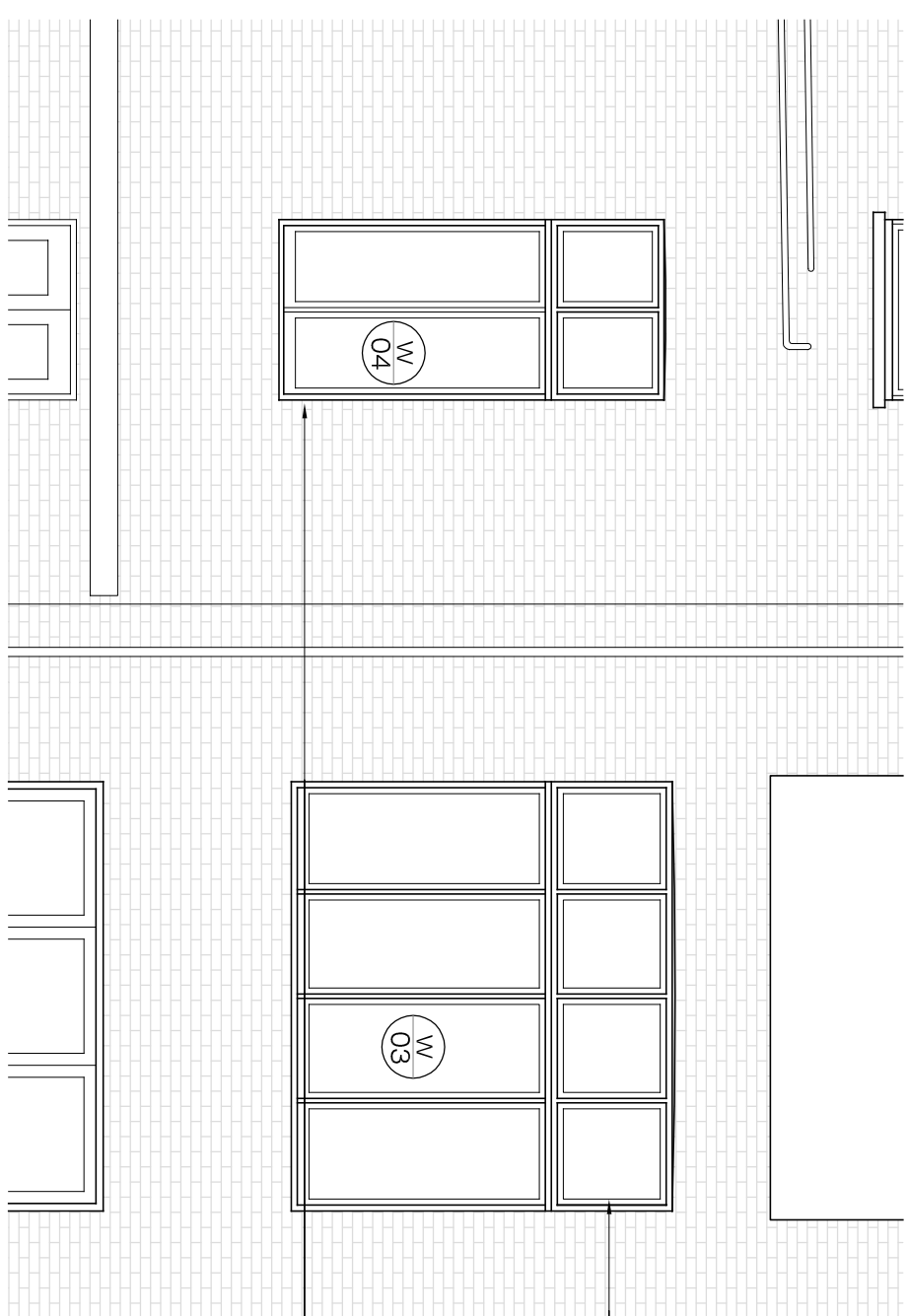

**PROPOSED**  
 Rear Elevation  
 SCALE 1:50@A3  
 PA-07

Replace casement windows for a double glazed door set to match like-for-like the existing door set (Conservation area style)

Replace casement windows for a double glazed door set to match like-for-like the existing door set (Conservation area style)

All existing windows are casement single glazed windows. They are all being replaced for casement double glazed windows to match the design of the existing windows (Conservation area style).

REVISIONS		
No	Date	Description
00	14/02/18	PLANNING

Client <b>PRIVATE CLIENT</b>	
Project Ground Floor Flat B, 34 Beisize Park NW3	
Title <b>PROPOSED</b> Typical Details for windows	

Scale	1:2@A3	Dwg. No.	PA-07	Rev.	00
Date	14/02/18	Drawn	ESM	Checked	YR
		Project Number	16_054		