

This drawing is provided to customers free of charge and the details shown are subject to the accuracy of the information provided to British Gypsum at the time the drawing was originally requested. No duty of care is owed to the recipient or any other third party and British Gypsum cannot accept liability in respect of the details shown. The drawing should therefore be approved by the project design and management authority before use to ensure that it meets with their specific project requirements. It should also be read in conjunction with British Gypsum's current literature available at www.british-gypsum.com. Taping and finishing in accordance with British Gypsum's current recommendations is assumed (with the exception of FireCase system)

CasoLine MF

Avoid tightening rubber gromitt on acoustic hangers beyond compression of chamfers. Over tightening may reduce acoustic performance

Gypframe GAH1 Acoustic Hanger fixed through lath & plaster ceiling to timber joist with suitable washer head type fixings by others & fixed to hangers with MF11 Nut & Bolt

Gypframe MF8 Strap or GA1 Angle hangers at 1200mm centres fixed to MF7 with 2 no. Gyproc Wafer Head Jack-Point Screws

Indicative timber joists

Existing lath & plaster ceiling under drawn with chicken wire suitably fixed through to joists

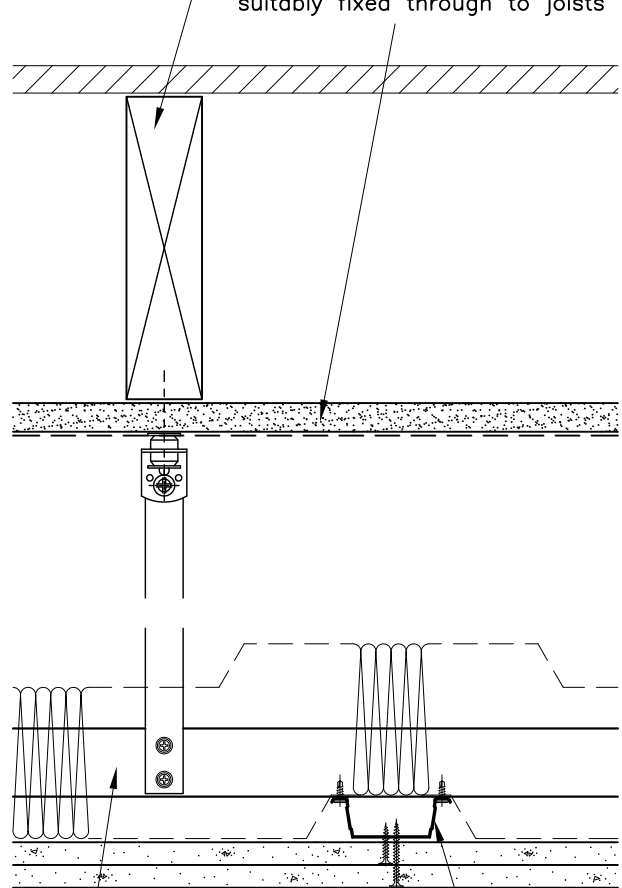
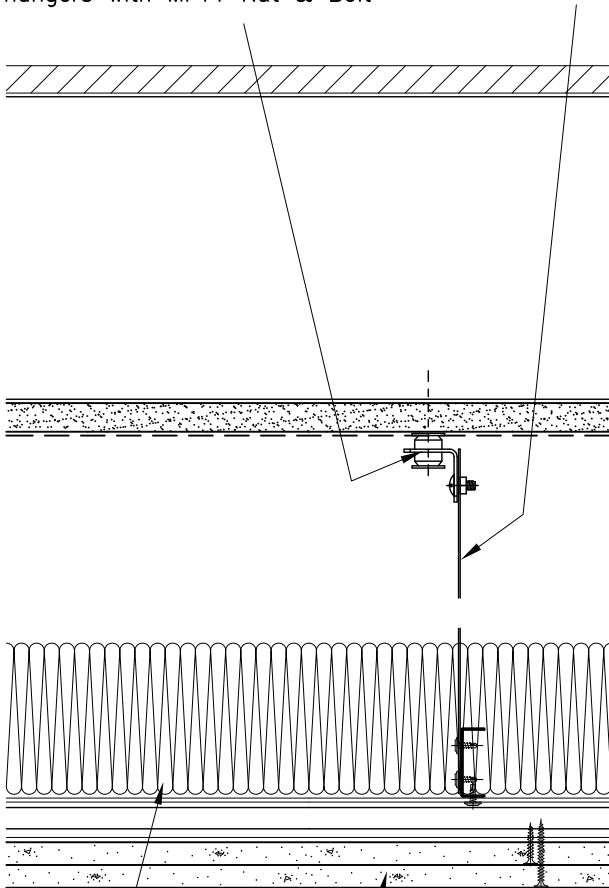

100mm Isover APR 1200

2 layers 15mm Gyproc SoundBloc fixed with 25 and 42mm Gyproc Drywall Screws at 230mm centres in field of board & 150mm centres at board ends

Gypframe MF7 Primary Support Channel at 1200mm centres

Gypframe MF5 Ceiling Sections at 450mm centres fixed to MF7 with 2 no. Gyproc Wafer Head Jack-Point Screws

Ceiling Sections

Title:

CONCEPT DETAIL ONLY



Drywall Academy
 Technical Advice Centre
 Tel: 0844 800 1991
 Fax: 0844 561 8816
 E-mail: bgtechnical.enquiries@bpb.com

Scale:

1:2

Date:

Feb 08

Drawn:

Dwg No.:

08/7780/01