

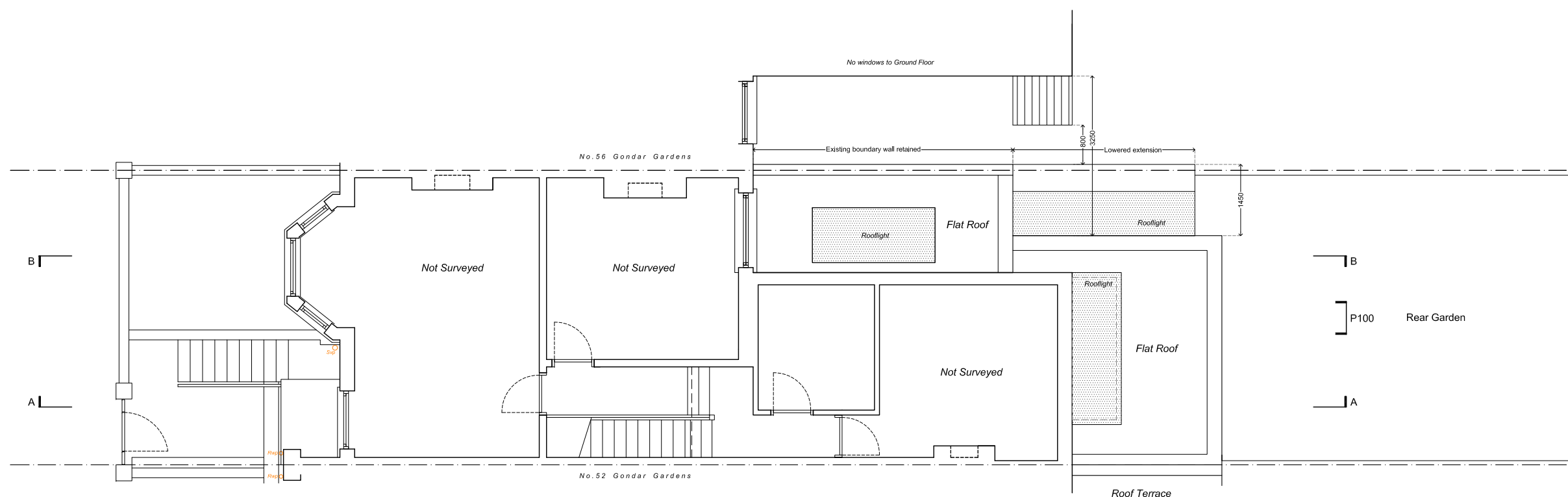

Notes
 Do not scale from this drawing. Any discrepancies are to be reported to the architect immediately. All dimensions will be taken on site prior to ordering and construction.
 Copyright remains with the architect. This drawing is to be read in conjunction with the notes specification and all other relevant information. No disclosure or copies may be made without prior written permission.

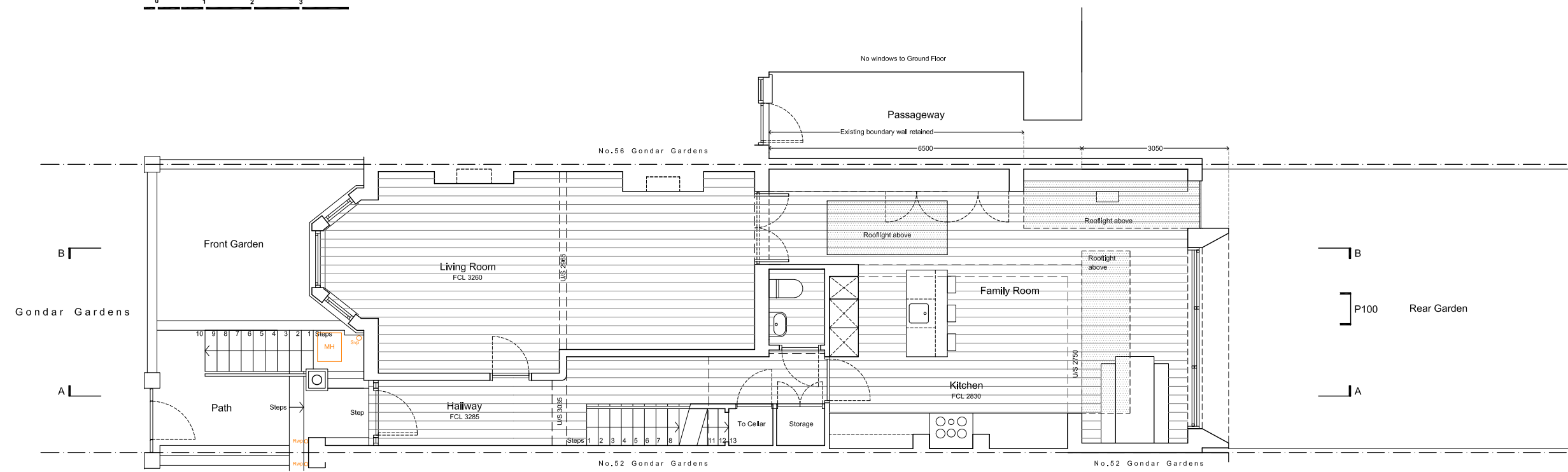

Proposed First Floor Plan

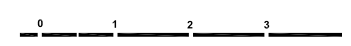

Proposed Ground Floor Plan

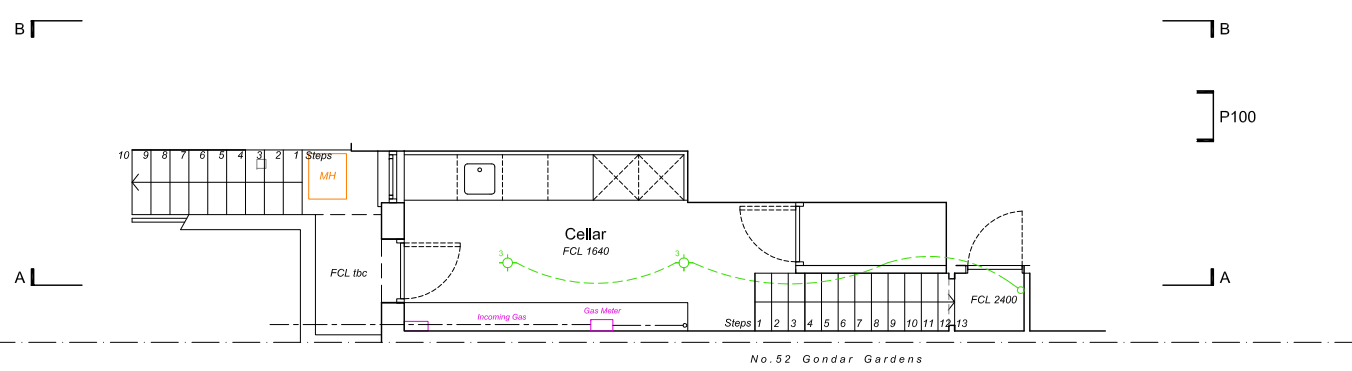

Proposed Cellar Plan

**DE
DRAFT**

Architecture | Interiors
 Studio 5. The Hothouse,
 274 Richmond Road,
 London E8 3QW
 0207 254 7214
 dedraft.co.uk
 @dedraftlondon

Planning Issue

Project 177
54 Gondar Gardens, NW6
 Scott Doran & Ellen Temperton

Drawing No. A001
Proposed Floor Plans
 Scale 1:100 at A3 + 1:50 at A1

Drawn 26.01.18
 Stephanie Choi

- Revisions**
- A 13.11.17 Planning submission
 - B 26.01.18 Planning amendments
 - C 02.02.18 Planning amendments
 - D 09.02.18 Rooflight reduced in length