

- NOTES:
1. This drawing is copyright of Scancon Architects Ltd.
 2. Use figured dimensions only.
 3. Contractors to notify architect immediately of any dimensional discrepancy.

Revisions:

A - JANUARY 2018
Issued to Local Authority as part of an application for Full Planning Permission and Conservation Area Consent.

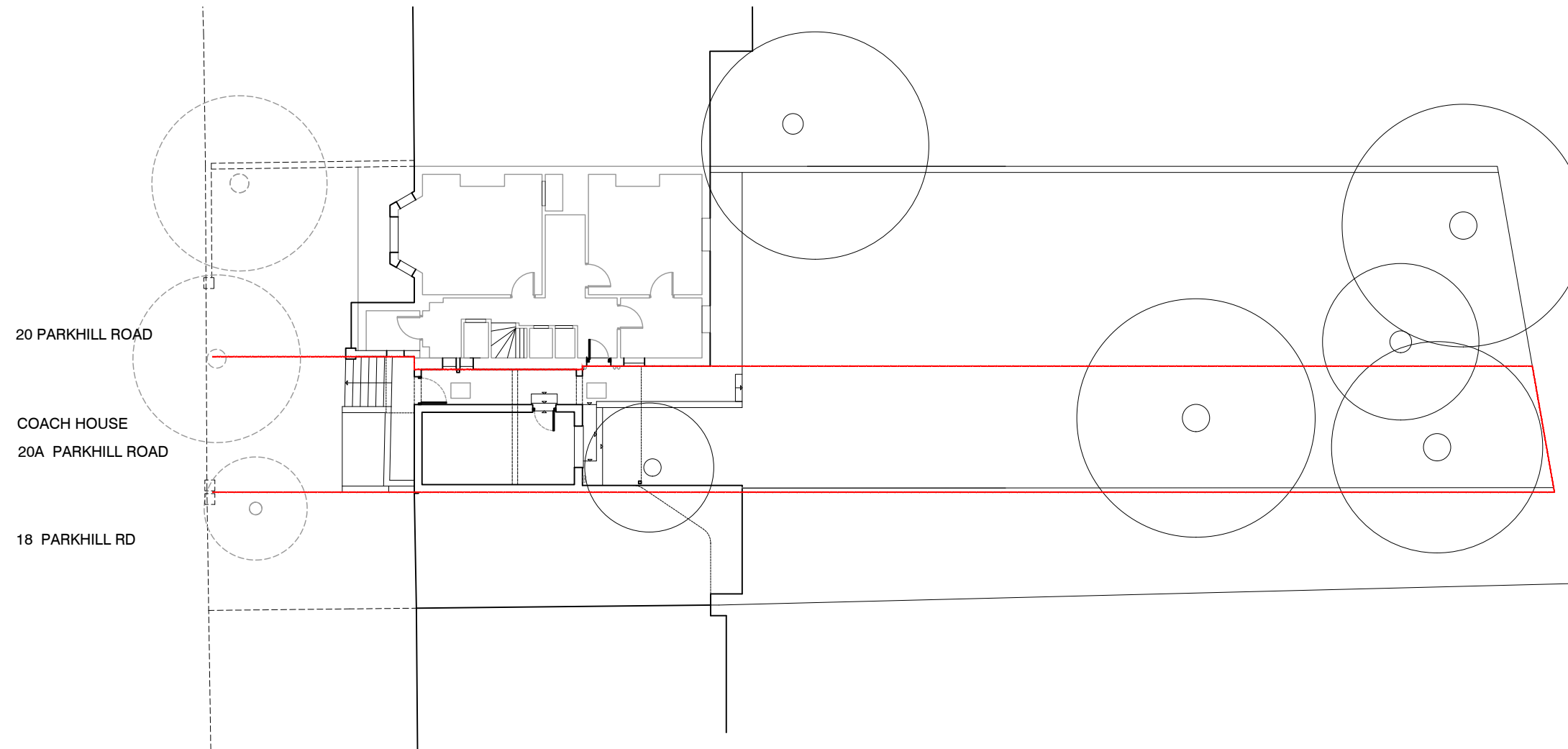

SITE PLAN



drawing status:	PLANNING		
job title:	20A PARKHILL ROAD		
	London NW3 2YN		
client:	Hyjan Investments Holdings Ltd		
diag. title:	SITE PLAN		
	Existing Layout		
drawn:	audited:	date:	scale:
mk	lbgd	10/2017	1:100@A1 1:200@A3
job No:	diag. No:	rev:	
0252	PL 00	A	