



PROPOSED FRONT ELEVATION
5 ELM TERRACE and 1 & 3 Constantine Road



Approved shop front visual indicating proposed alterations

The proposal includes:

1. The addition of a ramp to provide level access to the Dental Practice
2. Retaining the existing recessed entrance to the upper floors
3. Retaining the existing low wall

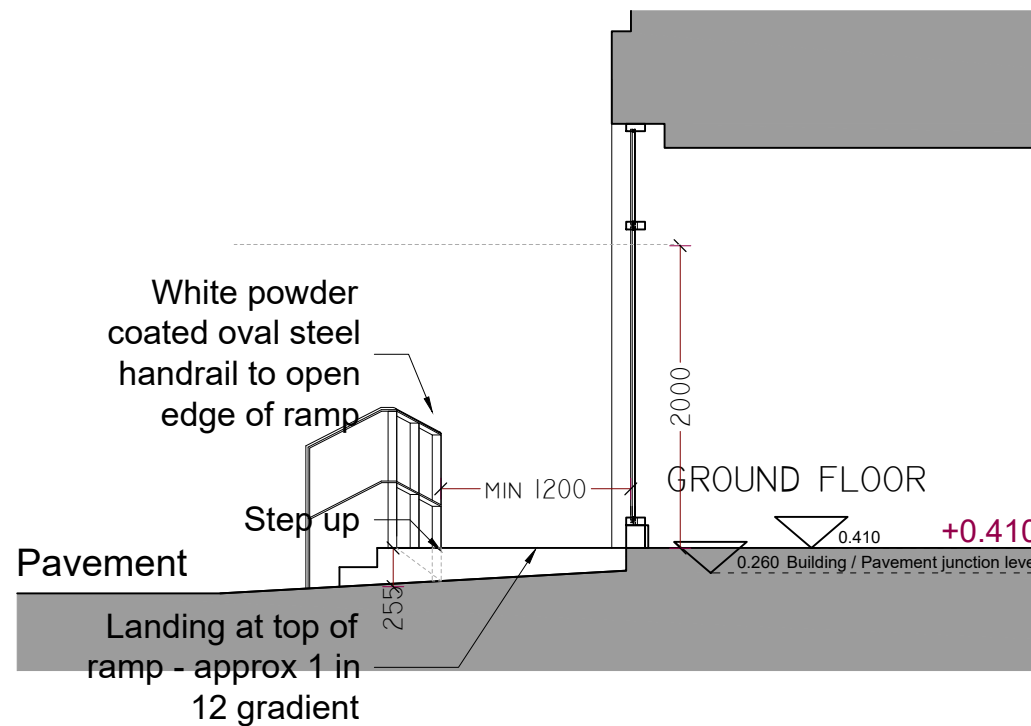

PROPOSED ENTRANCE SECTION

SCALE - meters

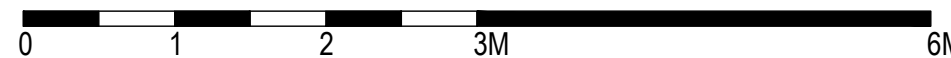

NOTE
THIS DRAWING IS TO BE READ IN CONJUNCTION WITH ALL OTHER RELEVANT DRAWINGS AND SPECIFICATIONS
THIS DRAWING HAS BEEN PREPARED FOR IDENTIFICATION PURPOSES ONLY. VERIFICATION OF DRAWN INFORMATION TO BE CARRIED OUT BY CONTRACTOR PRIOR TO OTHER USE. ALL DIMENSIONS TO BE CHECKED ON SITE, AND SUCH DIMENSIONS TO BE THE CONTRACTORS RESPONSIBILITY. DRAWING ERRORS AND OMISSIONS TO BE REPORTED TO THE CONTRACT ADMINISTRATOR.

Sign reinstated
Low wall with service doors retained (containing electrical head and distribution)

A - Amendments as agreed with the access officer 08/02/18

REVISION DATE

Eveleigh Designs

rupert@eveleighdesigns.co.uk
jocelyn@eveleighdesigns.co.uk
tel 07722 830254

project 5 ELM TERRACE AND 1 & 3 CONSTANTINE ROAD London NW3 no 17/15

drawing PROPOSED SHOP FRONT DISABLED ACCESS no GA 08 A

scale 1:50@A3 date 19.10.17 drawn RE checked JLE

PLANNING