

DO NOT SCALE FROM THIS DRAWING. ALL DIMENSIONS ARE TO BE CHECKED ON SITE PRIOR TO BUILD. DIMENSIONAL DIFFERENCES TO BE CONFIRMED WITH THE ARCHITECT. THIS DRAWING IS TO BE READ IN CONJUNCTION WITH ALL CONSULTANTS INFORMATION, MACKAY AND PARTNERS. RETAIN THE COPYRIGHT OF ALL INFORMATION WITHIN THIS DRAWING.

- FLOOR FINISH LEGEND**
- FL-701/ Porcelanosa Nast White Polished Porcelain Flooring, 443x443 mm.
 - FL-702/ Porcelanosa EGEO Blanco White Flooring, 800x800 mm.
 - FL-801/ Meister Lindura Wood HD300, White Washed Rustic Oak 8425, Brushed, Naturally oiled Flooring, 2600x320x110 mm PATTERN 1.
 - FL-802/ Meister Lindura Wood HD300, White Washed Rustic Oak 8425, Brushed, Naturally oiled Flooring, 2600x320x110 mm, PATTERN 2.
 - FL-820/ Tarmatec Polar 2347.

- WALL FINISH LEGEND**
- PT-101/ White Paint (RAL 9010 Satin).
 - LIN-501/ Meister Lindura Wood HD300, White Washed Rustic Oak 8425, Brushed naturally oiled, to match Floor.
 - LIN-502/ Egger Oak Gladstone White H335 ST28, According to Detail.
 - LIN-505/ Lacquered MDF Baseboard, NCS 1002-R.
 - LIN-901/ Molding Lacquered Little Greene, Colours of England, Aquamarine 138
 - LIN 920/ Laminated Glass.
 - LIN-921/ Clear Laminated Mirror.
 - RD-01/ Refer to Millwork Drawings.
 - RD-02/ Refer to Elevation Drawings.

- CEILING FINISH LEGEND**
- CLG-101- Wall Paint (RAL 9003 MATTE)

- FURNITURE MATERIALS LEGEND**
- LIN-301/ Black Metallic Frame
 - LIN-302/ Steel Structure 50x75mm
 - LIN-303/ Plywood 20mm
 - LIN-304/ Fire Rated Thermal Isolation
 - LIN-305/ Dekton Lumina Solid
 - LIN-306/ LED Linearlight Colormix Flex - LF05CA2 (Warm Light and low power)
 - LIN-307/ Fire Rated MDF + Formica F1079 Natural Oak
 - LIN-308/ Steel Structure
 - LIN-309/ Fire Rated MDF Seat, Fabric DEDAR Milano, Adamo & Eva 140 LAGO

- DOORS FINISH LEGEND**
- LIN-401/ Aluminium Profile
 - LIN-402/ MDF Board (19mm)

2	New Materials List	31/01/2018
1	New Finishes	26/01/2018

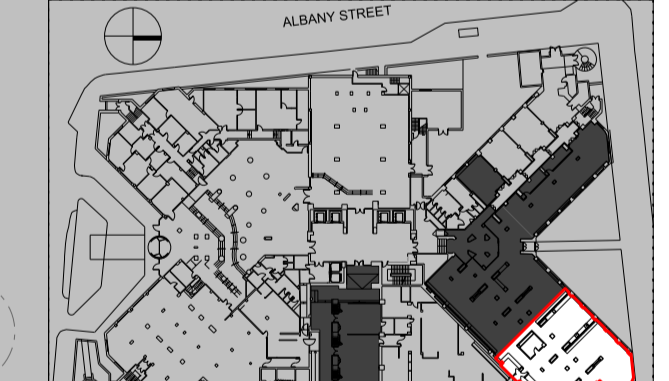

Key Plan
Drawing Status

PLANNING
Issued only for purpose indicated

Mackay + Partners

ARCHITECTS & DESIGNERS
Florin Studios, Florin Court, 6-8 Charterhouse Square
London EC1M 6EY Tel +44 (0)207 608 1177
e-mail: contact@mackayandpartners.co.uk

Job Title
White House Hotel

Drawing Title
**PROPOSAL
GROUND FLOOR / ZONE C1
WALL AND FLOOR FINISHES**

Scale @ A1	1:50	Scale @ A3	1:100	Drawn by	MT
Date	28/07/2017	Checked by	KM		
Drawing No.	598.16_PL_0600_321	Rev.			2