

Existing Location Plan - 1:1250 North

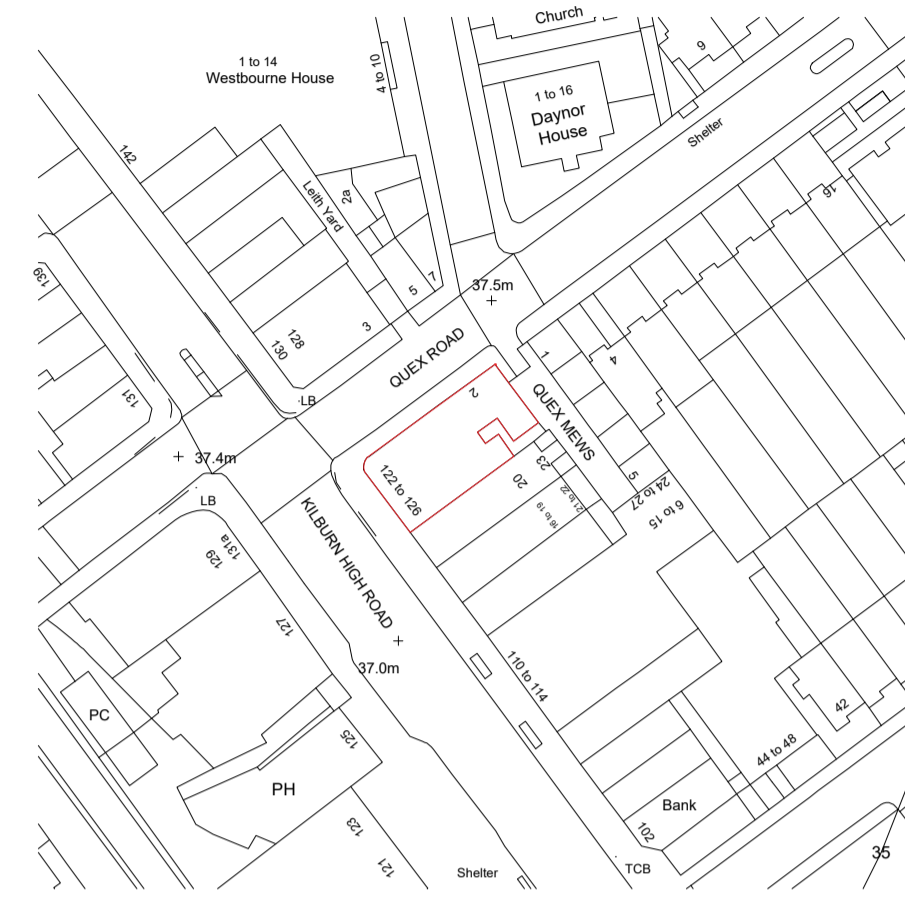

Proposed Location Plan - 1:1250 North

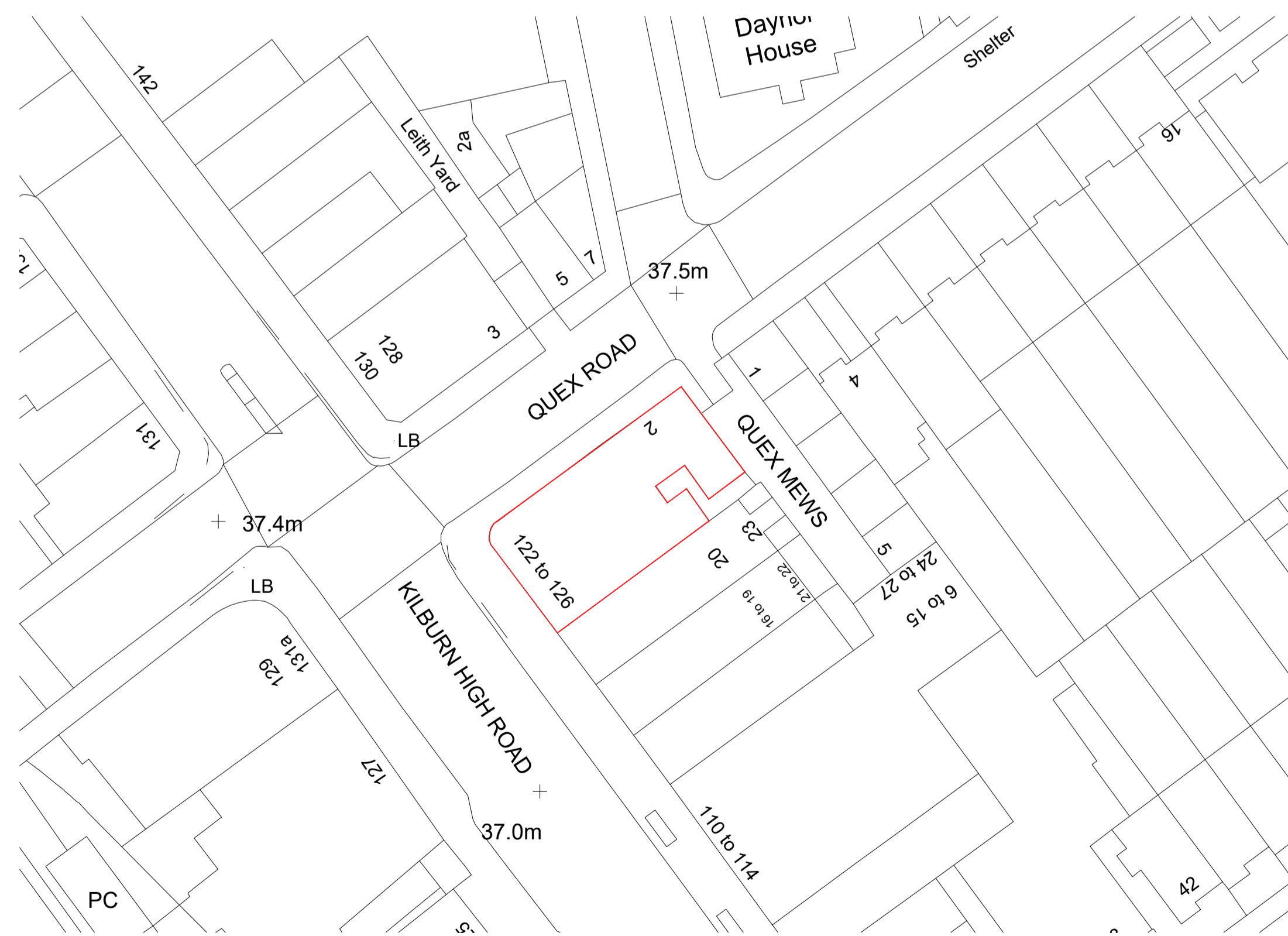

Existing Block Plan - 1:500 North

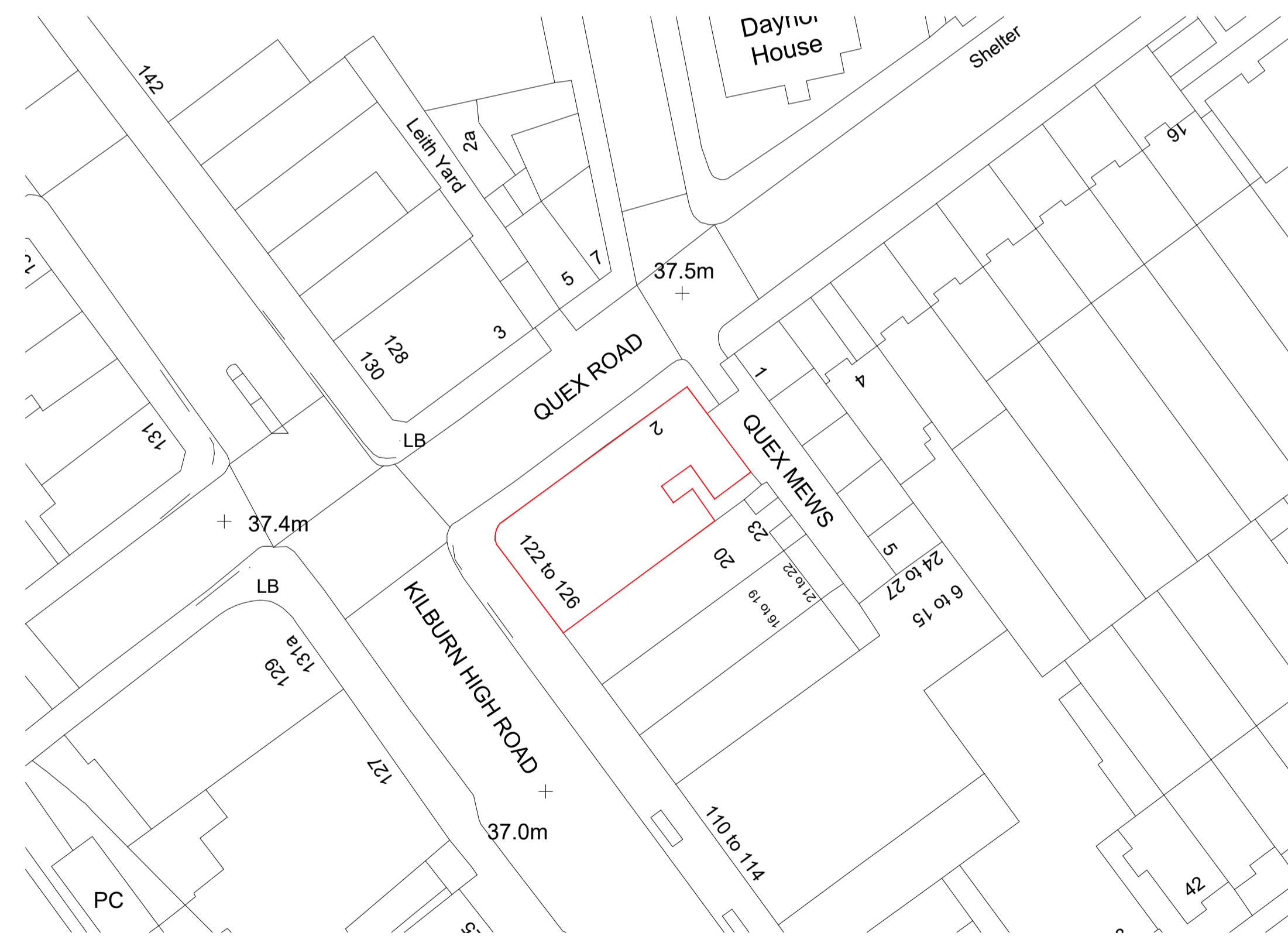

Proposed Block Plan - 1:500 North

STATUS: AWAITING APPROVAL

PROJECT STAGE: S3 - Planning	DRAWN BY: RK	CHKD BY: SK
CLIENT: Steve Greenwood		
PROJECT: Merlin House, Kilburn High Road		
PROJECT NO: 490-02-18	PAGE NO: P01	POSTCODE: NW6 4HY
DRAWING: Site and Block Plans		
SCALE: 1:500, 1:1250 on A1		

BUILDER INFORMATION:
DO NOT BUILD FROM ANY DRAWINGS PACKAGES THAT DO NOT SAY: BUILDING CONTROL APPROVED OR IN CONSTRUCTION PACKAGES.
IT IS THE RESPONSIBILITY OF THE BUILDER TO CONTACT THE ARCHITECT TO REQUEST/CONFIRM THE RIGHT DRAWING PACKAGE IS ON SITE. PLEASE BE ADVISED THAT ALL DRAWING PACKAGES WILL ALSO HAVE STRUCTURAL ENGINEERING WORKS ATTACHED. DO NOT BUILD WITHOUT ALL PAPERWORK.

DRAWING NOTES:
ALL ITEMS, NOTES, DIMENSIONS AND GENERAL DESIGN CONTAINED IN THIS DRAWING ARE FOR GUIDANCE PURPOSES ONLY. NOMINATED BUILDER AND PERSON RESPONSIBLE FOR THE PROJECT SHOULD MAKE A THOROUGH CHECK PRIOR TO COMMENCEMENT OF WORKS AGAINST SITE, DRAINAGE SERVICE DRAWINGS, CURRENT BUILDING REGULATIONS, BRITISH STANDARDS AND CODES OF PRACTICE. FAILURE TO DO SO WILL BE AT THE LIABILITY OF THE BUILDER/CONTRACTOR NOT THE ARCHITECT.

THE CONTRACTOR IS TO ALLOW/ WITHIN THEIR PRICE FOR ALL ITEMS NOT LISTED BUT THAT WILL BE REQUIRED TO COMPLETE THE WORK IN ACCORDANCE WITH ALL CURRENT LEGISLATION.