

Proposed Section C-C

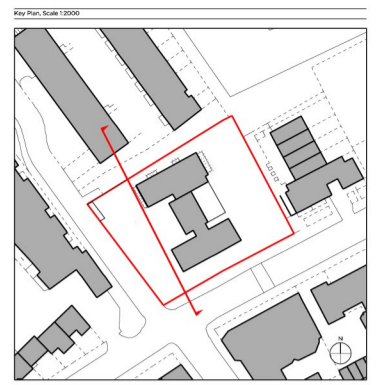

Proposed South West Elevation



- Proposed notes:
- 01 Natural stone paving to terrace
  - 02 Natural stone paving on permeable base
  - 03 Resin bonded gravel
  - 04 Resin bonded gravel to car parking space
  - 05 Existing bin store relocated
  - 06 Proposed bin store (2x, 100 litre eurobins + 2x, 240 litre wheeled bins)
  - 07 Proposed bike store (8 long stay and 4 short stay - external)
  - 08 Planting border
  - 09 Pedestrian pathway
  - 10 Dwarf wall to site boundary
  - 11 Pedestrian access gate
  - 12 Sliding vehicle access gate
  - 13 Vehicle one way system
  - 14 Lightwell
  - 15 Sedum green roof
  - 16 Lift overrun
  - 17 Profilled anodised aluminium cladding
  - 18 Pressed anodised aluminium window reveal
  - 19 Brickwork
  - 20 Portland ashlar stone
  - 21 Portland stone coping
  - 22 Double glazed window with anodised aluminium frame
  - 23 Anodised aluminium balustrade
  - 24 Structural low iron glass
  - 25 Anodised aluminium fin
  - 26 TO existing residents' parking bays retained as shown
  - 27 AOV smoke outlet
  - 28 Existing porters' lodge to be demolished
  - 29 Anodised aluminium folding lowered privacy screens
  - 30 Obscured glazing to 1.7m above finished floor level
  - 31 Clear glass balustrade
  - 32 Attenuated Acoustic Enclosure

Rev - 04.01.18 Issued for Planning

## PLANNING

Project No. **16033**

Date **November 2017**

Scale **1:50 @ A3**

Project **Barrie House, 29 St. Edmunds Terrace**

Drawing Title: **Proposed Southwest Detailed Bay-Screens Closed**

Drawing No. **P\_52** Rev. **-**

Drawn <b>MW</b>	Approved <b>TMC</b>	Signed
-----------------	---------------------	--------

**Marek Wojciechowski Architects Ltd.**

66-68 Margaret Street, W1W 8SR T. 020 7580 9336 www.mw-a.co.uk

Copyright Marek Wojciechowski Architects Limited. No implied license exists. This drawing should not be used to calculate areas for the purposes of valuation. All dimensions to be checked on site by the contractor and such dimensions to be their responsibility. Do not scale drawings. All work must comply with relevant British Standards and Building Regulations requirements. Drawing errors and omissions to be reported to the architect.

0 0.5m 1m 2m